

MATCH LINE STA. 13+00

MATCH LINE STA. 3+00

### MIDWAY ROAD

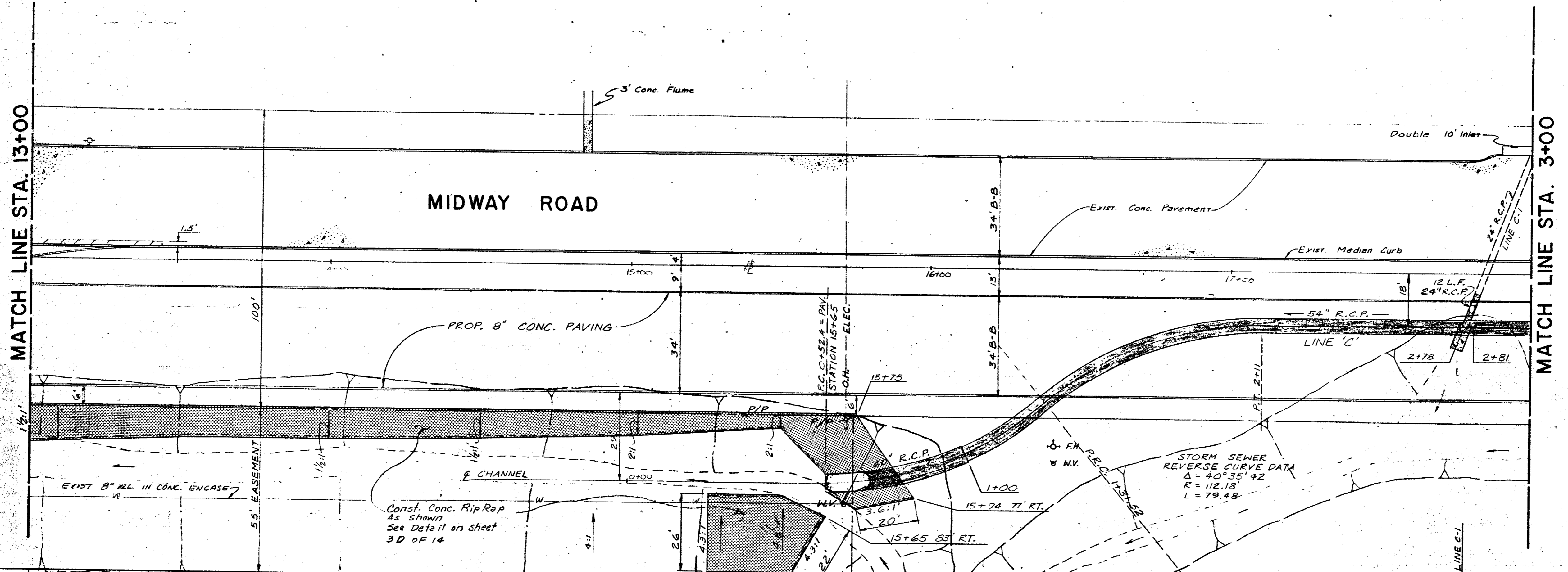

T.P. ~ Top Operating Nut F.H.  
STA. 13+18 39.5 Lt. Elev. 606.97

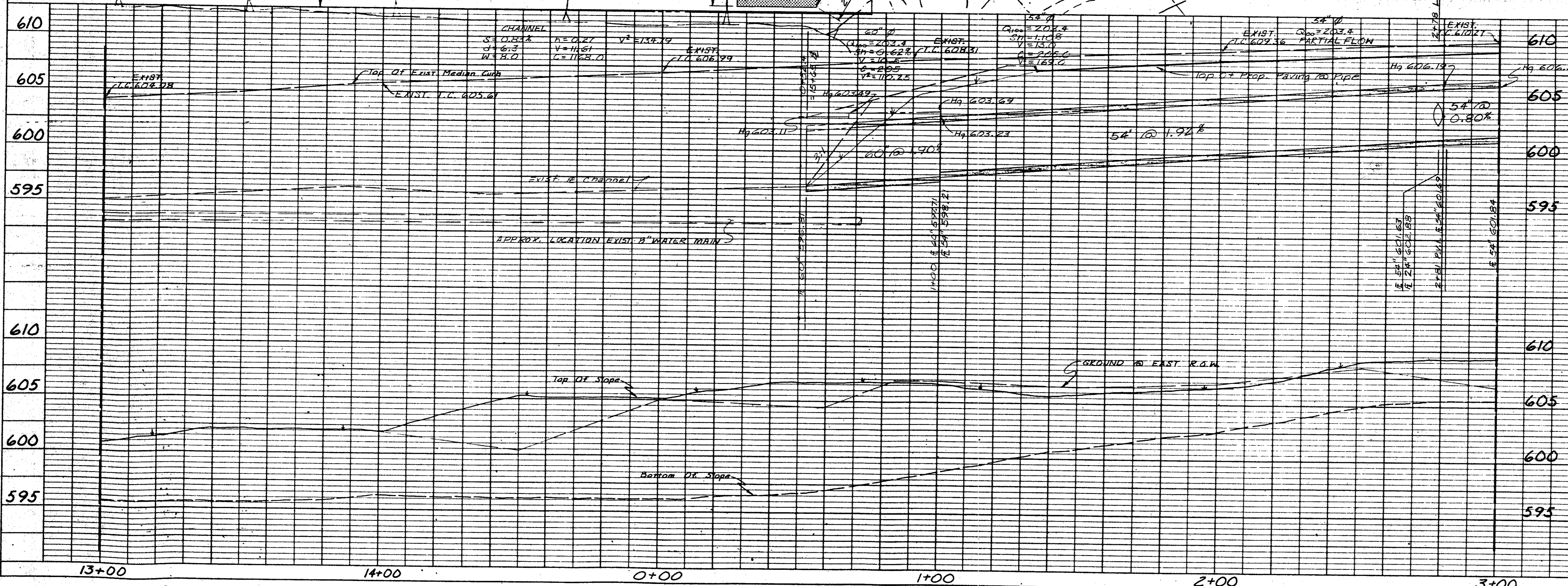

**PLAN**  
 SURVEYED BY: \_\_\_\_\_  
 NOTED BY: \_\_\_\_\_  
 NOTE BOOK GRADES CHECKED: \_\_\_\_\_  
 STRUCTURE NOTATIONS CHECKED: \_\_\_\_\_  
 No. \_\_\_\_\_

**PROFILE**  
 SURVEYED BY: \_\_\_\_\_  
 NOTED BY: \_\_\_\_\_  
 NOTE BOOK GRADES CHECKED: \_\_\_\_\_  
 STRUCTURE NOTATIONS CHECKED: \_\_\_\_\_  
 No. \_\_\_\_\_

REVISION NO.	REMARKS	DATE
CITY OF CARROLLTON DRAINAGE IMPROVEMENTS <b>MIDWAY ROAD</b> KELLER SPRINGS RD. TO TRINITY MILLS RD.		
<b>HUNTER ASSOCIATES INC.</b> ENGINEERS/PLANNERS/SURVEYORS DALLAS, TEXAS 214-568-8711		
DESIGNED BY: J.S.	SCALE: 1" = 20' H 1" = 5' V	
DRAWN BY: P.D.F.	APPROVED BY: _____	
JOB NUMBER: D83099	DATE: SEPT 83	SHEET 40 OF 14

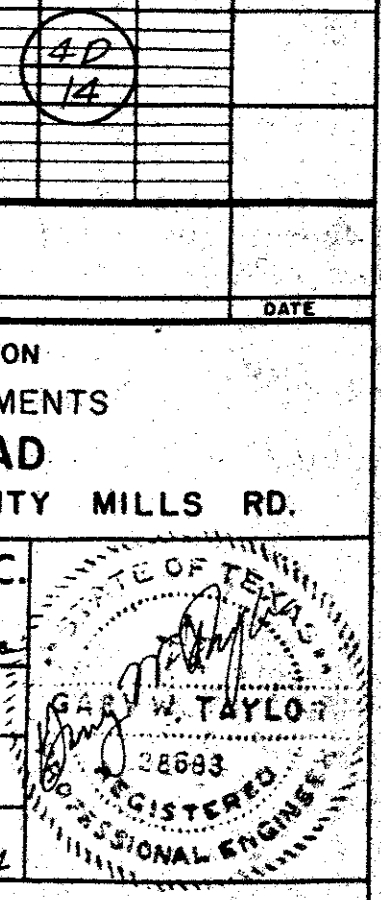

DATE	BY
REVISION	NO.
NOTE BOOK	NO.
ADJUSTMENT CHECKED	BY
FT. OF WAY CHECKED	BY
PLAN	NO.

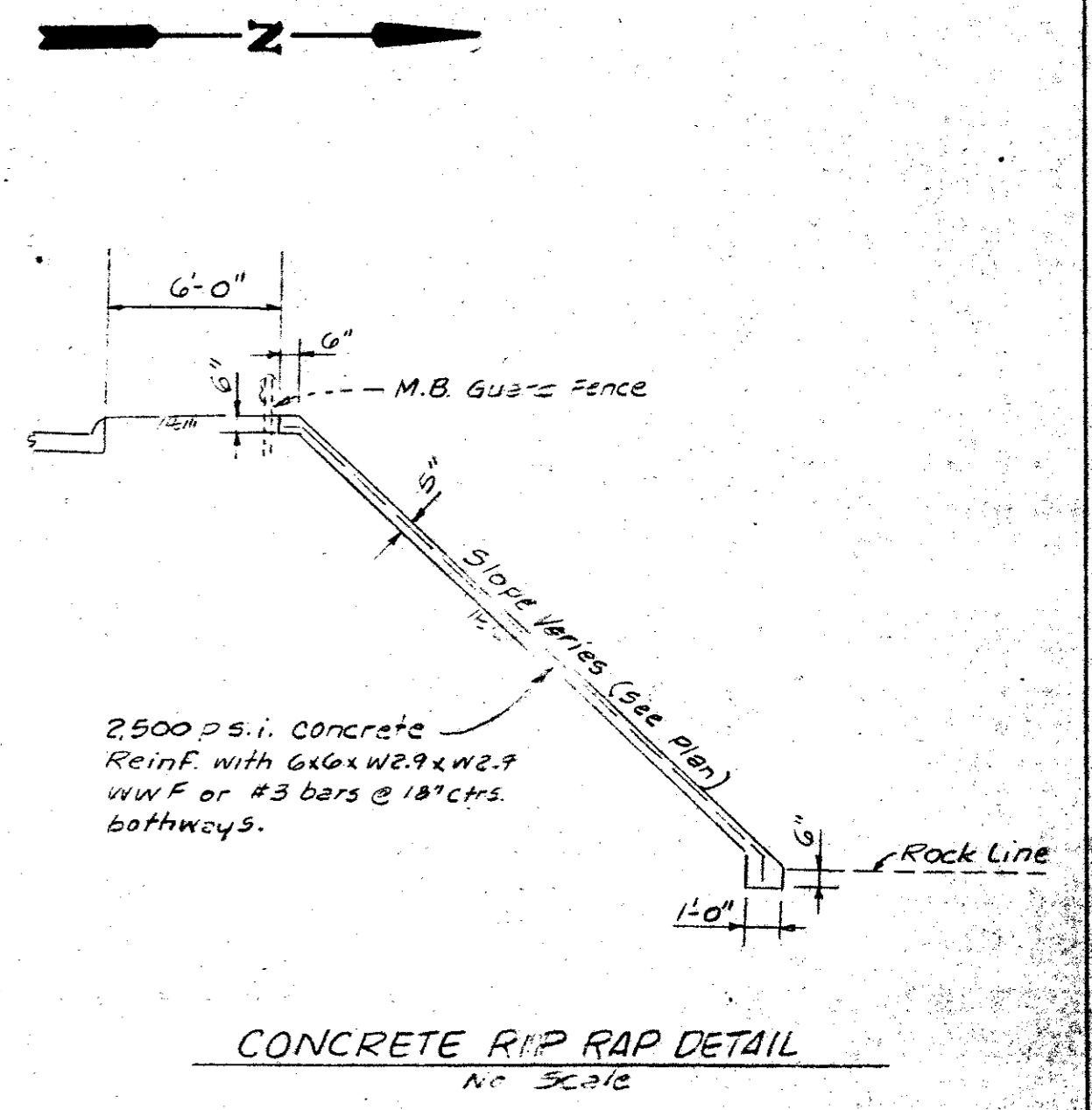
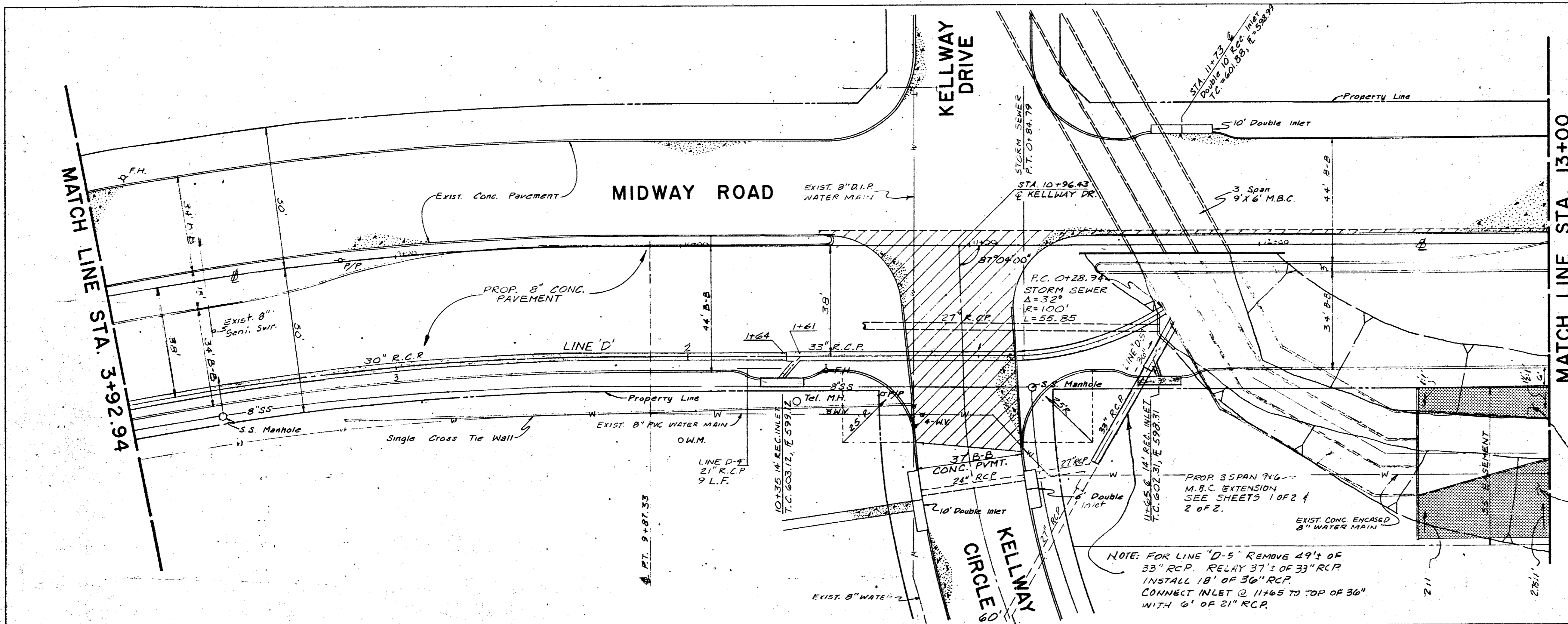

NOTE: FOR LINE "D-5" REMOVE 49' OF 33" RCP. RELAY 37' OF 33" RCP. INSTALL 18' OF 30" RCP. CONNECT INLET @ 11465 TO TOP OF 30" WITH 6' OF 21" RCP.

Const. Conc. Rip Rap as shown. See Detail on this sheet

I.P. ~ Top Operating Nut F.H. @ STA. 8+13, 39.5' Lt. Elev. 609.21

DATE	BY
REVISION	NO.
NOTE BOOK	NO.
ADJUSTMENT CHECKED	BY
STRUCTURE NOTATIONS CHECKED	BY
PROFILE	NO.

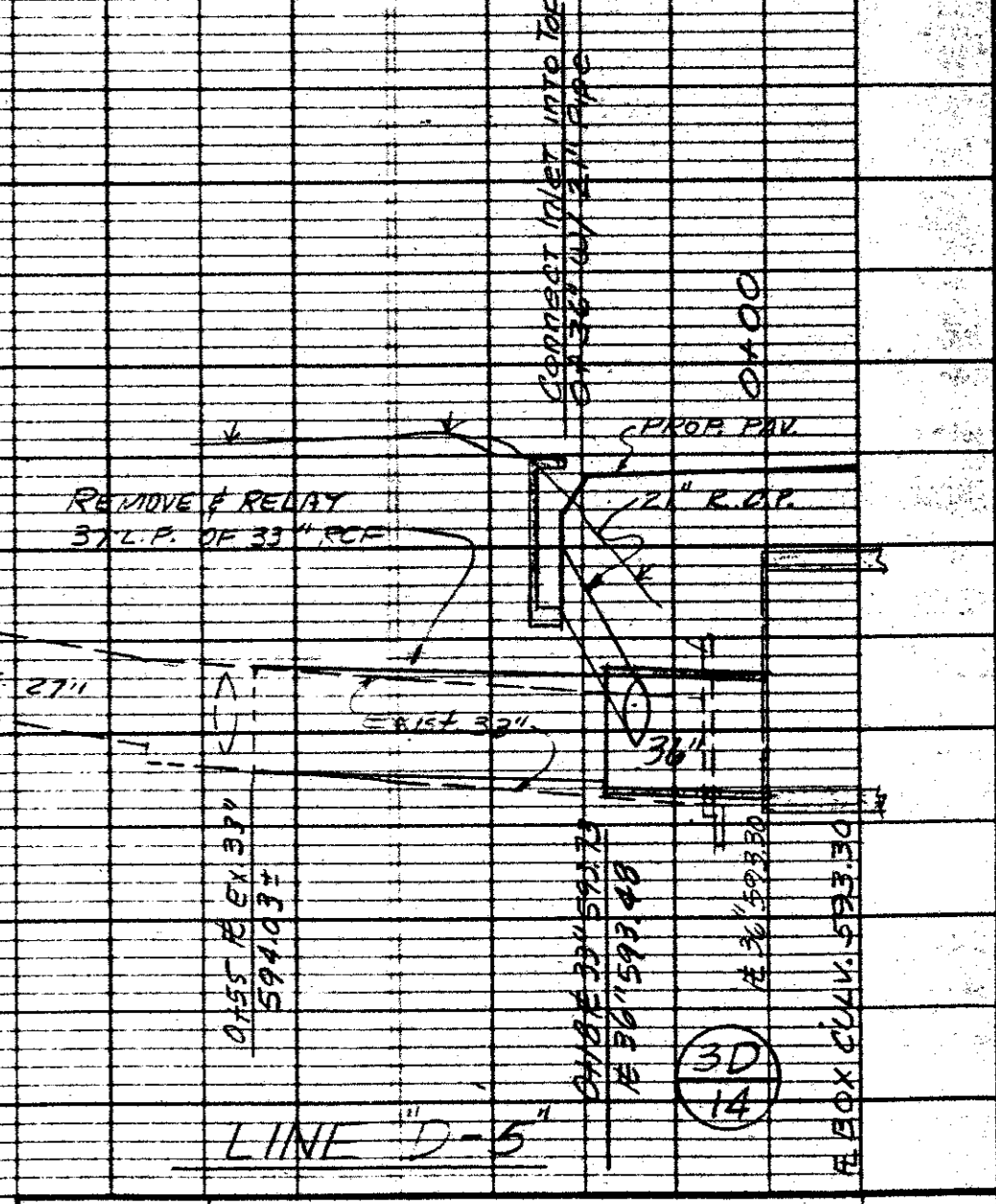
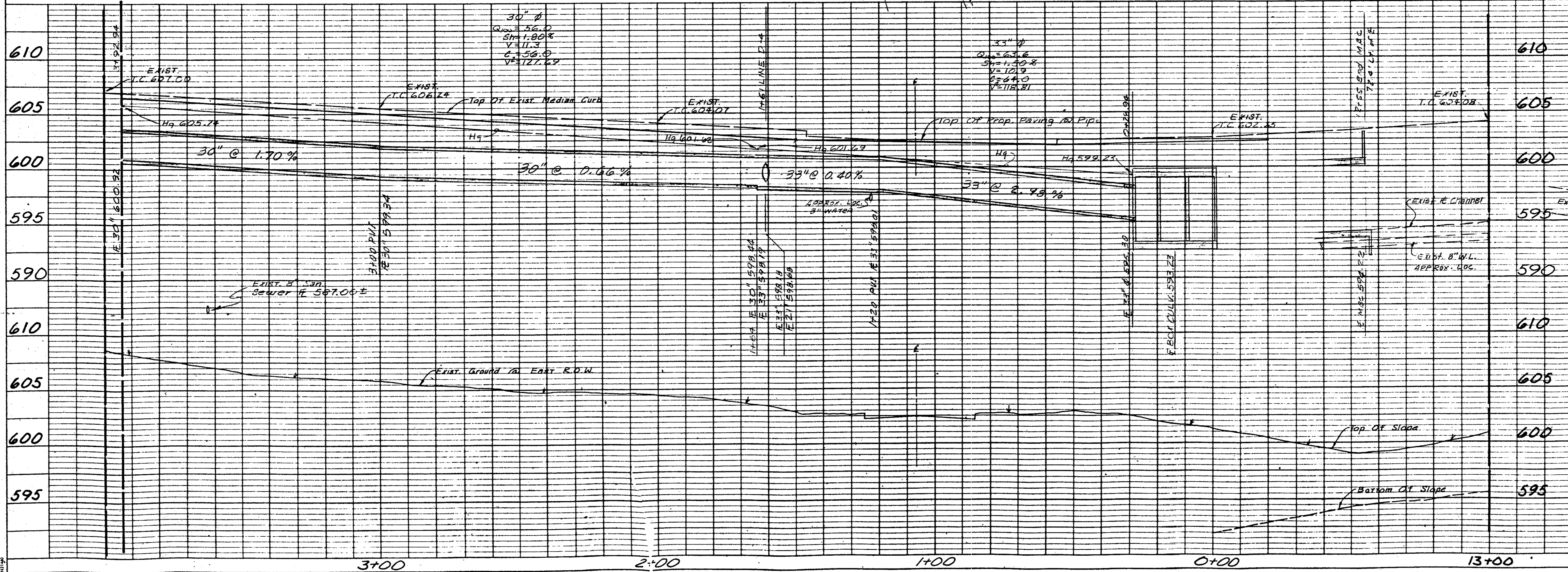

REVISION NO.	REMARKS	DATE
CITY OF CARROLLTON DRAINAGE IMPROVEMENTS <b>MIDWAY ROAD</b> KELLER SPRINGS RD. TO TRINITY MILLS RD.		
<b>HUNTER ASSOCIATES, INC.</b> ENGINEERS/PLANNERS/SURVEYORS DALLAS, TEXAS 214-358-9177		
DESIGNED BY: J.S.	SCALE: 1" = 20' H 1" = 5' V	APPROVED BY: 
DRAWN BY: P.D.F.	DATE: SEPT 83	
JOB NUMBER: D83099	SHEET 32 OF 14	

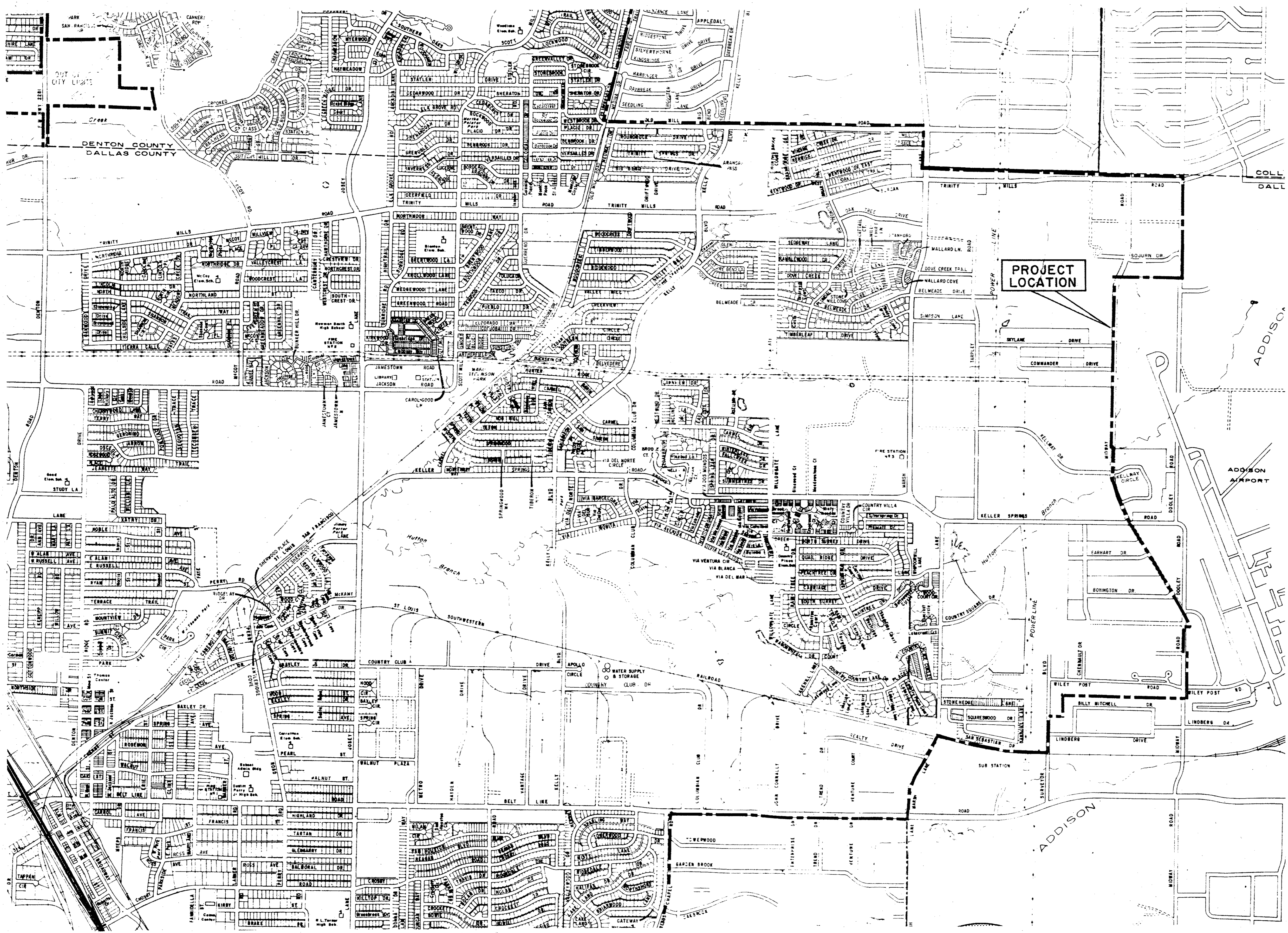

N  
1" = 1000'

### INDEX OF DRAWINGS

SHEET NO.	DESCRIPTION
I/1	LOCATION MAP
I/6 TO 6/6	PAVING & DRAINAGE DETAILS
I/14 TO 14/14	PAVING PLAN PROFILE
I/3 TO 3/3	DRAINAGE MAPS
I/14 TO 14/14	DRAINAGE PLANS
I/2 TO 2/2	CULVERT DETAILS
I/34 TO 34/34	CROSS SECTIONS

REVISION NO.	REMARKS	DATE
CITY OF CARROLLTON, TEXAS MIDWAY ROAD KELLER SPRINGS RD TO TRINITY MILLS RD. LOCATION MAP		
<b>HUNTER ASSOCIATES, INC.</b> ENGINEERS/PLANNERS/SURVEYORS DALLAS, TEXAS 75243 214-359-9171 912-454-8716		
DESIGNED BY: J.S.	SCALE: 1" = 300'	
DRAWN BY: P.D.F.	APPROVED BY:	
JOB NUMBER: D83099	DATE: SEP 83	
SHEET 1 OF 1		

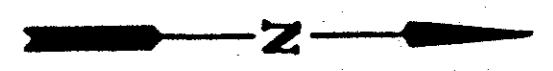

MATCH LINE STA. 13+00

MATCH LINE STA. 18+00

### MIDWAY ROAD

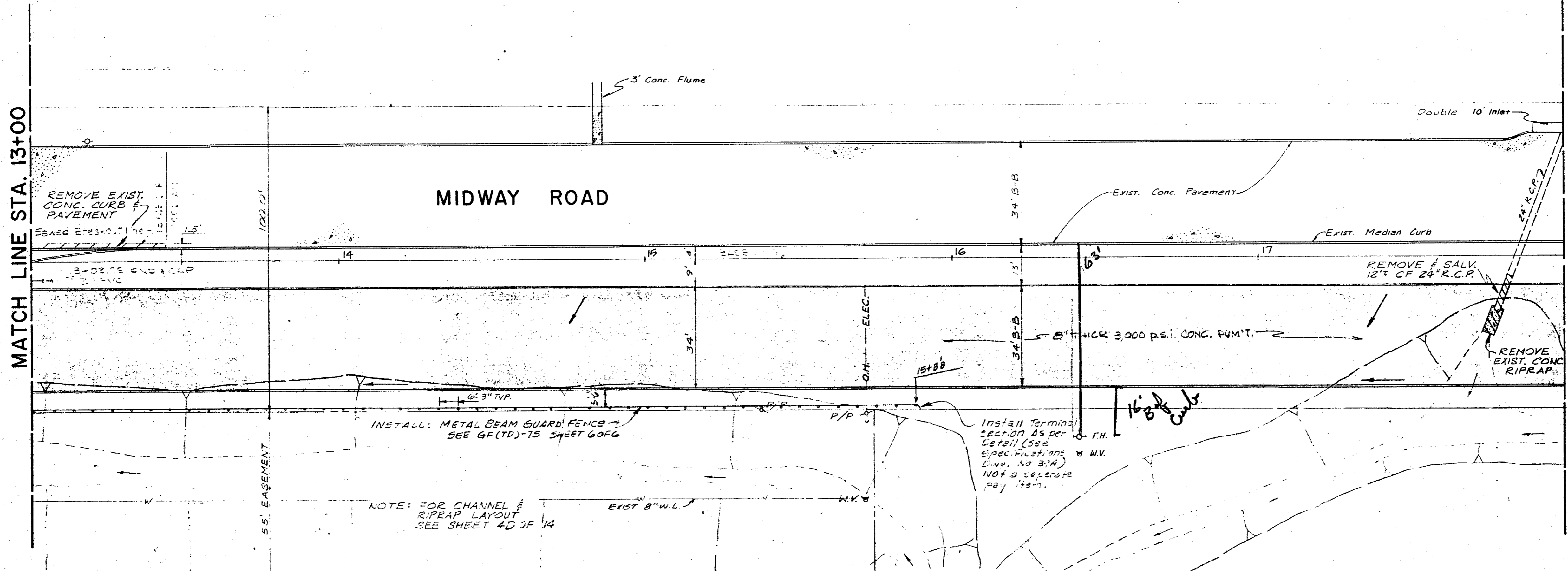

For General Notes and Typical Detail See Sheet 14

T.P. - Top Operating Nut F.H. STA. 18+33.5 Lt. Elev. 606.97

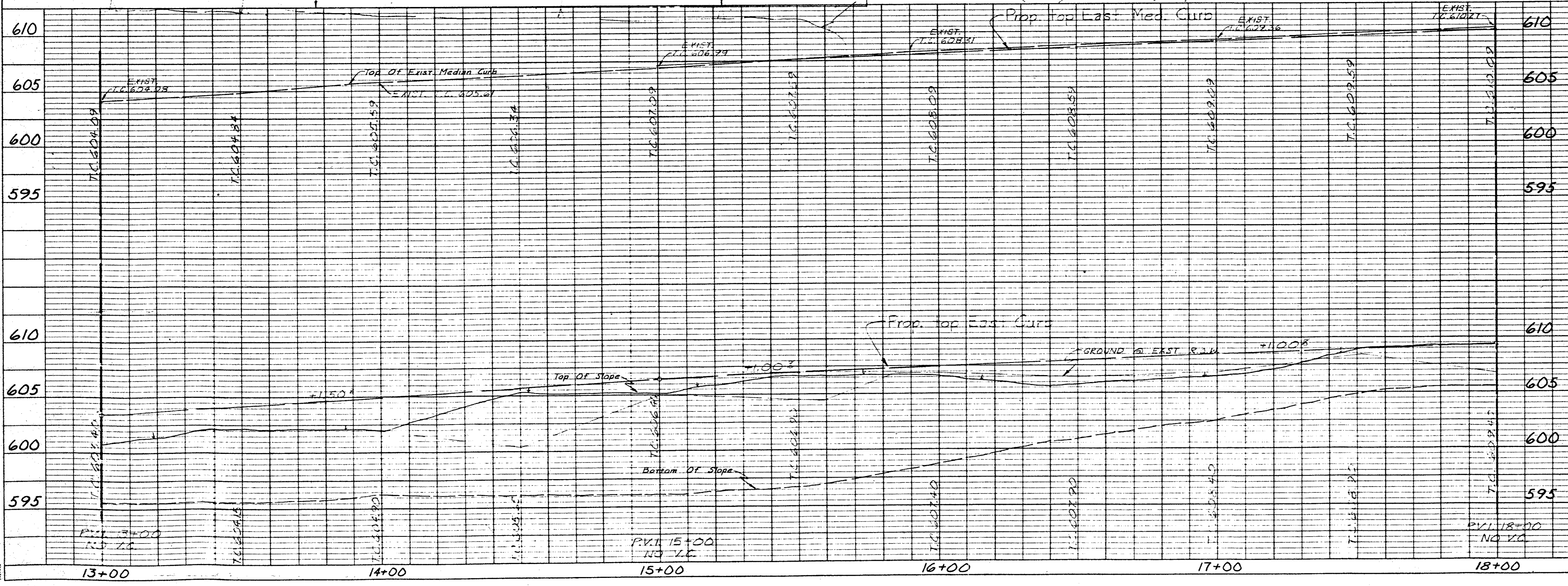

REVISION NO.	REMARKS	DATE
CITY OF CARROLLTON PAVING IMPROVEMENTS <b>MIDWAY ROAD</b> KELLER SPRINGS RD. TO TRINITY MILLS RD.		
<b>HUNTER ASSOCIATES INC.</b> ENGINEERS/PLANNERS/SURVEYORS DALLAS, TEXAS      AUSTIN, TEXAS 214-349-9171      512-454-8716		
DESIGNED BY: J.S.	SCALE: 1" = 20' H 1" = 5' V	
DRAWN BY: P.D.F.	APPROVED BY:	
JOB NUMBER: DB3099	DATE: SEPT 83	SHEET 4 OF 14

PLAN  
 SURVIVED  
 PORTLAND CEMENT  
 NOTE BOOK  
 NO. 14

PROFILE  
 SURVIVED  
 PORTLAND CEMENT  
 NOTE BOOK  
 NO. 14