

| | |
|--------------------|-----|
| DATE | BY |
| REVISION | NO. |
| NOTE BOOK | NO. |
| ADJUSTMENT CHECKED | BY |
| FT. OF WAY CHECKED | BY |
| PLAN | NO. |

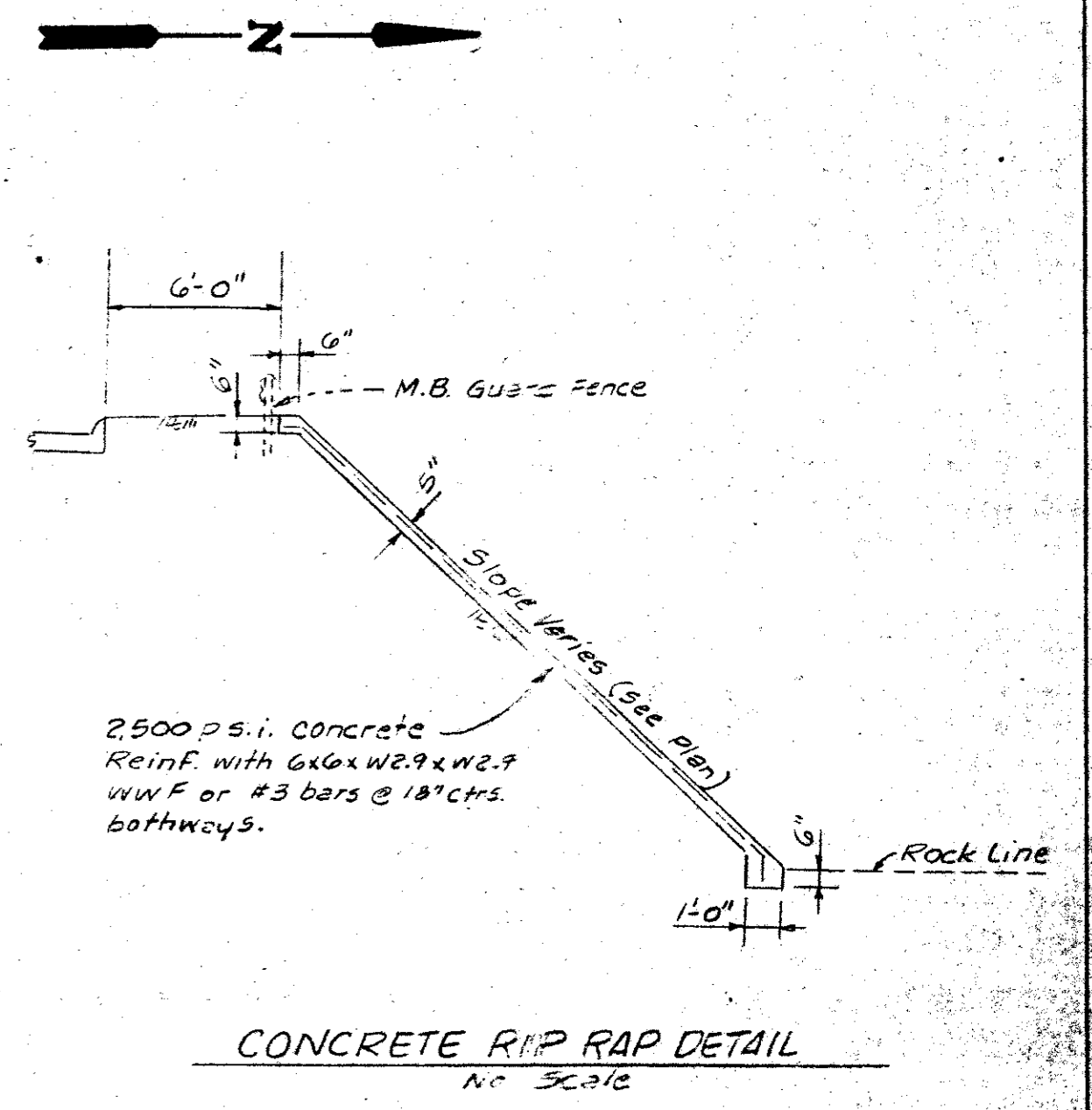
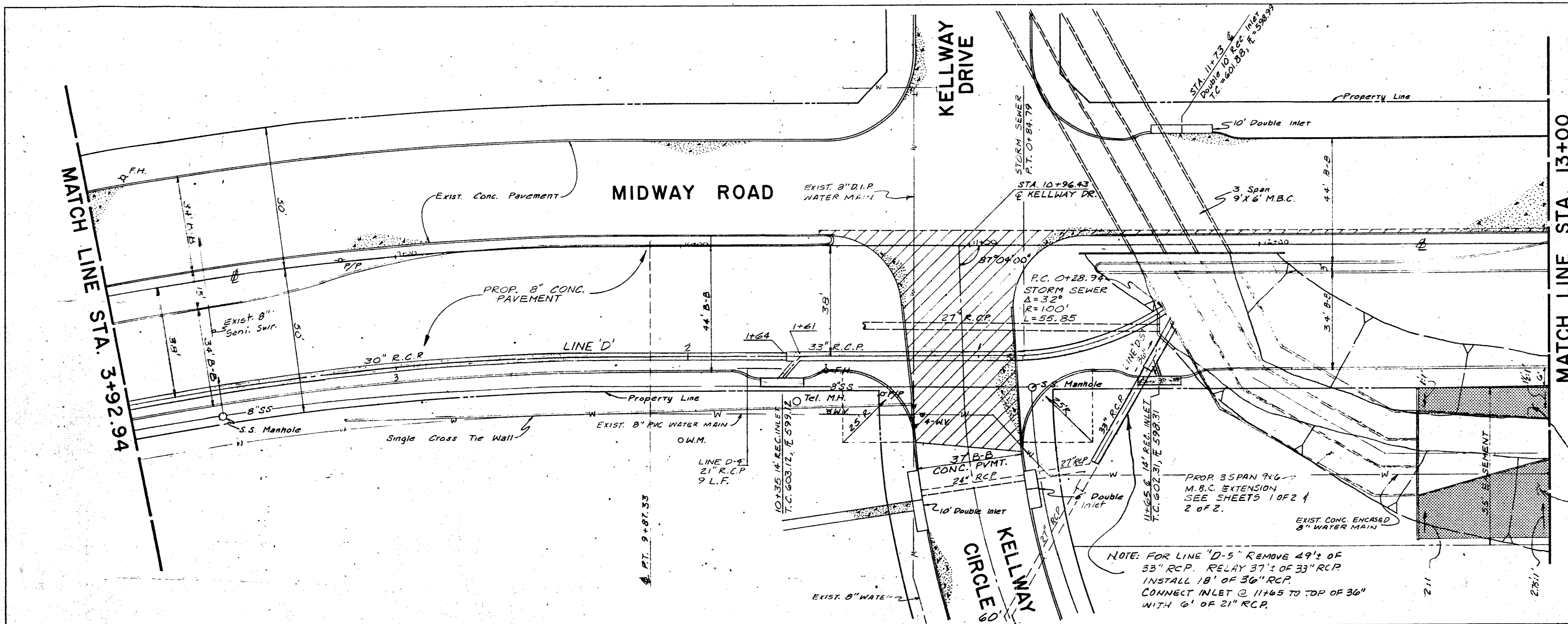

NOTE: FOR LINE "D-5" REMOVE 49' OF 33" RCP. RELAY 37' OF 33" RCP. INSTALL 18' OF 30" RCP. CONNECT INLET @ 11465 TO TOP OF 30" WITH 6' OF 21" RCP.

I.P. ~ Top Operating Nut F.H. @ STA. 8+13, 39.5' Lt. Elev. 609.21

| | |
|-----------------------------|-----|
| DATE | BY |
| REVISION | NO. |
| NOTE BOOK | NO. |
| ADJUSTMENT CHECKED | BY |
| STRUCTURE NOTATIONS CHECKED | BY |
| PROFILE | NO. |

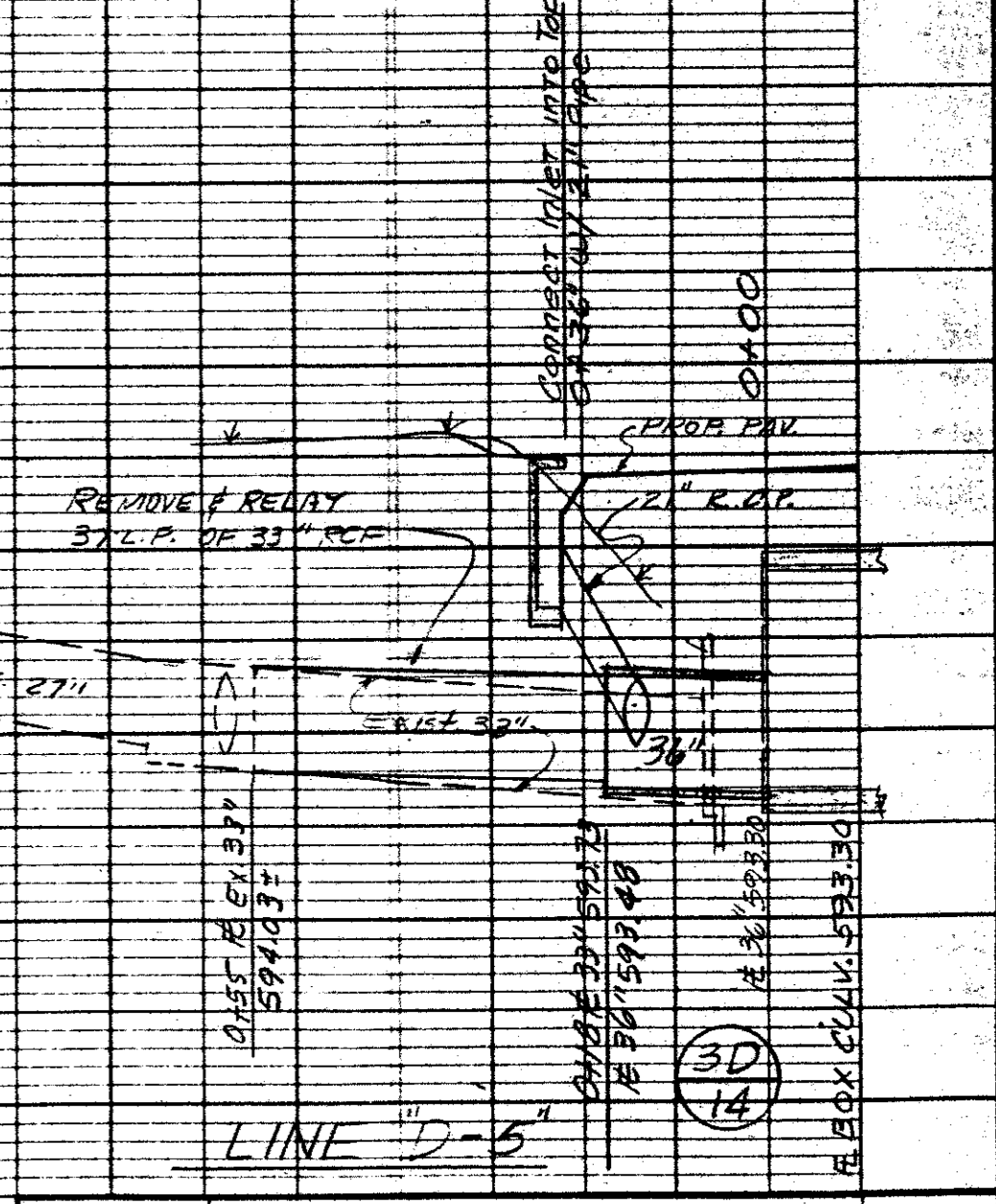
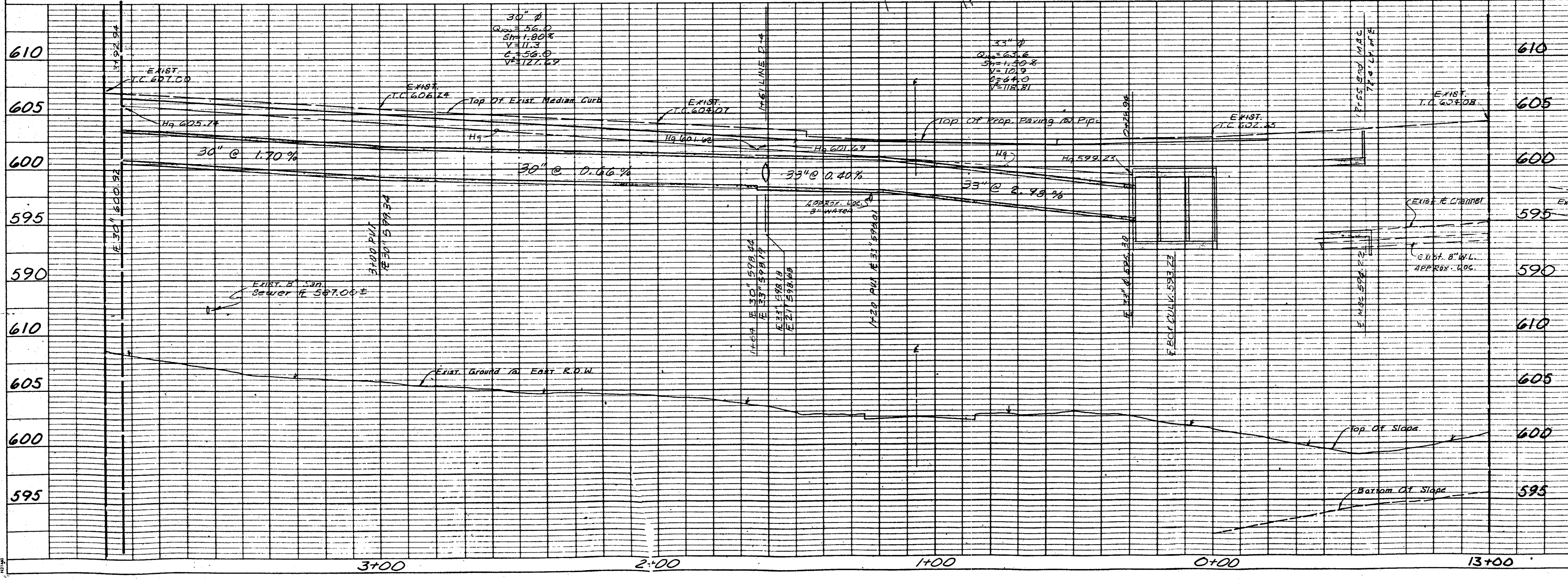

| | | |
|--|--------------------------------|------|
| REVISION NO. | REMARKS | DATE |
| CITY OF CARROLLTON DRAINAGE IMPROVEMENTS MIDWAY ROAD KELLER SPRINGS RD. TO TRINITY MILLS RD. | | |
| HUNTER ASSOCIATES, INC. ENGINEERS/PLANNERS/SURVEYORS DALLAS, TEXAS 214-358-9177 | | |
| DESIGNED BY: J.S. | SCALE: 1" = 20' H 1" = 5' V | |
| DRAWN BY: P.D.F. | APPROVED BY: | |
| JOB NUMBER: D83099 | DATE: SEPT 83 | |
| SHEET 32 OF 14 | | |