

TOWN OF ADDISON, TEXAS

MIDWAY/BELTLINE SEWER INTERCEPTOR

PHASE I
ADDISON AIRPORT
MARCH 1995

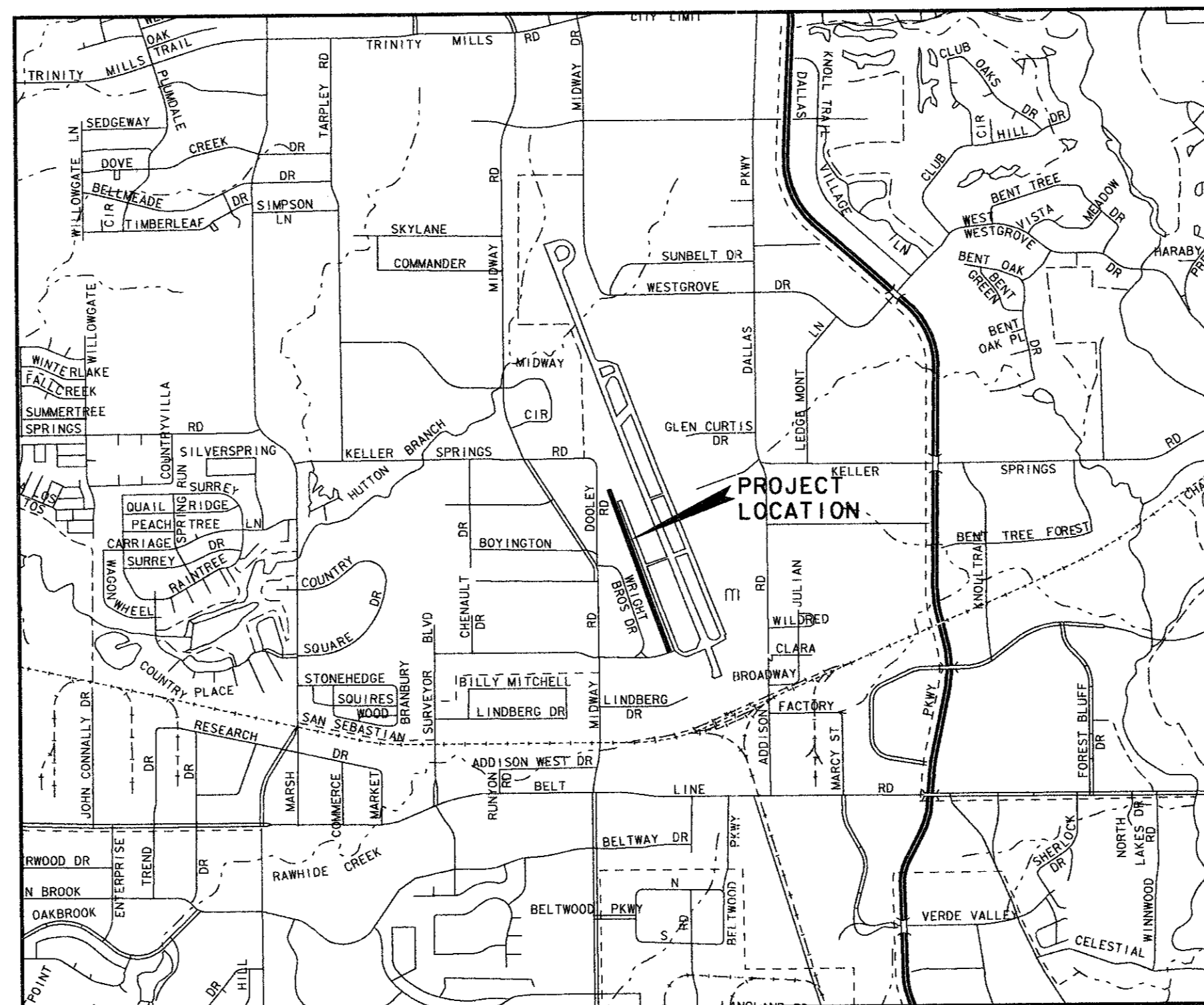
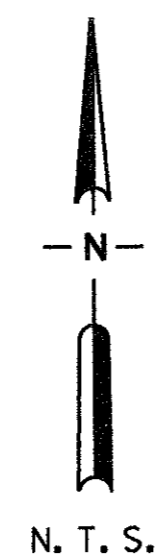
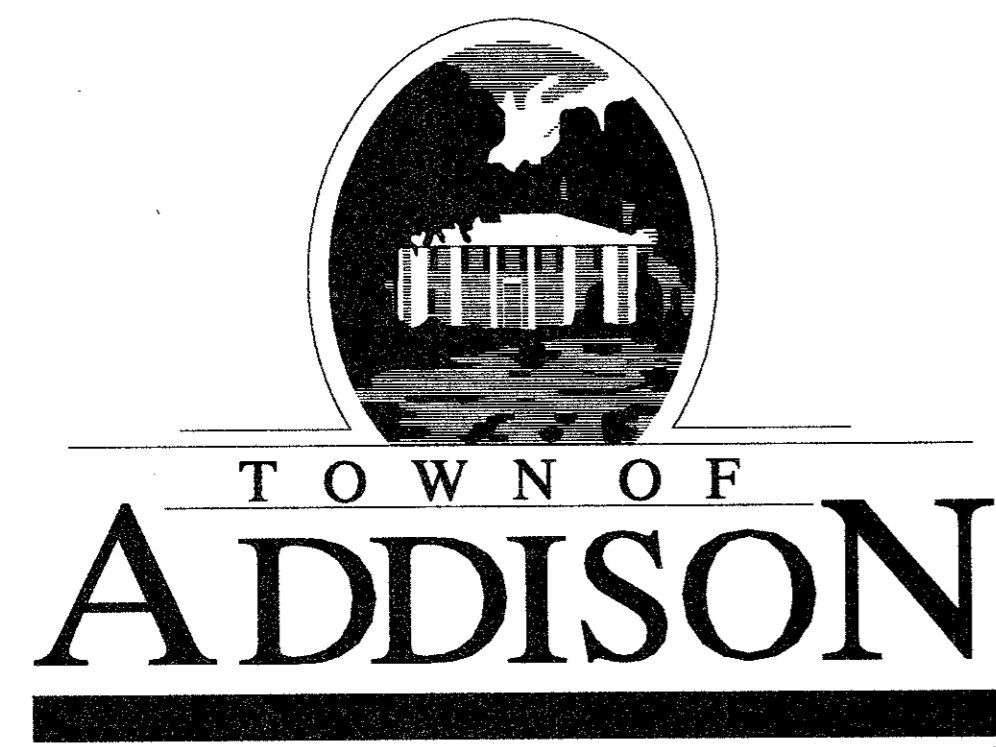

VICINITY MAP

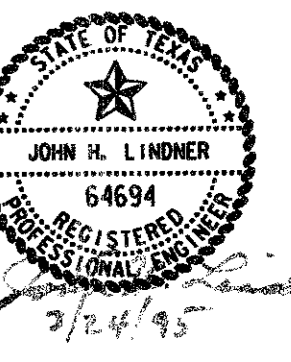

SUBMITTED BY:
CARTER & BURGESS, INC. John Lindner 3/24/95
John Lindner - Project Manager Date

APPROVED BY:
TOWN OF ADDISON _____
John Baumgartner - Director of Public Works Date

Carter Burgess
Consultants in Engineering, Architecture,
Planning and the Environment
CARTER & BURGESS, INC.
7950 EMBROOK DRIVE, SUITE 250
DALLAS, TX 75247-4961

GENERAL NOTES

1. All sewer main construction shall conform to the minimum requirements of the Texas Natural Resource Conservation Commission (TNRCC) Rules and Regulations for public water and sewer systems. In particular, Title 30 Texas Administrative Code Chapter 317.2 - Design Criteria for Sewerage Systems.
2. All construction shall conform to the requirements as stated in the "Standard Specifications For Public Works Construction, North Central Texas Council of Governments" (latest edition).
3. All 8" thru 12" force mains shall be Class 200, AWWA C900, P.V.C. pipe.
4. Depth of sewer line shall be adjusted as necessary to avoid conflicts with other underground utilities. No separate pay for use of vertical bends or additional depth of cut.
5. All mains shall be tested in accordance with TNRCC Chapter 317.2 testing requirements as shown in the specifications. Not a separate pay item.
6. All sanitary sewer pipe joints shall be SDR 35 (P.S. 46) PVC ASTM D3034 (green in color), unless otherwise noted.
7. The Contractor shall be required to provide and maintain all necessary warning and safety devices (flashing lights, barricades, signs, etc.) in accordance with Texas Manual on Uniform Traffic Control Devices to protect the public safety and health until all the work has been completed and accepted by the City. Not a separate pay item.
8. The locations of existing utilities indicated on these plans are taken from existing public records. The Contractor is solely responsible for verification of vertical and horizontal location of all utilities prior to construction. Additional utilities and services may be crossing proposed sanitary sewer line. Contractor shall notify all utility companies with facilities in project area 48 hours prior to construction. Contractor is responsible for repairing damage to existing utilities, whether shown or not shown on plans, at no additional cost to the City.
9. All expansion joints shall be subsidiary to pavement replacement.
10. All sawcuts are to be full depth unless otherwise indicated on plans.
11. All dimensions to curbline are referenced to the back of curb unless otherwise noted. Curb removal/replacement is subsidiary to pavement removal/replacement.
12. All trees shall be protected from damage unless specifically designated for removal on the plans.
13. All embedment and backfill to be included in the unit prices for installation of pipe.
14. The Contractor shall notify the following, five (5) days before starting work on the improvements shown on these plans.
 - a. Addison Airport of Texas, Inc. - Mr. Edward Morales (214) 248-7733 ext.105
 - b. FAA - Mr. Curtis Gray (214) 490-4750
 - c. SW Bell Telephone ENTERPRISE 9800
 - d. GTE Telephone (214) 318-3880
 - e. TU Electric (214) 323-8910
 - f. Lone Star Gas (214) 263-3444
 - g. Storer Cable (214) 840-2288
 - h. Conoco Pipeline (800) 833-6012
 - i. Explorer Pipeline (918) 493-5100
 - j. Sprint (800) 245-4545
15. The Contractor shall notify the following, five days before starting work on the improvements in order to coordinate construction, administration, and inspection activities.
 - a. City of Addison - Construction Inspection (214) 450-2847
16. The Contractor shall dispose of waste pavement, concrete, pipe, unacceptable soil, etc. in an approved offsite landfill. This shall be subsidiary to the unit price of pipe installation.
17. Unpaved areas disturbed by construction are to be hydromulched or sodded at the direction of the Engineer, fertilized and watered per NCTCOG specifications. No separate payment for seeding, sodding, fertilizing, watering and related work. All costs for this work are considered incidental and are to be included in the unit prices for installation of pipe.
18. All sprinkler systems and related components of sprinkler systems and fences, signs, etc. disturbed by construction are to be restored to existing condition. No separate payment for this work. All costs are considered incidental and are to be included in the unit prices for installation of pipe.
19. Contractor, at his own expense, shall be responsible for the repair of any facility damaged, and immediate notice shall be given to property owner and repaired within four hours.
20. Unless otherwise noted, all materials will conform to the "Standard Specifications for Public Works Construction for North Central Texas", (latest edition) and the Town of Addison Standards.
21. In the event an item is not covered in the specifications, the City Engineer's decision will apply.
22. Where sanitary sewer pressure pipe parallels water a minimum clearance of 2.0' vertical and 9.0' horizontal shall be maintained. Where sewer line crosses existing water line a minimum of 6" clearance shall be maintained with one joint of sewer pipe centered on water line.
23. Trench excavation for trenches 5 feet or more in depth shall be in accordance with all provisions of Part 1926, Subpart P - Excavations, Trenching and Shoring of the Occupational Safety and Health's Standards and Interpretations. It shall be the responsibility of the Contractor to conform to the above provisions.
24. The Contractor shall maintain continuous mail service to all residences in the construction area. Should it become necessary to remove existing mail boxes the Contractor shall erect temporary facilities and coordinate delivery with the Postmaster. Following construction, the Contractor shall permanently replace all mail boxes in accordance with U.S. Postal regulations.

Maintaining continuous mail service, establishment of temporary facilities, and permanent replacement of mail boxes after construction are subsidiary to the item being installed.
25. If temporary sanitary sewer by-pass is required, the Contractor shall coordinate with the Town of Addison Department of Public Works five (5) working days prior to anticipated shut-down. Prior to installing the by-pass lines, the Contractor shall have on site all men, materials and equipment necessary to complete the by-pass without delays. The by-pass assemblies shall be fully assembled and ready for installation prior to shut-down of the existing system. Any required temporary by-passing shall be considered incidental and not a separate pay item.
26. Thrust blocking required at all bends unless otherwise indicated on plans and shall be included in unit price of pipe installation.
27. All force main pipe shall be white in color.
28. Terra-Tape required the length of force main installed one (1) foot above main. Tape to read "Sanitary Sewer". This shall be incidental to the cost of installing the pipe.
29. Contractor shall maintain access to properties and shall repair driveways within forty-eight (48) hours of pavement removal. For all pavement replacement use Type 1 cement with appropriate ASTM C494 admixtures.
30. Contractor shall obtain Fire Department and Street Cutting Permits.

31. For all work inside Addison Airport property, Contractor must supply, at his cost, radios compatible with the Control Tower to be employed at all times during construction.

BENCHMARKS			
DESCRIPTION	ELEVATION	NORTHING	EASTING
"X" CUT IN BRAK-O PARKING LOT APPROXIMATELY 5 FEET EAST OF SIGN.	624.95	470,653.9352	2,203,023.5463
"X" CUT IN CONCRETE ENTRANCE OF PARKING LOT SOUTH SIDE OF WILEY POST ROAD APPROXIMATELY 150 FEET EAST OF MIDWAY.	635.26	471,165.8800	2,203,249.3273

ESTIMATED QUANTITIES			
ITEM	DESCRIPTION	UNIT	QUANTITY
1	8" PVC (DR-14) FORCE MAIN INCLUDING EXCAVATION, EMBEDMENT, BACKFILL AND THRUST BLOCKING	LF	693
2	12" PVC (DR-14) FORCE MAIN INCLUDING EXCAVATION, EMBEDMENT, BACKFILL AND THRUST BLOCKING	LF	693
3	15" PVC (SDR-35) SANITARY SEWER	LF	2060
4	24" STEEL CASING PIPE BY BORE	LF	20
5	REMOVE AND REPLACE CONCRETE PAVEMENT INCLUDING CURB AND STABILIZED SUBGRADE	SY	261
6	REMOVE AND REPLACE ASPHALT PAVEMENT INCLUDING CURB AND STABILIZED SUBGRADE	SY	53
7	CONSTRUCT 4-FOOT DIAMETER MANHOLE	EA	4
8	CONSTRUCT 5-FOOT DIAMETER MANHOLE	EA	1
9	SAW CUTTING PAVEMENT	LF	1039
10	FURNISH, INSTALL AND IMPLEMENT TRENCH SAFETY SYSTEM	LF	2753
11	FURNISH TRENCH SAFETY DESIGN	LS	1
12	FURNISH AND INSTALL 8" PLUG	EA	1
13	FURNISH AND INSTALL 12" PLUG	EA	1
14	FURNISH AND INSTALL 15" PLUG	EA	1
15	REMOVE AND REPLACE 12" RCP CULVERT w/ HEADWALLS	LF	52

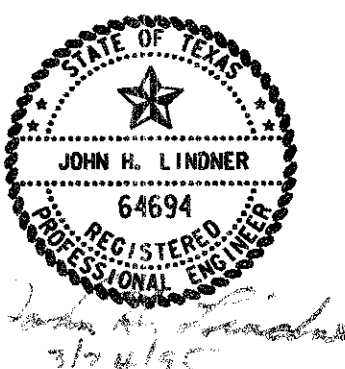

4			
3			
2			
1			
NO.	DATE	REVISION	APPROV.
TOWN OF ADDISON, TEXAS			
MIDWAY/BELTLINE SANITARY SEWER			
GENERAL NOTES			
Carter & Burgess <small>Consultants in Engineering, Architecture, Planning and the Environment</small> CARTER & BURGESS, INC. 7950 EMBROOK DRIVE, SUITE 250 DALLAS, TX 75247-4961			
Unit#	Soles	Date	03-23-95
Designed	D. Moore	Checked	J. Lindner
Drawn	B. Sowers	Approved	J. Lindner
		Job No.	93327601D
		Sheet	2 of 11

USER: J. AND PREL_DRAWN
 DATE: 03/21/95
 PROJECT: MIDWAY/BELTLINE SANITARY SEWER
 SHEET: 3 OF 11
 DRAWN: B. SOWERS
 CHECKED: J. LINDNER
 APPROVED: J. LINDNER
 DATE: 03/21/95

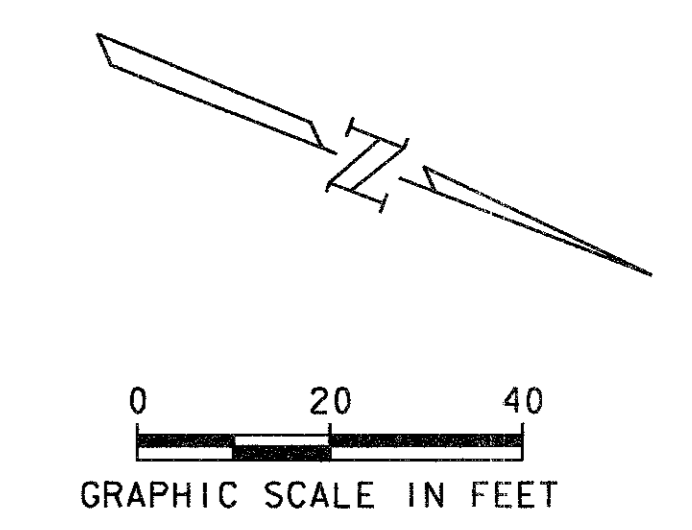
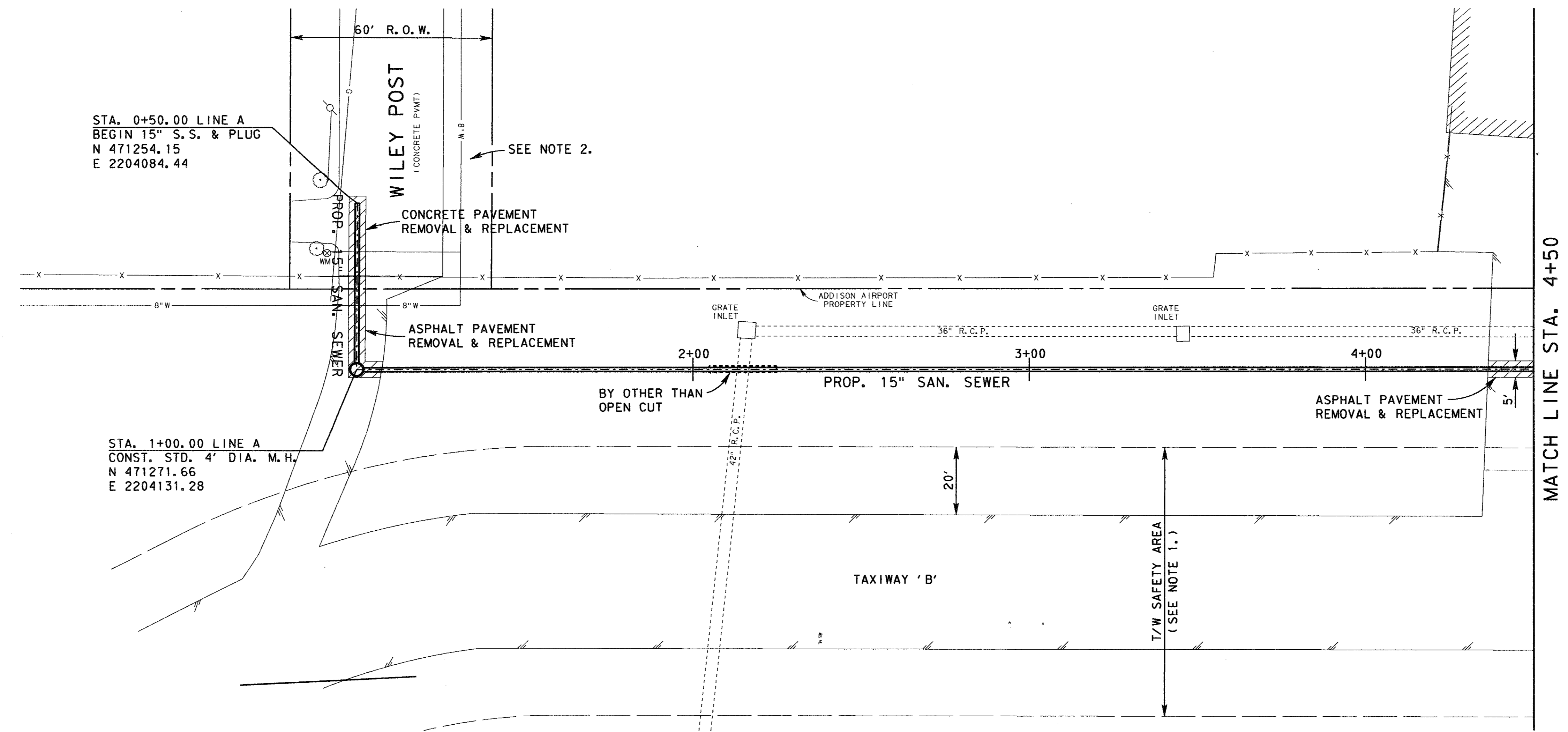

- NOTES:
- CONTRACTOR SHALL BE PROHIBITED FROM ACCESSING OR CONDUCTING ANY ACTIVITIES WITHIN THE T/W SAFETY AREA.
 - CONTRACTOR SHALL RESTRICT ACCESS TO CONSTRUCTION AREA FROM WILEY POST RD.

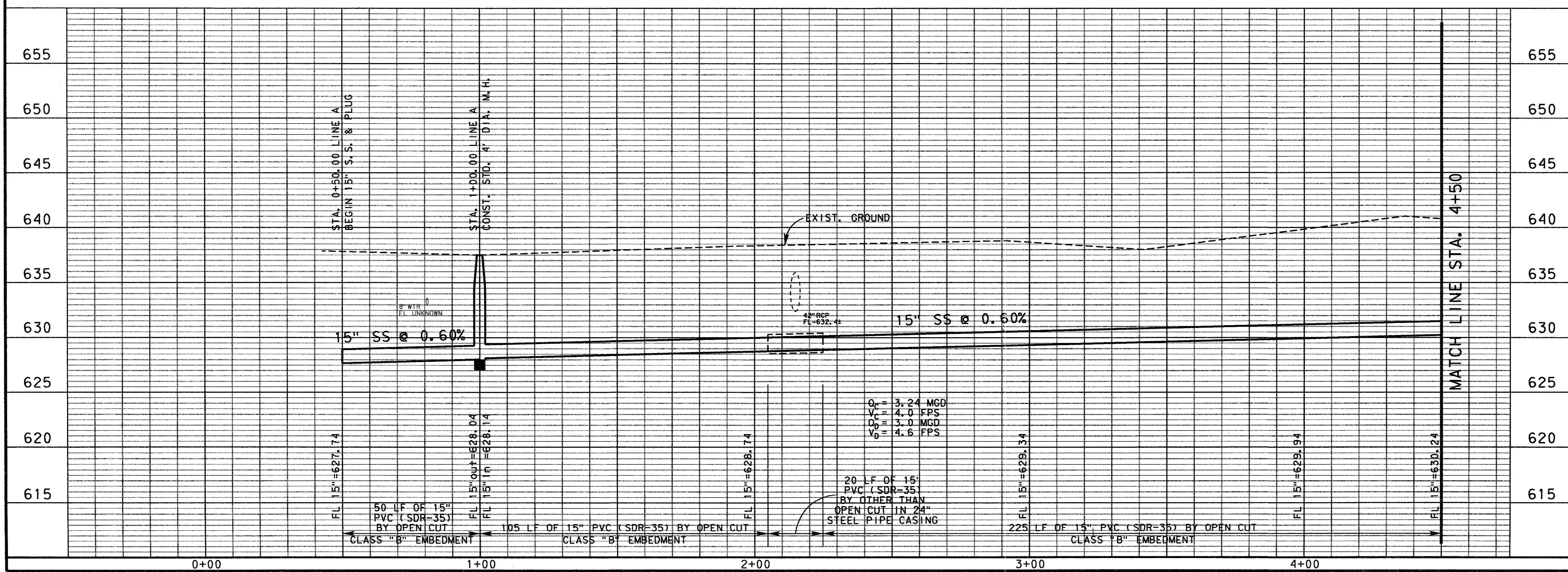

NO.	DATE	REVISION	APPROV.
4			
3			
2			
1			

TOWN OF ADDISON, TEXAS

MIDWAY/BELTLINE SANITARY SEWER
SANITARY SWR. PLAN & PROFILE
FROM STATION 0+50 TO STATION 4+50

Carter Burgess
Consultants in Engineering, Architecture,
Planning and the Environment
CARTER & BURGESS, INC.
7900 ELMBROOK DRIVE, SUITE 250
DALLAS, TX 75247-4961

Unit	Scale	Horiz. Vert.	Date
Assigned	D. Moore	Checked J. Lindner	03-23-95
Drawn	B. Sowers	Approved J. Lindner	Job No. 933276010
			Sheet 3 of 11

3276e21.DGN

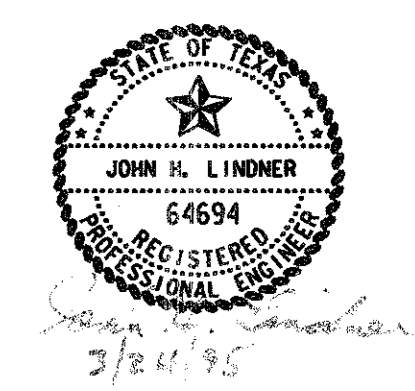

USER: I:\NO_PRF_USER\...
 DATE: 11-22-89
 TIME: 11:45 AM

DN = 1-83
 DN = 1-19, 27-89
 DN = 00

LEON
 : SHEET
 : PROFILE
 : SHEET
 : PROFILE

LEVELS DN = 1-82
 DN = 00
 DN = 00
 DN = 00

FILE: I:\NO_PRF_USER\...
 DATE: 11-22-89
 TIME: 11:45 AM

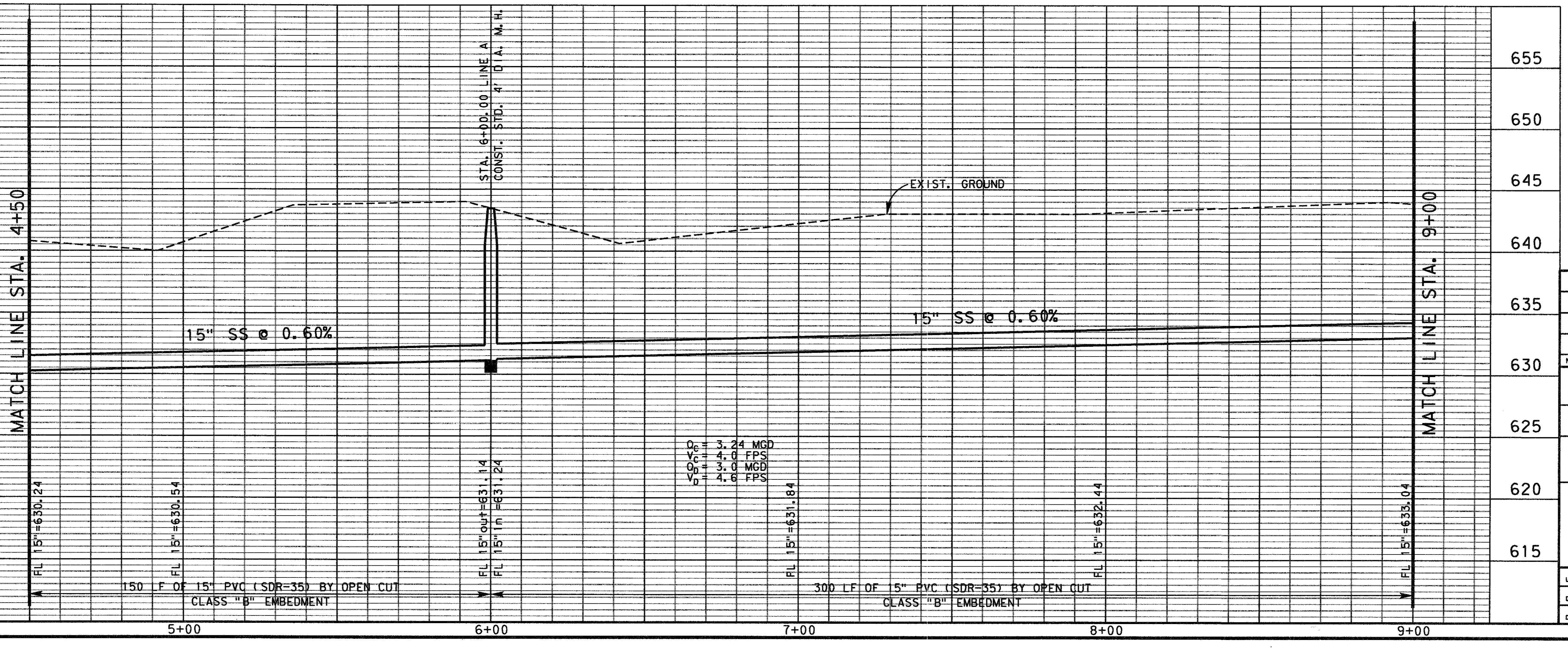
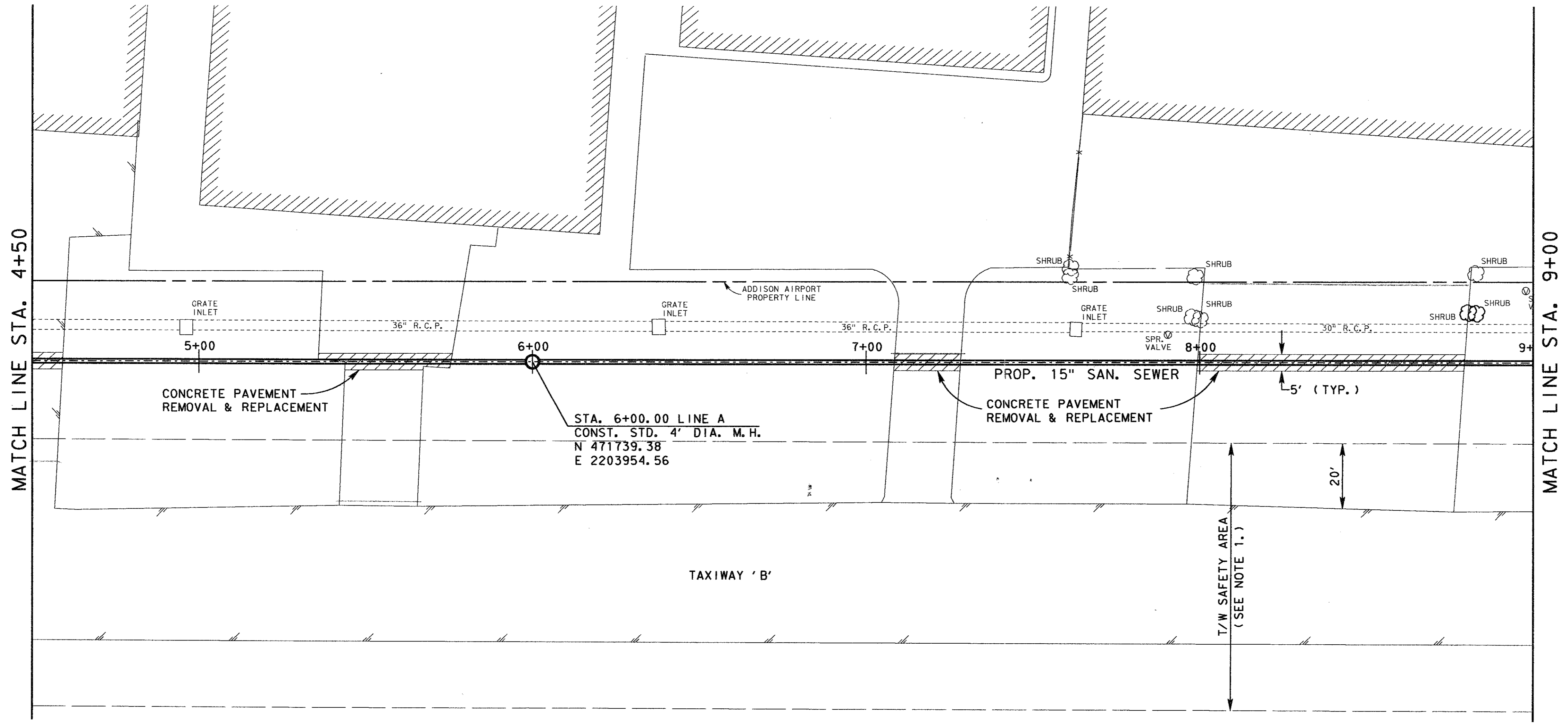

NOTES:

- CONTRACTOR SHALL BE PROHIBITED FROM ACCESSING OR CONDUCTING ANY ACTIVITIES WITHIN THE T/W SAFETY AREA.
- CONTRACTOR SHALL RESTRICT ACCESS TO CONSTRUCTION AREA FROM WILEY POST RD.

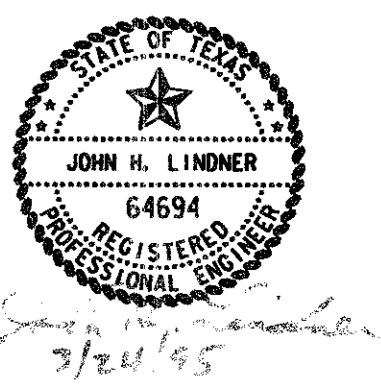

NO.	DATE	REVISION	APPROV.
4			
3			
2			
1			

TOWN OF ADDISON, TEXAS
 MIDWAY/BELTLINE SANITARY SEWER
 SANITARY SWR. PLAN & PROFILE
 FROM STATION 4+50 TO STATION 9+00

Carter-Burgess
 Consultants in Engineering, Architecture,
 Planning and the Environment
 CARTER & BURGESS, INC.
 7950 ELMBROOK DRIVE, SUITE 250
 DALLAS, TX 75247-4963

Unit	Scale	Hor. 1" = 20' Ver. 1" = 5'	Date	03-23-95	
Designed	D. Moore	Checked	J. Lindner	Job No.	93327601D
Drawn	B. Sowels	Approved	J. Lindner	Sheet	4 of 11

3276ss22.DGN

SEE: AND JOINTS
 THE: 11-14-27-89
 3276623.DGN

ON: 1-83
 ON: 1-14-27-89
 ON: 1-14-27-89

ALON
 PROFILE

3276623.DGN
 3276623.DGN
 3276623.DGN

LEVELS ON: 1-83
 ON: 1-83
 ON: 1-83
 ON: 1-83

3276623.DGN
 3276623.DGN
 3276623.DGN
 3276623.DGN

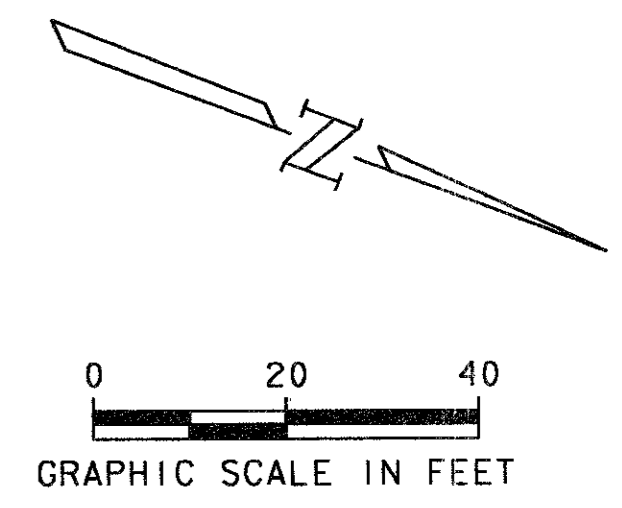
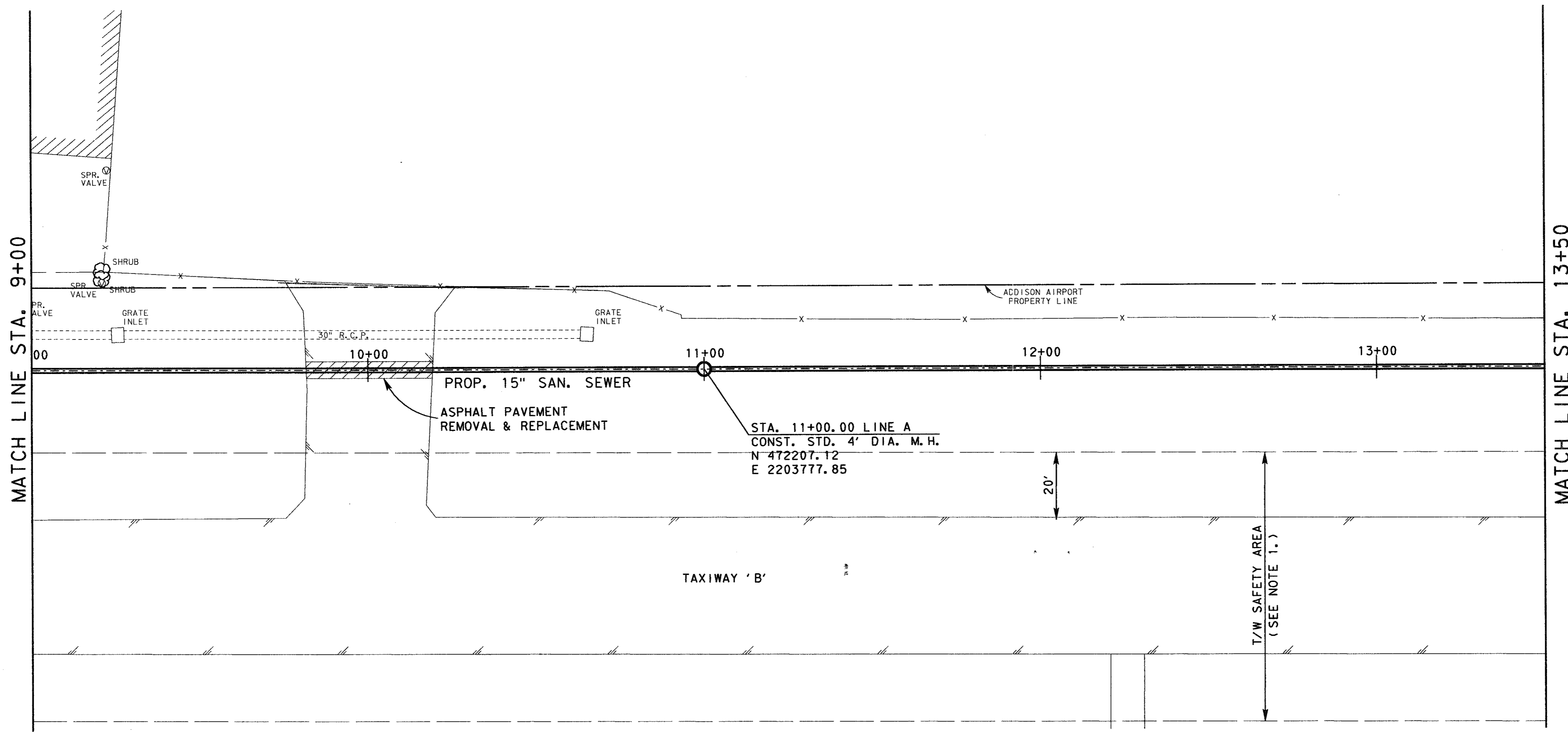

- NOTES:
1. CONTRACTOR SHALL BE PROHIBITED FROM ACCESSING OR CONDUCTING ANY ACTIVITIES WITHIN THE T/W SAFETY AREA.
 2. CONTRACTOR SHALL RESTRICT ACCESS TO CONSTRUCTION AREA FROM WILEY POST RD.

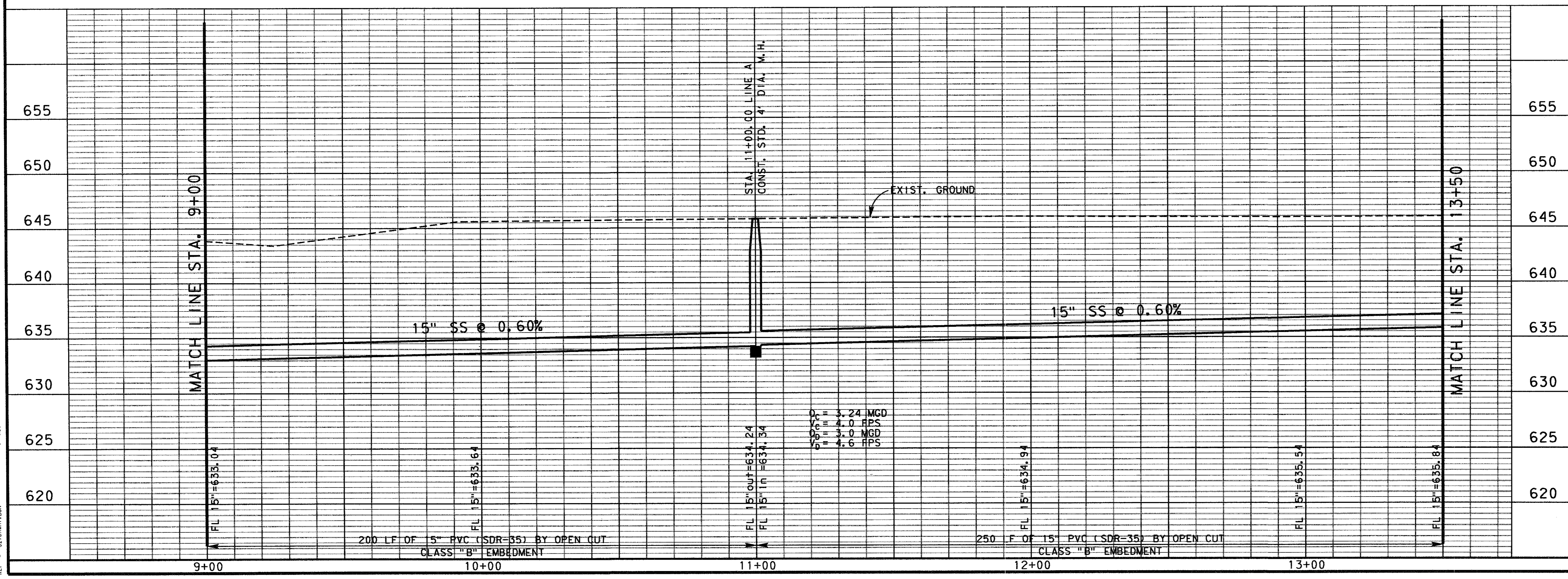

NO.	DATE	REVISION	APPROV.
4			
3			
2			
1			

TOWN OF ADDISON, TEXAS
 MIDWAY/BELTLINE SANITARY SEWER
 SANITARY SWR. PLAN & PROFILE
 FROM STATION 9+00 TO STATION 13+50

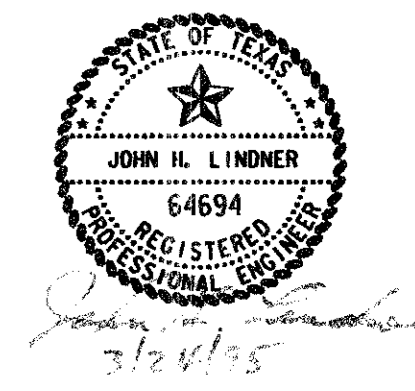

Carter Burgess
 Consultants in Engineering, Architecture,
 Planning and the Environment
 CARTER & BURGESS, INC.
 7950 EMBROOK DRIVE, SUITE 250
 DALLAS, TX 75247-4961

Unit	Scale	Horiz. Vert.	Date
Designed	D. Moore	1"=20' 1"=5'	03-23-95
Drawn	B. Sowis	Checked	J. Lindner
Approved	J. Lindner	Job No.	93327601D
Sheet	5	of	11

USER: J AND PRO-JUSEM
 DATE: 03/24/15
 PROJECT: MIDWAY/BELTLINE SANITARY SEWER
 SHEET: 6 OF 11
 DRAWN BY: B. SOWELS
 CHECKED BY: J. LINDNER
 APPROVED BY: J. LINDNER
 DATE: 03-23-15
 JOB NO.: 93327601D
 SHEET NO.: 6 OF 11
 PROJECT NO.: 3276SS24.DGN

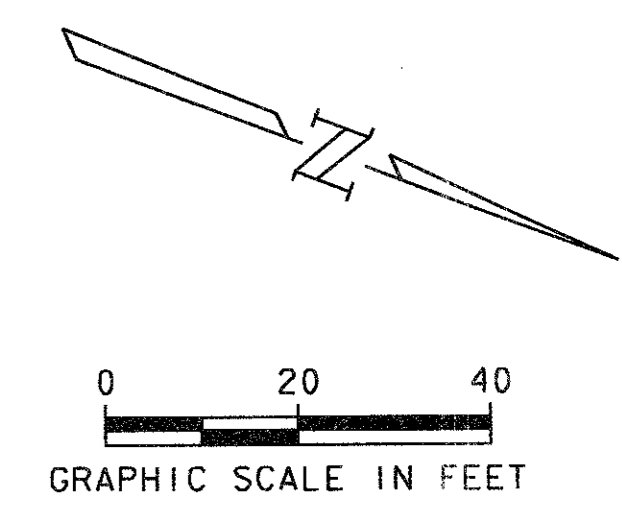
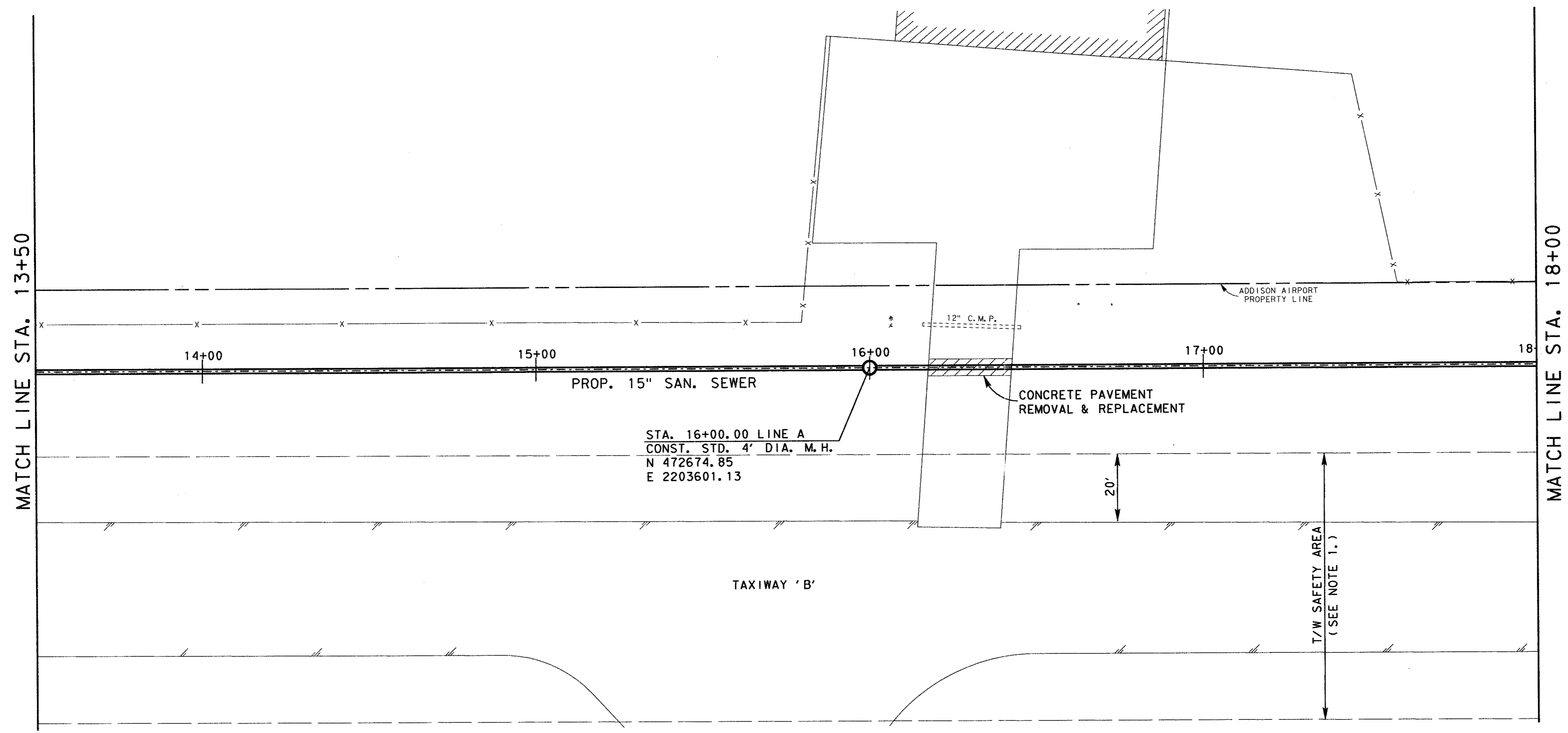

- NOTES:
- CONTRACTOR SHALL BE PROHIBITED FROM ACCESSING OR CONDUCTING ANY ACTIVITIES WITHIN THE T/W SAFETY AREA.
 - CONTRACTOR SHALL RESTRICT ACCESS TO CONSTRUCTION AREA FROM WILEY POST RD.

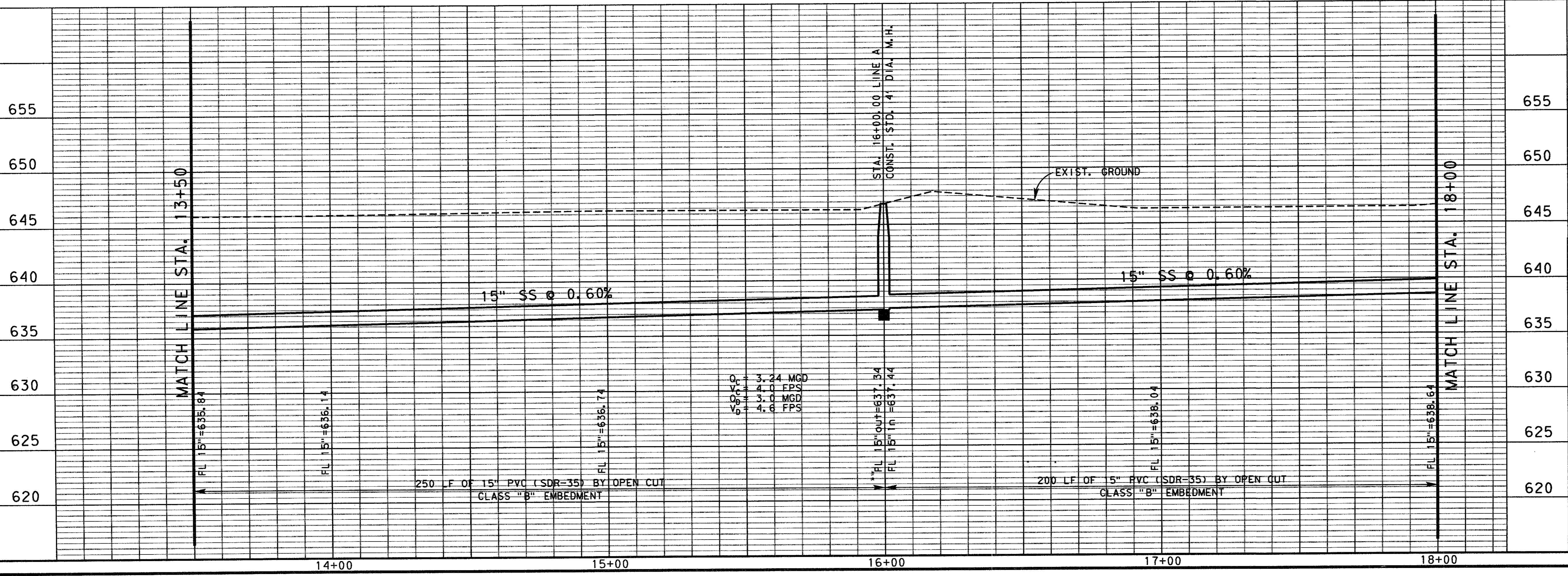

NO.	DATE	REVISION	APPROV.
4			
3			
2			
1			

TOWN OF ADDISON, TEXAS
 MIDWAY/BELTLINE SANITARY SEWER
 SANITARY SWR. PLAN & PROFILE
 FROM STATION 13+50 TO STATION 18+00

Carter & Burgess
 Consultants in Engineering, Architecture,
 Planning and the Environment
 CARTER & BURGESS, INC.
 7950 ELMBROOK DRIVE, SUITE 250
 DALLAS, TX 75247-4961

Unit	Scale	Horiz. 1"=20'	Vert. 1"=5'	Date	03-23-15
Designed	D. Moore	Checked	J. Lindner	Job No.	93327601D
Drawn	B. Sowels	Approved	J. Lindner	Sheet	6 of 11

3276SS24.DGN

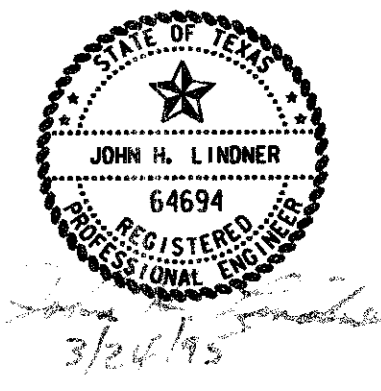

USER: JWD PRELIMINARY
 FILE: J:\PROJECTS\ADDISON\PLAN\18-22\18-22-95.DWG
 DATE: 3/24/95

DN = 1:80
 DN = 1:16.25-89

ALIGN
 PROFILE

3276601.DWG
 3276601.DWG
 3276601.DWG

LEVELS ON: 1:80
 DN: 1:80
 DN: 1:80

3276601.DWG
 3276601.DWG
 3276601.DWG
 3276601.DWG

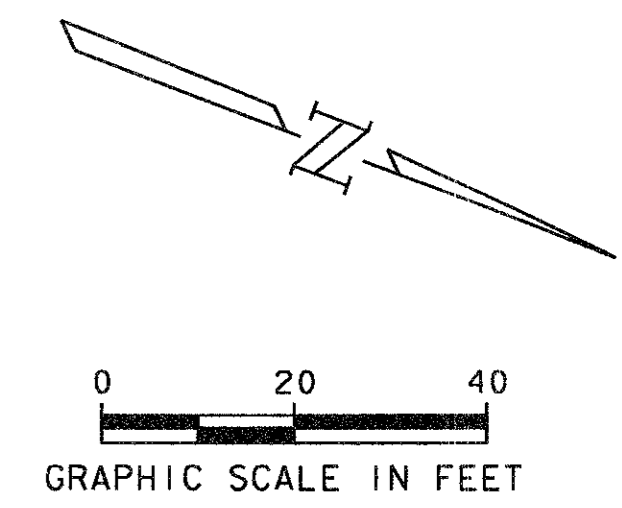
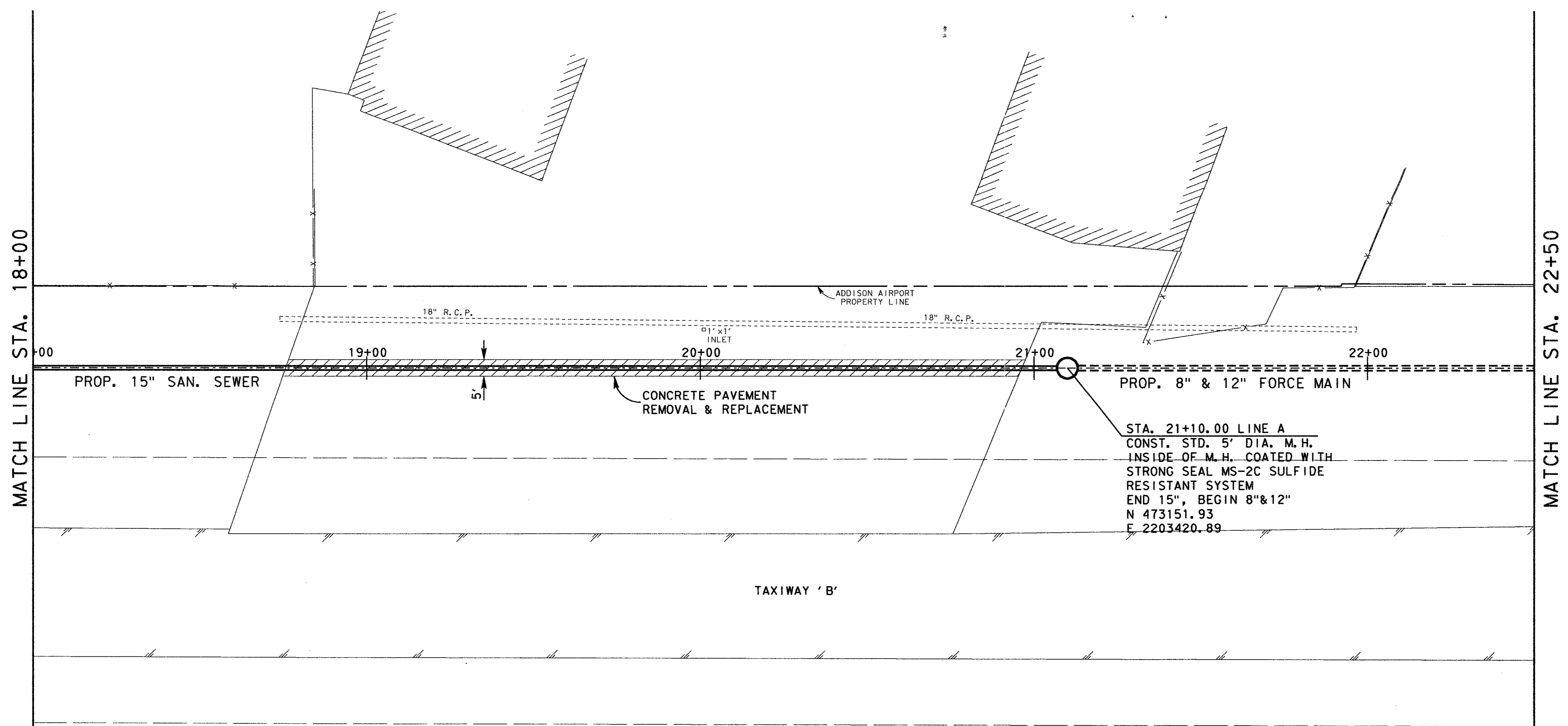

NOTES:

- CONTRACTOR SHALL BE PROHIBITED FROM ACCESSING OR CONDUCTING ANY ACTIVITIES WITHIN THE T/W SAFETY AREA.
- CONTRACTOR SHALL RESTRICT ACCESS TO CONSTRUCTION AREA FROM WILEY POST RD.

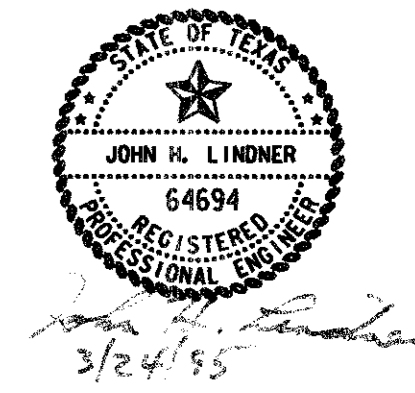
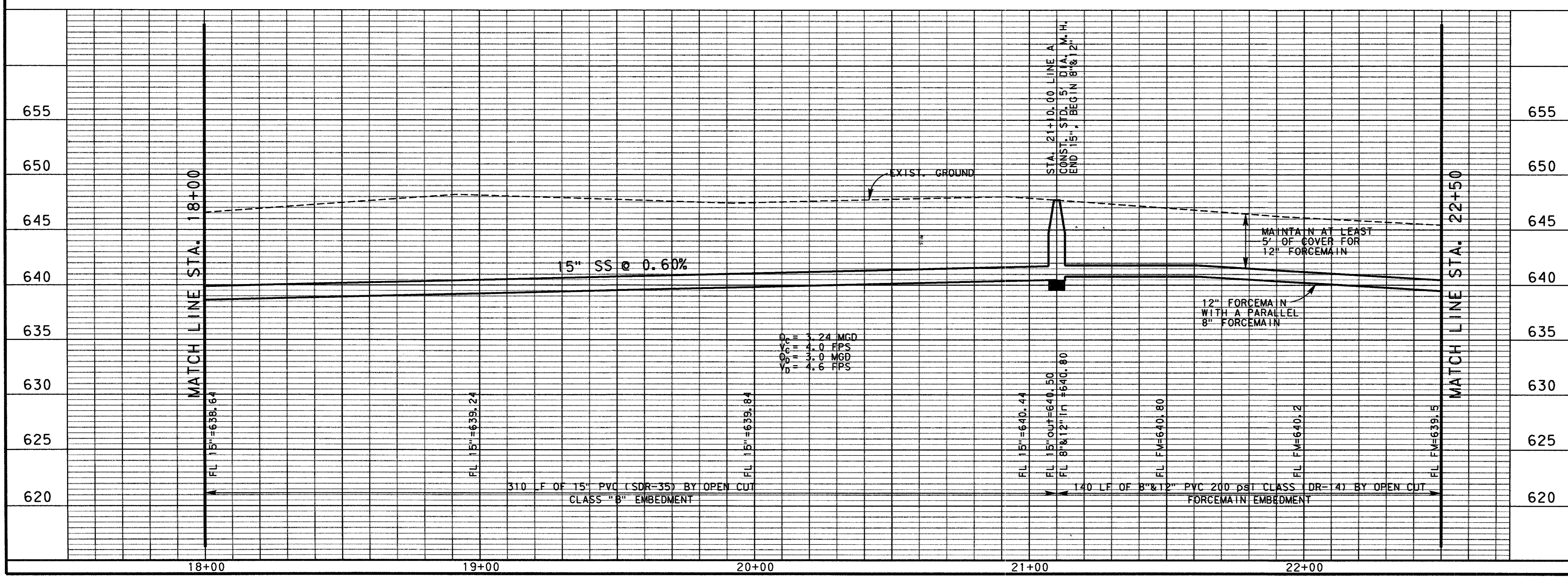

NO.	DATE	REVISION	APPROV.
4			
3			
2			
1			

TOWN OF ADDISON, TEXAS
 MIDWAY/BELTLINE SANITARY SEWER
 SANITARY SWR. PLAN & PROFILE
 FROM STATION 18+00 TO STATION 22+50

Carter Burgess
 Consultants in Engineering, Architecture,
 Planning and the Environment
 CARTER & BURGESS, INC.
 7950 EMBROOK DRIVE, SUITE 250
 DALLAS, TX 75247-4960

Unit	Scale	Hor: 1"=20'	Vert: 1"=5'	Date	03-23-95
Designed	D. Moore	Checked	J. Lindner	Job No.	93327601D
Drawn	B. Sowis	Approved	J. Lindner	Sheet	7 of 11

3276601.DWG

SEE PLAN SHEET 3276SS26 FOR ADDITIONAL INFORMATION
 REFERENCE TO SHEETS 3276SS26, 3276SS27, 3276SS28, 3276SS29, 3276SS30, 3276SS31, 3276SS32, 3276SS33, 3276SS34, 3276SS35, 3276SS36, 3276SS37, 3276SS38, 3276SS39, 3276SS40, 3276SS41, 3276SS42, 3276SS43, 3276SS44, 3276SS45, 3276SS46, 3276SS47, 3276SS48, 3276SS49, 3276SS50, 3276SS51, 3276SS52, 3276SS53, 3276SS54, 3276SS55, 3276SS56, 3276SS57, 3276SS58, 3276SS59, 3276SS60, 3276SS61, 3276SS62, 3276SS63, 3276SS64, 3276SS65, 3276SS66, 3276SS67, 3276SS68, 3276SS69, 3276SS70, 3276SS71, 3276SS72, 3276SS73, 3276SS74, 3276SS75, 3276SS76, 3276SS77, 3276SS78, 3276SS79, 3276SS80, 3276SS81, 3276SS82, 3276SS83, 3276SS84, 3276SS85, 3276SS86, 3276SS87, 3276SS88, 3276SS89, 3276SS90, 3276SS91, 3276SS92, 3276SS93, 3276SS94, 3276SS95, 3276SS96, 3276SS97, 3276SS98, 3276SS99, 3276SS00

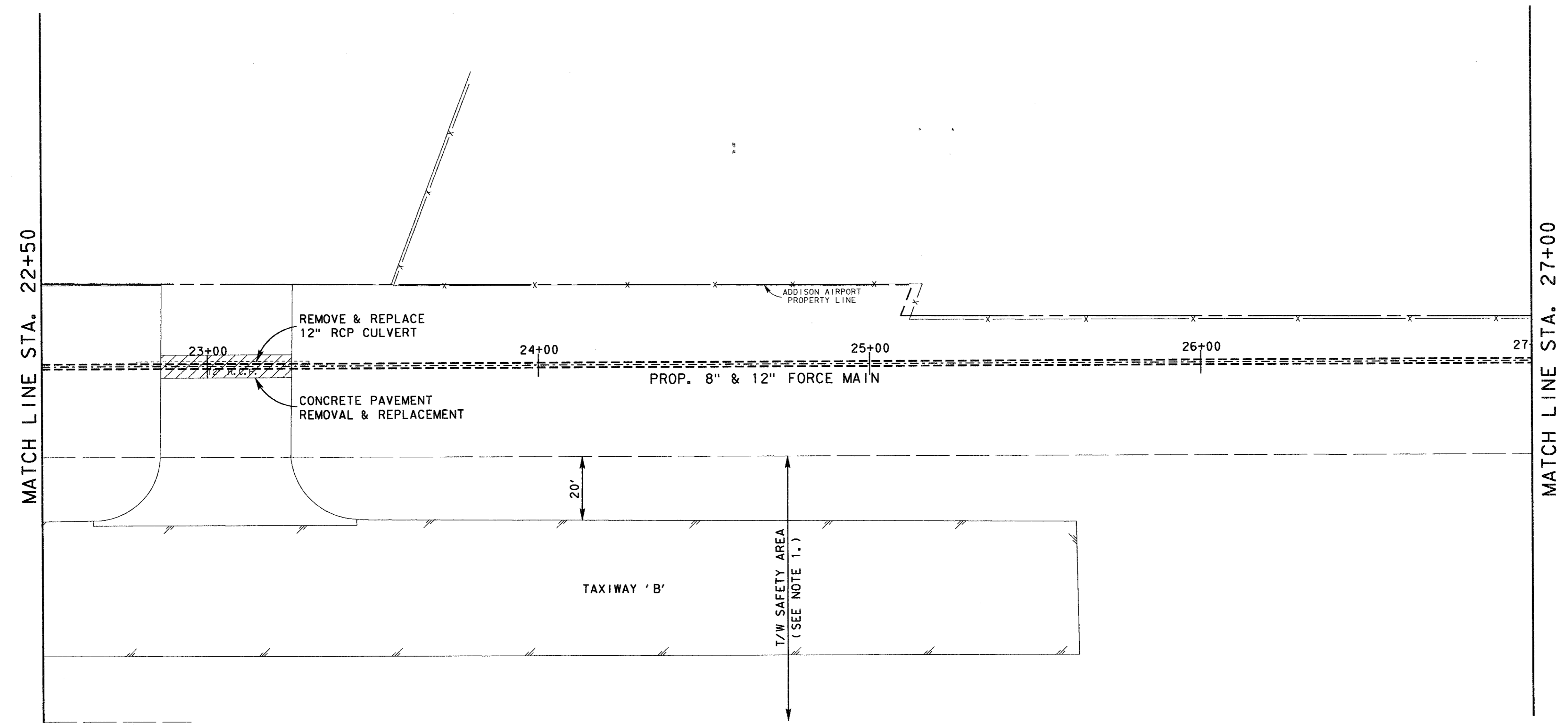
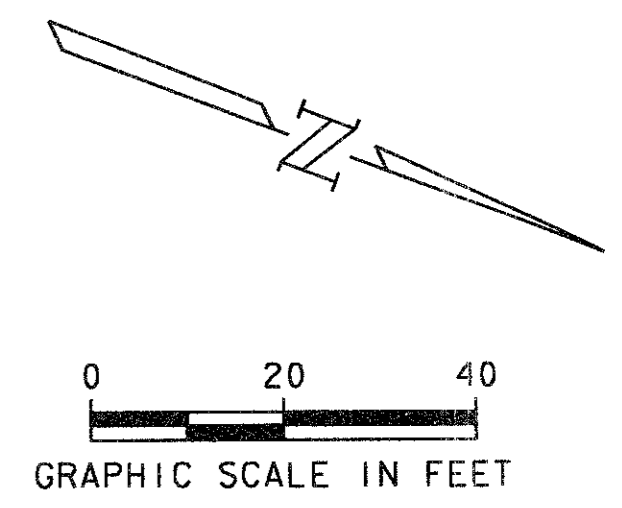

- NOTES:
1. CONTRACTOR SHALL BE PROHIBITED FROM ACCESSING OR CONDUCTING ANY ACTIVITIES WITHIN THE T/W SAFETY AREA.
 2. CONTRACTOR SHALL RESTRICT ACCESS TO CONSTRUCTION AREA FROM WILEY POST RD.

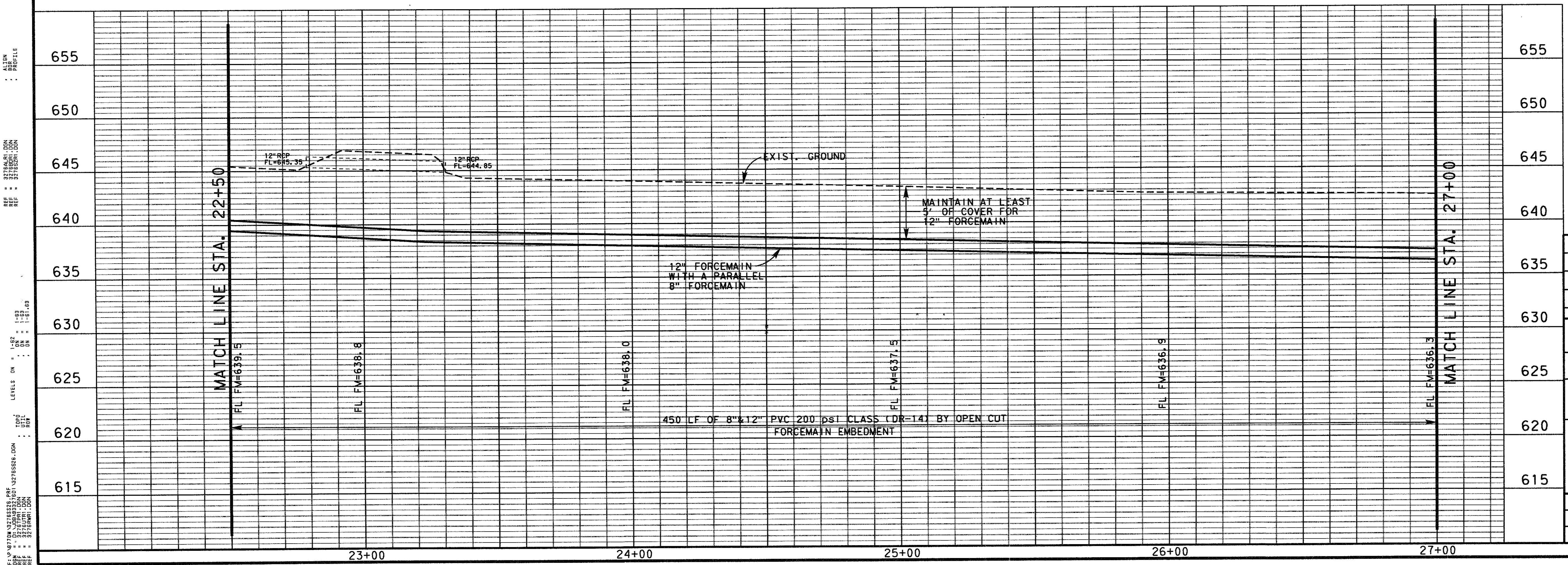

4			
3			
2			
1			
NO.	DATE	REVISION	APPROV.

TOWN OF ADDISON, TEXAS
 MIDWAY/BELTLINE SANITARY SEWER
 SANITARY SWR. PLAN & PROFILE
 FROM STATION 22+50 TO STATION 27+00

Carter & Burgess
 Consultants in Engineering, Architecture,
 Planning and the Environment
 CARTER & BURGESS, INC.
 7950 ELMBROOK DRIVE, SUITE 250
 DALLAS, TX 75247-4961

Unit	Scale	Hor. 1" = 20' Ver. 1" = 5'	Date	03-23-95	
Designed	D. Moore	Checked	J. Lindner	Job No.	93327601D
Drawn	B. Sowell	Approved	J. Lindner	Sheet	8 of 11

3276ss26.DGN

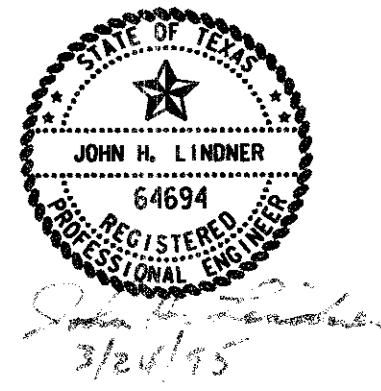

DESIGNER: J. LINDNER
 DATE: 1-19-95
 PROJECT: AIRPORT

DATE: 1-19-95
 PROJECT: AIRPORT

DATE: 1-19-95
 PROJECT: AIRPORT

DATE: 1-19-95
 PROJECT: AIRPORT

DATE: 1-19-95
 PROJECT: AIRPORT

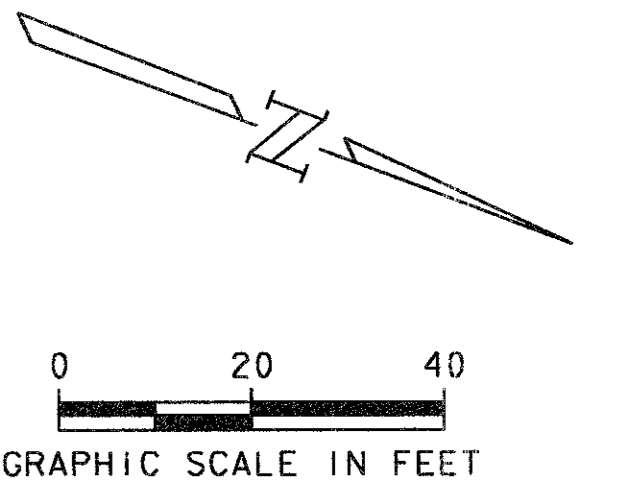
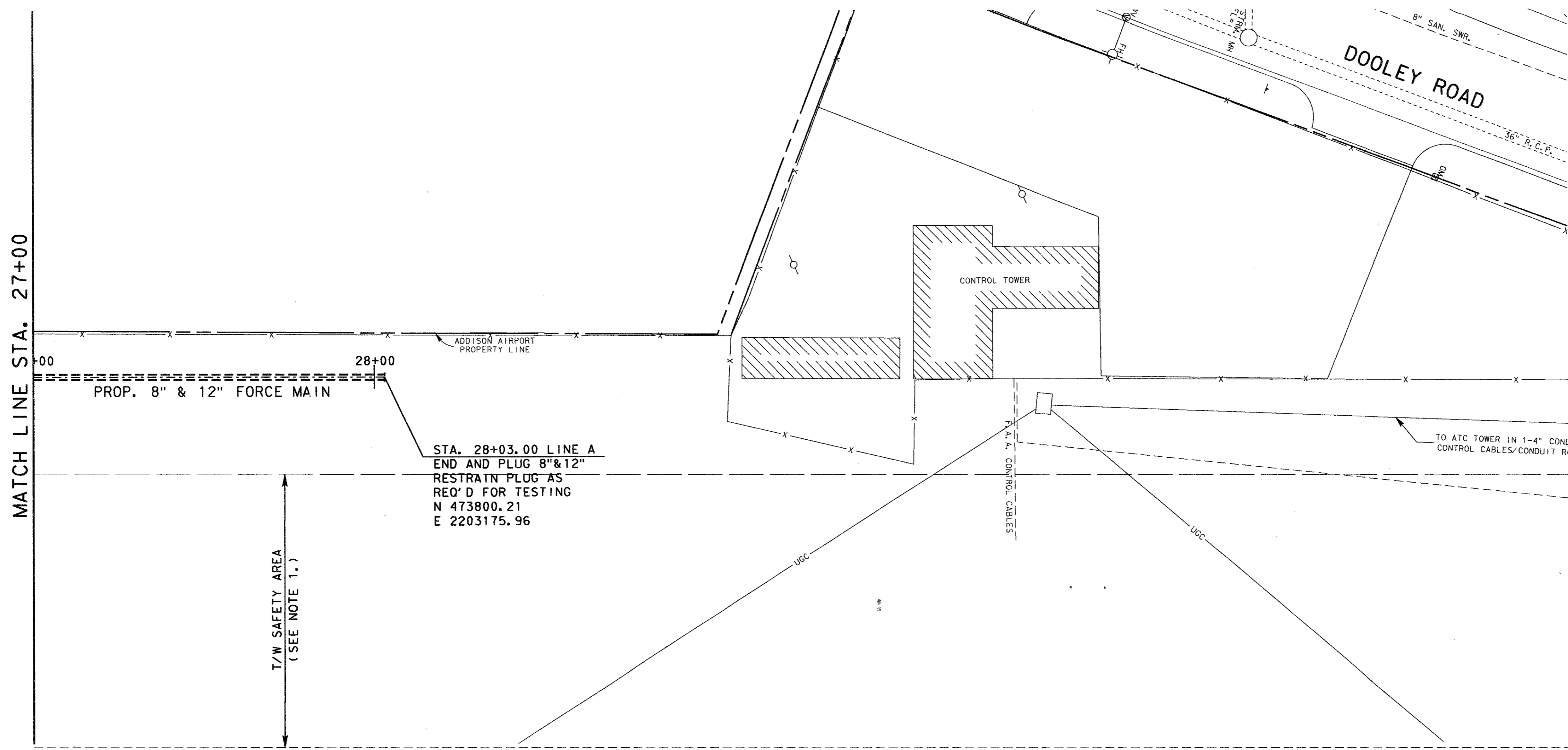

- NOTES:
1. CONTRACTOR SHALL BE PROHIBITED FROM ACCESSING OR CONDUCTING ANY ACTIVITIES WITHIN THE T/W SAFETY AREA.
 2. CONTRACTOR SHALL RESTRICT ACCESS TO CONSTRUCTION AREA FROM WILEY POST RD.

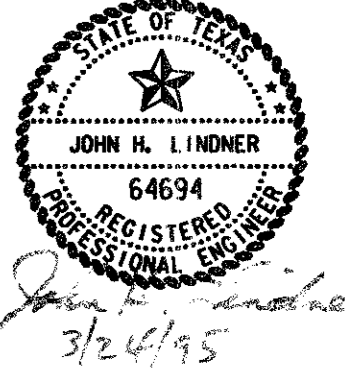
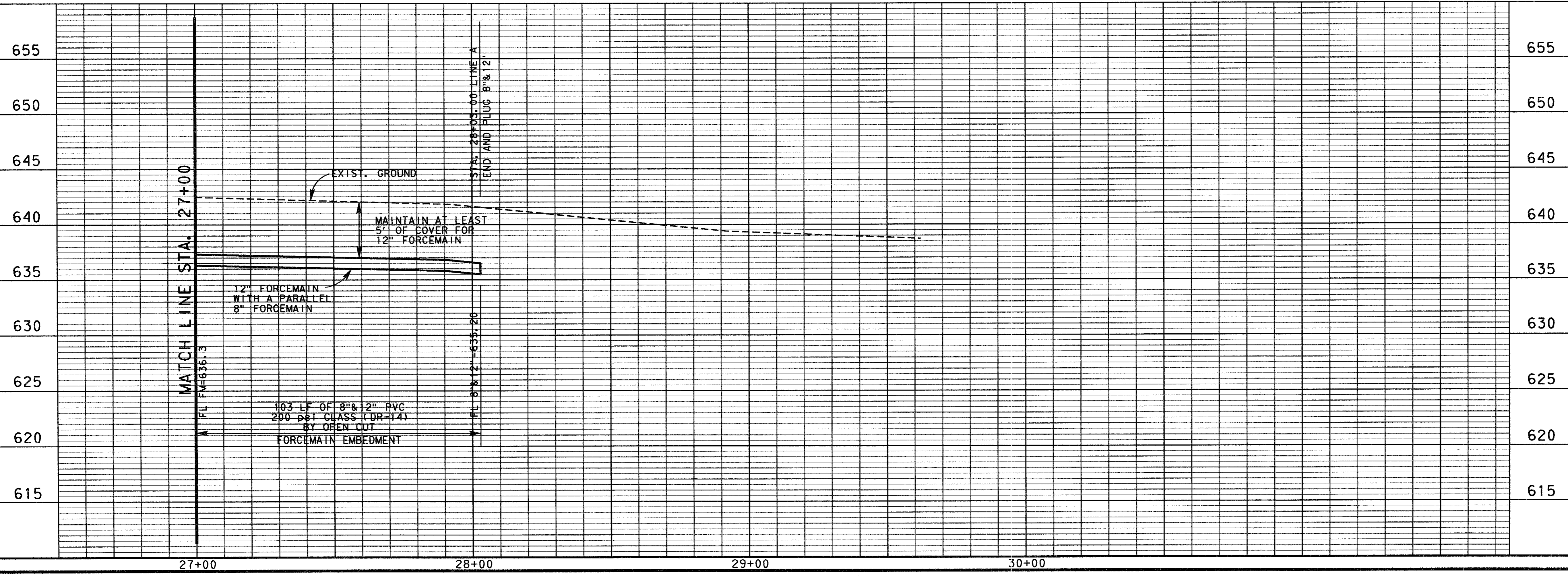

NO.	DATE	REVISION	APPROV.
4			
3			
2			
1			

TOWN OF ADDISON, TEXAS
MIDWAY/BELTLINE SANITARY SEWER
SANITARY SWR. PLAN & PROFILE
 FROM STATION 27+00 TO STATION 28+03

Carter Burgess
 Consultants in Engineering, Architecture,
 Planning and the Environment
 CARTER & BURGESS, INC.
 7950 EMBROOK DRIVE, SUITE 250
 DALLAS, TX 75247-4961

Unit	Scale	Hor. 1" = 20'	Vert. 1" = 5'	Date	
Designed	D. Moore	Checked	J. Lindner	Job No.	93327601D
Drawn	B. Sowis	Approved	J. Lindner	Sheet	9 of 11

3276es27.DGN

USER: JAC AND ASSOCIATES, INC. PROJECT: BELTLINE SANITARY SEWER, PHASE 1, STATION 11+00 TO 21+00, DALLAS, TEXAS. SHEET: 10 OF 11. DATE: 03-23-95.

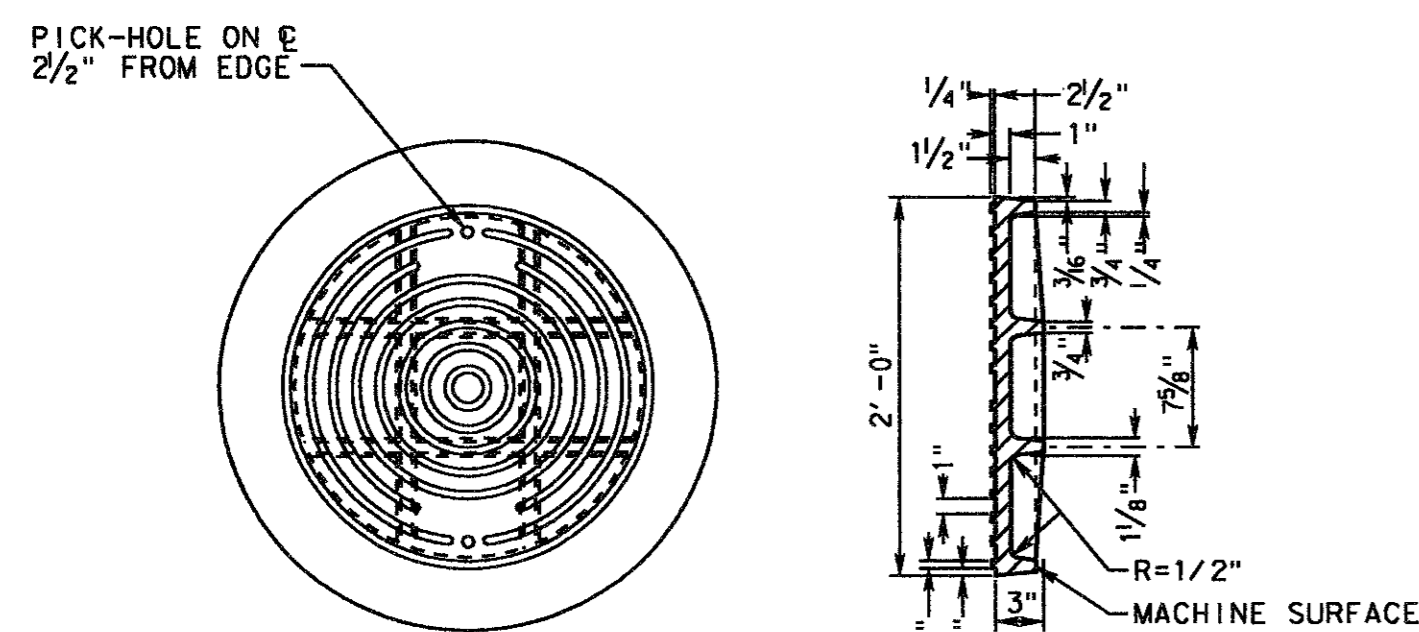

PLAN
COVER SECTION

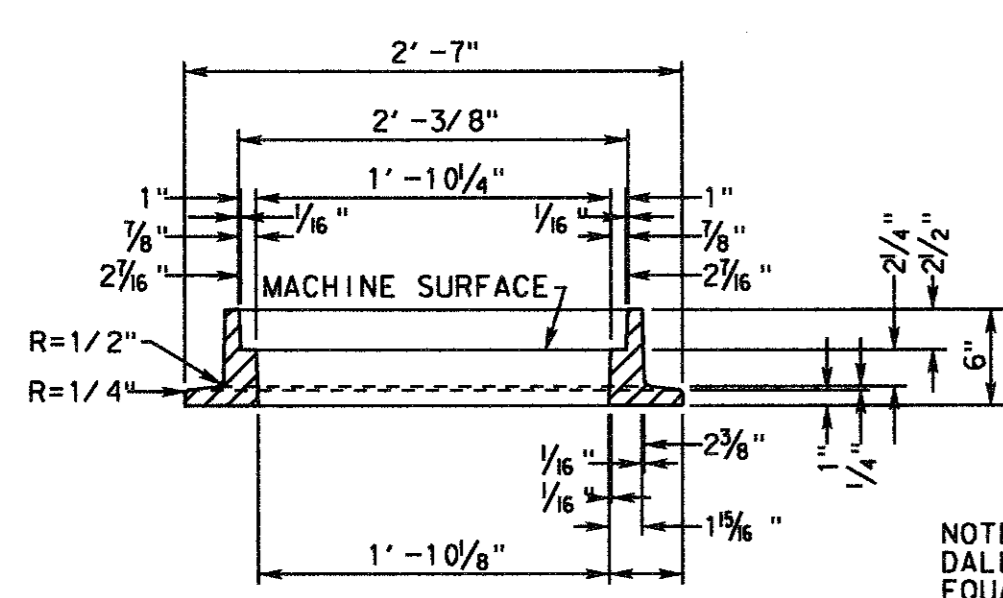

FRAME SECTION

MANHOLE COVER AND FRAME
STANDARD

NOTE:
DALLAS FOUNDRY 700-8, OR
EQUAL, 400 FRAME AND COVER.
FOR OTHER THAN STREET
LOCATIONS, 300 FRAME AND
COVER (DALLAS FOUNDRY 700-
12, OR EQUAL) MAY BE SUBSTITUTED.

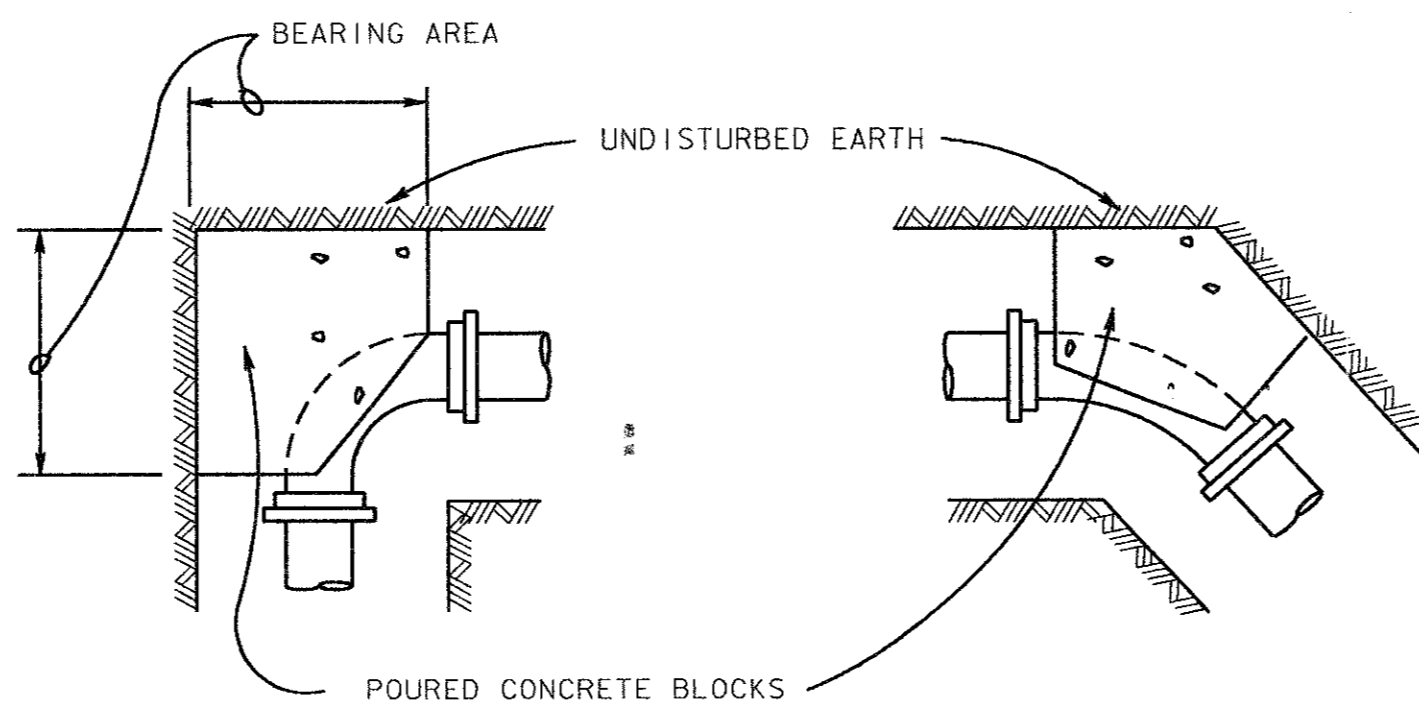

FITTING SIZES	BEARING AREA OF BLOCK IN SQ. FT.				
	TEE & END	90° BEND	45° BEND	22 1/2° BEND	11 1/4° BEND
6"	3.6	5.4	2.5	1.5	0.8
8"	6.3	8.9	4.8	2.5	1.3
10"	9.9	13.9	7.6	3.9	2.0
12"	14.2	20.0	10.9	5.6	2.8

NOTE:
AREAS BASED ON PIPE BURST PRESSURE OF 250 PSI.
SOIL BEARING PRESSURE MULTIPLIER

1000	2.0
1500	1.33
2000	1.0
3000	0.67

THRUST BLOCK DETAILS
NOT TO SCALE

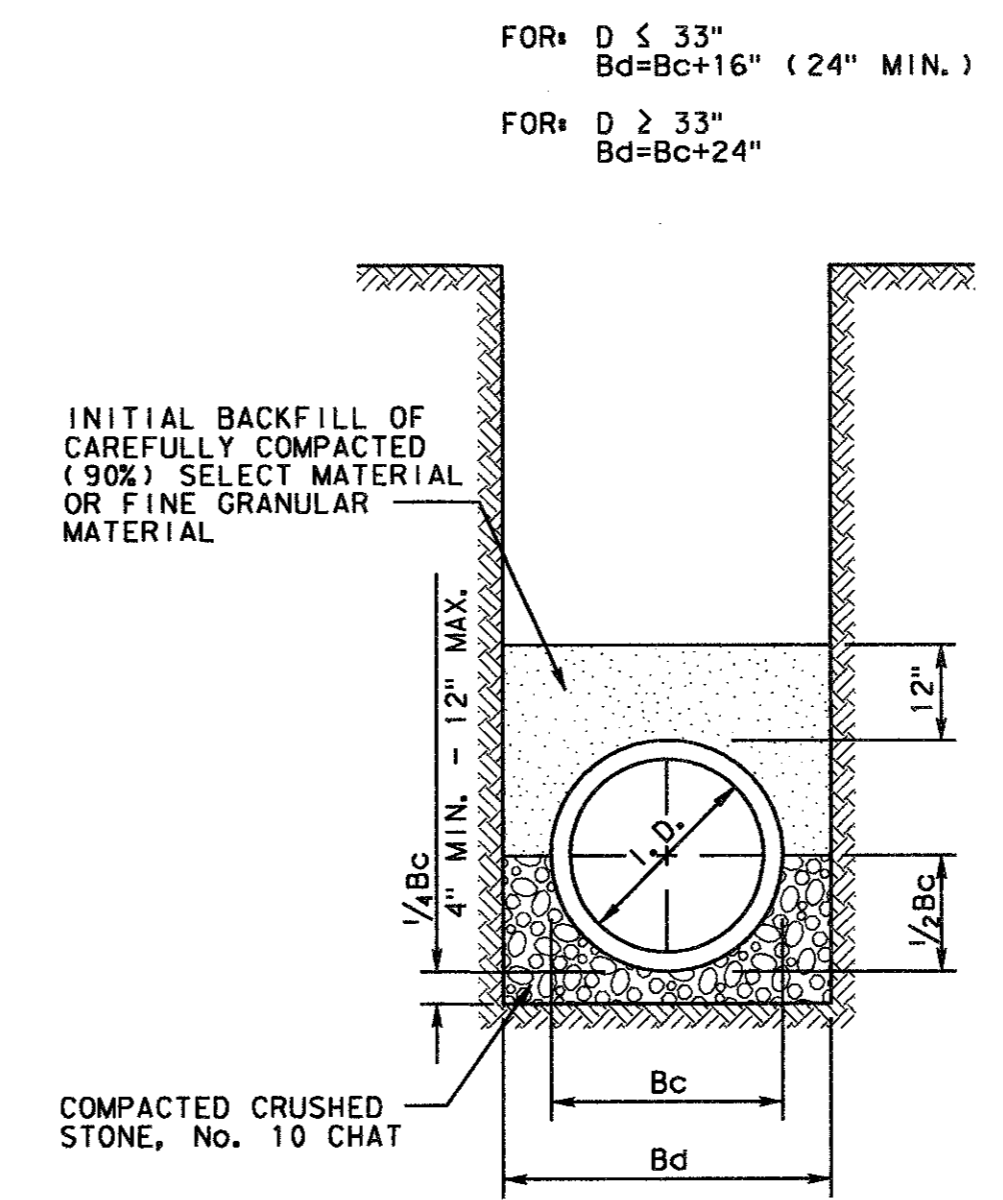

BEDDING DETAIL
CLASS "B"

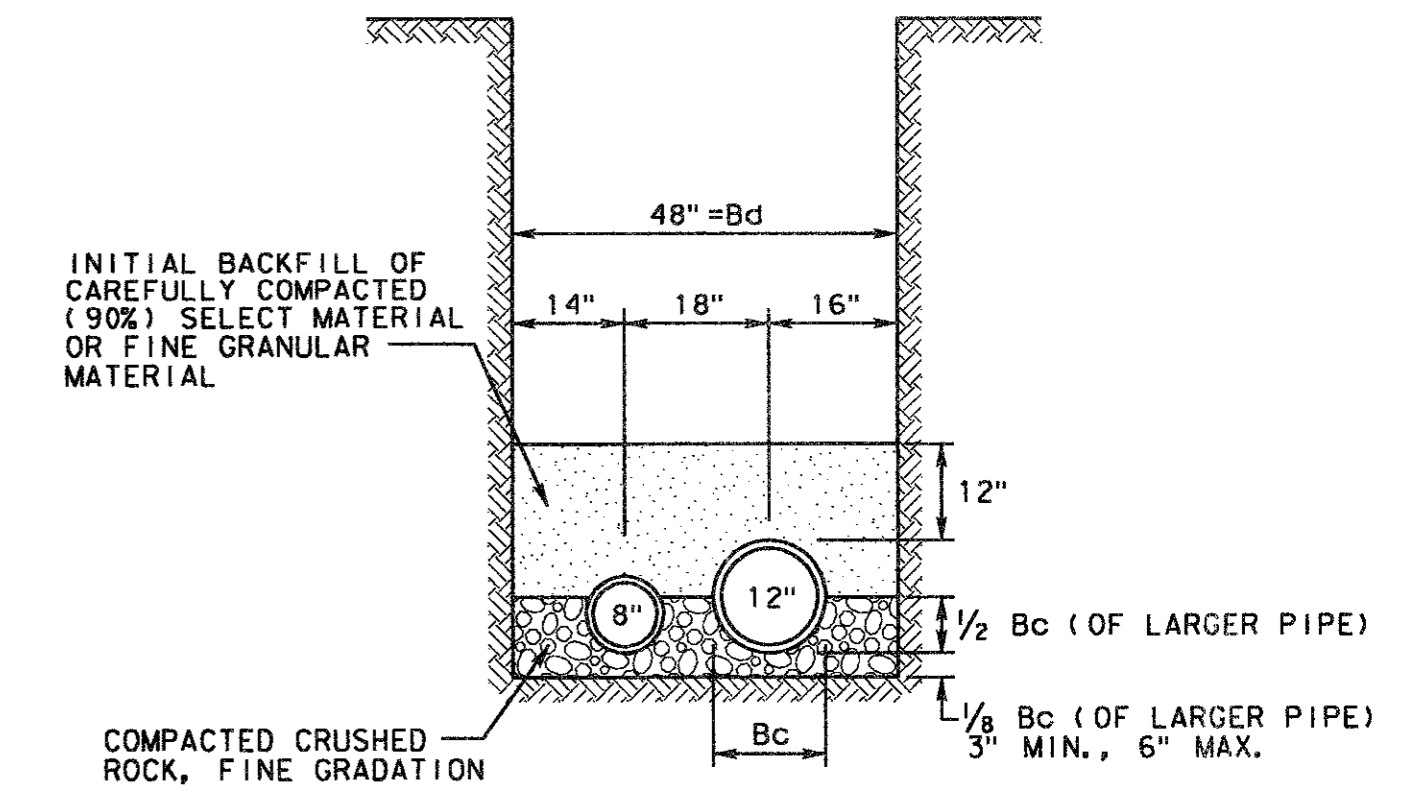

PVC FORCEMAIN
EMBEDMENT DETAIL

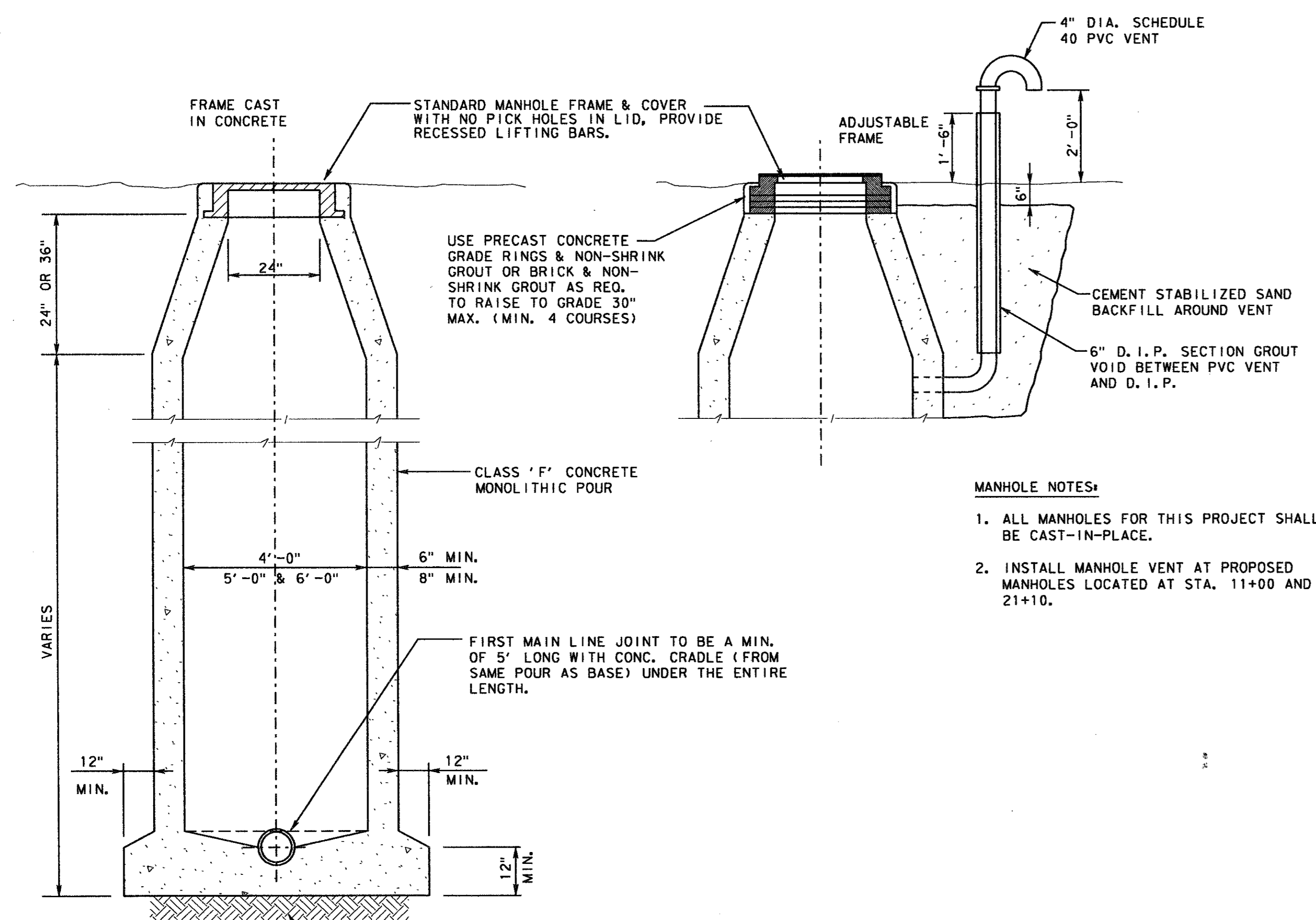

STANDARD CAST-IN-PLACE
CONCRETE MANHOLE
NOT TO SCALE

- MANHOLE NOTES:**
- ALL MANHOLES FOR THIS PROJECT SHALL BE CAST-IN-PLACE.
 - INSTALL MANHOLE VENT AT PROPOSED MANHOLES LOCATED AT STA. 11+00 AND 21+10.

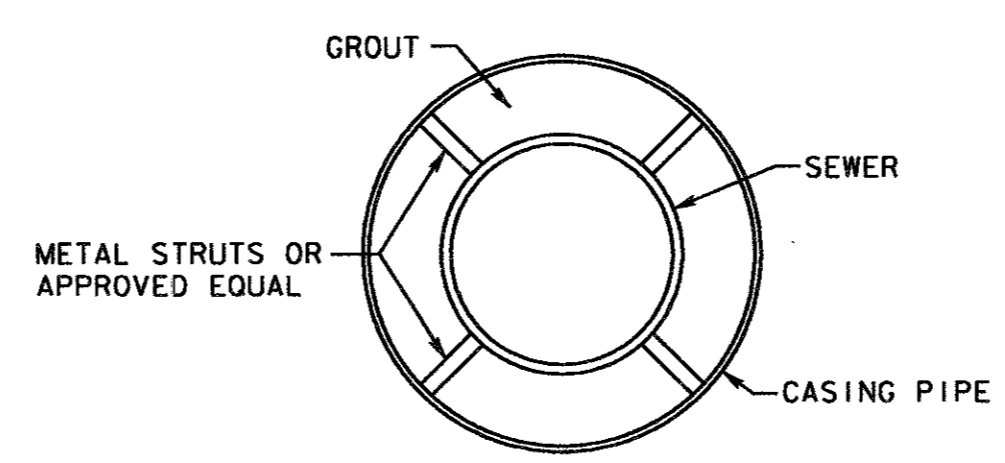

CARRIER PIPE (DIA.)	CASING PIPE (DIA.)	STEEL PIPE WALL THICKNESS
8"	16"	1/4"
12"	20"	3/8"
15"	24"	1/2"

CASING DETAIL
FOR BORING

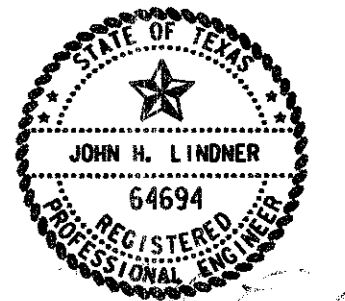

4			
3			
2			
1			
NO.	DATE	REVISION	APPROV.
TOWN OF ADDISON, TEXAS			
MIDWAY/BELTLINE SANITARY SEWER			
SANITARY SEWER DETAILS			
()			
Carter-Burgess			
<small>Consultants in Engineering, Architecture, Planning and the Environment CARTER & BURGESS, INC. 7950 ELMBROOK DRIVE, SUITE 250 DALLAS, TX 75247-4961</small>			
Unit	Scale 1" = 2'	Date	03-23-95
Designed	D. Moore	Checked	J. Lindner
Drawn	B. Sowell	Approved	J. Lindner
		Job No.	93327601D
		Sheet	10 of 11

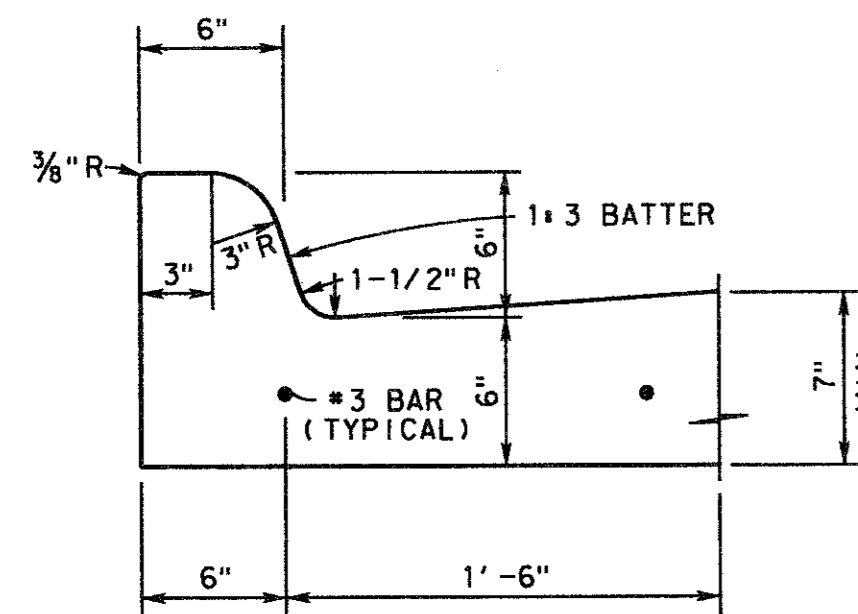

NOTE: CURB TO BE CONSTRUCTED MONOLITHIC WITH THE CONCRETE PAVEMENT AND PLACED ON THE SAME GRADE AND ELEVATION AS THE EXISTING CURB.

MATCH EXISTING PAVEMENT THICKNESS IF MORE THAN 7" THICK.

6" CONCRETE CURB

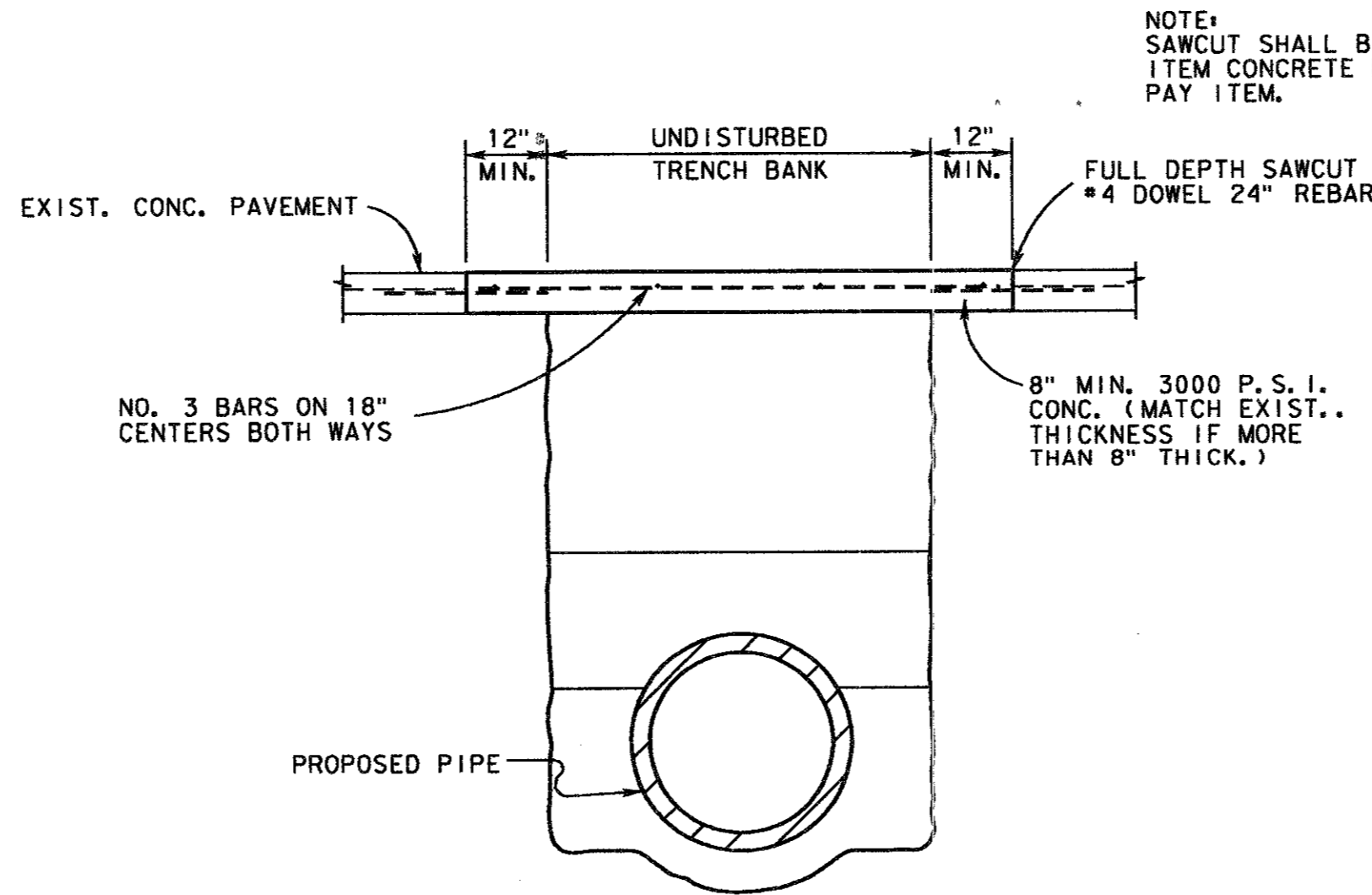

NOTE: SAWCUT SHALL BE SUBSIDIARY TO THE BID ITEM CONCRETE PAVEMENT. NO SEPERATE PAY ITEM.

CONCRETE STREET OR DRIVEWAY REPAIR

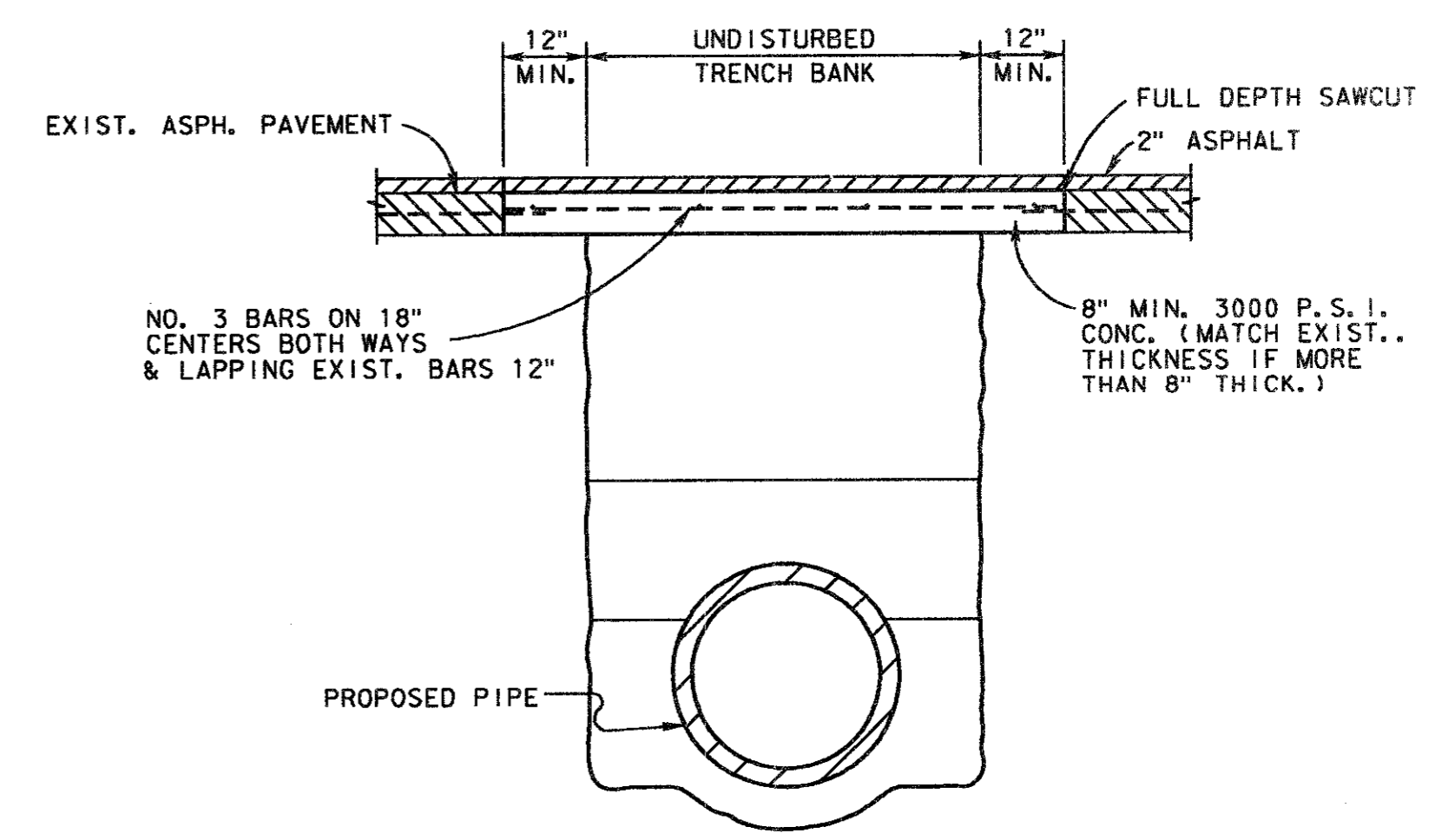

ASPHALT STREET OR DRIVEWAY REPAIR

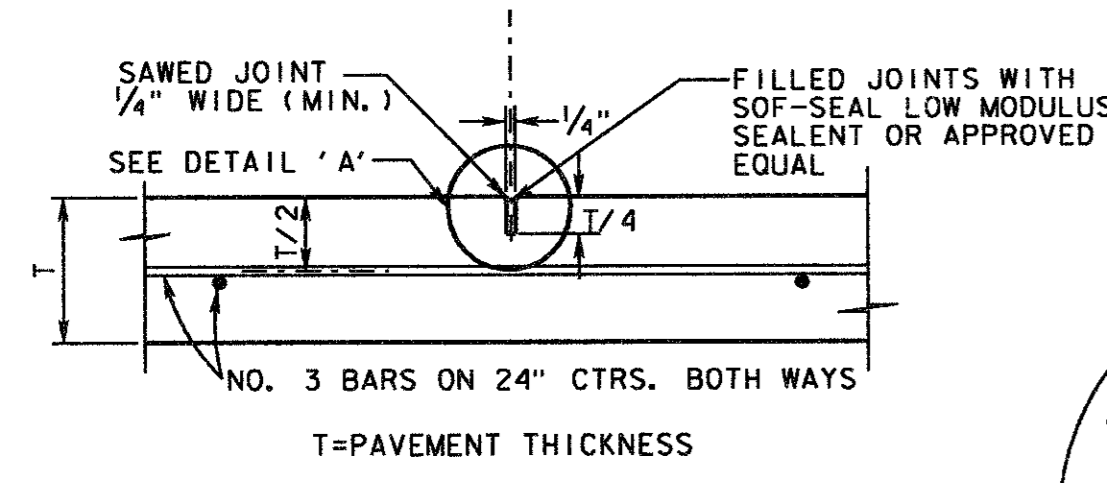

SAWED DUMMY JOINT (TRANSVERSE DUMMY JOINT TO BE SPACED 16' MIN. & 22' MAX.)

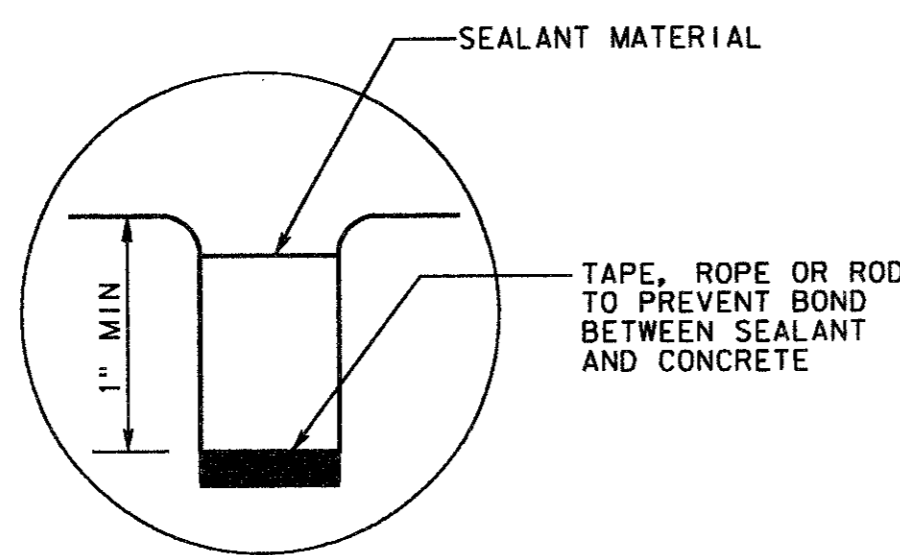

DETAIL 'A'

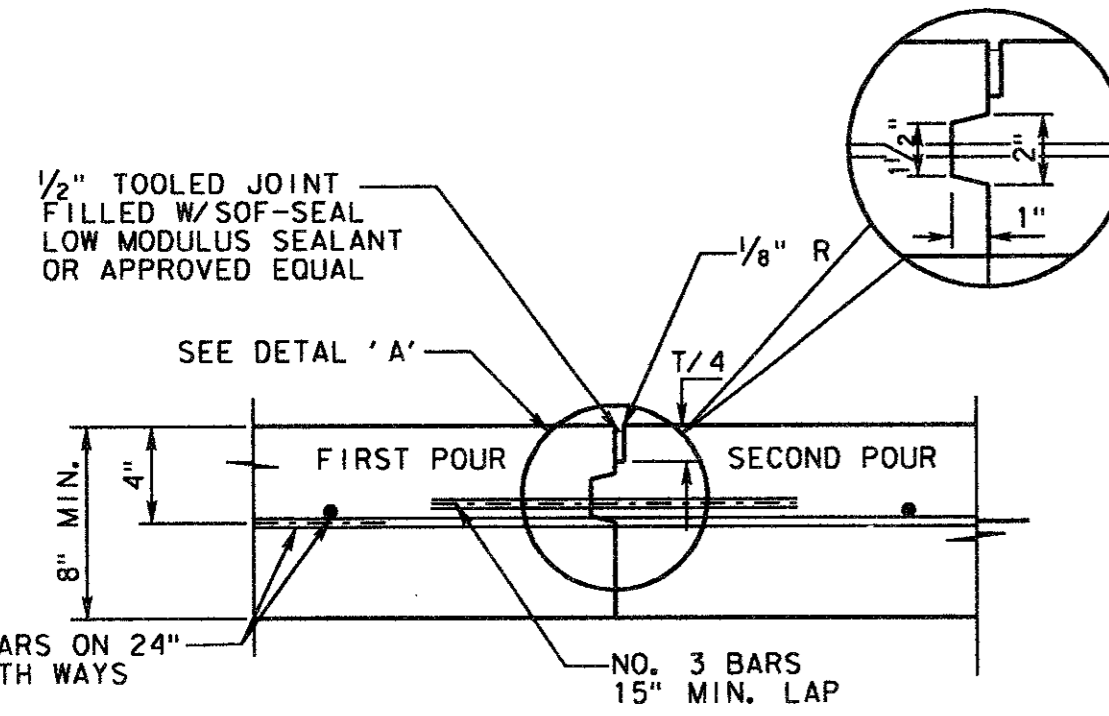

CONSTRUCTION JOINT FOR PAVEMENTS FOR 8" THICKNESS PAVEMENT AND LONGITUDINAL JOINTS

NOTE: CONTRACTOR SHALL PROTECT KEYWAY PRIOR TO SECOND POUR. IF LONGITUDINAL KEYWAY IS DAMAGED, CONTRACTOR SHALL REPAIR WITH THE USE OF LONGITUDINAL BUTT JOINT. DRILL DOWELS INTO FIRST POUR. T=PAVEMENT THICKNESS THICKENED EDGES ARE REQUIRED FOR FUTURE WIDENING ONLY.

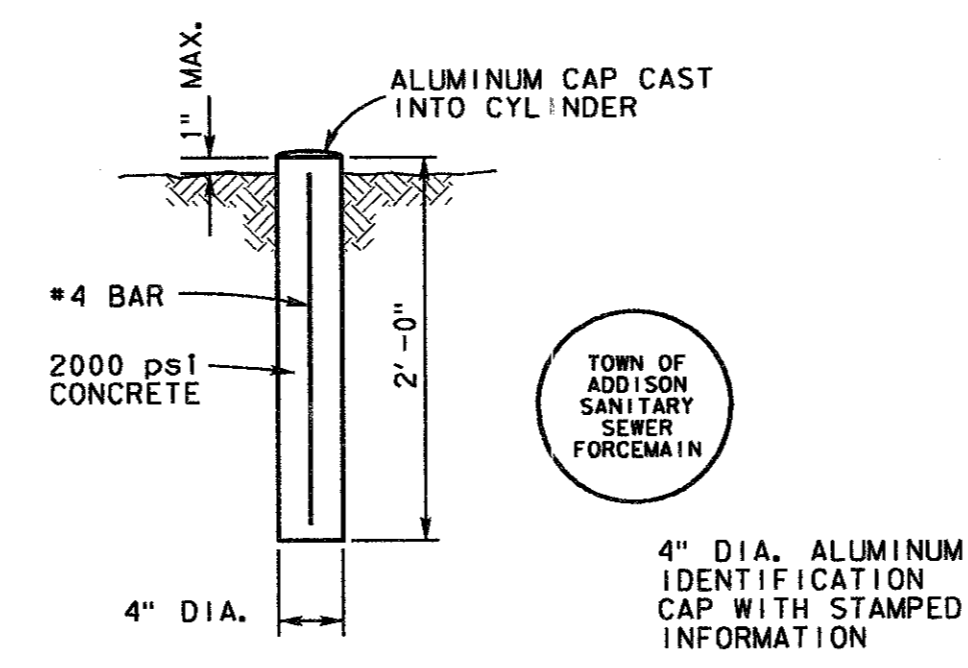

FORCE MAIN MARKER DETAIL

LOCATE FORCE MAIN MARKERS ON CENTERLINE AT 300 FEET MAXIMUM SPACING AND AS SHOWN ON PLANS. NOT A SEPERATE PAY ITEM.

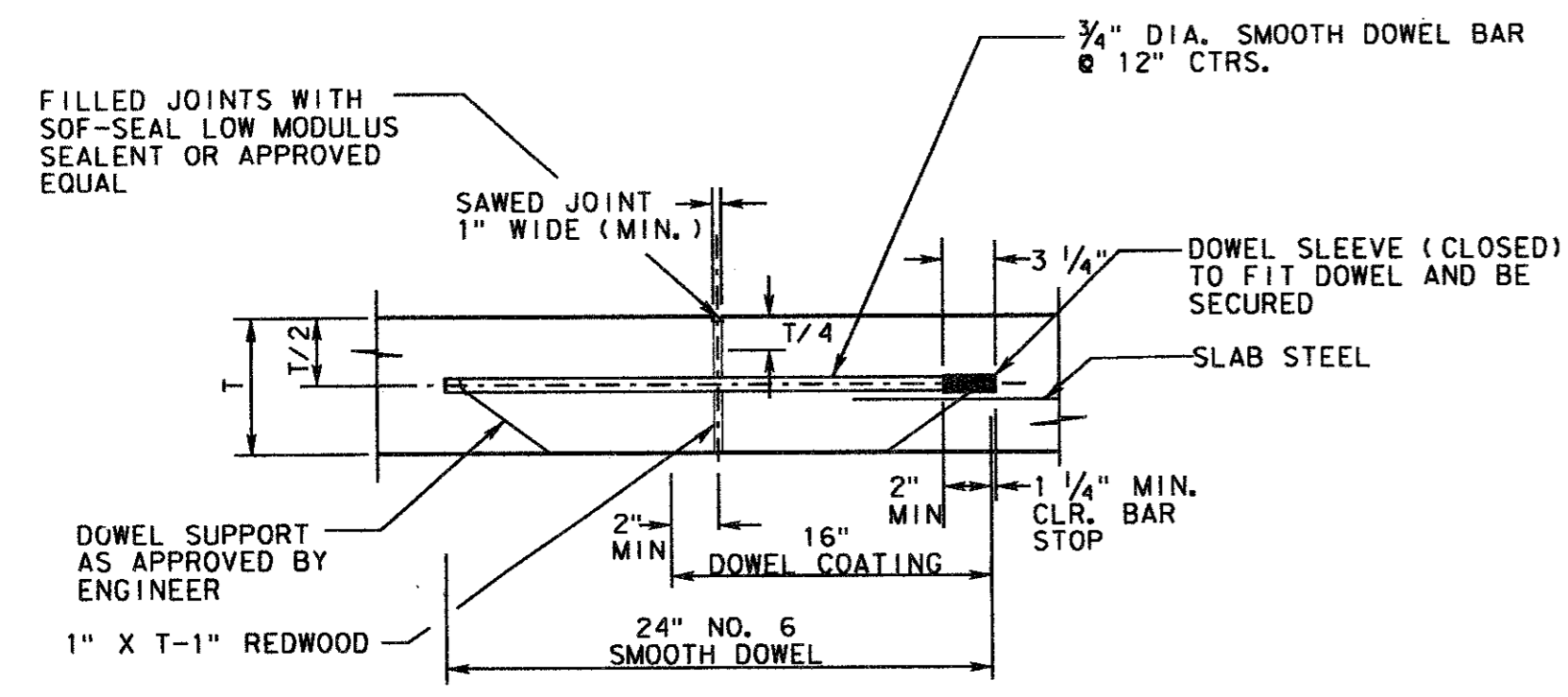

TRANSVERSE EXPANSION JOINT

NOTES: 1. DOWEL SPACER TO BE PLACED ON FIRST Poured SIDE OF DOWELS. 2. SPACER SHALL BE ALIGNED SUCH THAT DOWELS ARE PARALLEL TO EACH OTHER, AND PERPENDICULAR TO REDWOOD.

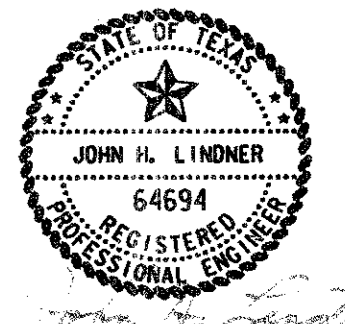

4			
3			
2			
1			
NO.	DATE	REVISION	APPROV.

TOWN OF ADDISON, TEXAS
MIDWAY/BELTLINE SANITARY SEWER
PAVING DETAILS
()



Unit	Scale	1" = 2'	Date	03-23-95
Designed	D. Moore	Checked	J. Lindner	Job No. 93327601D
Drawn	B. Sowell	Approved	J. Lindner	Sheet 11 of 11