

# TOWN OF ADDISON, TEXAS

# MIDWAY/BELTLINE SEWER INTERCEPTOR

PHASE I  
 ADDISON AIRPORT  
 MARCH 1995

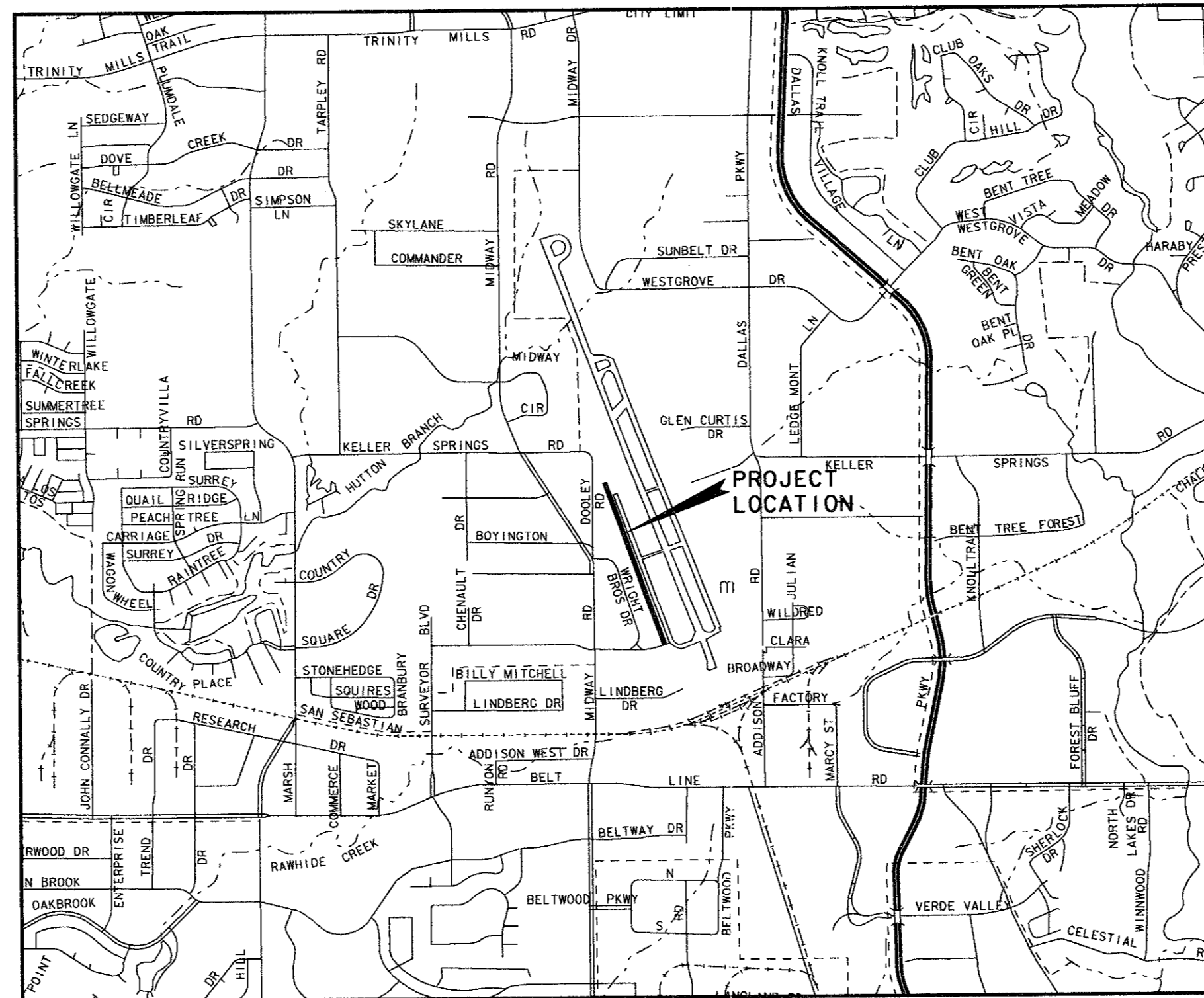
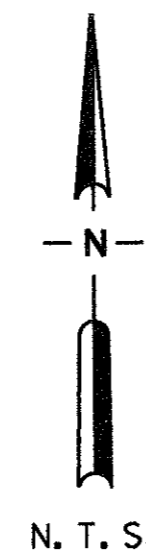
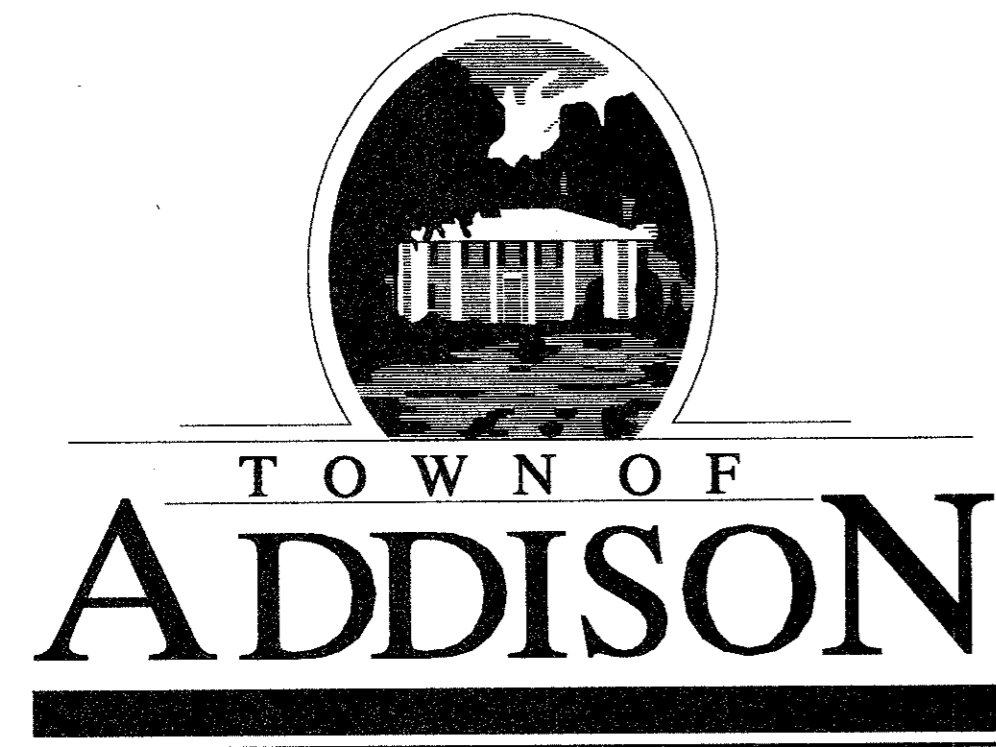

VICINITY MAP

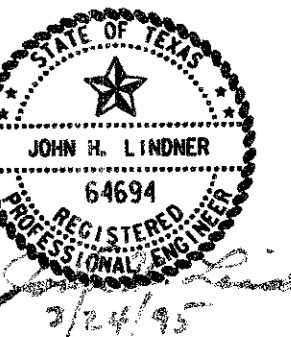

SUBMITTED BY:  
 CARTER & BURGESS, INC. *John Lindner* 3/24/95  
 John Lindner - Project Manager Date

APPROVED BY:  
 TOWN OF ADDISON \_\_\_\_\_  
 John Baumgartner - Director of Public Works Date

**Carter Burgess**  
 Consultants in Engineering, Architecture,  
 Planning and the Environment  
 CARTER & BURGESS, INC.  
 7950 EMBROOK DRIVE, SUITE 250  
 DALLAS, TX 75247-4961

USER: J. H. LINDNER  
 DATE: 3/24/95  
 TIME: 11:45 AM  
 PROJECT: MIDWAY/BELTLINE SEWER INTERCEPTOR - PHASE I - ADDISON AIRPORT  
 DRAWING: 3276C001.DGN  
 PLOT: 3276C001.DGN  
 PLOT DATE: 3/24/95  
 PLOT TIME: 11:45 AM  
 PLOT USER: J. H. LINDNER  
 PLOT DEVICE: HP-GL/2  
 PLOT SCALE: 1:1  
 PLOT SHEET: 1 OF 1  
 PLOT STATUS: SUCCESSFUL

MIDWAY/BELTLINE SEWER INTERCEPTOR - PHASE I - ADDISON AIRPORT