

TOWN OF ADDISON, TEXAS

MIDWAY/ BELT LINE SEWER IMPROVEMENTS

PHASE II

FROM MARSH LANE & BELTLINE RD. TO ADDISON AIRPORT

APRIL 5, 1996

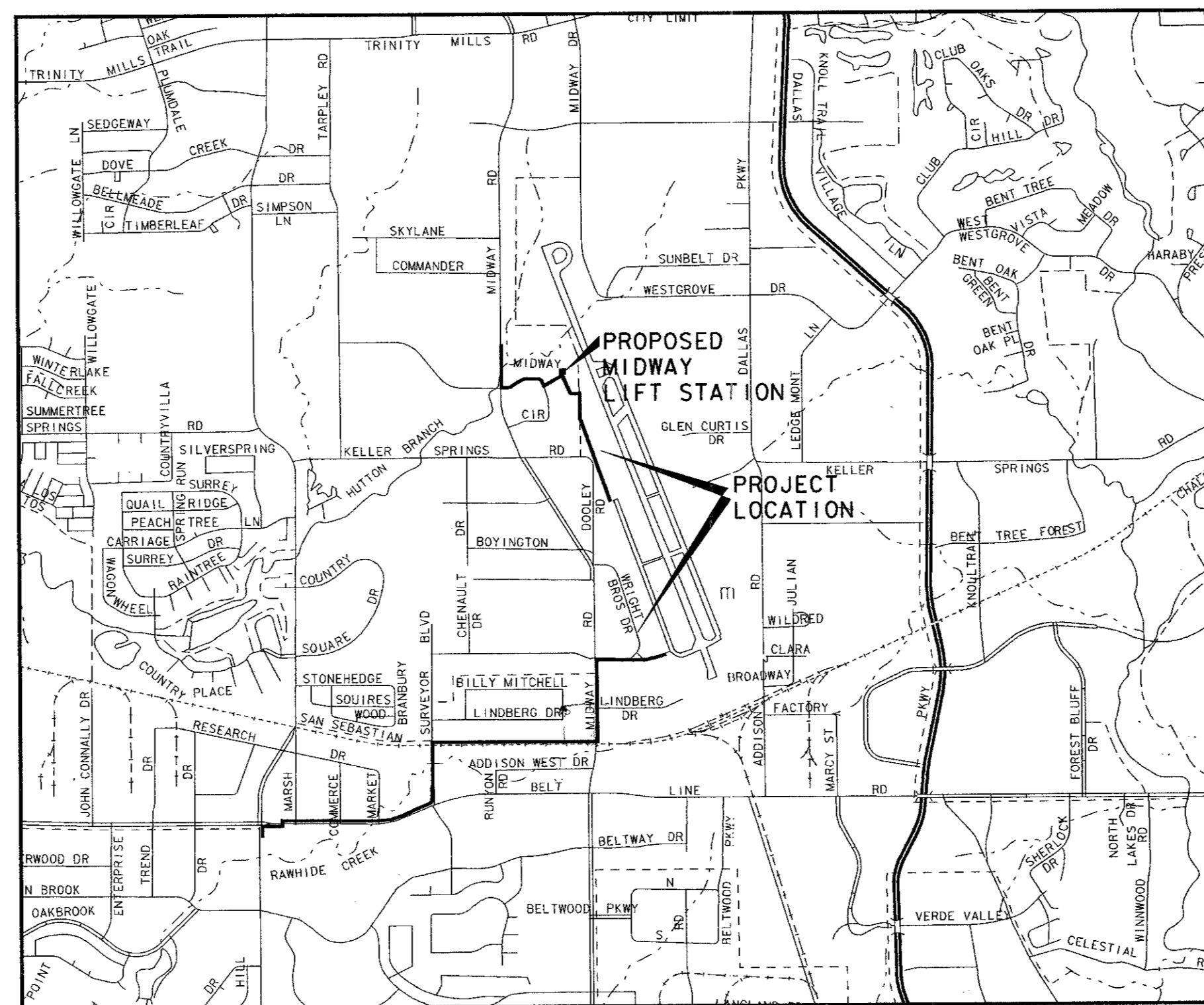
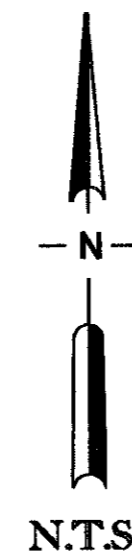
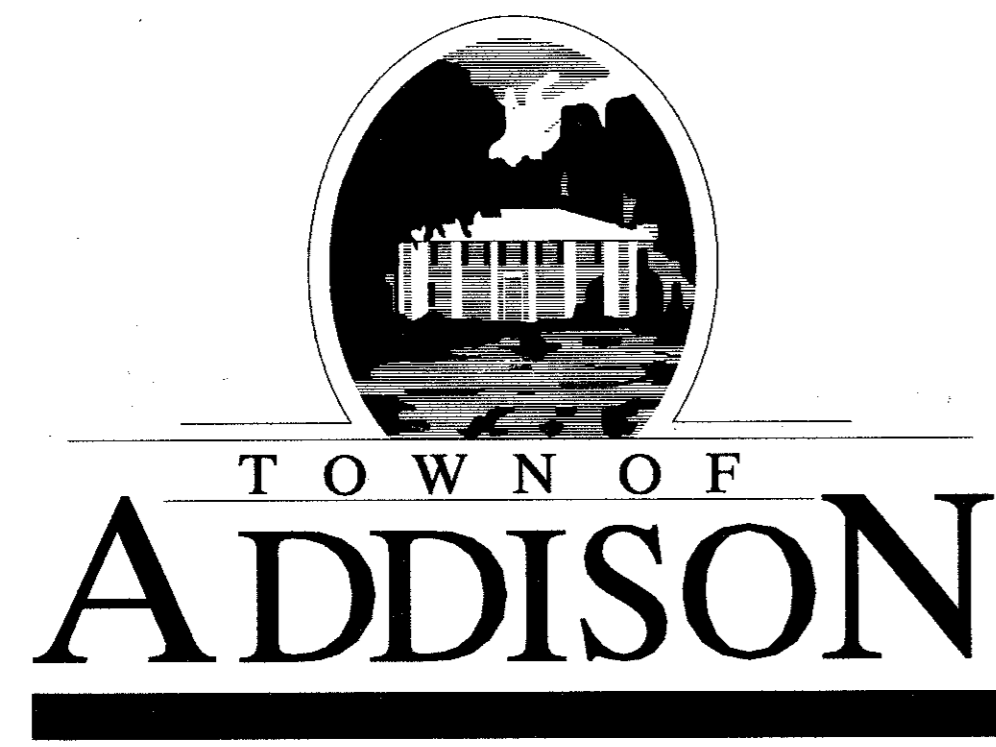

VICINITY MAP

SUBMITTED BY:

CARTER & BURGESS, INC. *John H. Linder* 6/12/96
John Linder - Project Manager Date

APPROVED BY:

TOWN OF ADDISON _____ John Baumgartner - Director of Public Works _____ Date

CONSTRUCTION SET
ISSUED BY
TOWN OF ADDISON
PUBLIC WORKS DEPARTMENT
NAME: *David N. ...* DATE: 7/19/96

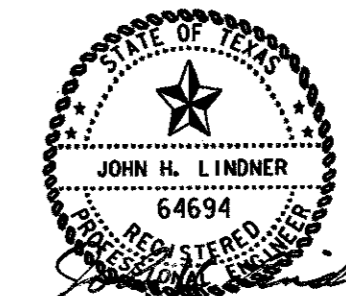

Carter & Burgess
Consultants in Engineering, Architecture,
Planning and the Environment
CARTER & BURGESS, INC.
7950 ELMBROOK DRIVE, SUITE 250
DALLAS, TX 75247-4961