

MATCH LINE STA. 64+00

S.P. R.R.

CONCRETE REMOVAL & REPLACEMENT

STA 64+28.53
CONST. 4' DIA MANHOLE
CONST. TO MAINT. ACCESS
IN DRIVE

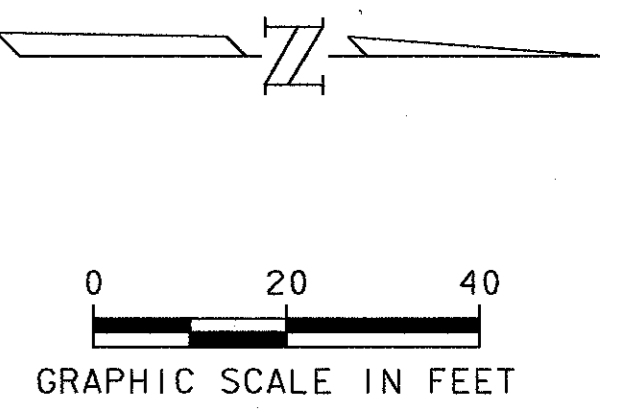

MATCH LINE STA. 68+00

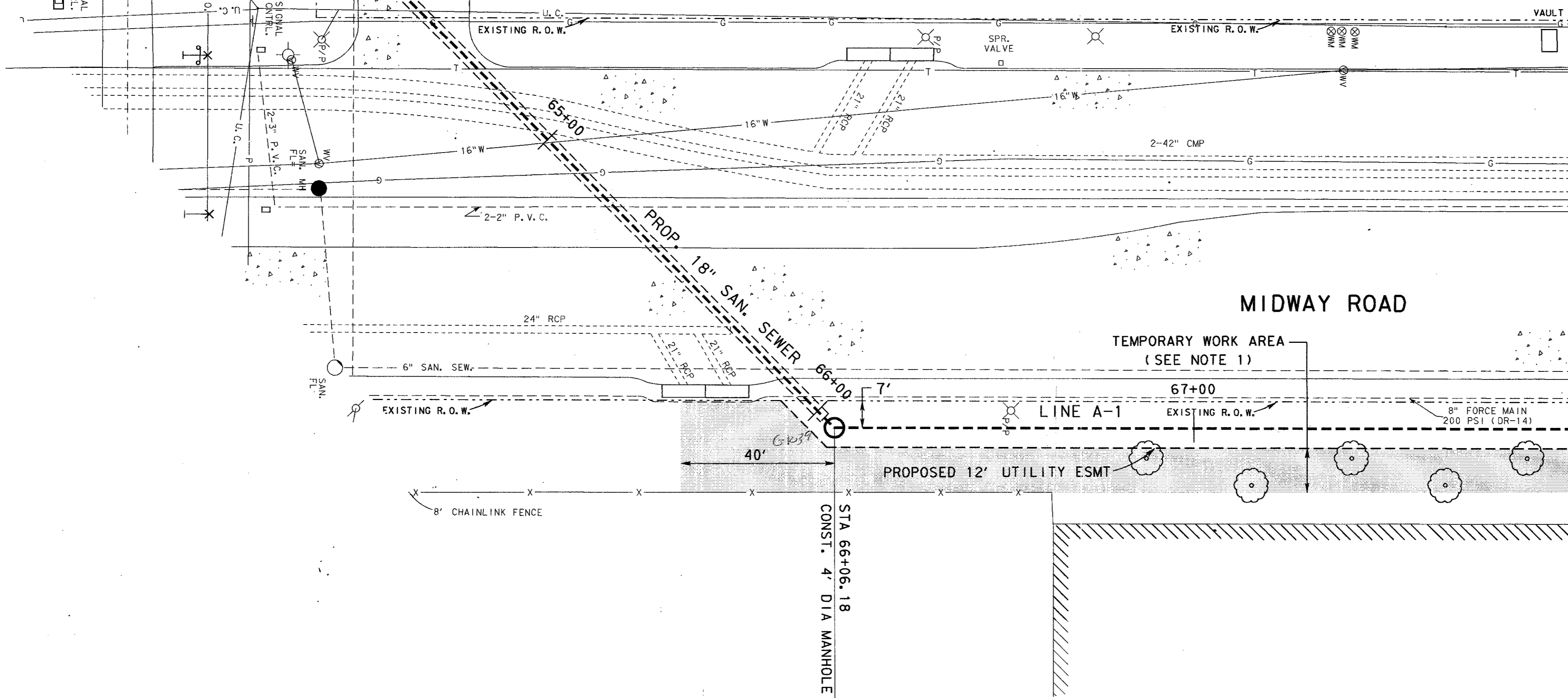

NOTE:
1. CONTRACTOR SHALL REMOVE AND REPLACE WEST ROW OF EXISTING TREES AS NECESSARY TO INSTALL PROPOSED SEWER LINE AND SHALL CONSTRUCT TEMPORARY FENCING TO PROTECT EXIST ROW OF TREES. NOT A SEPERATE PAY ITEM.

0435
-0051
384
12854 @ 350 ± 36,000

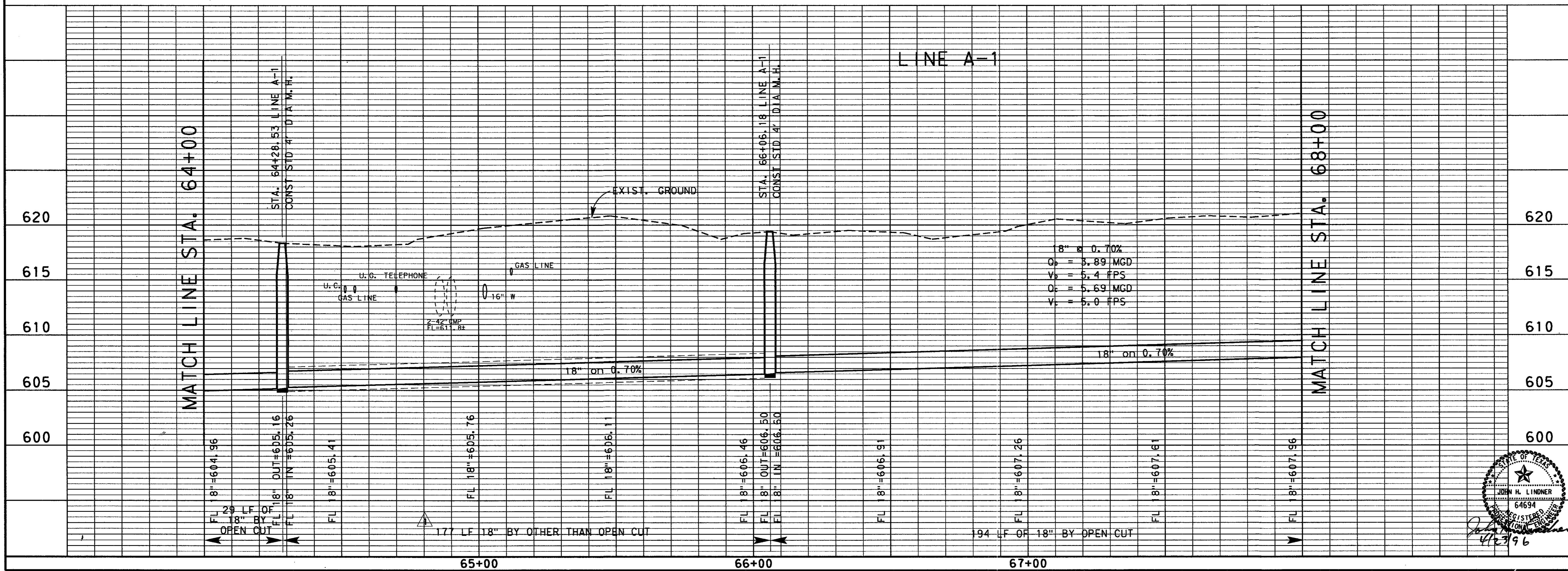

8" @ 0.70%
Q_s = 3.89 MGD
V_s = 5.4 FPS
Q_c = 5.69 MGD
V_c = 5.0 FPS

4			
3			
2			
1	4-23-96	ADDENDUM NO. 1	J. H.L.
NO.	DATE	REVISION	APPROV.
TOWN OF ADDISON, TEXAS			
MIDWAY/BELTLINE SANITARY SEWER PHASE II			
LINE A-1 FROM STATION 64+00 TO STATION 68+00			
Carter & Burgess Consultants in Engineering, Architecture, Planning and the Environment CARTER & BURGESS, INC. 7950 ELMBROOK DRIVE, SUITE 250 DALLAS, TX 75247-4961			
Unit	Scale	Horiz. 1" = 20' Vert. 1" = 5'	Date 04-05-96
Designed	J. Lindner	Checked	J. Lindner
Drawn	R. Howman	Approved	J. Lindner
Job No.	93327601D	Sheet	19 of 63
			32765516.DGN

