

SHEET NO. 20 OF 63
 DATE 04-05-96
 PROJECT NO. 93327601D
 TOWN OF ADDISON, TEXAS
 MIDWAY/BELTLINE SANITARY SEWER
 PHASE II
 LINE A-1
 FROM STATION 68+00 TO STATION 72+00

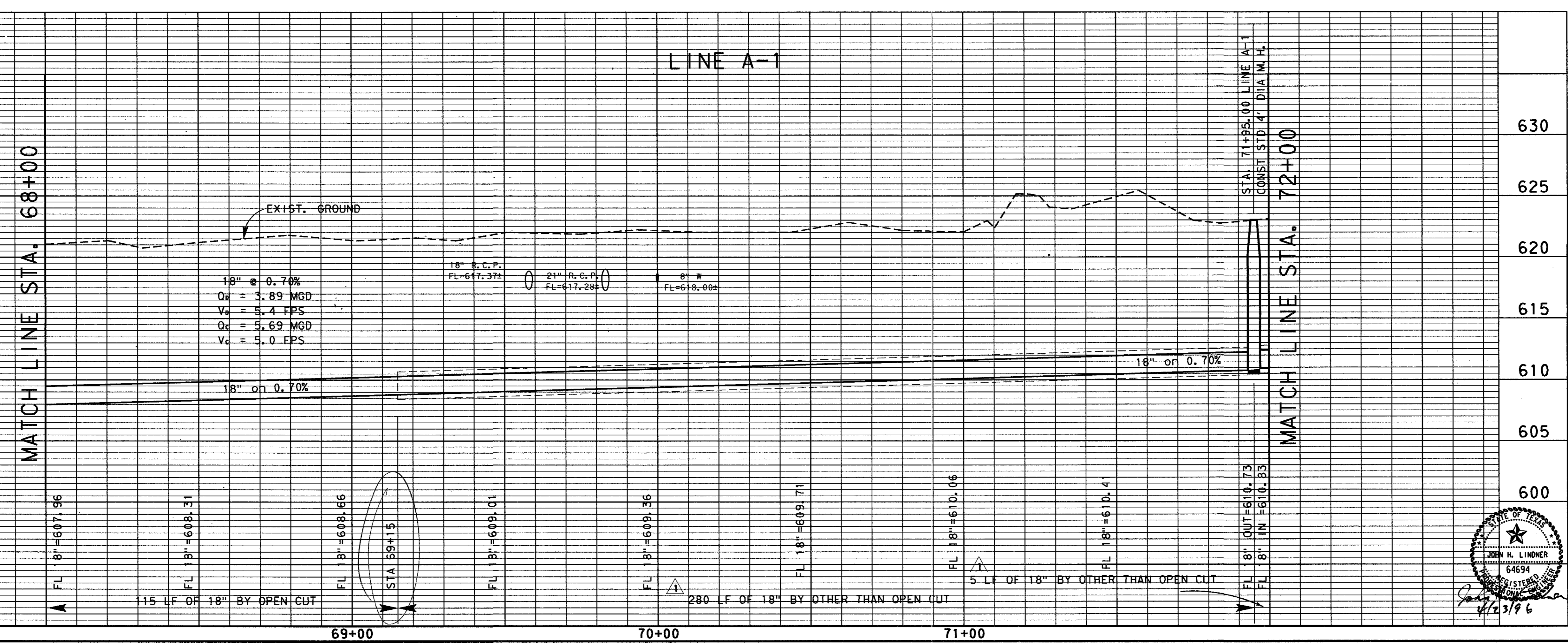
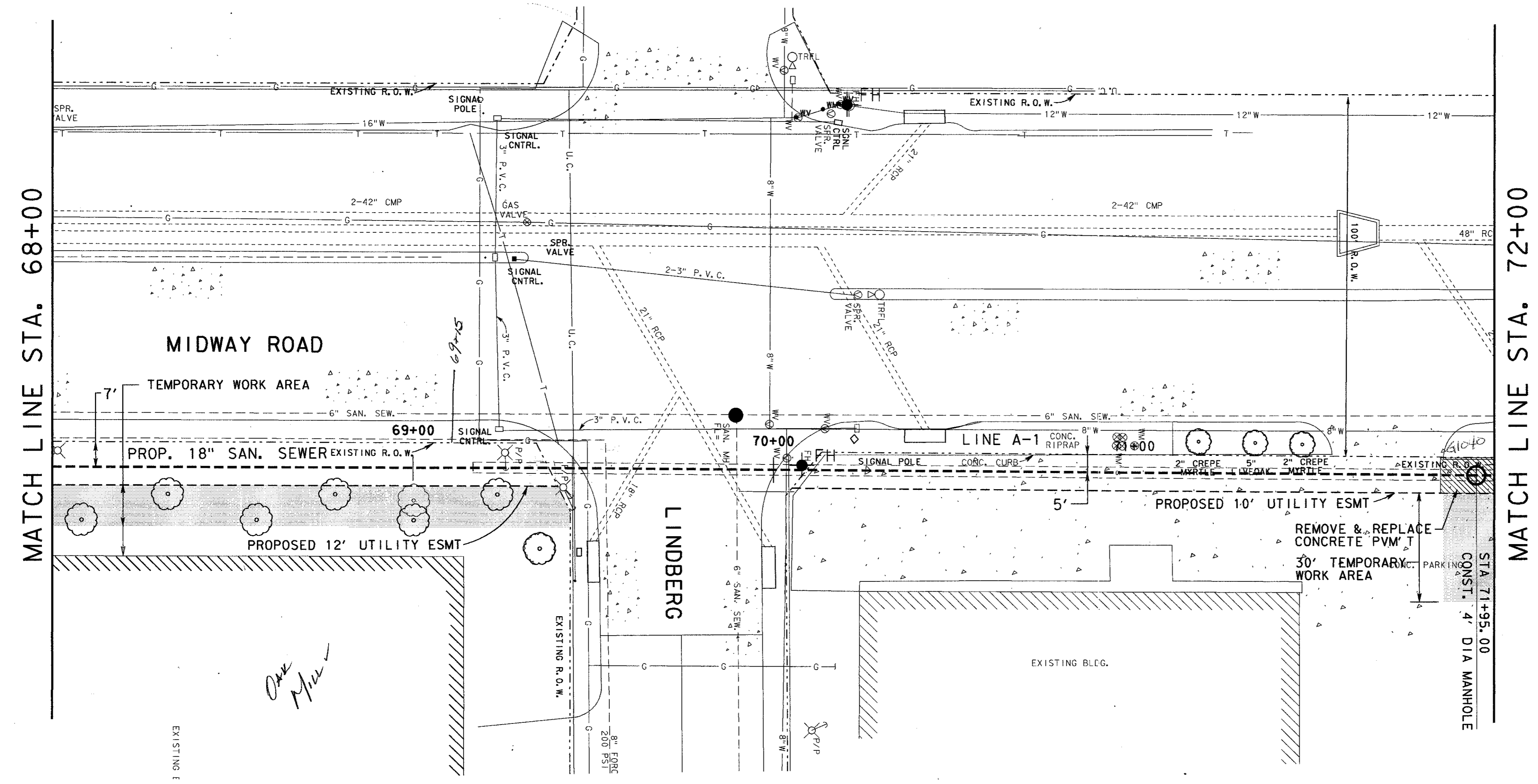
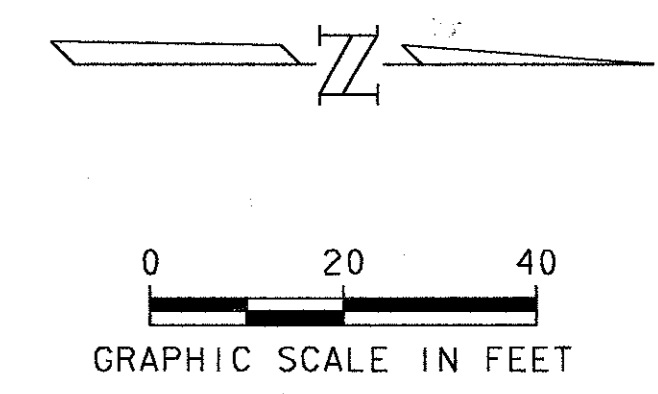

NO.	DATE	REVISION	APPROV.
1	4-23-96	ADDENDUM NO. 1	J. H. L.
TOWN OF ADDISON, TEXAS			
MIDWAY/BELTLINE SANITARY SEWER			
PHASE II			
LINE A-1			
FROM STATION 68+00 TO STATION 72+00			
Carter & Burgess Consultants in Engineering, Architecture, Planning and the Environment CARTER & BURGESS, INC. 7950 ELMBROOK DRIVE, SUITE 250 DALLAS, TX 75247-4961			
Unit	Scale	Horiz. 1"=20' Vert. 1"=5'	Date 04-05-96
Designed	J. Lindner	Checked	J. Lindner
Drawn	R. Howman	Approved	J. Lindner
Job No. 93327601D		Sheet 20 of 63	
3276517.DGN			