

BENCH MARKS

- 4] BM NO. P114
A 3/8" IRON ROD STAMPED "CARTER & BURGESS" APPROXIMATELY 1000 FEET NORTH OF THE CENTERLINE INTERSECTION OF WILEY POST RD. AND MIDWAY RD. AND APPROXIMATELY 3 FEET WEST OF THE WEST CURB LINE OF MIDWAY RD. ELEVATION - 642.97
- 5] BM NO. P105
A 3/8" IRON ROD STAMPED "CARTER & BURGESS" SITUATED ON ADDISON AIRPORT PROPERTY, APPROXIMATELY 225 FEET EAST OF THE CENTERLINE OF DOOLEY RD. AND APPROXIMATELY 200 FEET NORTH OF THE CENTERLINE OF KELLER SPRINGS RD. ELEVATION - 638.04
- 6] BM NO. 1000
SQUARE BOX CUT APPROXIMATELY 450 FEET NORTH OF THE CENTERLINE INTERSECTION OF MIDWAY RD. AND KELLWAY CIRCLE AND ON TOP OF EAST CURB LINE OF MIDWAY RD. ELEVATION - 607.10

☉ LINE A-2 SANITARY SEWER ALIGNMENT

STATION	POINT	COORDINATES	
		NORTHING	EASTING
1+37.35	P. I.	473800.21	2203175.96
2+96.79	P. I.	473957.94	2203155.02
11+74.13	P. I.	474778.66	2202844.94
18+52.46	P. I.	475456.98	2202845.20
19+47.08	P. I.	475490.50	2202756.72
21+52.00	P. I.	475490.50	2202551.80
24+98.53	P. I.	475808.05	2202413.06
25+52.43	P. I.	475827.72	2202362.87
25+93.68	P. I.	475827.69	2202413.06

☉ LINE B SANITARY SEWER ALIGNMENT

STATION	POINT	COORDINATES	
		NORTHING	EASTING
1+10.00	M. H.	475853.66	2202343.27
2+12.85	M. H.	475766.93	2202288.67
3+06.20	M. H.	475766.87	2202195.32
4+85.90	M. H./P. C.	475590.40	2202161.38
5+27.95	P. T.	475592.40	2202119.40
7+21.02	P. C.	475590.01	2201926.35
8+81.84	M. H.	475534.07	2201778.49
10+35.72	M. H./P. T.	475465.98	2201641.87
14+49.08	M. H.	475879.34	2201643.02
15+14.93	M. H.	475942.04	2201622.89
15+44.93	M. H.	475971.82	2201626.52

☉ LINE B-1 SANITARY SEWER ALIGNMENT

STATION	POINT	COORDINATES	
		NORTHING	EASTING
0+00.00	M. H./P. C.	475590.40	2202161.38
0+37.32	P. T.	475602.83	2202126.60
0+70.00	M. H.	475602.59	2202094.37

☉ LINE C SANITARY SEWER ALIGNMENT

STATION	POINT	COORDINATES	
		NORTHING	EASTING
0+00.00	M. H.	475465.98	2201641.87
0+52.82	M. H.	475456.20	2201589.96
1+89.82	P. C.	475319.87	2201588.98
3+38.71	EX. M. H.	475171.56	2201600.22

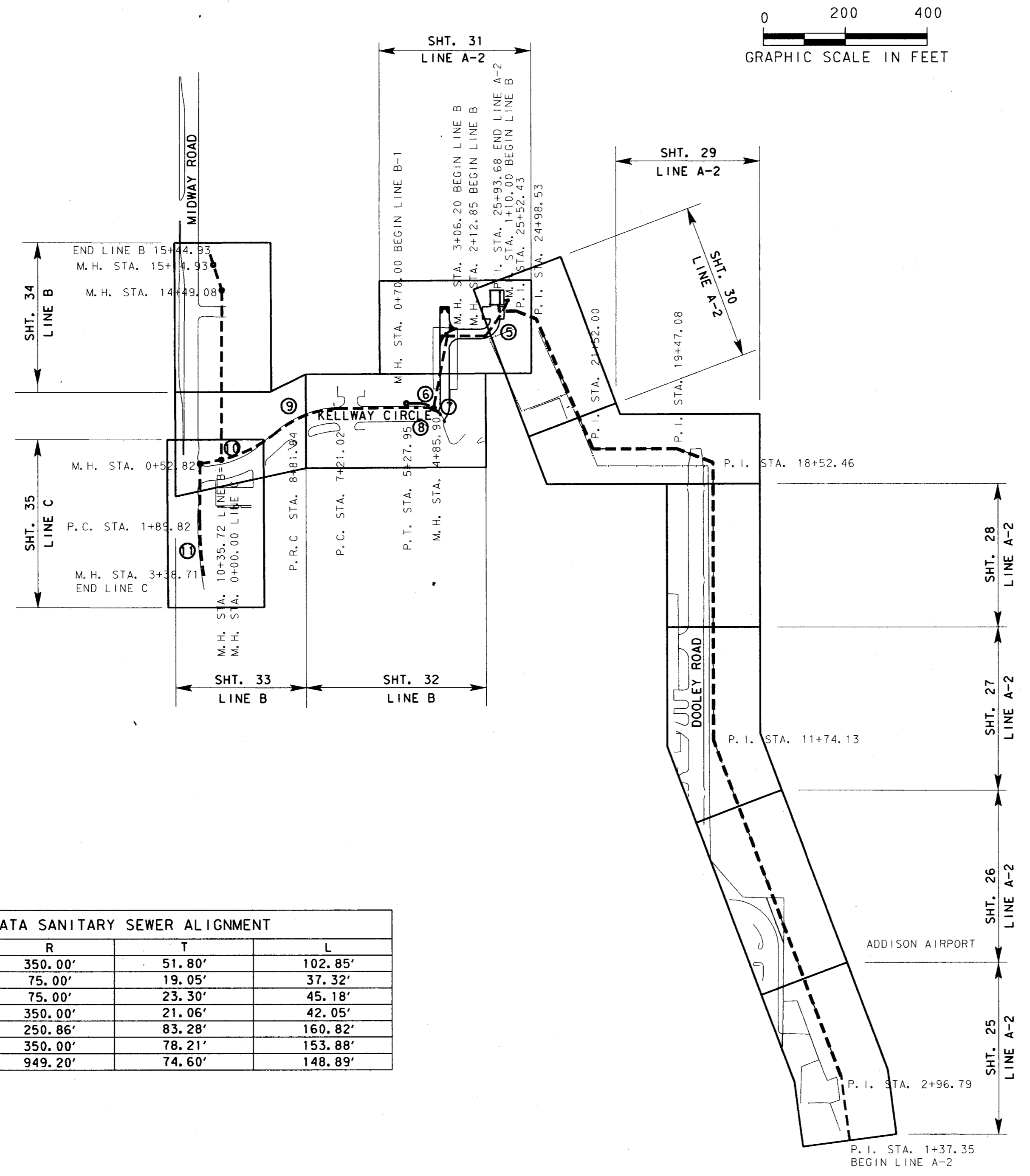

☉ CURVE DATA SANITARY SEWER ALIGNMENT

CURVE NO.	Δ	R	T	L
5	16° 50' 15"	350.00'	51.80'	102.85'
6	28° 30' 39"	75.00'	19.05'	37.32'
7	34° 30' 45"	75.00'	23.30'	45.18'
8	6° 53' 04"	350.00'	21.06'	42.05'
9	36° 43' 56"	250.86'	83.28'	160.82'
10	25° 11' 28"	350.00'	78.21'	153.88'
11	8° 59' 15"	949.20'	74.60'	148.89'

4			
3			
2			
1	3-4-98	AS BUILT DRAWING	J. H. L.
NO.	DATE	REVISION	APPROV.
TOWN OF ADDISON, TEXAS			
MIDWAY/BELTLINE SANITARY SEWER PHASE II			
SHEET LAYOUT LINES A-2, B & C			
Carter Burgess Consultants in Engineering, Architecture, Planning and the Environment CARTER & BURGESS, INC. 7950 ELMBROOK DRIVE, SUITE 250 DALLAS, TX 75247-4961			
Unit	Scale	1"=200'	Date 04-05-96
Designed	J. Lindner	Checked	J. Lindner Job No. 93327601D
Drawn	R. Howman	Approved	J. Lindner Sheet 2 of 63

