

TOWN OF ADDISON, TEXAS

MIDWAY/BELT LINE SEWER IMPROVEMENTS

PHASE II

FROM MARSH LANE & BELTLINE RD. TO ADDISON AIRPORT

APRIL 5, 1996

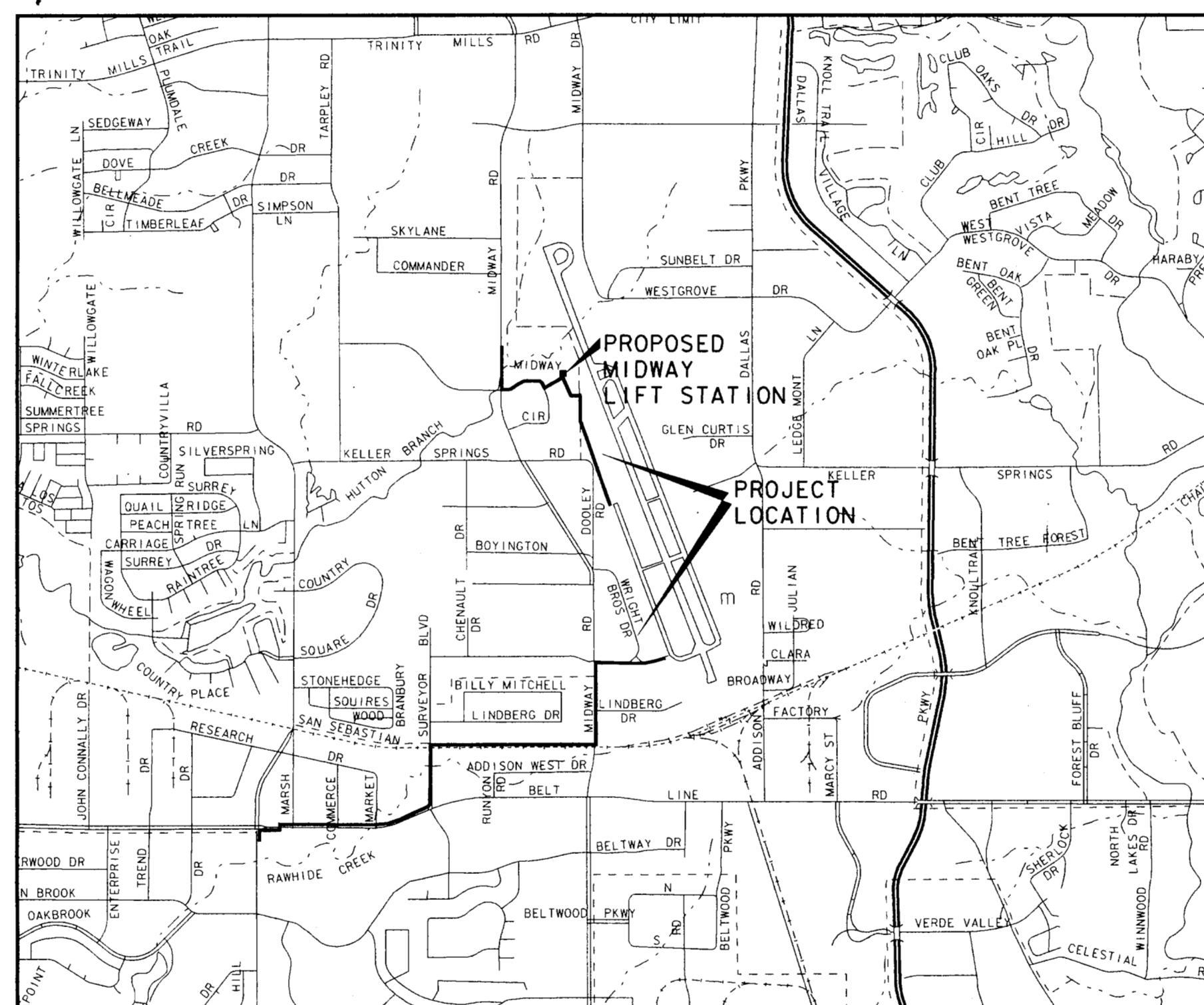
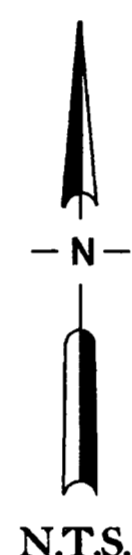
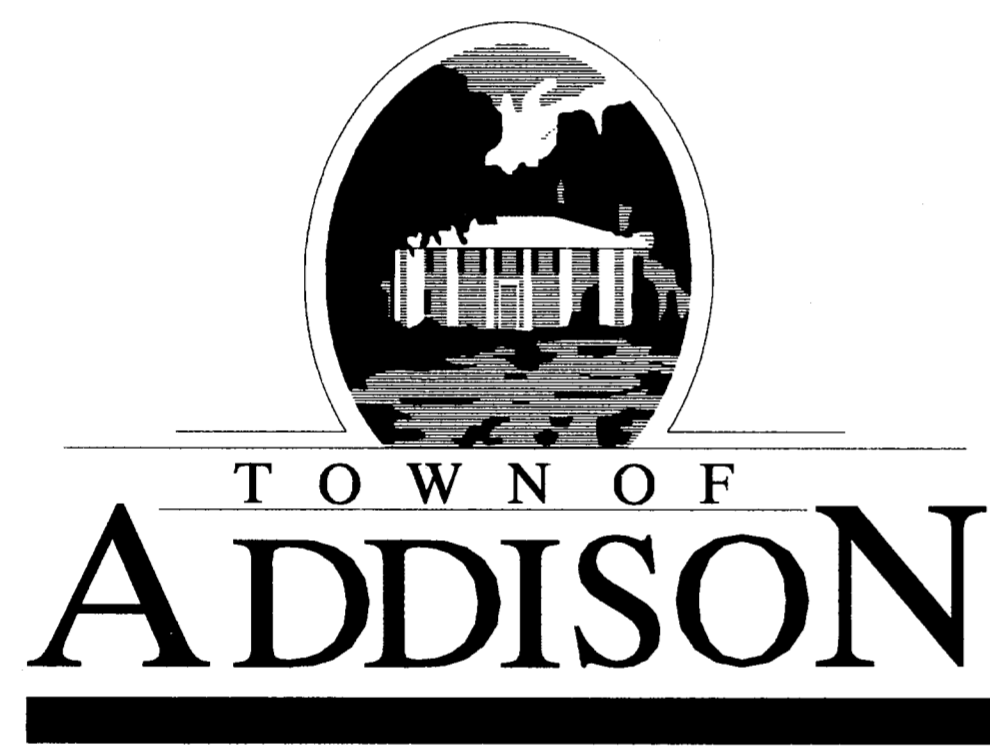

VICINITY MAP

SUBMITTED BY:

CARTER & BURGESS, INC. *John H. Lindner* 6/12/96
John Lindner - Project Manager Date

APPROVED BY:

TOWN OF ADDISON *John Baumgartner* - Director of Public Works Date

SEAL OF THE TOWN OF ADDISON, TEXAS
 JOHN H. LINDNER
 PROJECT MANAGER
 APRIL 5, 1996



4/5/96 2/22/97

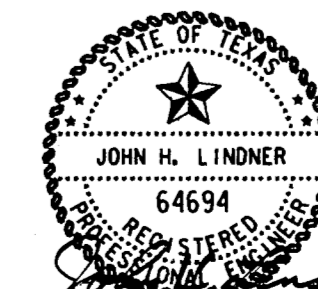

4/5/96

Carter & Burgess
 Consultants in Engineering, Architecture,
 Planning and the Environment
 CARTER & BURGESS, INC.
 7950 ELMBROOK DRIVE, SUITE 250
 DALLAS, TX 75247-4861