

ELEVATION  
 APPROXIMATE  
 81008  
 81009  
 81010  
 81011  
 81012  
 81013  
 81014  
 81015  
 81016  
 81017  
 81018  
 81019  
 81020  
 81021  
 81022  
 81023  
 81024  
 81025  
 81026  
 81027  
 81028  
 81029  
 81030  
 81031  
 81032  
 81033  
 81034  
 81035  
 81036  
 81037  
 81038  
 81039  
 81040  
 81041  
 81042  
 81043  
 81044  
 81045  
 81046  
 81047  
 81048  
 81049  
 81050  
 81051  
 81052  
 81053  
 81054  
 81055  
 81056  
 81057  
 81058  
 81059  
 81060  
 81061  
 81062  
 81063  
 81064  
 81065  
 81066  
 81067  
 81068  
 81069  
 81070  
 81071  
 81072  
 81073  
 81074  
 81075  
 81076  
 81077  
 81078  
 81079  
 81080  
 81081  
 81082  
 81083  
 81084  
 81085  
 81086  
 81087  
 81088  
 81089  
 81090  
 81091  
 81092  
 81093  
 81094  
 81095  
 81096  
 81097  
 81098  
 81099  
 81100  
 81101  
 81102  
 81103  
 81104  
 81105  
 81106  
 81107  
 81108  
 81109  
 81110  
 81111  
 81112  
 81113  
 81114  
 81115  
 81116  
 81117  
 81118  
 81119  
 81120  
 81121  
 81122  
 81123  
 81124  
 81125  
 81126  
 81127  
 81128  
 81129  
 81130  
 81131  
 81132  
 81133  
 81134  
 81135  
 81136  
 81137  
 81138  
 81139  
 81140  
 81141  
 81142  
 81143  
 81144  
 81145  
 81146  
 81147  
 81148  
 81149  
 81150  
 81151  
 81152  
 81153  
 81154  
 81155  
 81156  
 81157  
 81158  
 81159  
 81160  
 81161  
 81162  
 81163  
 81164  
 81165  
 81166  
 81167  
 81168  
 81169  
 81170  
 81171  
 81172  
 81173  
 81174  
 81175  
 81176  
 81177  
 81178  
 81179  
 81180  
 81181  
 81182  
 81183  
 81184  
 81185  
 81186  
 81187  
 81188  
 81189  
 81190  
 81191  
 81192  
 81193  
 81194  
 81195  
 81196  
 81197  
 81198  
 81199  
 81200

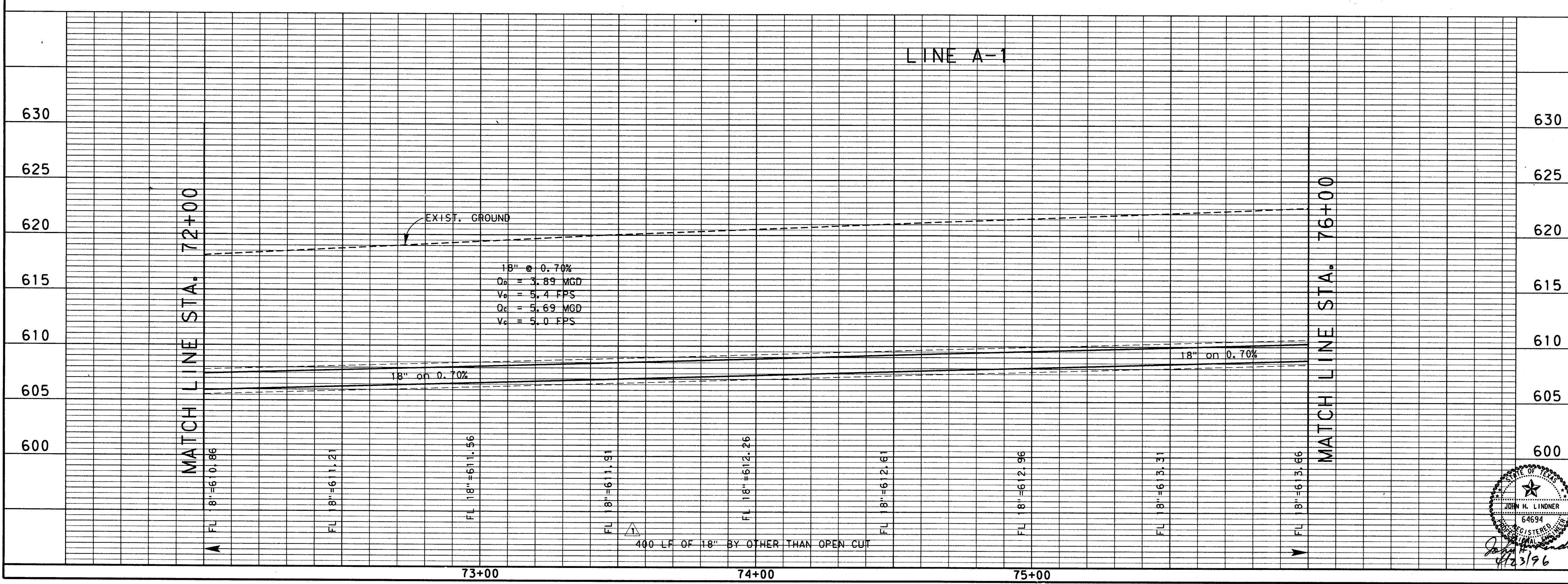

|  |            |                              |                |
|--|------------|------------------------------|----------------|
| 4  |            |                              |                |
| 3  |            |                              |                |
| 2  | 9-4-98     | AS BUILT DRAWING             | J. H. L.       |
| 1  | 4-23-96    | ADDENDUM NO. 1               | J. H. L.       |
| NO.  | DATE       | REVISION                     | APPROV.        |
| TOWN OF ADDISON, TEXAS   |            |                              |                |
| MIDWAY/BELTLINE SANITARY SEWER<br>PHASE II   |            |                              |                |
| LINE A-1<br>FROM STATION 72+00 TO STATION 76+00  |            |                              |                |
| <b>Carter-Burgess</b><br><small>Consultants in Engineering, Architecture,<br/>Planning and the Environment.</small><br>CARTER & BURGESS, INC.<br>7950 ELMBROOK DRIVE, SUITE 250<br>DALLAS, TX 75247-4963 |            |                              |                |
| Unit   | Scale      | Horiz. 1"=20'<br>Vert. 1"=5' | Date 04-05-96  |
| Designed   | J. Lindner | Checked                      | J. Lindner     |
| Drawn  | R. Howman  | Approved                     | J. Lindner     |
| Job No.  | 93327601D  |                              | Sheet 21 of 63 |

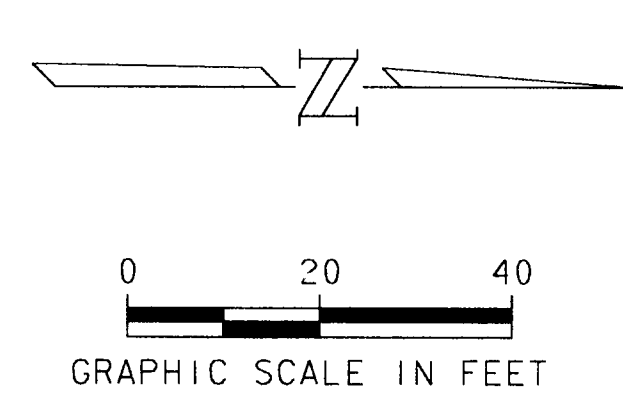
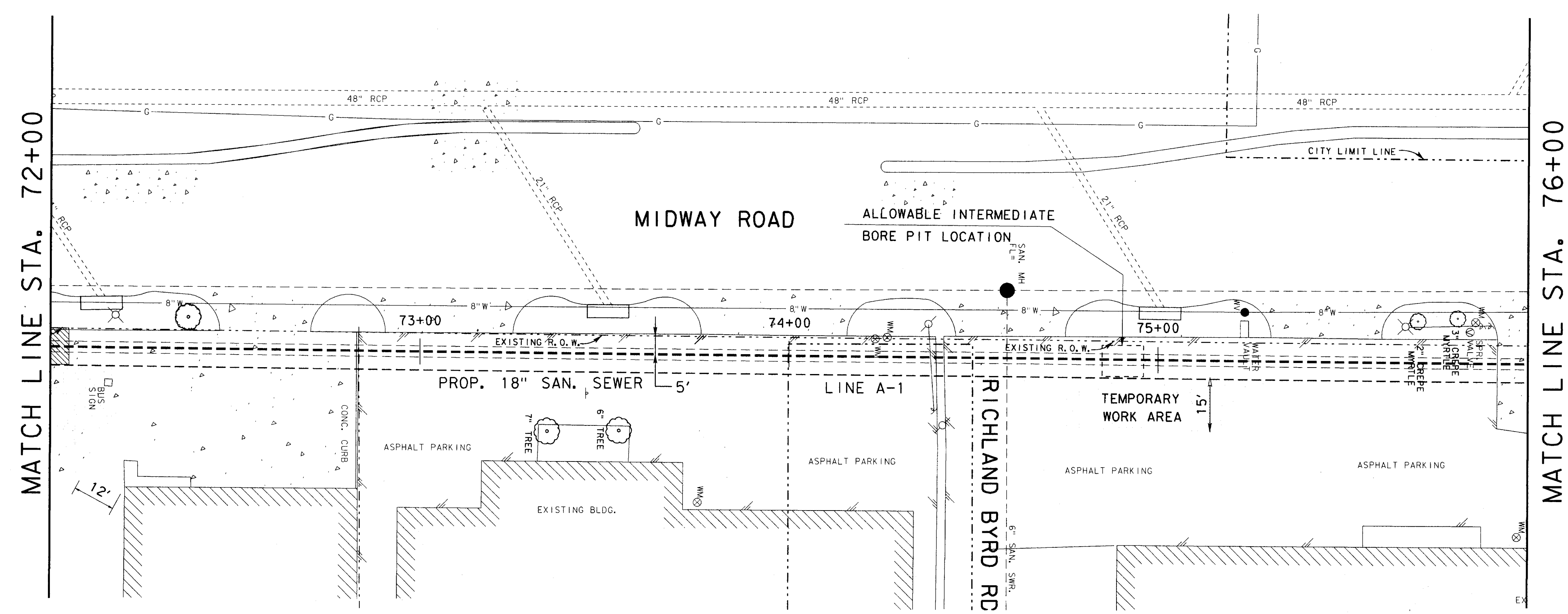