





LEGEND

-  LIVE OAK
-  RED OAK
-  BRADFORD PEAR
-  CRAPE MYRTLE- RED
-  HYDROMULCH
-  LIMIT OF HYDROMULCH

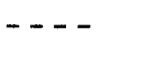
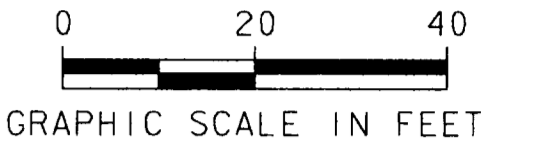

PLANTING NOTES:

1. THE GENERAL CONTRACTOR SHALL BE RESPONSIBLE FOR COORDINATION OF THE WORK AMONG THE LANDSCAPE CONTRACTOR, THE IRRIGATION CONTRACTOR AND OTHER CONTRACTORS ON SITE.
2. THE CONTRACTOR SHALL DETERMINE THE EXACT LOCATION OF ALL EXISTING UTILITIES AND CONDUCT HIS WORK SO AS TO PREVENT INTERRUPTION OF SERVICE OR DAMAGE TO THEM. THE CONTRACTOR SHALL PROTECT EXISTING STRUCTURES AND UTILITIES AND SHALL BE RESPONSIBLE FOR THEIR REPAIR IF DAMAGED.
3. ALL PLANT MATERIAL SHALL BE CONTAINER GROWN. FIELD COLLECTED MATERIAL SHALL NOT BE USED UNLESS APPROVED BY THE OWNER.
4. ONLY TOPSOIL FREE OF NOXIOUS PLANTS EXCAVATED FROM PITS AND BEDS WILL BE ACCEPTABLE FOR USE AS BACKFILL MATERIAL AS SPECIFIED.
5. ALL TREES PLANTED ON SLOPES SHALL BE PLANTED SO THAT TRUNKS ARE STRAIGHT AND UPRIGHT. TREE WELLS WILL BE CAREFULLY MADE SO THAT DOWNHILL LIP OF TREE WELL FORMS A BASIN TO CATCH AND HOLD WATER.
6. AFTER PLANTING, ALL OAK SPECIES (LIVE OAK, BUR OAK, RED OAK) SHALL HAVE THEIR TRUNKS SPRAYED WITH A LINDANE BORER PREVENTATIVE SOLUTION. SOLUTION SHALL BE CAREFULLY APPLIED SO THAT FOLIAGE IS NOT SPRAYED.
7. CONTRACTOR IS RESPONSIBLE FOR ESTABLISHING A STAND OF GRASS AS STATED IN THE SPECIFICATIONS, FOR THE AREAS DESIGNATED ON THE PLANS.
8. CONTRACTOR SHALL STAKE ALL TREE LOCATIONS PRIOR TO INSTALLATION. OWNER SHALL APPROVE STAKING BEFORE PLANTING.
9. REFER TO PLANTING DETAILS.

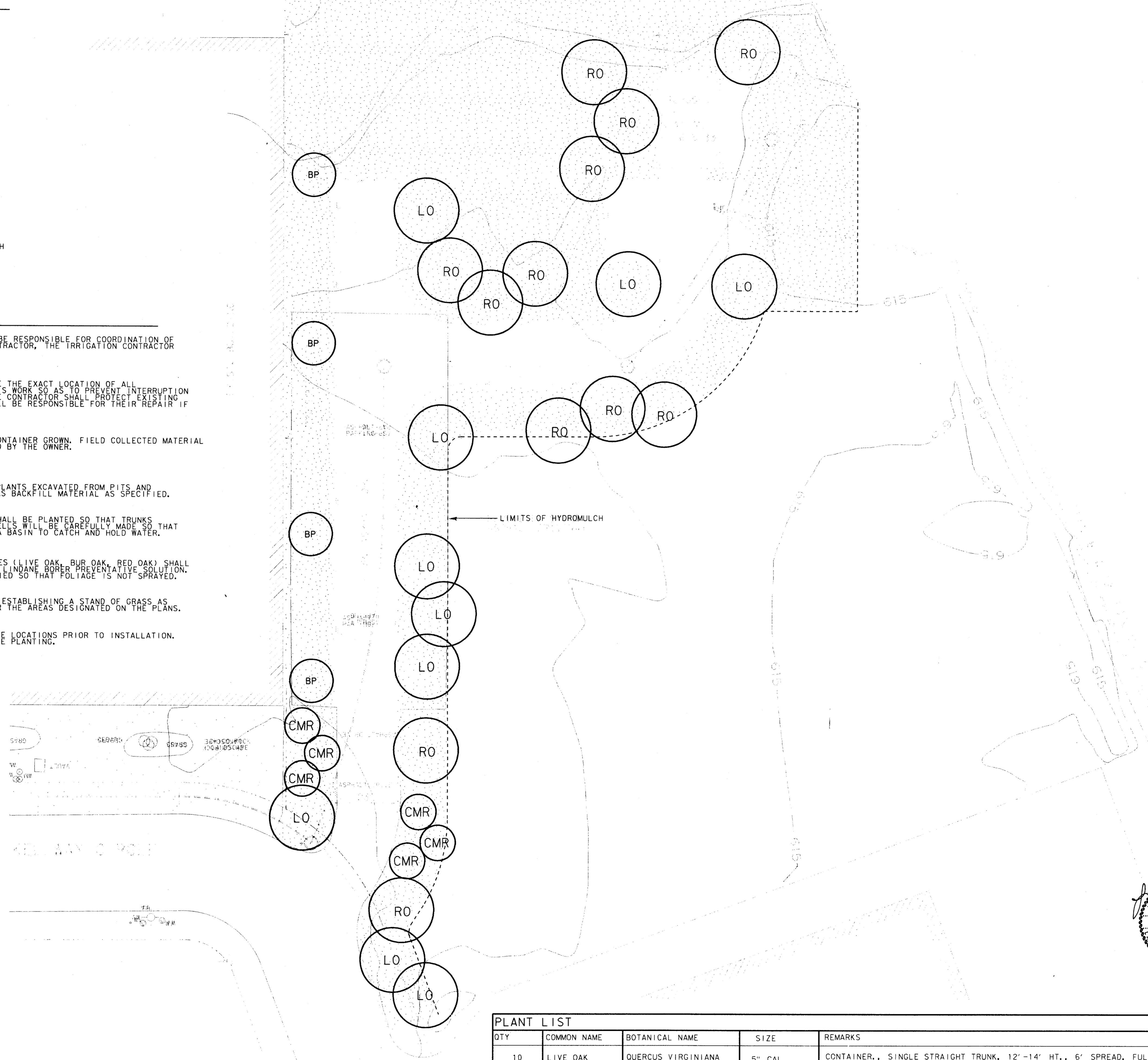

PLANT LIST

QTY	COMMON NAME	BOTANICAL NAME	SIZE	REMARKS
10	LIVE OAK	QUERCUS VIRGINIANA	5" CAL.	CONTAINER., SINGLE STRAIGHT TRUNK, 12'-14' HT., 6' SPREAD, FULL CROWN
12	SHUMARD OAK	QUERCUS SHUMARDII	5" CAL.	CONTAINER., SINGLE STRAIGHT TRUNK, 12'-14' HT., 6' SPREAD, FULL CROWN
6	CRAPE MYRTLE	LAGERSTROEMIA INDICA 'TUSCARORA'	10'-12' HT.	CONTAINER, MULTI-TRUNK, MATCHED, 5' SPREAD, FULL CROWN, 5 CANE MINIMUM
4	BRADFORD PEAR	PYRUS CALLERYANA	3/2" CAL.	CONTAINER, SINGLE STRIAIGHT TRUNK, 8'-10' HT.
33,025 SF	COMMON BERMUDA	CYNODON DACTYLON		HYDROSEED



4			
3			
2			
1	9-4-98	AS BUILT DRAWING	J. N. L.
NO.	DATE	REVISION	APPROV.

TOWN OF ADDISON, TEXAS
 MIDWAY/BELTLINE SANITARY SEWER
 PHASE II
 LIFT STATION
 LANDSCAPE ARCHITECTURAL SITE PLAN



Consultants in Engineering, Architecture,
 Planning, and the Environment
 CARTER & BURGESS, INC.
 7950 ELMBROOK DRIVE, SUITE 250
 DALLAS, TX 75247-4961

Unit	Scale	Date	04-05-96
Designed	B. Luck	Checked	J. Lindner
Drawn	B. Luck	Approved	J. Lindner
		Job No.	93327601D
		Sheet	60 of 63