

# TOWN OF ADDISON IRRIGATION SPECIFICATIONS

ALL MAIN LINE PIPE TO BE SCHEDULE 40 BELLED PVC. PUT NOT MORE THAN TWO (2) PIPES IN ANY ONE TRENCH. CLASS 200 LATERAL PIPING IS SUBJECT TO PRIOR APPROVAL BY THE TOWN.

FITTINGS: NO CROSSES ARE PERMITTED. SEPARATE TEES AND/OR ELBOWS BE AT LEAST 12". REDUCTION TEES ARE PERMITTED OVER USE OF REDUCER BUSHINGS. ONLY SPEARS AND/OR LASCO ARE PERMITTED. ALLOW 18" OUTSIDE OF SLEEVE BEFORE FIRST FITTING.

WIRING: 14 GA. UF. RED-CONTROL WIRES. WHITE-GROUND. ANYTIME WIRING CHANGES DIRECTION, SUCH AS AT AN ELBOW OR TEE, ALLOW A LOOP AT LEAST ONE HAND WIDTH (10 INCHES) ALONGSIDE THE FITTING AT THAT LOCATION. ONLY CONTINUOUS WIRE RUNS ARE PERMISSIBLE UNLESS OTHERWISE APPROVED. WIRE SHOULD FOLLOW MAINLINE WHERE POSSIBLE AND LAY ALONG A SINGLE SIDE NOT CROSSING OVER LATERAL LINES.

USE KING CONNECTORS FOR ALL WIRE SPLICES. ALLOW AT LEAST 36" OF PIGTAILED WIRE AT EACH SPLICE. ALL VALVE SPLICES ARE TO BE HOUSED IN STANDARD (LARGE) RECTANGULAR PLASTIC VALVE BOXES. ALL FIELD SPLICES ARE TO BE IN 10" ROUND PLASTIC VALVE BOXES.

ONLY WEATHERMATIC 11000CR SERIES PLASTIC VALVES ARE PERMITTED. THEY ARE TO BE LOCATED WITHIN STANDARD (LARGE) RECTANGULAR PLASTIC VALVE BOXES WITH 4"-6" OF PEA GRAVEL PLACED UNDERNEATH THE VALVE IN SUCH A MANNER AS TO PREVENT SOIL INFILTRATION INTO THE BOX.

ONLY BUCKNER MODEL 30A SINGLE LUG 1/2" OVC'S ARE PERMITTED. THEY ARE TO BE CONNECTED TO A THREADED FITTING. STANDARD (LARGE) RECTANGULAR PLASTIC VALVE BOXES AND SCHEDULE 40 FITTINGS ARE TO BE USED. HOUSE OVC IN A 10" ROUND PLASTIC VALVE BOX.

ALL HEADS ARE TO BE ATTACHED TO THREADED FITTINGS VIA 6" POLYETHYLENE NIPPLES CUT TO THE APPROPRIATE LENGTH. ALL NOZZLE SIZES WILL BE DESIGNATED ON THE PLANS.

POP-UPS: ONLY TORO 570C SERIES ARE PERMITTED UNLESS OTHERWISE NOTED. INSTALL 3/4" ABOVE FINISHED GRADE. TURF-4" (INCLUDES TREE BUBBLER WITHIN TURF AREAS, USE TORO SB-PC NOZZLES. VERY LOW GROUND COVER (LESS THAN 6" MATURE HT.) 1"-6" GROUND COVER AND LOW GROWING SHRUBS 12" HP FUNNY PIPE FOR 12" HP INSTALLATIONS WITH OWNER APPROVAL IS ACCEPTABLE IF CONDITIONS WARRANT.

BUBBLERS: BED AREAS ONLY. USE TORO 500 SERIES STREAM OR FLOOD BUBBLERS.

ROTARIES: ONLY HUNTER PGP SERIES ARE PERMITTED UNLESS OTHERWISE NOTED. INSTALL 3/4" ABOVE FINISHED GRADE.

RISERS: USE TYPE M COPPER WITH SOLDERED MALE ENDS FOR TORO 570-S SHRUB ADAPTERS AND FEMALE ENDS TO ATTACH TO SHORT POLYETHYLENE NIPPLES SCREWED INTO THREADED FITTINGS. OWNER RESERVES THE RIGHT TO DETERMINE PLACEMENT OF RISERS VERSUS POP-UPS.

ONLY HERSEY MVR METERS WITH 17" LAY LENGTH AND (3) BRASS FLANGES ARE ACCEPTABLE. STAINLESS STEEL BOLTS AND NUTS MUST BE USED IN THE INSTALLATION ALONG WITH NEOPRENE GASKETS. HOUSE IN APPROPRIATE SIZE (TO BE DETERMINED BY OWNER) CONCRETE BOX WITH LID. TO BRING BOX TO GROUND LEVEL USE BRICKS OR PAVERS, AND BACKFILL INSIDE BELOW METER BASE WITH AT LEAST 6" OF PEA GRAVEL. CONNECTION TO MAIN MUST BE DONE BY THE TOWN'S WATER DEPARTMENT AND ALL TAP MATERIALS MUST BE APPROVED BY THEM.

ONLY FEBCO 805-Y DOUBLE CHECK ASSEMBLIES ARE TO BE USED. CONNECT TO METER FLANGE USING TEFLON PASTE AND GRAY SCHEDULE 80 NIPPLE AT LEAST 6" IN LENGTH. HOUSE IN APPROPRIATE SIZE (TO BE DETERMINED BY OWNER) CONCRETE BOX WITH LID. TO BRING BOX TO GROUND LEVEL USE BRICKS OR PAVERS, AND BACKFILL INSIDE BELOW METER BASE WITH AT LEAST 6" OF PEA GRAVEL. CONNECTION TO MAIN MUST BE DONE BY THE TOWN'S WATER DEPARTMENT AND ALL TAP MATERIALS MUST BE APPROVED BY THEM.

FEMALE THREADED PLASTIC BALL VALVES WITH POSITIVE T-HANDLE CUT OFF MUST BE INSTALLED. HOUSE IN STANDARD (LARGE) RECTANGULAR PLASTIC VALVE BOX AND FOLLOW METER BOX INSTALLATION INSTRUCTIONS FOR DCA ASSEMBLY. USE TO ISOLATE EVERY 200' OF MAINLINE.

ONLY IRRITROL MC PLUS SERIES CONTROLLER IS PERMITTED UNLESS OTHERWISE APPROVED AND/OR NOTED. NICKAD BATTERIES MUST BE SUPPLIED WITH EVERY INSTALLATION. CONTROLLERS ARE TO BE INSTALLED ON THE APPROPRIATE PEDESTAL AFFIXED TO A PERMANENT CONCRETE PAD VIA (4) BOLTS. ALL WIRING IS TO ENTER THE PEDESTAL VIA GRAY PVC SWEEP ELBOWS EXTENDING THROUGH THE PAD. CONTROL WIRING AND 120-V SERVICES ARE TO BE SEPARATED WITH EACH HAVING IT'S OWN ACCESS ELBOW. CHECK TOWN'S ELECTRICAL CODES FOR PROPER 120-V SERVICE INSTALLATION. ALL CONTROLLERS ARE TO BE PERMANENTLY WIRED FOR QUICK ATTACHMENT OF IRRITROL RVC UNIT. USE IRRITROL CABLE ADP-1. ALL CONTROLLERS ARE TO BE PROPERLY AND PERMANENTLY WIRED WITH MINICLICK FREEZE SENSOR OR EQUAL.

USE CLEAN AND APPROVED LOAM TO BACKFILL ALL PIPE TO A DEPTH OF AT LEAST 6" ABOVE TOP OF PIPE. ALL HEADS AND BOXES ARE TO BE BACKFILLED TO GRADE WITH LOAM. REMAINDER OF TRENCH MAY BE FILLED USING CLEAN AND APPROVED SOIL. NO ROCKS GREATER THAN 1" ARE ALLOWED. COMPACT TRENCHES TO ALLEVIATE SETTLING.

ALL SLEEVES WILL BE SCHEDULE 40 PVC WITH SIZE AND APPROPRIATE LOCATION NOTED ON THE PLAN. ALL PIPING UNDERNEATH PAVING INCLUDING SIDEWALKS MUST BE SLEEVED.

USE APPROPRIATE AND APPROVED PVC SOLVENT. AVOID EXCESSIVE USE AND WIPE ALL JOINTS AND FITTINGS CLEAN.

THE INSTALLER IS RESPONSIBLE FOR RESETTING HEAD AND/OR BOX HEIGHT DUE TO SETTLING. CONTRACTOR MUST OBTAIN A WORKMANSHIP WARRANTY FOR (1) YEAR FROM DATE OF COMPLETION.

MODIFY PER CITY CENTRAL CONTROL STANDARD

## IRRIGATION LEGEND

- TORO 570Z MPR 4" POP-UP SPRAY HEAD w/10 NOZZLE
- TORO 570Z MPR 4" POP-UP SPRAY HEAD w/12 NOZZLE
- △ TORO 570Z MPR 4" POP-UP SPRAY HEAD w/15 NOZZLE
- ⊕ WEATHERMATIC 11000CR SERIES VALVE w/ XPR PRESSURE REGULATOR, 2"
- IRRIGATION SYSTEM LATERAL PIPING, SIZE AS NOTED
- IRRIGATION SYSTEM MAINLINE PIPING, 2"
- == SCHEDULE 40 PVC SLEEVE, 6"
- ⊞ FEBCO 805-Y DOUBLE CHECK ASSEMBLY, 2"
- M 1/2" WATER METER
- BALL VALVE, 1/2"
- ▼ 3/4" QUICK COUPLING VALVE
- RAIN MASTER 'EVOLUTION' 12 STATION CONTROLLER, WALL MOUNT SYSTEM

A? -STATION  
2" -VALVE SIZE  
XX.XX -GPM

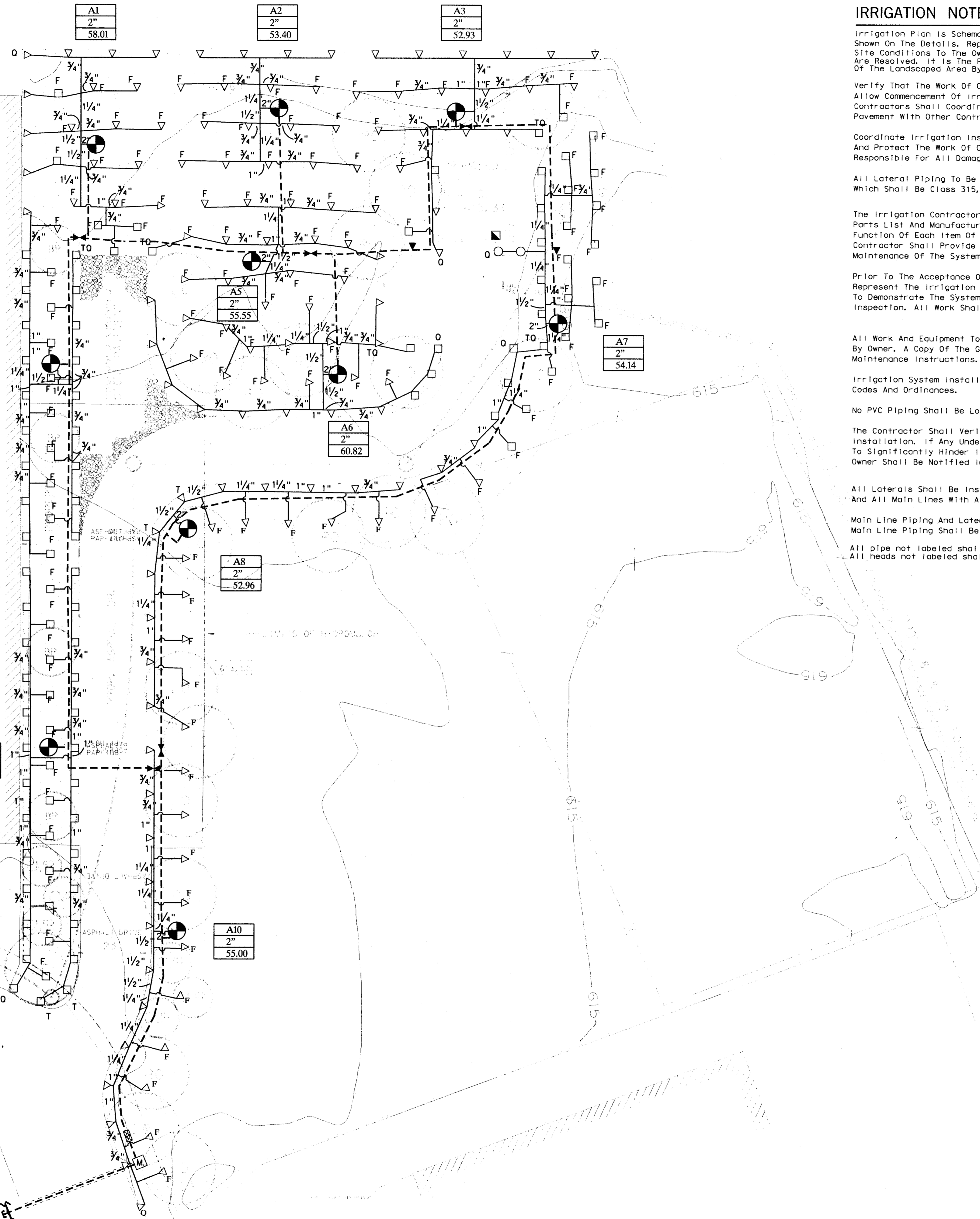

CONTRACTOR TO TAP INTO EXISTING CITY WATER MAIN AND BURE UNDER STREET TO PROPOSED WATER METER

## IRRIGATION NOTES

1. Irrigation Plan Is Schematic. All Piping Heads, Valves, Etc. Shall Be Located As Shown On The Details. Report Any Discrepancies Between Actual And Proposed Site Conditions To The Owner. Do Not Proceed With Work Until Said Discrepancies Are Resolved. It Is The Responsibility Of The Contractor To Achieve Full, Even Coverage Of The Landscaped Area By Adjustments To Head Locations Or Headings As Necessary.

2. Verify That The Work Of Other Contractors/Trades Is Sufficiently Complete To Allow Commencement Of Irrigation Installation Prior To Beginning Work. Contractors Shall Coordinate Installation Of All Irrigation Sleeves Under Pavement With Other Contractors.

3. Coordinate Irrigation Installation With The Work Of Other Contractors/Trades And Protect The Work Of Other Contractor/Trades. Irrigation Contractor Is Responsible For All Damages Resulting From His Actions.

4. All Lateral Piping To Be PVC Class 200, SDR 21 With Solvent Welded Joints. Except 1/2" Pipe Which Shall Be Class 315, SDR 13.5.

5. The Irrigation Contractor Shall Provide The Owner With Two Copies Of The Parts List And Manufacturer's Catalog Showing Performance, Quality And Function Of Each Item Of Equipment In The System. In Addition, The Irrigation Contractor Shall Provide The Owner Written Instructions For Operation And Maintenance Of The System.

6. Prior To The Acceptance Of Irrigation System By Owner, A Person Qualified To Represent The Irrigation Contractor Shall Be Present At The Final Inspection To Demonstrate The System And Prove Its Performance Prior To The Inspection. All Work Shall Have Been Completed, TESTED, Adjusted And Placed

7. All Work And Equipment To Be Guaranteed For One Year From Date Of Acceptance By Owner. A Copy Of The Guarantee Shall Be Included In The Operation/Maintenance Instructions.

8. Irrigation System Installation To Be Performed In Accordance With All Pertinent Codes And Ordinances.

9. No PVC Piping Shall Be Located Under Tree Rootballs.

10. The Contractor Shall Verify Location Of All Underground Utilities Prior To Installation. If Any Underground Or Above Ground Construction Is Located As To Significantly Hinder Installation Or Function Of The Irrigation System, The Owner Shall Be Notified Immediately.

11. All Laterals Shall Be Installed With 12" Minimum Coverage Over Pipes At Finish Grade And All Main Lines With At Least 18" Minimum Coverage.

12. Main Line Piping And Lateral Piping May Be Placed In Same Trench When Possible. Main Line Piping Shall Be Installed In Bottom Of Trench With Laterals Above.

13. All pipe not labeled shall be 1/2" class 315 PVC. All heads not labeled shall be half or 180° pattern.

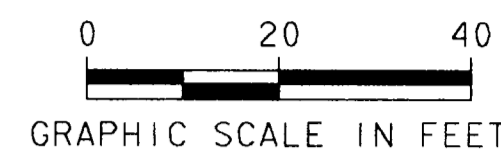

4			
3			
2			
1	9-4-98	AS BUILT DRAWING	J. H. L.
NO.	DATE	REVISION	APPROV.

TOWN OF ADDISON, TEXAS  
MIDWAY/BELTLINE SANITARY SEWER  
PHASE II  
LIFT STATION  
IRRIGATION PLAN

**Carter Burgess**

Consultants in Engineering, Architecture,  
Planning and the Environment  
CARTER & BURGESS, INC.  
7500 EMBROOK DRIVE, SUITE 250  
DALLAS, TX 75247-4961

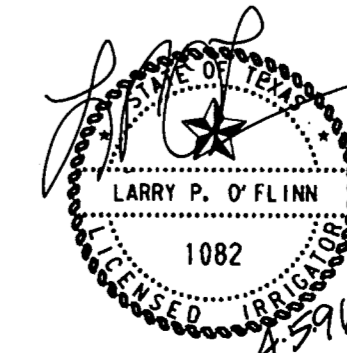

Unit	Scale	1" = 20'	Date	04-05-96	
Designed	B. Luck	Checked	J. Lindner	Job No.	933276010
Drawn	B. Luck	Approved	J. Lindner	Sheet	62 of 63