

Belt Line Road S. 89°37'17"E

Begin This Project
Sta. 0+80.50

STA. 2+00
Begin Paving
This Project

STA. 5+00

Sta. 52+44.36 Belt Line Rd.
Sta. 0+00 Midway Road

CURVE DATA
 $\Delta = 11^\circ 44' 20''$
 $R = 954.93'$
 $T = 98.17'$
 $L = 195.65'$

Record Drawing 4/9/85

B.M. #1 On N.W. Corner Parking To Gulf Gas Station
at S.W. Corner Inter. Belt Line & Midway Rd. Elev. 624.32
 B.M. #2 On S.E. Corner Of Conc. Walk To Bldg. At
15101 Midway Rd. Elev. 614.84

BY OTHERS THIS PROJECT

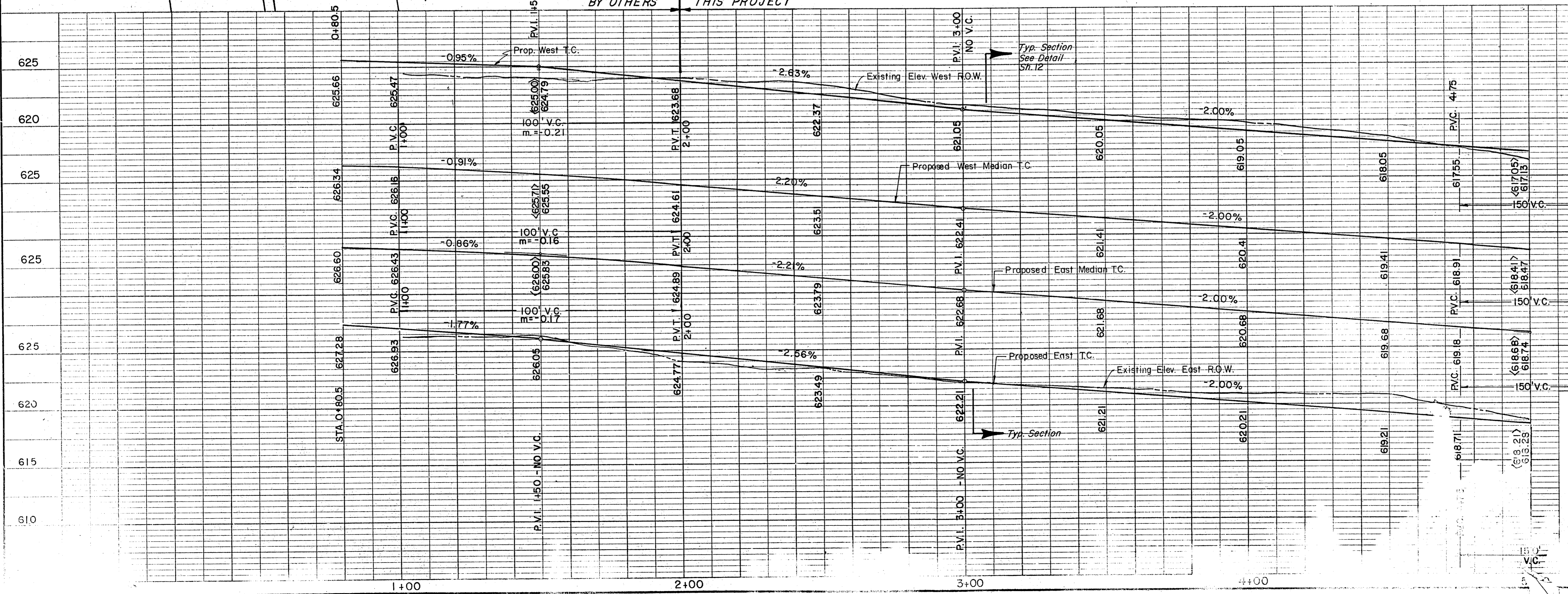

MOVED
 DELETED
 NO
 MIDWAY
 GINN, INC.
 DESIGNED - H
 APPROVED - T