

FH RELOCATION DETAIL

CONTRACTOR SHALL NOTIFY LONE STAR GAS, SOUTHWESTERN BELL, TP&L AND TOWN OF ADDISON UTILITY DEPT. 24 HOURS PRIOR TO BEGINNING CONSTRUCTION OF UTILITIES

TBM  
 CHISELED IN CONC. BASE OF LIGHT POLE. ELEV. 100.00

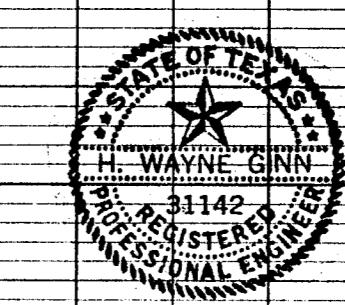
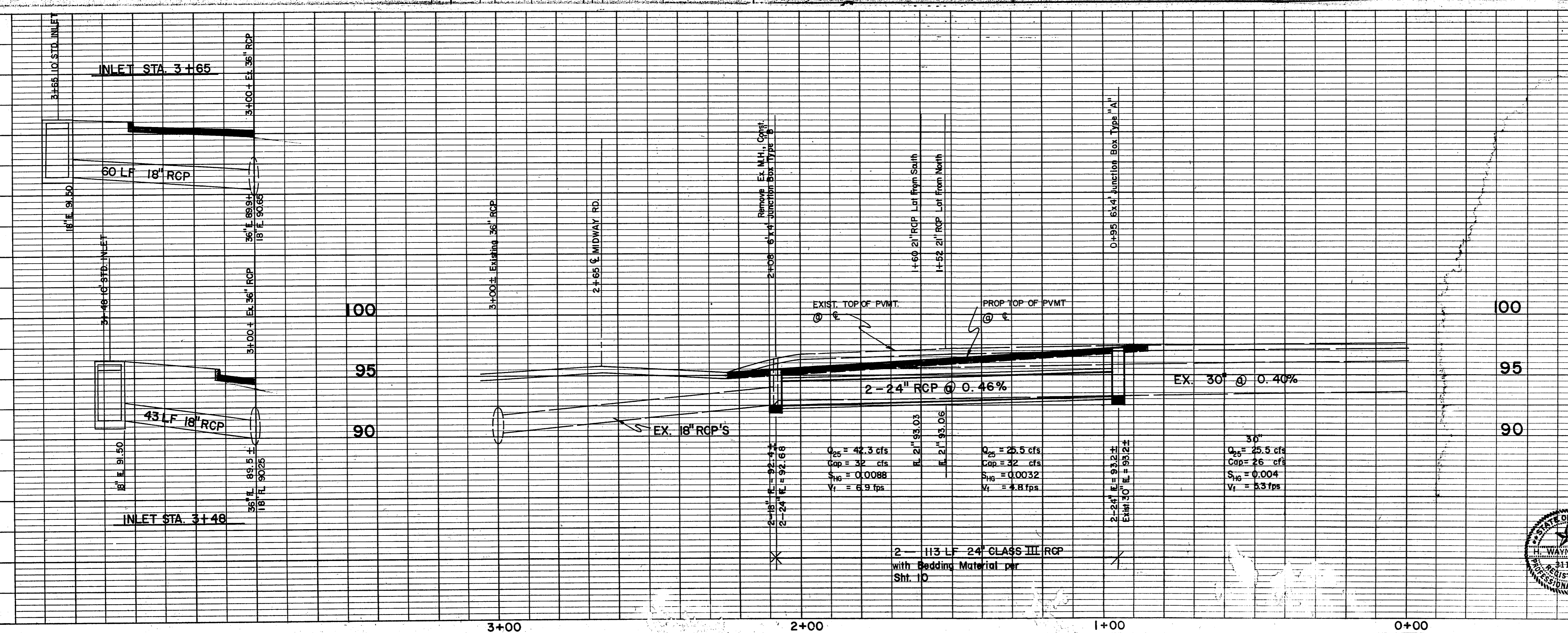

No.	Revision	By	Date
<b>MIDWAY ROAD / BELTWAY ROAD INTERSECTION MODIFICATIONS</b>			
<b>STORM SEWER &amp; UTILITIES</b>			
<b>GINN, INC.</b>			
Consulting Engineers Dallas, Texas			
Designed - RCH	Drawn - ALA	Date - MARCH 1986	Job No. - 288
Approved - HWG	Checked - RCH	Scale - 1" = 20' Horiz. 1" = 5' Vert.	Sheet 5 of 15