

# PLANS FOR THE CONSTRUCTION OF

# MIDWAY ROAD

FROM : SPRING VALLEY ROAD  
TO : BELT LINE ROAD

A COOPERATIVE EFFORT OF :

THE CITY OF FARMERS BRANCH, TEXAS  
THE CITY OF ADDISON, TEXAS  
THE COUNTY OF DALLAS, TEXAS

PLANS PREPARED BY THE  
ENGINEERING DIVISION OF THE  
PUBLIC WORKS DEPARTMENT OF  
THE CITY OF FARMERS BRANCH, TEXAS

SUBMITTED: March 17<sup>th</sup>, 1978

*Richard Lee Pickings, P.E.*

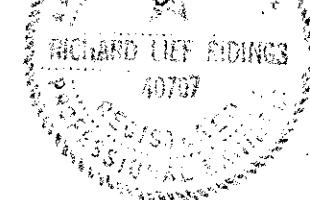

CITY OF FARMERS BRANCH

APPROVED: May 24<sup>th</sup>, 1978

*Paul M. West*  
PAUL M. WEST  
CITY MANAGER

CITY OF ADDISON

APPROVED: May 25<sup>th</sup>, 1978

*John Milligan*  
JOHN MILLIGAN  
CITY ADMINISTRATOR

COUNTY OF DALLAS

APPROVED: \_\_\_\_\_, 1978

*C. Judson Shook, P.E.*  
C. JUDSON SHOOK, P.E.  
DIRECTOR OF PUBLIC WORKS

## INDEX TO SHEETS

SHEET NO.	DESCRIPTION
1	TITLE SHEET with LOCATION MAP and INDEX to SHEETS
2	TYPICAL STREET SECTION with NOTES
3	STREET PLAN and PROFILE : STA. 51+00 to 56+00
4	" " " : STA. 56+00 to 61+00
5	STREET PLAN and PROFILE : STA. 61+00 to 66+00
6	" " " : STA. 66+00 to 71+00
7	STREET PLAN and PROFILE : STA. 71+00 to 76+00
8	" " " : STA. 76+00 to 81+00
9	STREET PLAN and PROFILE : STA. 81+00 to 86+00
10	" " " : STA. 86+00 to 91+00
11	STREET PLAN and PROFILE : STA. 91+00 to 96+00
12	" " " : STA. 96+00 to 101+00
13	STREET PLAN and PROFILE : STA. 101+00 to END of PROJECT
14	STORM SEWER PROFILE
15	" " "
16	STORM SEWER PROFILE
17	CONSTRUCTION PAVING DETAILS
18	" " "
19	CURB INLET DETAILS
20	UTILITY DETAILS : WATER
21	" " : SANITARY SEWER
22	SPECIAL DETAILS

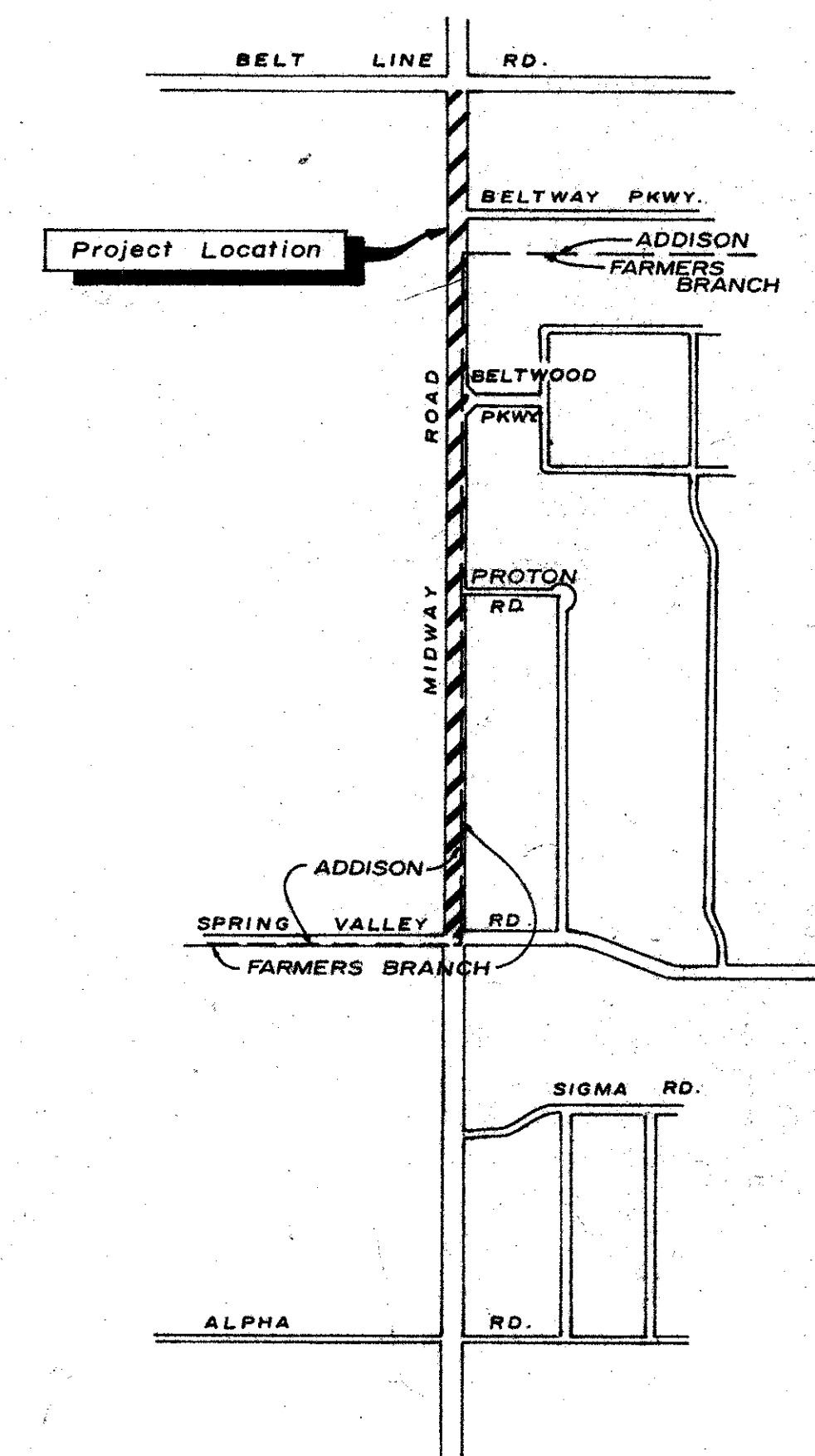

LOCATION MAP

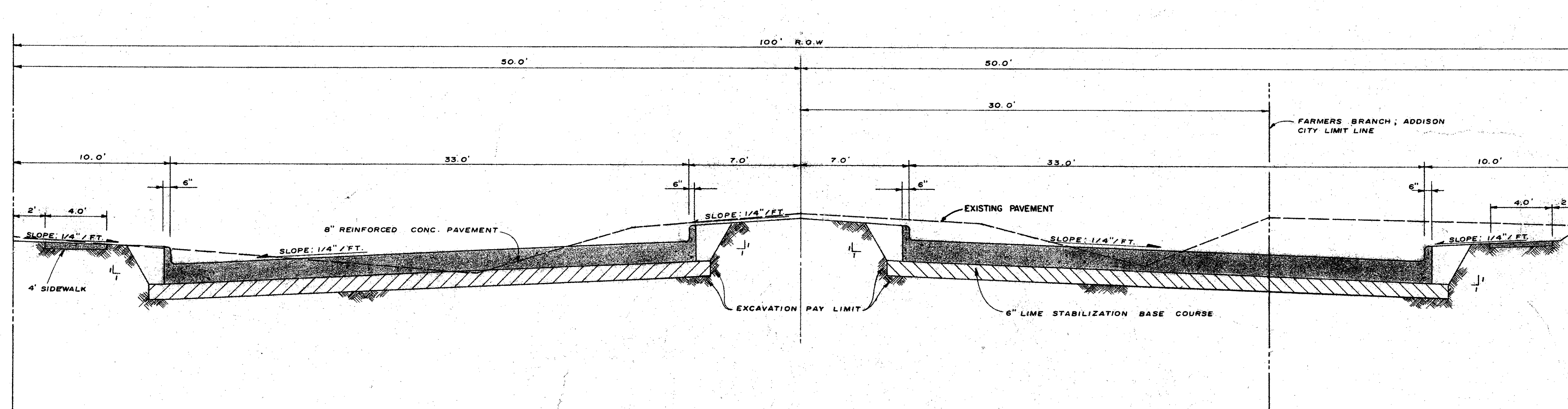

**TYPICAL PAVEMENT SECTION**

Scale: 1"=40' HORIZ; 1"=2' VERT.

**GENERAL NOTES:**

1. SIDEWALKS TO BE CONSTRUCTED WHERE NEEDED.
2. ADDITIONAL ITEMS CONSIDERED AS PART OF THIS PROJECT INCLUDE A SPRINKLER SYSTEM FOR THE MEDIAN AND RIGHT-OF-WAY, A SYSTEM OF STREET LIGHTS TO BE LOCATED IN THE MEDIAN AND A NEW TRAFFIC SIGNAL SYSTEM AT THE INTERSECTION OF MIDWAY ROAD AND SPRING VALLEY ROAD. PLANS FOR THESE ITEMS WILL BE FURNISHED IN THE FUTURE. PVC CONDUIT STUB-OUTS WILL BE PROVIDED WHERE NEEDED TO FACILITATE THE INSTALLATION OF THESE SYSTEMS.
3. ALL CONSTRUCTION SHALL CONFORM TO THE STANDARD SPECIFICATIONS OF THE CITY OF FARMERS BRANCH.

NO.	REVISION	BY	DATE
<b>CITY OF FARMERS BRANCH, TEXAS</b> PUBLIC WORKS DEPARTMENT ENGINEERING DIVISION			
<b>MIDWAY ROAD PAVING</b> SPRING VALLEY RD TO BELT LINE RD.			
DRAWN BY	D.D.	APPROVED BY	
DESIGNED BY	J.P.	DATE	3-79
PROJECT NO.	SCALE: 1"=20' H. 1"=5' V.	SHEET	2 OF



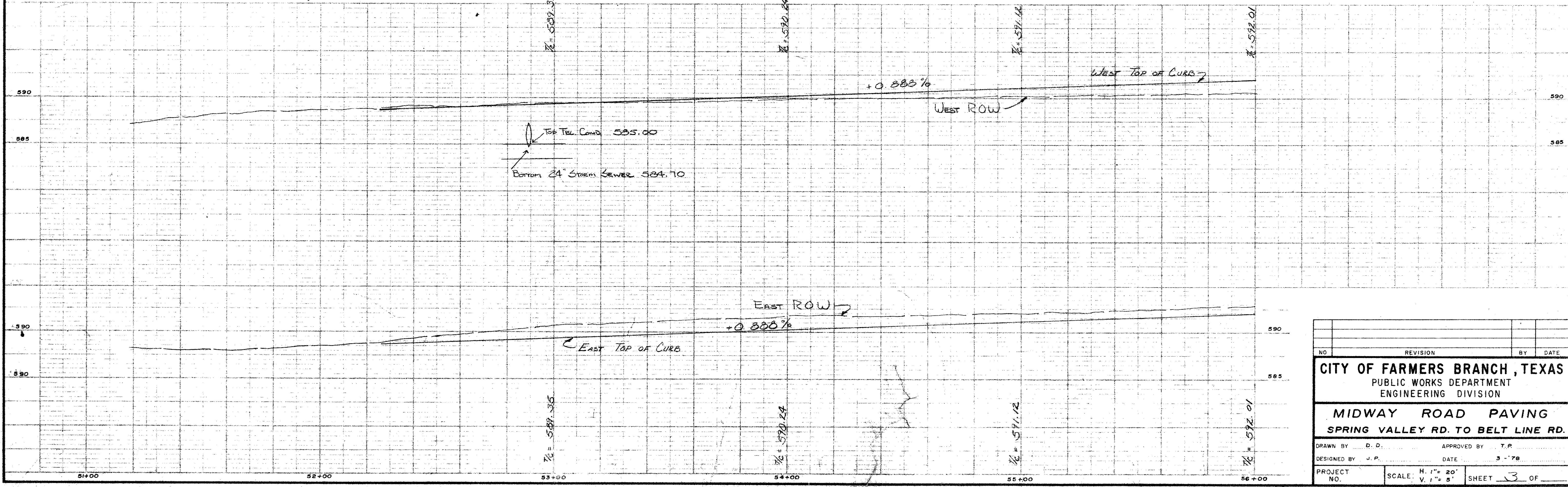
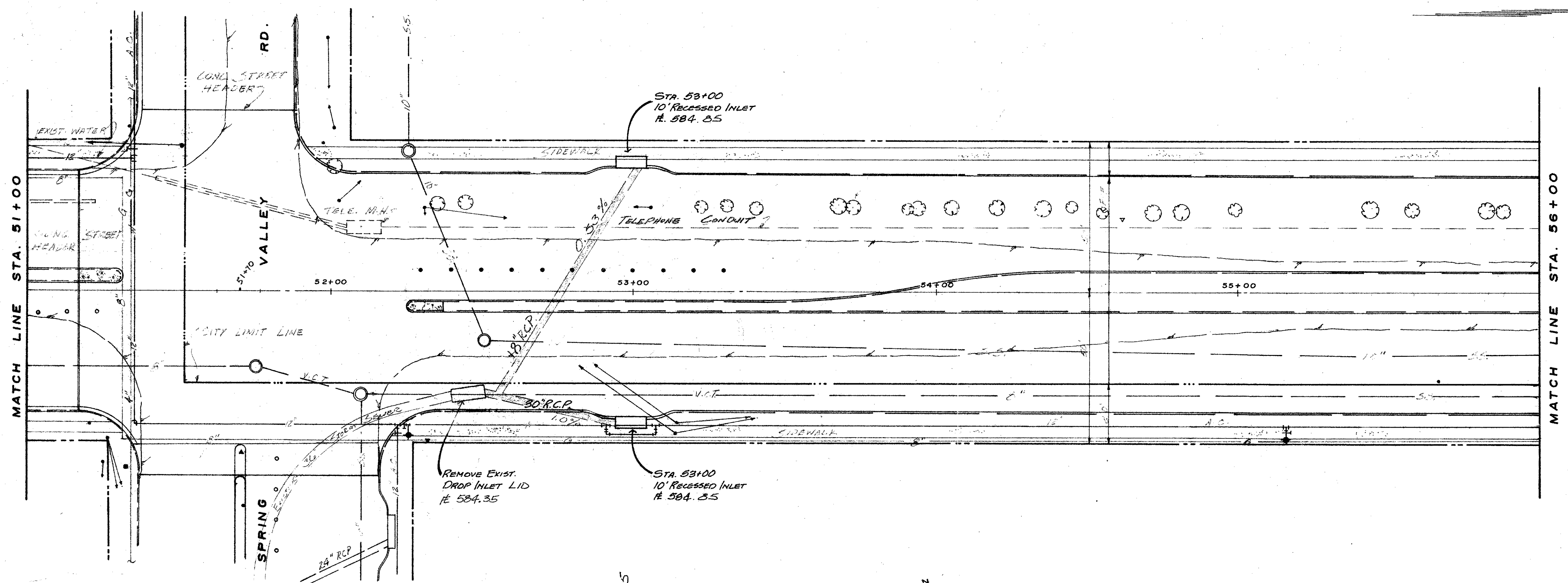
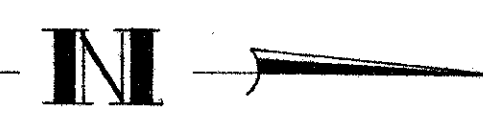

NO.	REVISION	BY	DATE
<b>CITY OF FARMERS BRANCH, TEXAS</b> PUBLIC WORKS DEPARTMENT ENGINEERING DIVISION			
<b>MIDWAY ROAD PAVING</b> SPRING VALLEY RD. TO BELT LINE RD.			
DRAWN BY	D. D.	APPROVED BY	T. P.
DESIGNED BY	J. P.	DATE	3-78
PROJECT NO.	SCALE: H. 1" = 20' V. 1" = 5'	SHEET	3 OF

F 284 PD



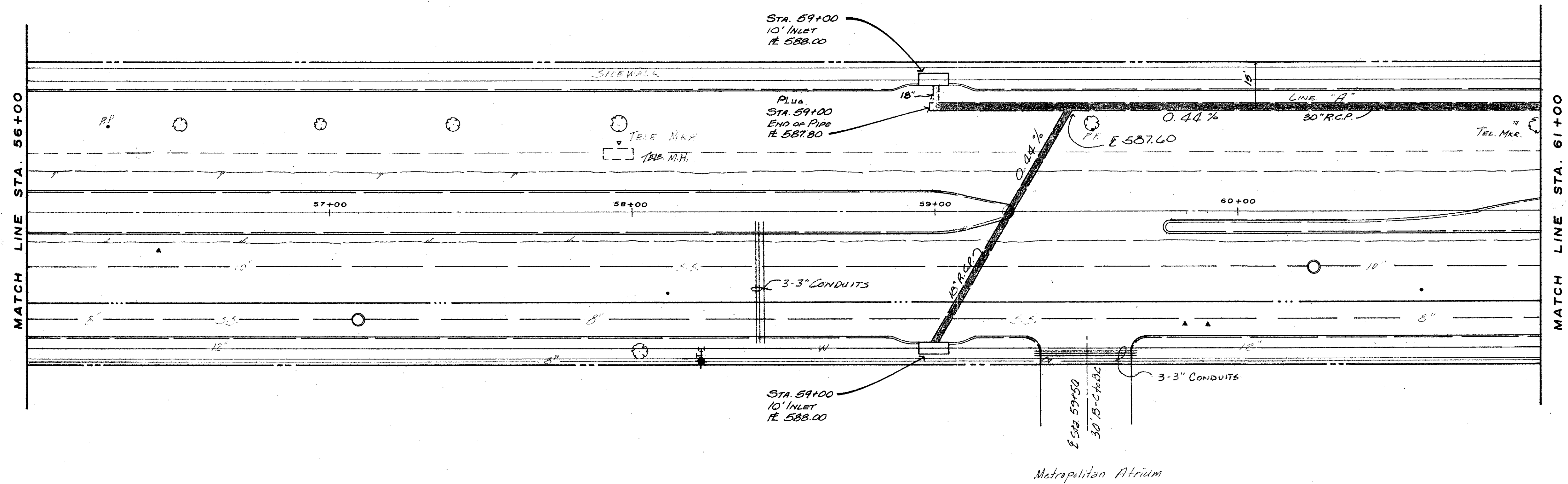

of  
2 700

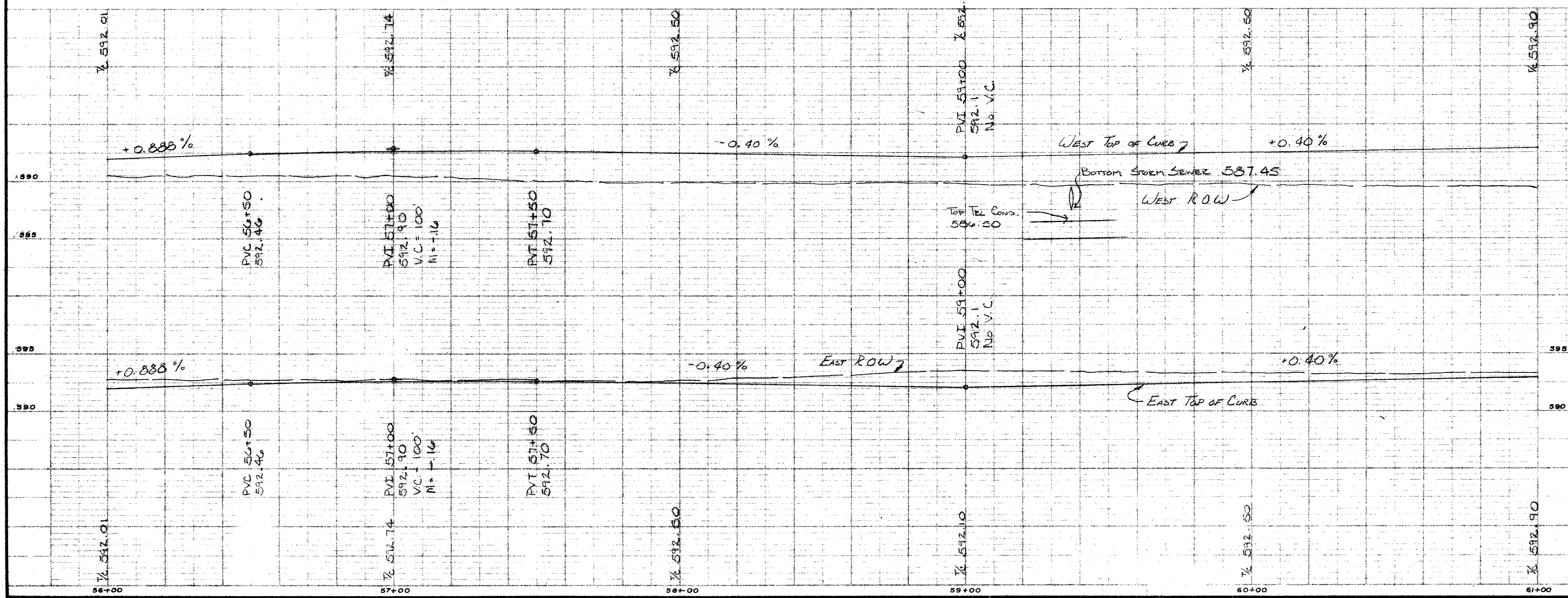

NO.	REVISION	BY	DATE

**CITY OF FARMERS BRANCH, TEXAS**  
PUBLIC WORKS DEPARTMENT  
ENGINEERING DIVISION

**MIDWAY ROAD PAVING**  
SPRING VALLEY RD. TO BELT LINE RD.

DRAWN BY D.D. APPROVED BY T.  
DESIGNED BY J.P. DATE 3-78

PROJECT NO. SCALE H. 1" = 20'  
V. 1" = 5' SHEET 4 OF



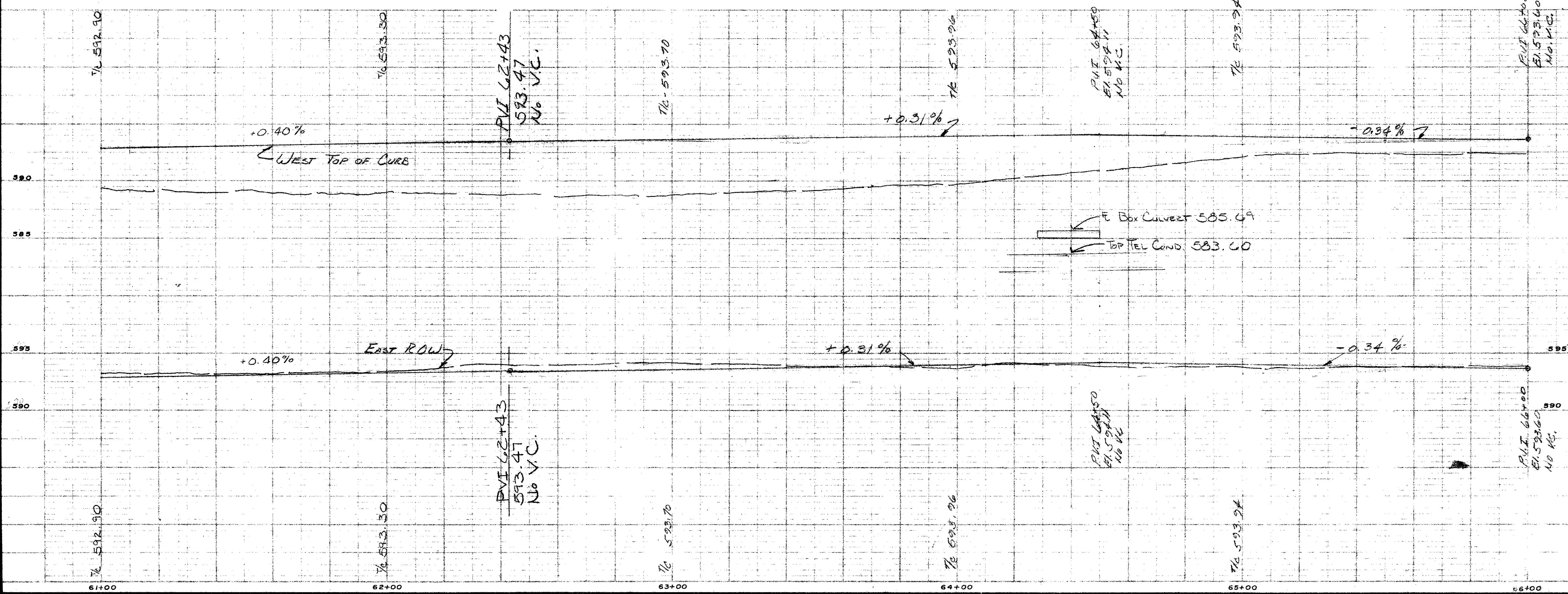
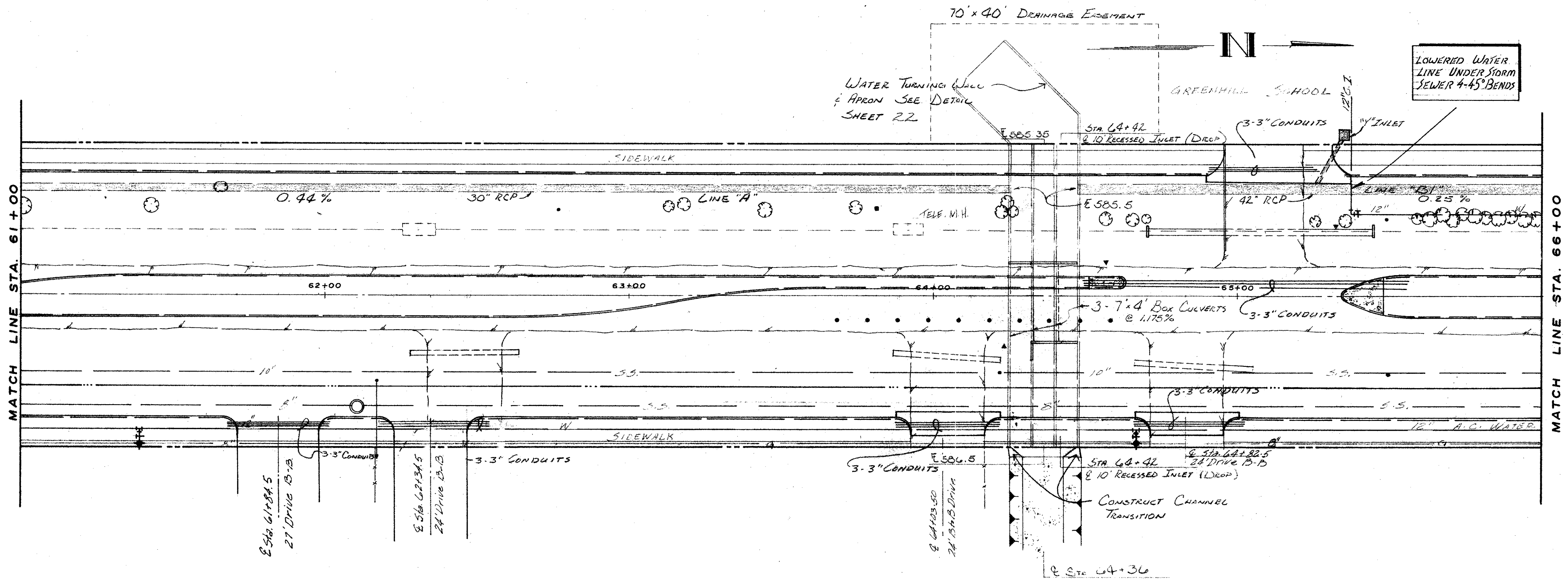

CHANGE IN T/C ELEVATION STATIONS 62+43 TO 66+00			3	3/19
NO.	REVISION	BY	DATE	
<b>CITY OF FARMERS BRANCH, TEXAS</b> PUBLIC WORKS DEPARTMENT ENGINEERING DIVISION				
<b>MIDWAY ROAD PAVING</b> SPRING VALLEY RD. TO BELT LINE RD.				
DRAWN BY D.D.		APPROVED BY		
DESIGNED BY J.P.		DATE 3-'78		
PROJECT NO.	SCALE: H. 1"=20' V. 1"=5'	SHEET 5 OF		







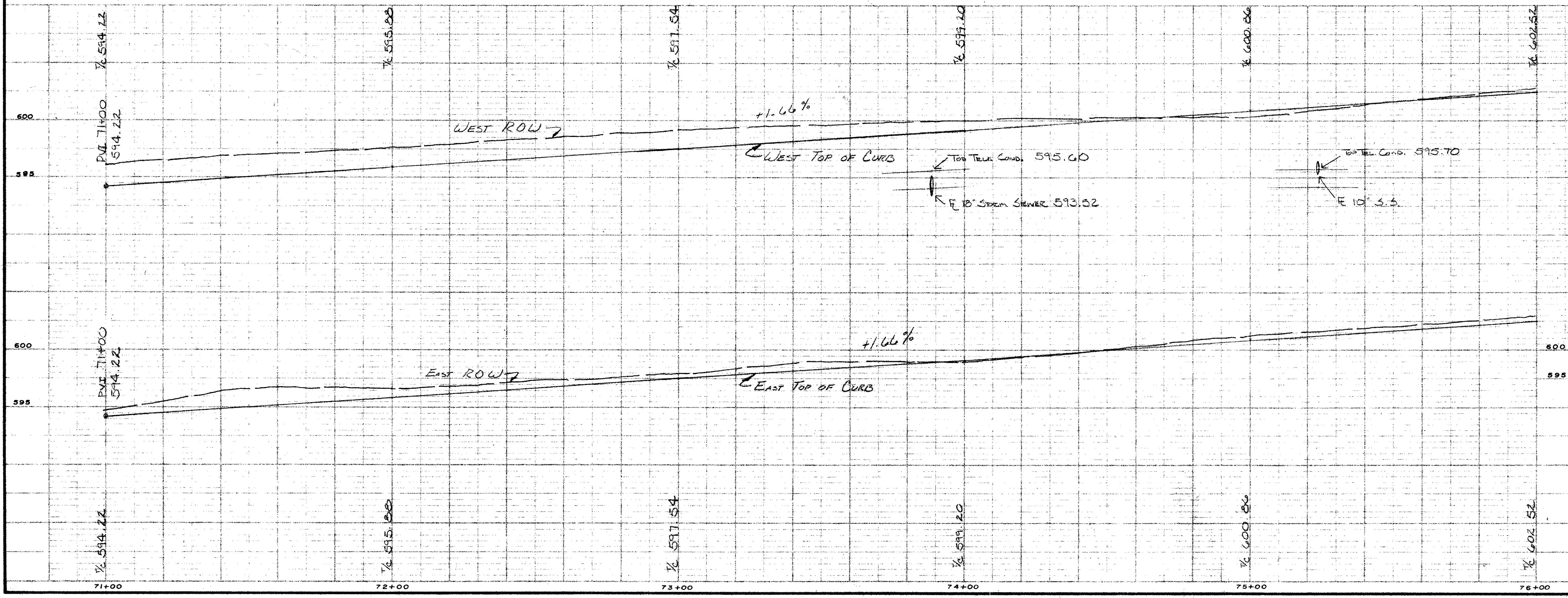
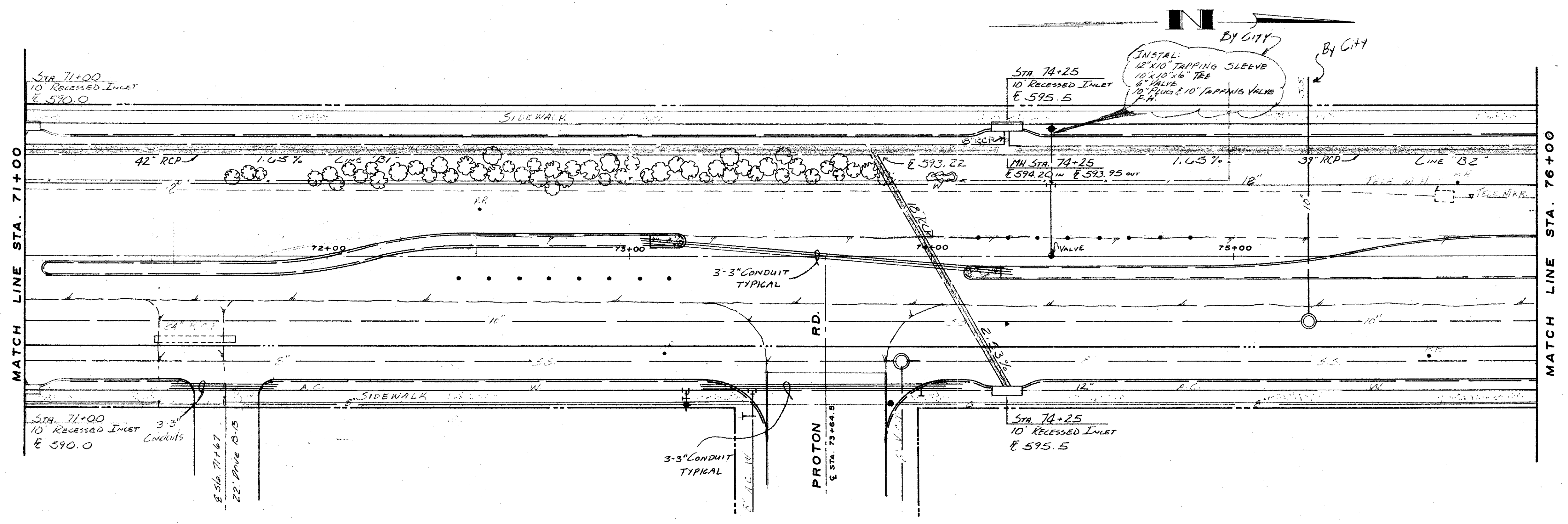

NO.	REVISION	BY	DATE
<b>CITY OF FARMERS BRANCH, TEXAS</b> PUBLIC WORKS DEPARTMENT ENGINEERING DIVISION			
<b>MIDWAY ROAD PAVING</b> <b>SPRING VALLEY RD. TO BELT LINE RD.</b>			
DRAWN BY D. D.		APPROVED BY	
DESIGNED BY J. P.		DATE 3-78	
PROJECT NO.	SCALE H. 1"=20' V. 1"=5'	SHEET 1 OF	







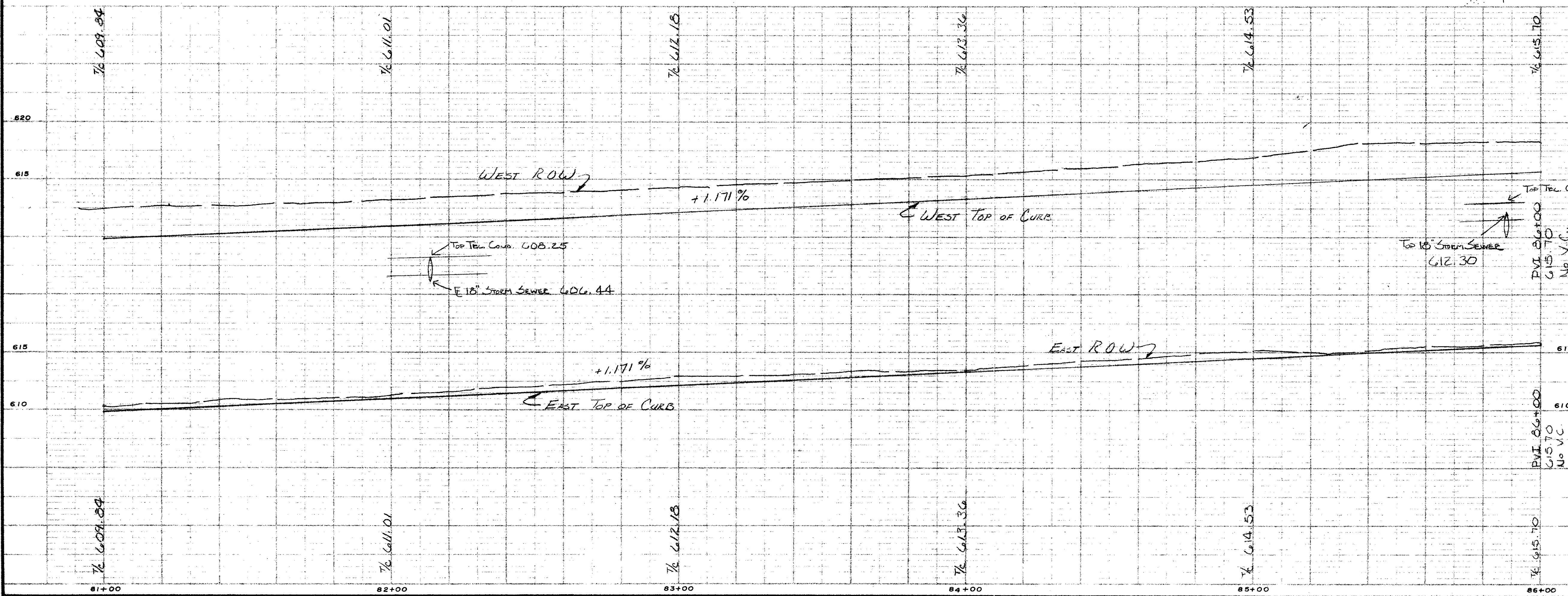
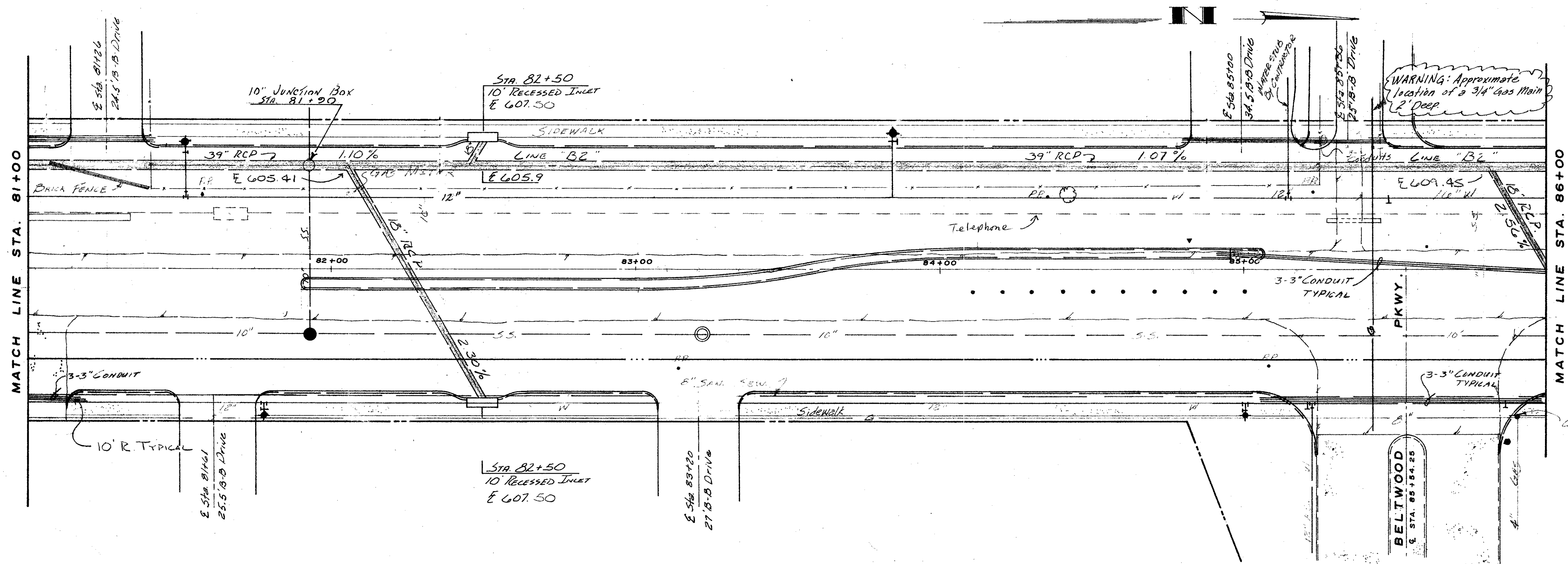

NO.	REVISION	BY	DATE

**CITY OF FARMERS BRANCH, TEXAS**  
 PUBLIC WORKS DEPARTMENT  
 ENGINEERING DIVISION

**MIDWAY ROAD PAVING**  
 SPRING VALLEY RD. TO BELT LINE RD.

DRAWN BY D. D. APPROVED BY \_\_\_\_\_  
 DESIGNED BY J. P. DATE 3-78

PROJECT NO. \_\_\_\_\_ SCALE H. 1" = 20'  
 V. 1" = 5' SHEET 9 OF \_\_\_\_\_



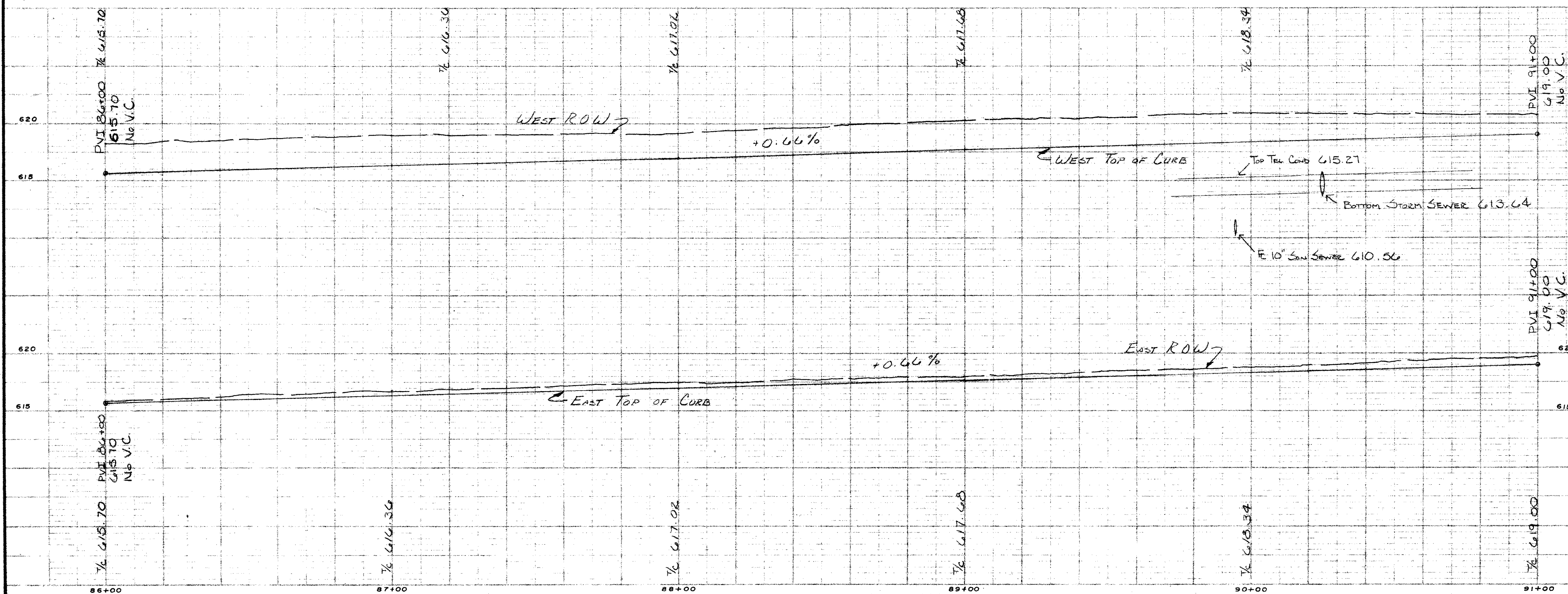
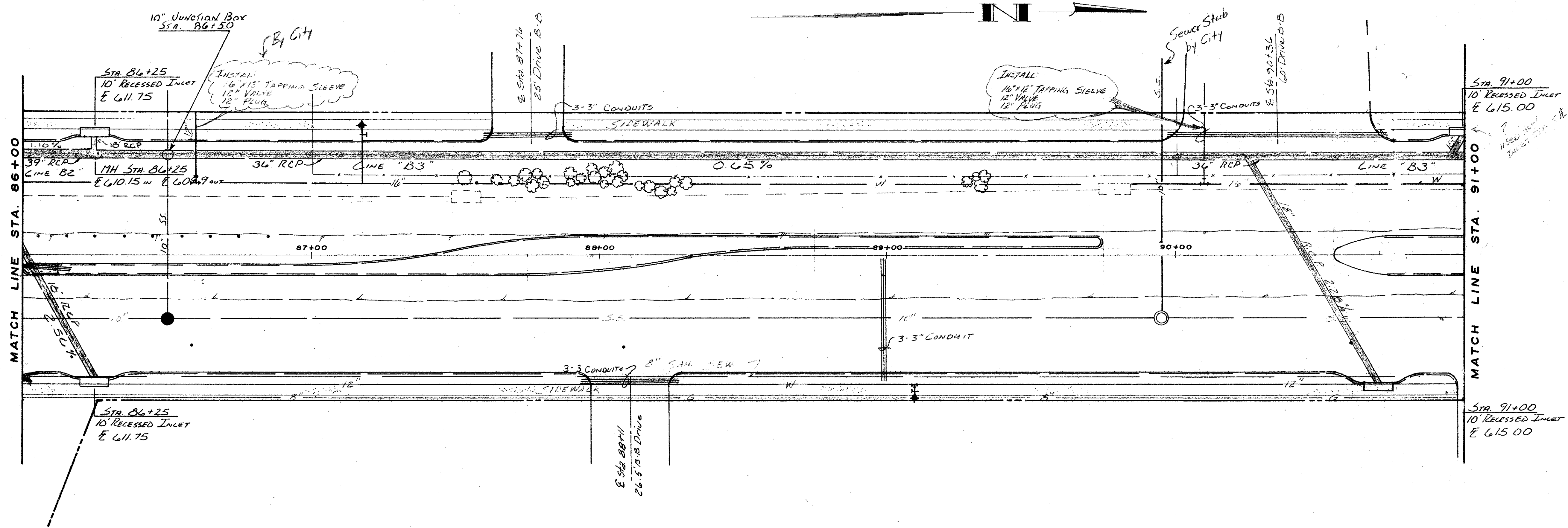

NO.	REVISION	BY	DATE
<b>CITY OF FARMERS BRANCH, TEXAS</b> PUBLIC WORKS DEPARTMENT ENGINEERING DIVISION			
<b>MIDWAY ROAD PAVING</b> <b>SPRING VALLEY RD. TO BELT LINE RD.</b>			
DESIGNED BY	J. P.	APPROVED BY	
PROJECT NO.		DATE	3 - 78
SCALE: H. 1" = 20'		SHEET 10 OF 2	



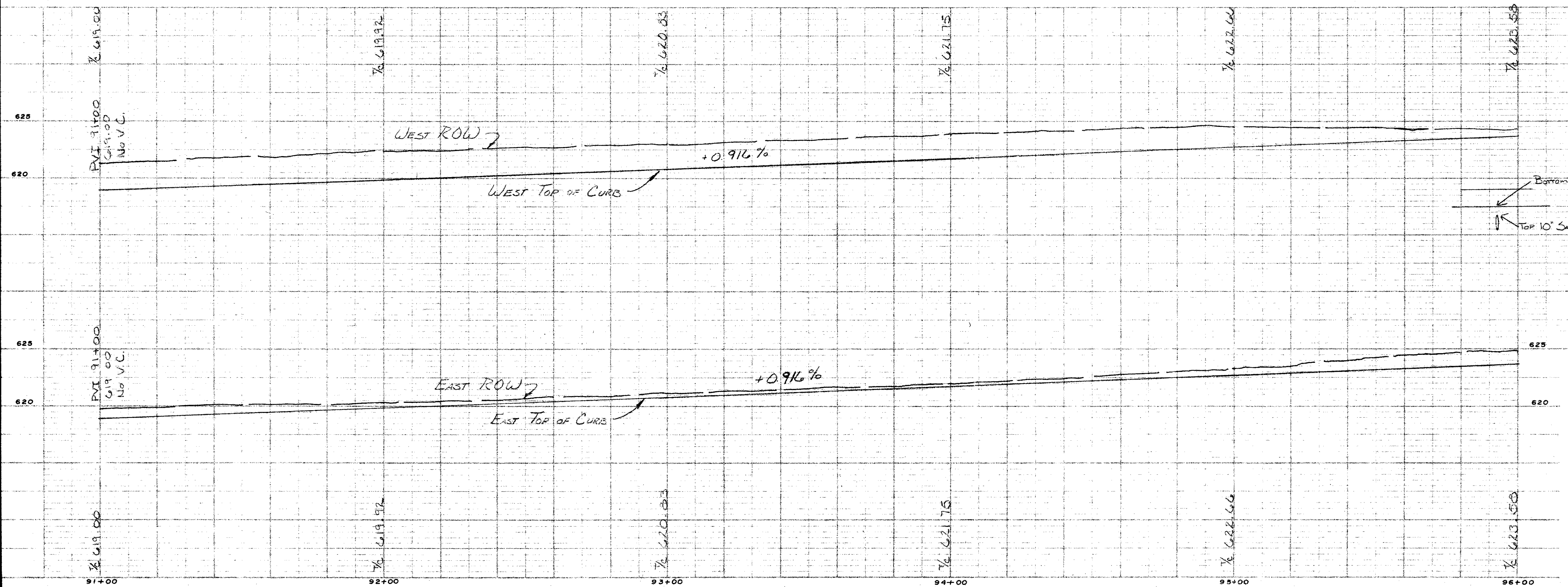
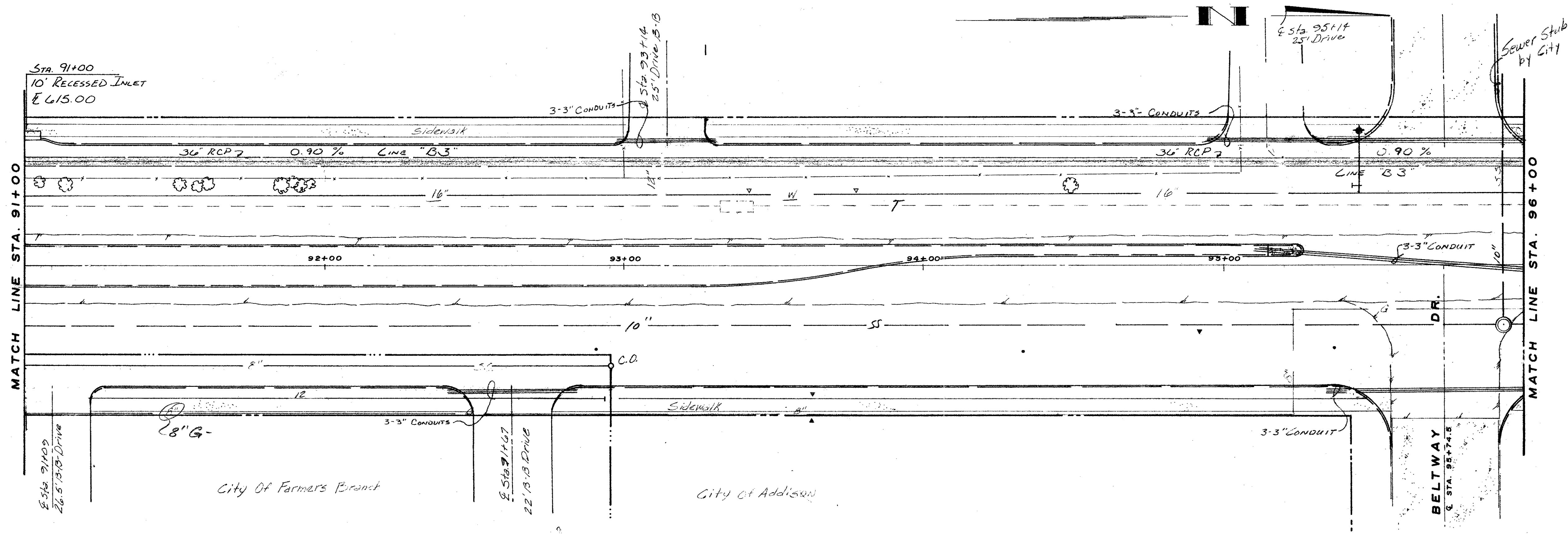

NO.	REVISION	BY	DATE
<b>CITY OF FARMERS BRANCH, TEXAS</b> PUBLIC WORKS DEPARTMENT ENGINEERING DIVISION			
<b>MIDWAY ROAD PAVING</b> <b>SPRING VALLEY RD. TO BELT LINE RD.</b>			
DRAWN BY	O. D.	APPROVED BY	
DESIGNED BY	J. P.	DATE	3 - '78
PROJECT NO.	SCALE: H. 1" = 20' V. 1" = 5'	SHEET	OF



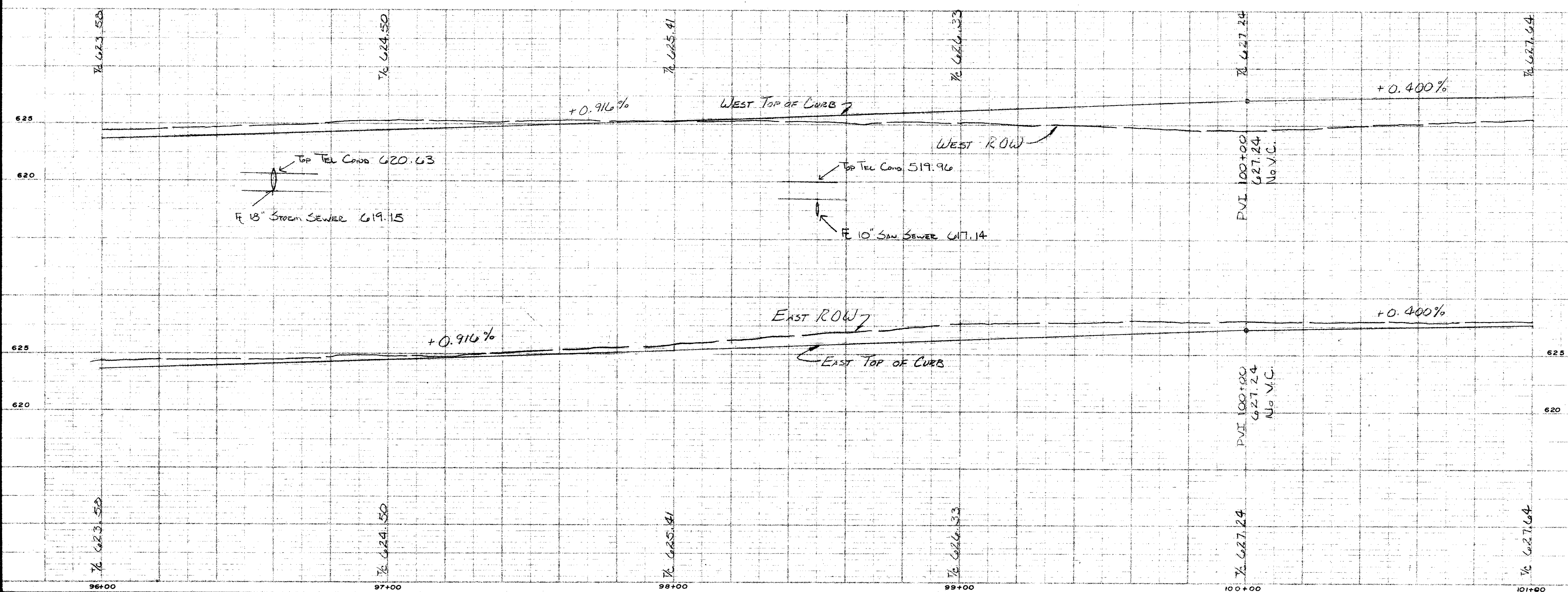
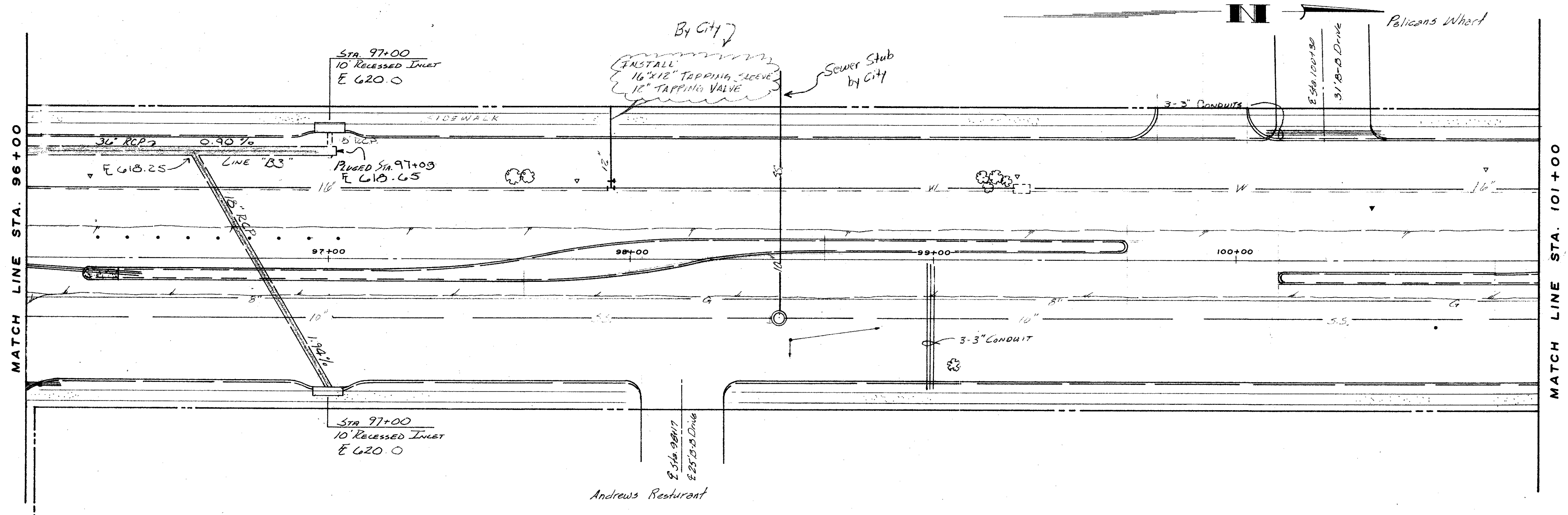

NO.	REVISION	BY	DATE

**CITY OF FARMERS BRANCH, TEXAS**  
PUBLIC WORKS DEPARTMENT  
ENGINEERING DIVISION

**MIDWAY ROAD PAVING**  
SPRING VALLEY RD. TO BELT LINE RD.

DRAWN BY D.D. APPROVED BY \_\_\_\_\_  
DESIGNED BY V.P. DATE 3-76

PROJECT NO. \_\_\_\_\_ SCALE H 1"=20'  
V 1"=5' SHEET 12 OF \_\_\_\_\_



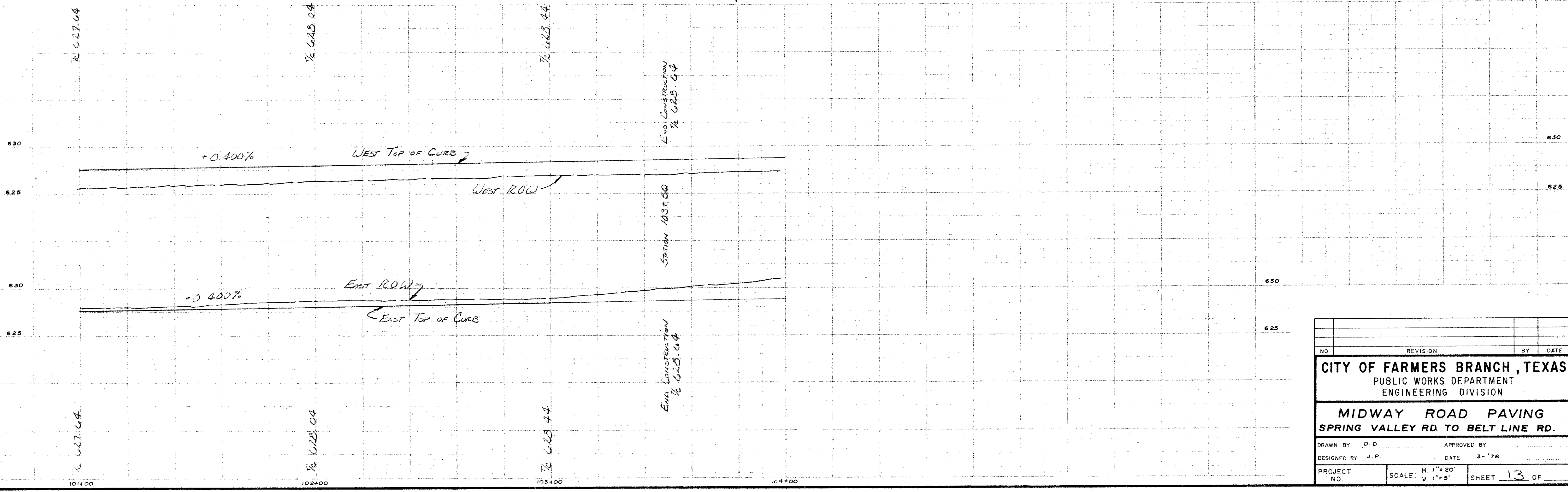
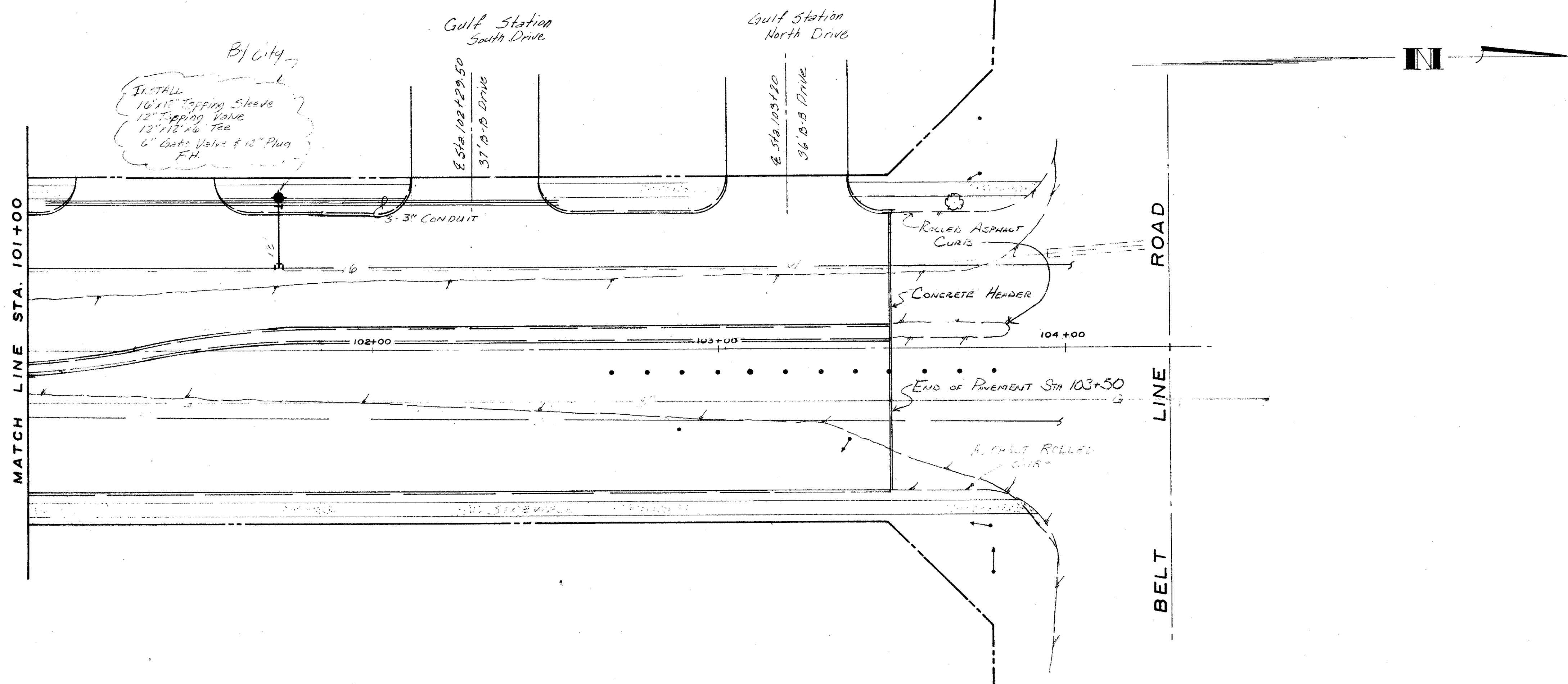

NO.	REVISION	BY	DATE
<b>CITY OF FARMERS BRANCH, TEXAS</b> PUBLIC WORKS DEPARTMENT ENGINEERING DIVISION			
<b>MIDWAY ROAD PAVING</b> <b>SPRING VALLEY RD. TO BELT LINE RD.</b>			
DRAWN BY	D. D.	APPROVED BY	
DESIGNED BY	J. P.	DATE	3-78
PROJECT NO.	SCALE	H. 1" = 20' V. 1" = 5'	SHEET 13 OF

284



