

EXISTING CONDITIONS

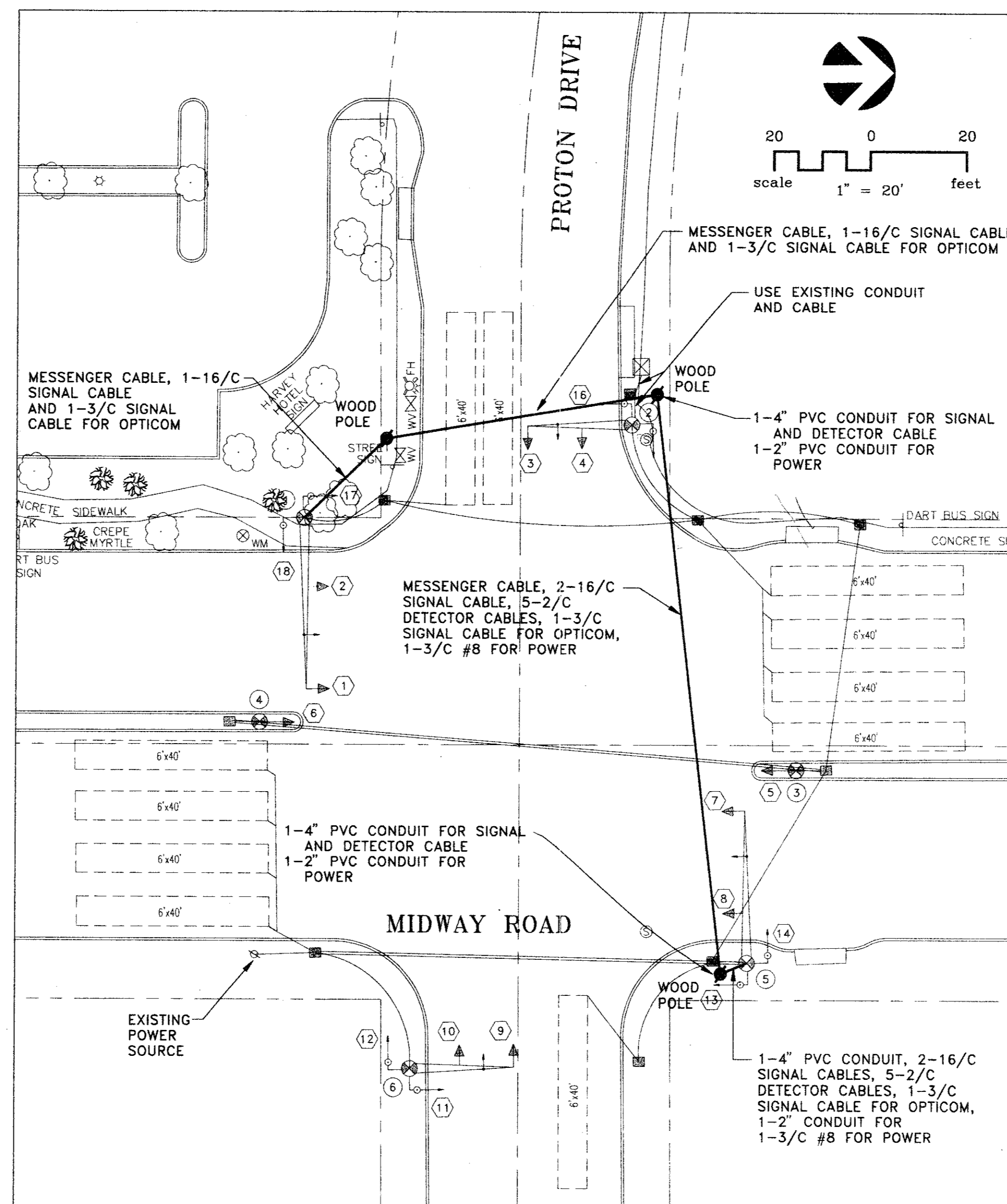

TEMPORARY TRAFFIC SIGNALS

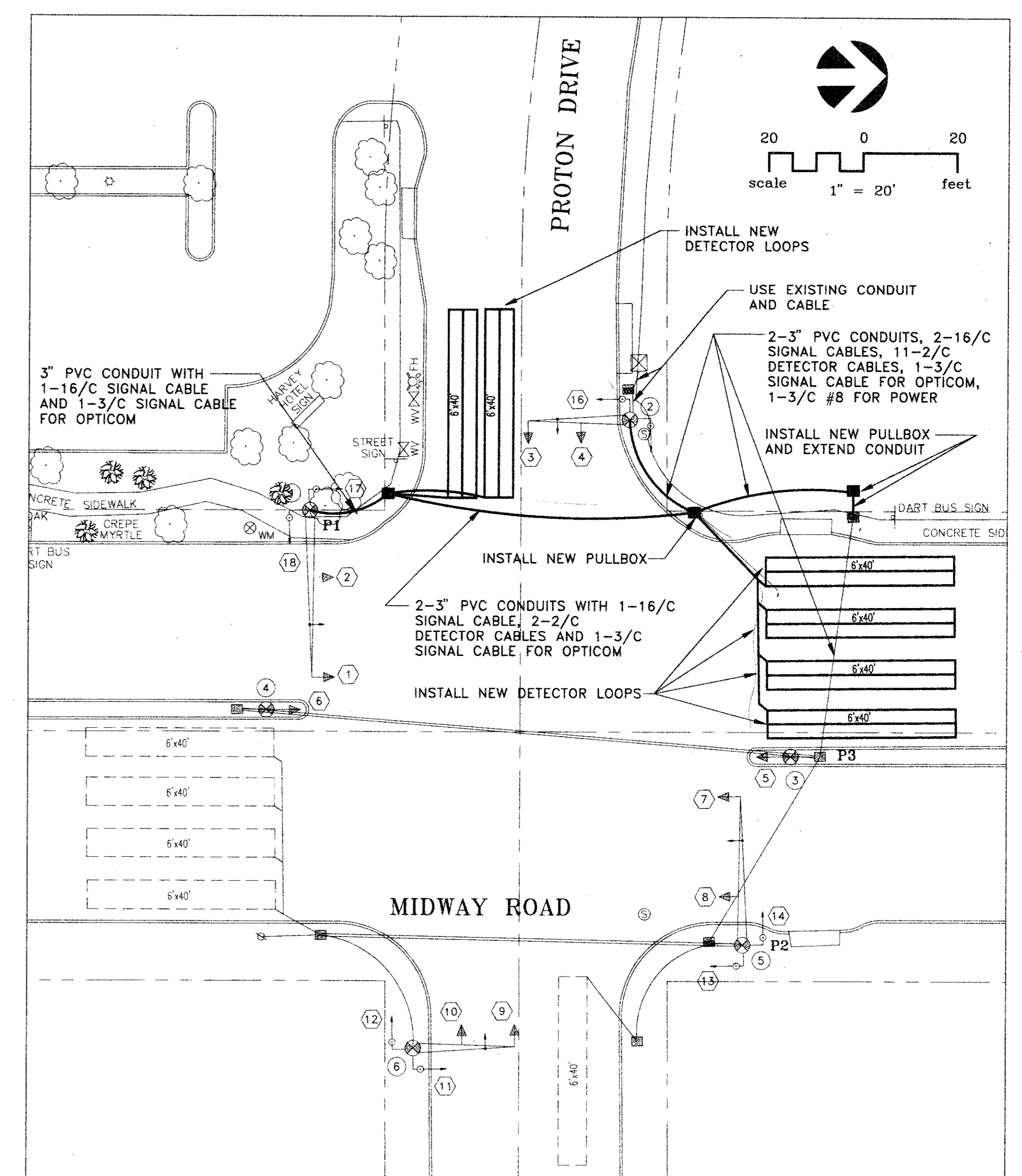

PERMANENT TRAFFIC SIGNALS

LEGEND

- PULLBOX
- WOOD POLE
- MESSENGER AND OTHER CABLE (EXIST.)
- MESSENGER AND OTHER CABLE (PROP.)
- CONDUIT AND CABLE
- 6"x40" DETECTOR LOOP (EXIST.) AND SIZE
- 6"x40" DETECTOR LOOP (PROP.) AND SIZE
- ① MAST-ARM POLE AND NO., SIGNAL HEAD AND NO.

NOTES:

1. CONTRACTOR SHALL INSTALL AND MAINTAIN TEMPORARY WOOD POLES, MESSENGER AND TRAFFIC SIGNAL CABLE AND POWER CABLE IN ACCORDANCE WITH THESE PLANS AND TOWN OF ADDISON SPECIFICATIONS.
2. CONTRACTOR SHALL MAINTAIN TRAFFIC SIGNALS IN OPERATION AT ALL TIMES. ANY SHUT-DOWN OF TRAFFIC SIGNALS SHALL BE APPROVED BY AND COORDINATED WITH THE TOWN OF ADDISON PUBLIC WORKS DEPARTMENT.
3. CONTRACTOR SHALL MAINTAIN MINIMUM OF 20 FEET OF CLEARANCE FROM BOTTOM OF MESSENGER CABLE TO STREET SURFACE.
4. CONTRACTOR SHALL INSTALL TEMPORARY CABLE ON EXISTING MAST ARM POLES BY ENTERING TOP OF MAST ARM POLE. CONTRACTOR SHALL INSTALL AND MAINTAIN PROTECTION FOR CABLE TO PREVENT IT FROM RUBBING AGAINST MAST ARM POLE AND BECOMING DAMAGED.

ESTIMATED QUANTITIES

| ITEM | QUANTITY |
|--------------------------|----------|
| Wood Pole with Down-guys | 3 |
| Messenger Cable | 225' |
| 16/C Signal Cable | 475' |
| 3/C Signal Cable | 285' |
| 3/C #8 Power Cable | 190' |
| Detector Cable | 950' |
| 4" PVC Conduit | 80' |
| 2" PVC Conduit | 100' |

NOTES:

1. INSTALL NEW PULLBOXES, CONDUIT, SIGNAL CABLE AND LOOP VEHICLE DETECTOR IN ACCORDANCE WITH THESE PLANS AND TOWN OF ADDISON SPECIFICATIONS.
2. CONTRACTOR SHALL MAINTAIN TRAFFIC SIGNALS IN OPERATION AT ALL TIMES. ANY SHUT-DOWN OF TRAFFIC SIGNALS SHALL BE APPROVED BY AND COORDINATED WITH THE TOWN OF ADDISON PUBLIC WORKS DEPARTMENT.

ESTIMATED QUANTITIES

| ITEM | QUANTITY |
|-----------------------|----------|
| 16/C Signal Cable | 370' |
| 3/C Signal Cable | 230' |
| 3/C #8 Power Cable | 145' |
| Detector Cable | 1,270' |
| Pullbox | 3 |
| 3" PVC Conduit | 305' |
| 6"x40' Loop Detectors | 6 |

CABLE TERMINATION CHART

| CNDR COLOR | CABLE 1 FROM P1 TO CNTRL 16 CNDR. | CABLE 2 FROM P2, P3 TO CNTRL 16 CNDR. |
|--------------|-----------------------------------|---------------------------------------|
| BLACK | SPARE | SPARE |
| WHITE | COMMON | COMMON |
| RED | SH1,2 R | SH5,7,8 R |
| GREEN | SH1,2 G | SH5,7,8 G |
| ORANGE | SH1,2 Y | SH5,7,8 Y |
| BLUE | SH17 W | SH5 -Y- |
| WHITE/BLACK | SH17 DW | SH5 -G- |
| RED/BLACK | SPARE | SPARE |
| GREEN/BLACK | SPARE | SH13 W |
| ORANGE/BLACK | SPARE | SH13 DW |
| BLUE/BLACK | SH18 W | SH14 W |
| BLACK/WHITE | SH18 DW | SH14 DW |
| RED/WHITE | PED CALL | PED CALL |
| GREEN/WHITE | SPARE | SPARE |
| BLUE/WHITE | SPARE | SPARE |
| BLACK/RED | PED CALL | PED CALL |

| NO. | REVISION | BY | DATE |
|-----|----------|----|------|
| | | | |
| | | | |
| | | | |

DESIGNED BY: JACK HATCHELL
 DRAWN BY: EH&A
 CHECKED BY: B GRANTHAM
 SCALE: 1" = 20'
 DATE: JULY 1995
 FILE: \MIDWAY\MIDSG2

William J. Hatcher
 9/12/95

EH&A Espey, Huston & Associates, Inc.
 Engineering & Environmental Consultants
 13800 Montfort Drive, Suite 230
 Dallas, Texas 75240 (214) 387-0771

TRAFFIC SIGNALIZATION
 MIDWAY ROAD AT PROTON DRIVE

MIDWAY ROAD DRAINAGE IMPROVEMENTS
 GREENHILL DRIVE TO TU RIGHT-OF-WAY
 for
 THE TOWN OF ADDISON

SHEET NO. 19
 OF 20 SHEETS
 JOB NO. 16285