

- NOTES:
1. COORDINATE SHUTDOWNS OF EXISTING WATER LINES WITH TOWN OF ADDISON AND PROPERTY OWNERS.
 2. REMOVAL OF ALL EXISTING FACILITIES IMPACTED BY CONSTRUCTION SHALL BE CONSIDERED INCIDENTAL TO OTHER ITEMS OF WORK UNLESS A PAY ITEM IS PROVIDED.

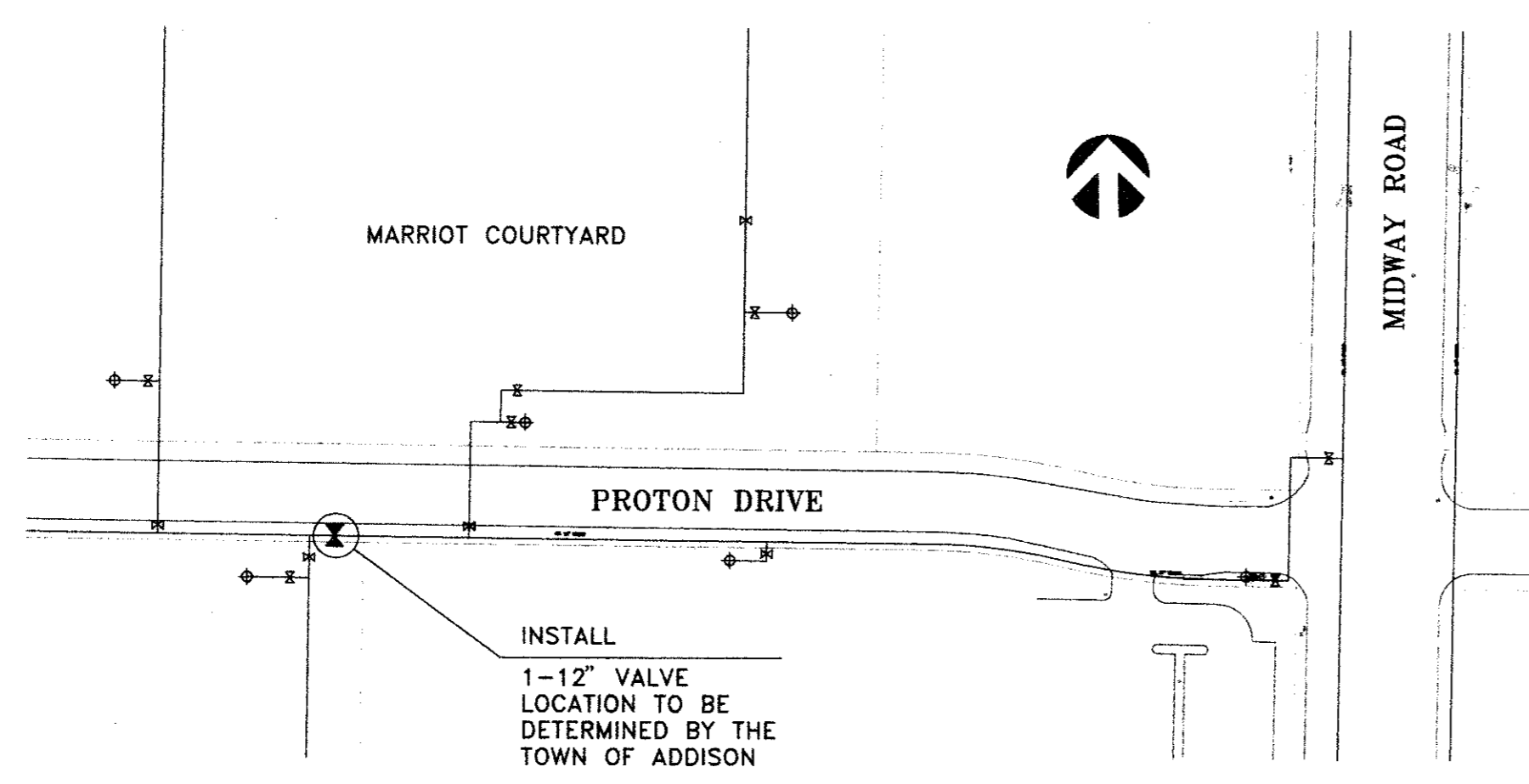

WATER VALVE LOCATION DETAIL
1" = 100'

NOTE:
CONTRACTOR SHALL CUT IN 12" VALVE AS SHOWN PRIOR TO SHUTTING DOWN WATER LINE IN PROTON DRIVE.

NO.	REVISION	BY	DATE

DESIGNED BY: J WALDBAUER
 DRAWN BY: EH&A
 CHECKED BY: B GRANTHAM
 SCALE: 1" = 20'
 DATE: JULY, 1995
 FILE: \MIDWAY\MIDUC03



EH&A **Espey, Huston & Associates, Inc.**
 Engineering & Environmental Consultants
 13800 Montfort Drive, Suite 230
 Dallas, Texas 75240 (214) 387-0771

UTILITY COMPOSITE
 STA. 12+00 TO STA. 15+55
 MIDWAY ROAD DRAINAGE IMPROVEMENTS
 FROM GREENHILL DRIVE TO TU RIGHT-OF-WAY
 for
 THE TOWN OF ADDISON

SHEET NO. 7
 OF 20 SHEETS
 JOB NO. 16285