

EXISTING CONDITIONS

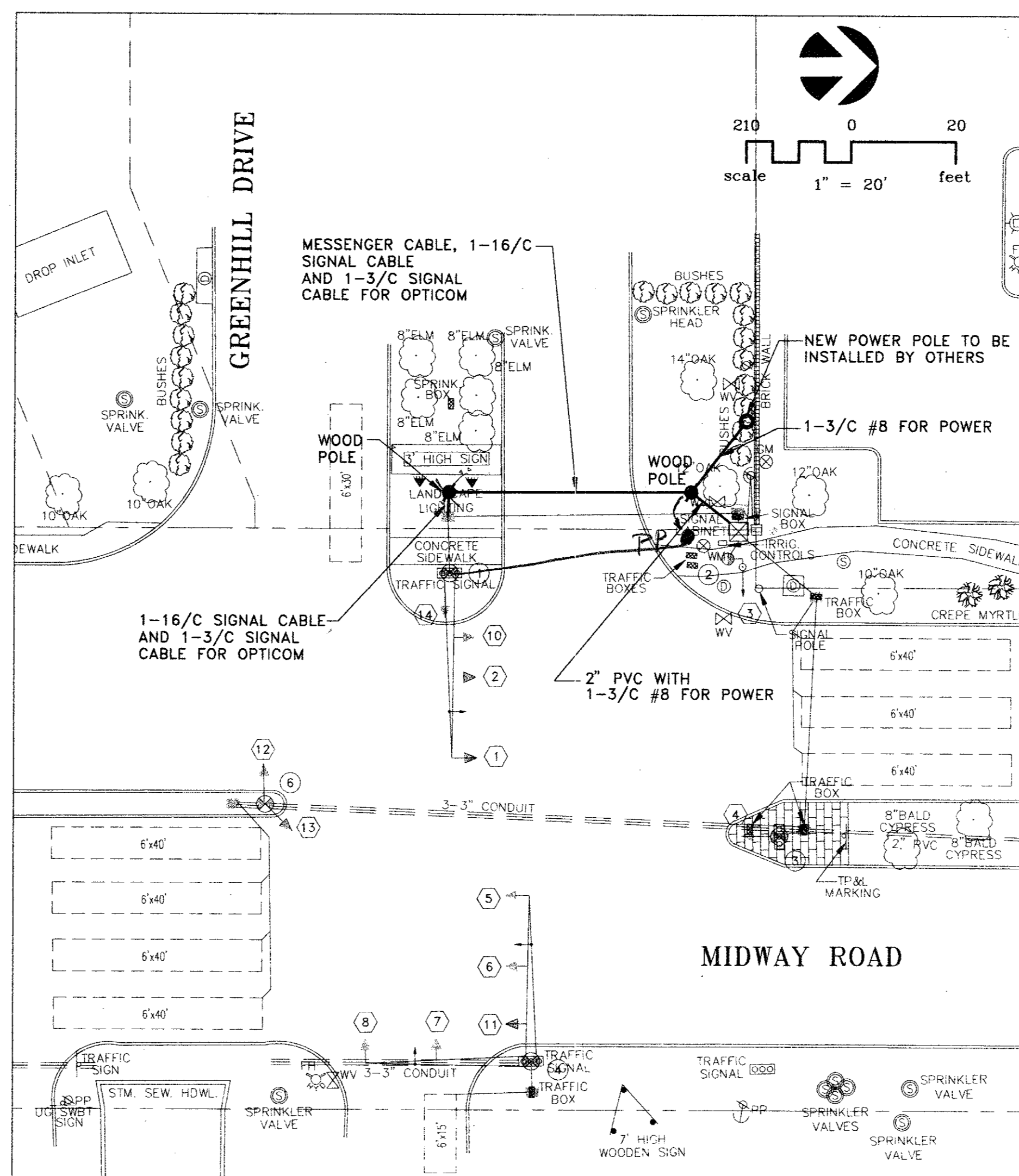

TEMPORARY TRAFFIC SIGNALS

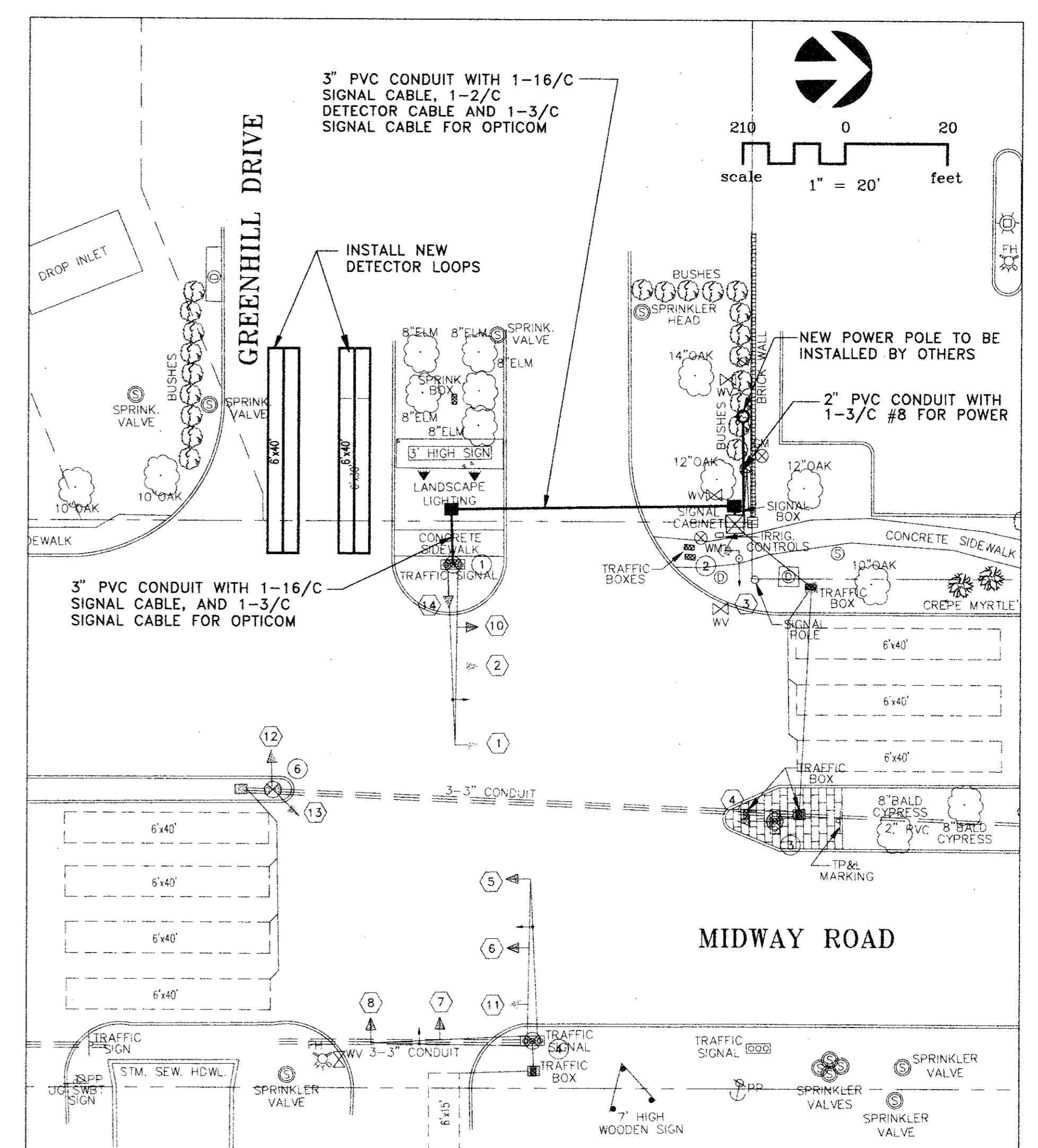

PERMANENT TRAFFIC SIGNALS

LEGEND

- PULLBOX
- WOOD POLE
- MESSENGER AND OTHER CABLE (EXIST.)
- - - MESSENGER AND OTHER CABLE (PROP.)
- ==== CONDUIT AND CABLE
- DETECTOR LOOP (EXIST.) AND SIZE
- DETECTOR LOOP (PROP.) AND SIZE
- ① MAST-ARM POLE AND NO., SIGNAL HEAD AND NO.

NOTES:

1. CONTRACTOR SHALL INSTALL AND MAINTAIN TEMPORARY WOOD POLES, MESSENGER AND TRAFFIC SIGNAL CABLE AND POWER CABLE IN ACCORDANCE WITH THESE PLANS AND TOWN OF ADDISON SPECIFICATIONS.
2. CONTRACTOR SHALL MAINTAIN TRAFFIC SIGNALS IN OPERATION AT ALL TIMES. ANY SHUT-DOWN OF TRAFFIC SIGNALS SHALL BE APPROVED BY AND COORDINATED WITH THE TOWN OF ADDISON PUBLIC WORKS DEPARTMENT.

CABLE TERMINATION CHART

CNDR COLOR	CABLE 1 FROM P1 TO CNTRL. 16 CNDR.
BLACK	SPARE
WHITE	COMMON
RED	SH1,2,10R
GREEN	SH1,2,10G
ORANGE	SH1,2,10Y
BLUE	SPARE
WHITE/BLACK	SPARE
RED/BLACK	SH14 R
GREEN/BLACK	SH14 G
ORANGE/BLACK	SH14 Y
BLUE/BLACK	SPARE
BLACK/WHITE	SPARE
RED/WHITE	SPARE
GREEN/WHITE	SPARE
BLUE/WHITE	SPARE
BLACK/RED	SPARE

NOTES:

1. INSTALL NEW PULLBOXES, CONDUIT, SIGNAL CABLE AND LOOP VEHICLE DETECTOR IN ACCORDANCE WITH THESE PLANS AND TOWN OF ADDISON SPECIFICATIONS.
2. CONTRACTOR SHALL MAINTAIN TRAFFIC SIGNALS IN OPERATION AT ALL TIMES. ANY SHUT-DOWN OF TRAFFIC SIGNALS SHALL BE APPROVED BY AND COORDINATED WITH THE TOWN OF ADDISON PUBLIC WORKS DEPARTMENT.

CABLE TERMINATION CHART

CNDR COLOR	CABLE 1 FROM P1 TO CNTRL. 16 CNDR.
BLACK	SPARE
WHITE	COMMON
RED	SH1,2,10R
GREEN	SH1,2,10G
ORANGE	SH1,2,10Y
BLUE	SPARE
WHITE/BLACK	SPARE
RED/BLACK	SH14 R
GREEN/BLACK	SH14 G
ORANGE/BLACK	SH14 Y
BLUE/BLACK	SPARE
BLACK/WHITE	SPARE
RED/WHITE	SPARE
GREEN/WHITE	SPARE
BLUE/WHITE	SPARE
BLACK/RED	SPARE

NO.	REVISION	BY	DATE

DESIGNED BY: JACK HATCHELL
 DRAWN BY: EH&A
 CHECKED BY: B GRANTHAM
 SCALE: 1" = 20'
 DATE: JULY 1995
 FILE: MIDWAY/MIDSG

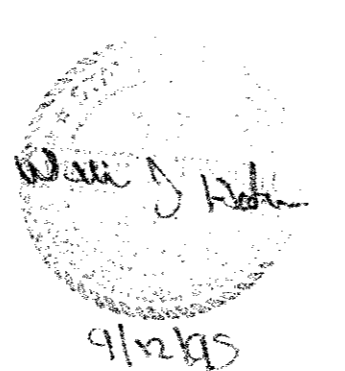

EH&A Espey, Huston & Associates, Inc.
 Engineering & Environmental Consultants
 13800 Montfort Drive, Suite 230
 Dallas, Texas 75240 (214) 387-0771

TRAFFIC SIGNALIZATION
 MIDWAY ROAD AT GREENHILL DRIVE
 MIDWAY ROAD DRAINAGE IMPROVEMENTS
 GREENHILL DRIVE TO TU RIGHT-OF-WAY
 for
 THE TOWN OF ADDISON

SHEET NO. 18
 OF 20 SHEETS
 JOB NO. 16285