

EXISTING CONDITIONS

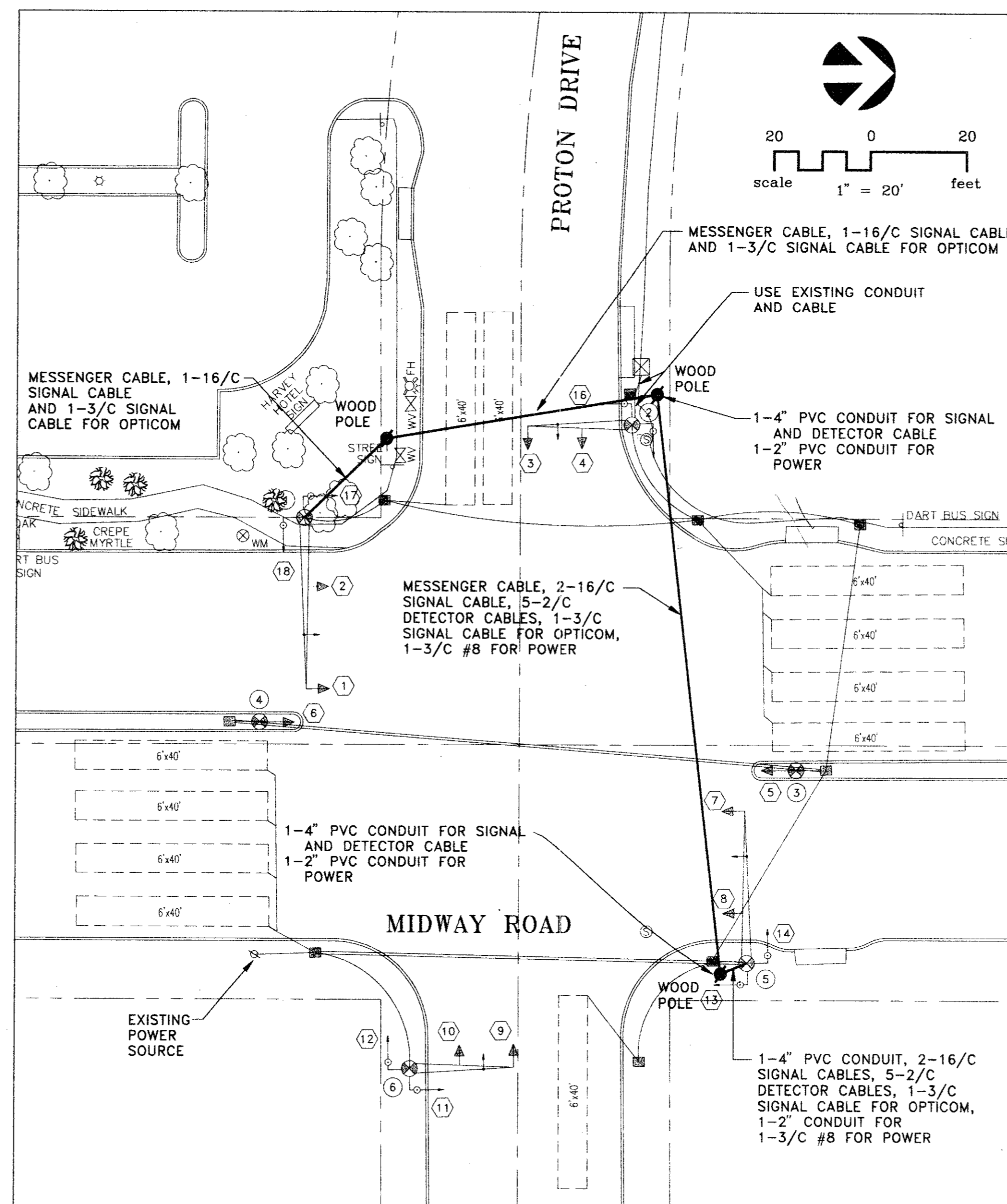

TEMPORARY TRAFFIC SIGNALS

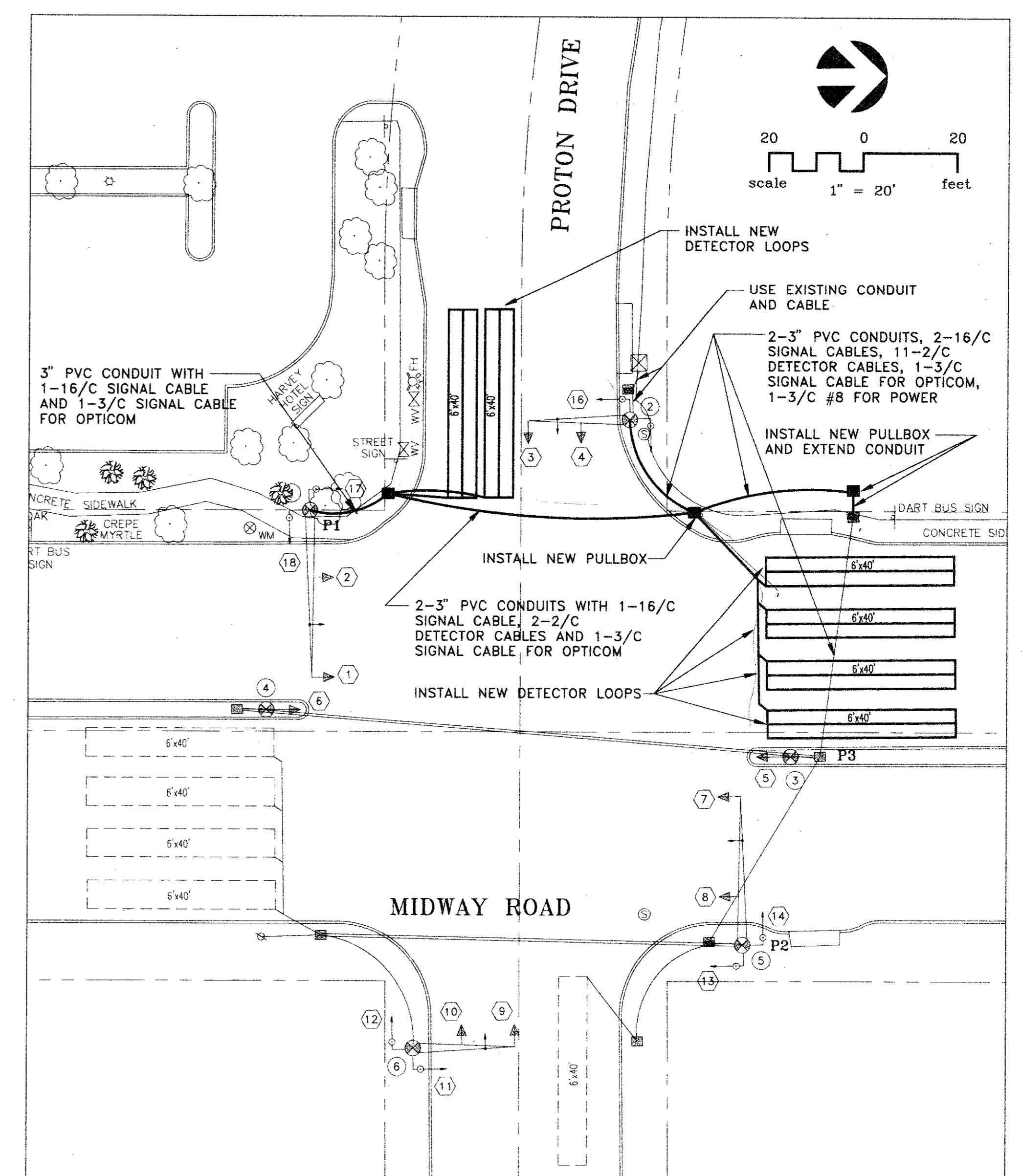

PERMANENT TRAFFIC SIGNALS

**LEGEND**

- PULLBOX
- WOOD POLE
- MESSENGER AND OTHER CABLE (EXIST.)
- MESSENGER AND OTHER CABLE (PROP.)
- CONDUIT AND CABLE
- 6"x40" DETECTOR LOOP (EXIST.) AND SIZE
- 6"x40" DETECTOR LOOP (PROP.) AND SIZE
- ① MAST-ARM POLE AND NO., SIGNAL HEAD AND NO.

**NOTES:**

1. CONTRACTOR SHALL INSTALL AND MAINTAIN TEMPORARY WOOD POLES, MESSENGER AND TRAFFIC SIGNAL CABLE AND POWER CABLE IN ACCORDANCE WITH THESE PLANS AND TOWN OF ADDISON SPECIFICATIONS.
2. CONTRACTOR SHALL MAINTAIN TRAFFIC SIGNALS IN OPERATION AT ALL TIMES. ANY SHUT-DOWN OF TRAFFIC SIGNALS SHALL BE APPROVED BY AND COORDINATED WITH THE TOWN OF ADDISON PUBLIC WORKS DEPARTMENT.
3. CONTRACTOR SHALL MAINTAIN MINIMUM OF 20 FEET OF CLEARANCE FROM BOTTOM OF MESSENGER CABLE TO STREET SURFACE.
4. CONTRACTOR SHALL INSTALL TEMPORARY CABLE ON EXISTING MAST ARM POLES BY ENTERING TOP OF MAST ARM POLE. CONTRACTOR SHALL INSTALL AND MAINTAIN PROTECTION FOR CABLE TO PREVENT IT FROM RUBBING AGAINST MAST ARM POLE AND BECOMING DAMAGED.

**ESTIMATED QUANTITIES**

ITEM	QUANTITY
Wood Pole with Down-guys	3
Messenger Cable	225'
16/C Signal Cable	475'
3/C Signal Cable	285'
3/C #8 Power Cable	190'
Detector Cable	950'
4" PVC Conduit	80'
2" PVC Conduit	100'

**NOTES:**

1. INSTALL NEW PULLBOXES, CONDUIT, SIGNAL CABLE AND LOOP VEHICLE DETECTOR IN ACCORDANCE WITH THESE PLANS AND TOWN OF ADDISON SPECIFICATIONS.
2. CONTRACTOR SHALL MAINTAIN TRAFFIC SIGNALS IN OPERATION AT ALL TIMES. ANY SHUT-DOWN OF TRAFFIC SIGNALS SHALL BE APPROVED BY AND COORDINATED WITH THE TOWN OF ADDISON PUBLIC WORKS DEPARTMENT.

**ESTIMATED QUANTITIES**

ITEM	QUANTITY
16/C Signal Cable	370'
3/C Signal Cable	230'
3/C #8 Power Cable	145'
Detector Cable	1,270'
Pullbox	3
3" PVC Conduit	305'
6"x40' Loop Detectors	6

**CABLE TERMINATION CHART**

CNDR COLOR	CABLE 1 FROM P1 TO CNTRL 16 CNDR.	CABLE 2 FROM P2, P3 TO CNTRL 16 CNDR.
BLACK	SPARE	SPARE
WHITE	COMMON	COMMON
RED	SH1,2 R	SH5,7,8 R
GREEN	SH1,2 G	SH5,7,8 G
ORANGE	SH1,2 Y	SH5,7,8 Y
BLUE	SH17 W	SH5 -Y
WHITE/BLACK	SH17 DW	SH5 -G
RED/BLACK	SPARE	SPARE
GREEN/BLACK	SPARE	SH13 W
ORANGE/BLACK	SPARE	SH13 DW
BLUE/BLACK	SH18 W	SH14 W
BLACK/WHITE	SH18 DW	SH14 DW
RED/WHITE	PED CALL	PED CALL
GREEN/WHITE	SPARE	SPARE
BLUE/WHITE	SPARE	SPARE
BLACK/RED	PED CALL	PED CALL

NO.	REVISION	BY	DATE

DESIGNED BY: JACK HATCHELL  
 DRAWN BY: EH&A  
 CHECKED BY: B GRANTHAM  
 SCALE: 1" = 20'  
 DATE: JULY 1995  
 FILE: \MIDWAY\MIDSG2

*William J. Huston*  
 9/12/95

**EH&A** Espey, Huston & Associates, Inc.  
 Engineering & Environmental Consultants  
 13800 Montfort Drive, Suite 230  
 Dallas, Texas 75240 (214) 387-0771

**TRAFFIC SIGNALIZATION**  
 MIDWAY ROAD AT PROTON DRIVE

**MIDWAY ROAD DRAINAGE IMPROVEMENTS**  
 GREENHILL DRIVE TO TU RIGHT-OF-WAY  
 for  
 THE TOWN OF ADDISON

SHEET NO. **19**  
 OF **20** SHEETS  
 JOB NO. **16285**