

MATERIAL/LABOR SUBSIDIARY TO ITEM 681

CONDUIT (RM) (75MM)	M	9.1
CONDUIT (PVC) (SCHD 40) (75MM)	M	3.0
WEATHERHEAD (75MM)	EA	1
ELEC CONDUCTOR (NO. 8) INSULATED	M	264.0
ELEC CONDUCTOR (NO. 6) BARE	M	12.1
VIVDS COAXIAL CABLE	M	213.6
* OPTICOM CABLE	M	212.4
SIGNAL CABLE TY A 14 AWG 7 CNDR	M	163.3
SIGNAL CABLE TY A 14 AWG 15 CNDR	M	233.4
ZINC-COAT STEEL STRAND 6.3MM	M	41.7
CABLE STRAPS (1 PER 300MM)	EA	139

\* SUPPLIED BY THE CITY

SEQUENCE OF WORK

1. INSTALL SIGNAL POLE FOUNDATION AND SIGNAL POLES T-1 AND T-4.
2. INSTALL CONDUIT RUNS 5 THROUGH 12, THE CONTROLLER FOUNDATION, AND THE CONTROLLER.
3. INSTALL CONDUIT RUNS 13 THROUGH 15, THE CONTROLLER FOUNDATION, AND THE CONTROLLER.
4. INSTALL VIVDS CAMERAS ON THE MAST ARMS AS SHOWN.
5. PULL TEMPORARY CABLES TO POLES T-1, T-2, T-3, T-5 AND T-6 OVERHEAD FROM POLE T-4, AND SET UP VIDEO DETECTION.
6. SALVAGE EXISTING SIGNALS (EXCEPT POLES T-2, T-3, T-5 AND T-6), INCLUDING EXISTING CONTROLLER AND CABLES.
7. CONSTRUCT ROADWAY.

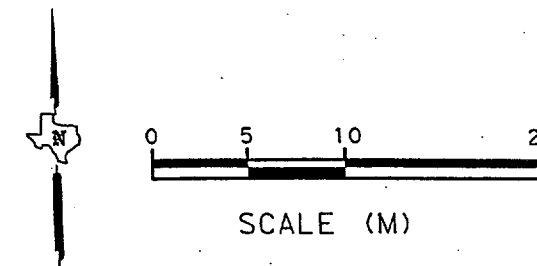

RUN NO.	POLE NO.	CONDUIT TYPE	NO. 6 XHHW	NO. 6 BARE	NO. 8 XHHW	NO. 12 XHHW	VIVDS COAX	OPTI-COM	TY A			LENGTH (M)
									5 CNDR CABLE	7 CNDR CABLE	15 CNDR CABLE	
1		2-50MM	2	2	4							1.6
2		1-50MM		1	2		1	1			1	3.0
*2		1-75MM		*1	*2		*3	*3			*3	3.0
*2A		1-75MM RM		*1	*2		*3	*3			*2	9.1
3		2-75MM		2			*3,1	*3,1			*2	8.0
3		1-50MM	2	1								8.0
5		1-50MM		1							*1	2.0
6		1-75MM BORED		1							*1	13.0
7		1-50MM		1							*1	1.4
8		1-50MM		1	*2		*1	*1				1.0
9		1-75MM BORED		1	*2		*1	*1				16.0
10		1-50MM		1							*1	2.0
11		1-75MM BORED		1	*2		*1	*1			*1	13.0
12		1-75MM		1	*2		*1	*1			*1	3.0
*14		AERIAL			*2		*1	*1			*1	24.3
*15		AERIAL			*2		*2	*2			*1	17.4
T-1												
T-2												
T-3												
*T-3												
T-4												
*T-4												
T-5												
T-6												
*T-6												
* TOTALS (M)												

\* SUBSIDIARY TO ITEM 681, AND TO BE REMOVED FOR THE PERMANENT SIGNAL  
 - RUN 2A IS STRAPPED TO POLE T-4, AND CONNECTS TO ONE CONDUIT OF RUN 2  
 - QUANTITIES NOT TOTALED ARE PAID BY BID ITEM, SEE PERMANENT SIGNAL LAYOUT

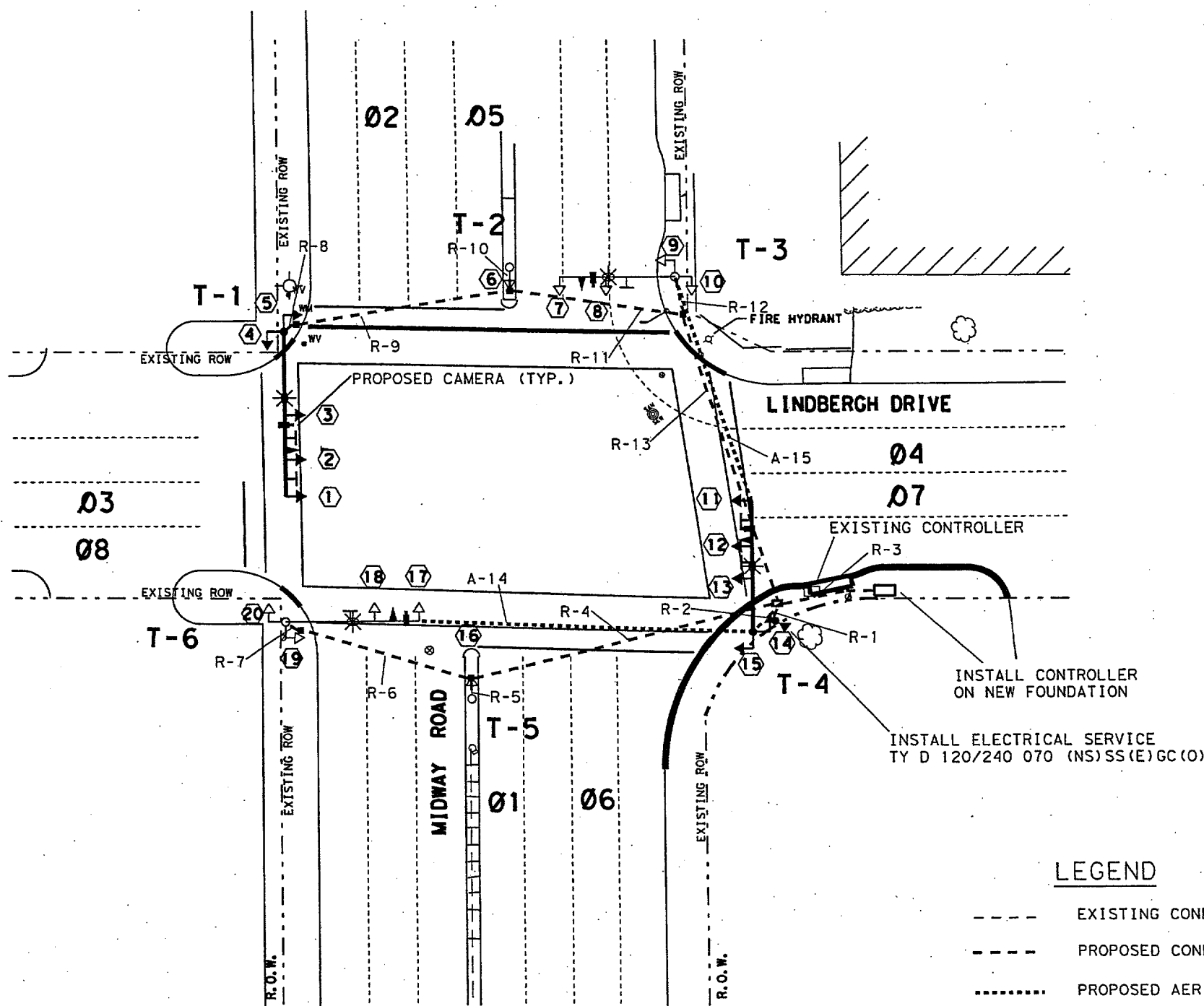

LEGEND

- EXISTING CONDUIT RUN
- - - PROPOSED CONDUIT RUN
- ..... PROPOSED AERIAL RUN

LEVELS DISPLAYED

1	2	3	4	5	6	7	8
9	10	11	12	13	14	15	16
17	18	19	20	21	22	23	24
25	26	27	28	29	30	31	32
33	34	35	36	37	38	39	40
41	42	43	44	45	46	47	48
49	50	51	52	53	54	55	56
57	58	59	60	61	62		

Signature: *Christopher D. Blain* P.E. 5/11/05  
Date

Texas Department of Transportation  
© 2005

TEMPORARY SIGNAL PLAN  
MIDWAY ROAD & LINDBERGH DRIVE

SCALE: 1 = 400 SHEET 1 OF 1

DESIGN	FED. RD. DIV. NO.	FEDERAL AID PROJECT NO.	HIGHWAY NO.
BES	6	CM 97(87)	CS
GRAPHICS	STATE	DISTRICT	COUNTY
BES	TEXAS	DALLAS	DALLAS
CHECK	CONTROL	SECTION	JOB
CDB	0918	45	344

691