

TO AND DRAINAGE SEGMENT

N

LOWERED WATER LINE UNDER STORM SEWER 4-45° BENDS

WATER TURNING WALL  
- FROM SEE DETAIL  
SHEET P. 2

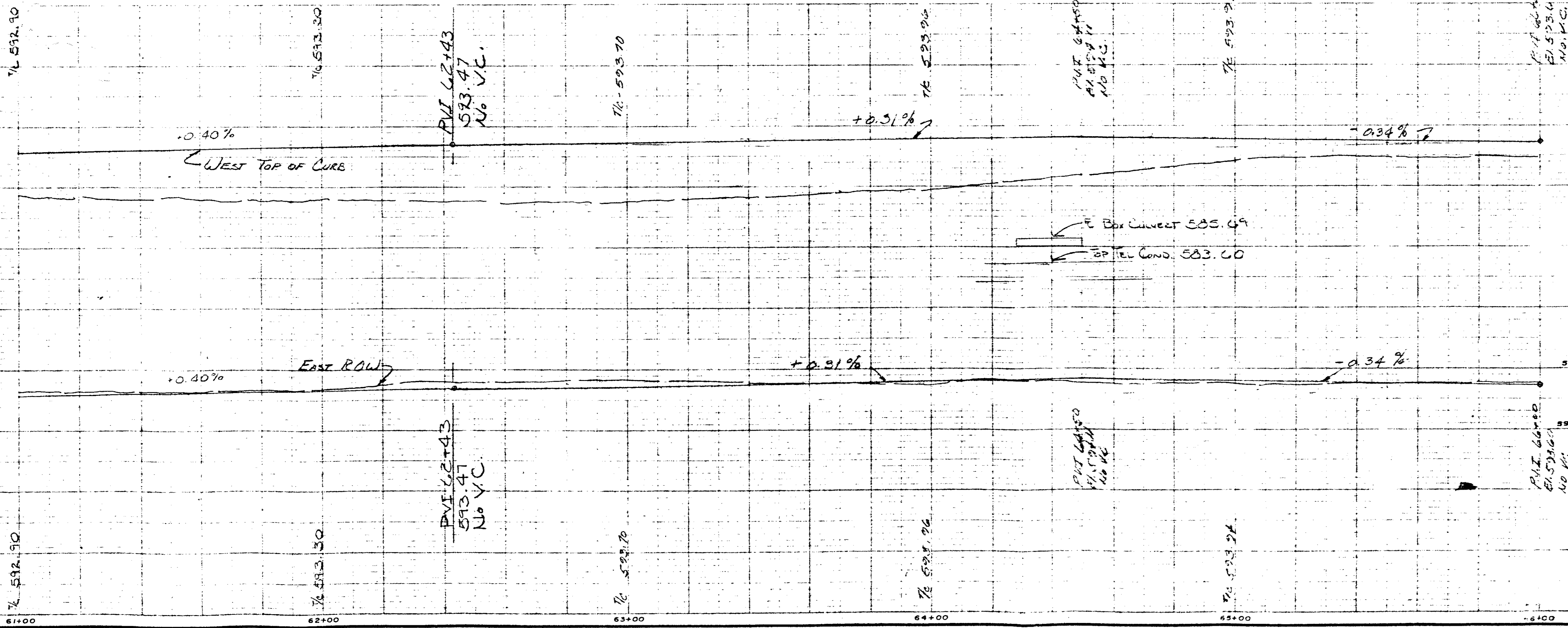
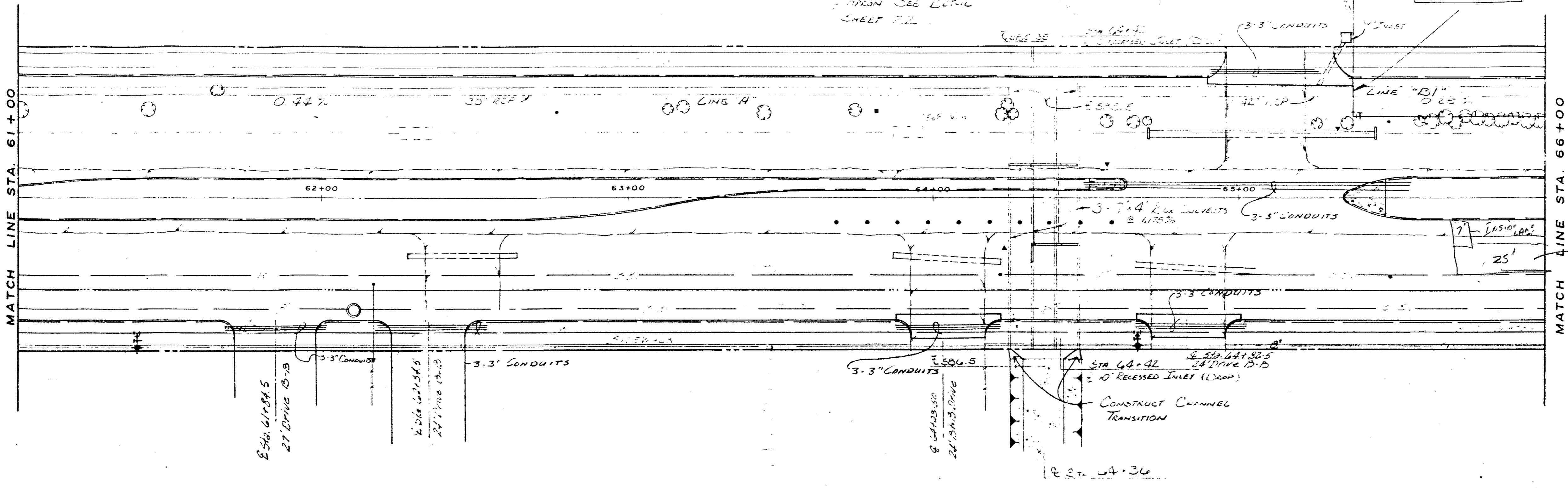

CHANGE - 1/2" ELEVATION STATIONS 52+45 TO 64+00		3	3/78
NO.	REVISION	BY	DATE
<b>CITY OF FARMERS BRANCH, TEXAS</b> PUBLIC WORKS DEPARTMENT ENGINEERING DIVISION			
<b>MIDWAY ROAD PAVING</b> SPRING VALLEY RD. TO BELT LINE RD.			
DRAWN BY	D. D.	APPROVED BY	
DESIGNED BY	J. P.	DATE	3-78
PROJECT NO.	SCALE	H. 1" = 20' V. 1" = 5'	SHEET 5 OF