

Talley Associates

Landscape Architecture
Planning
Urban Design
1825 San Jacinto, Suite 400
Dallas, Texas 75201
Tel. 214-871-2000
Fax. 214-871-7885

ZINSER / GROSSMAN STRUCTURAL LLC
Structural Engineering
1701 N. Market St., Suite #190
Dallas, Texas 75207
Tel. 469-277-3883
Fax. 469-277-3881

MEP SYSTEMS DESIGN AND ENGINEERING, INC.
518 Dragon Street
Dallas, Texas 75207
Tel. 214-915-0028
Fax. 214-915-0918

JAMES POLE LANDSCAPE IRRIGATION SPECIALIST
Landscape Irrigation Consulting, Design, Specifications
2815 Woodhaven
Dallas, Texas 75201
Tel. 940-248-2004

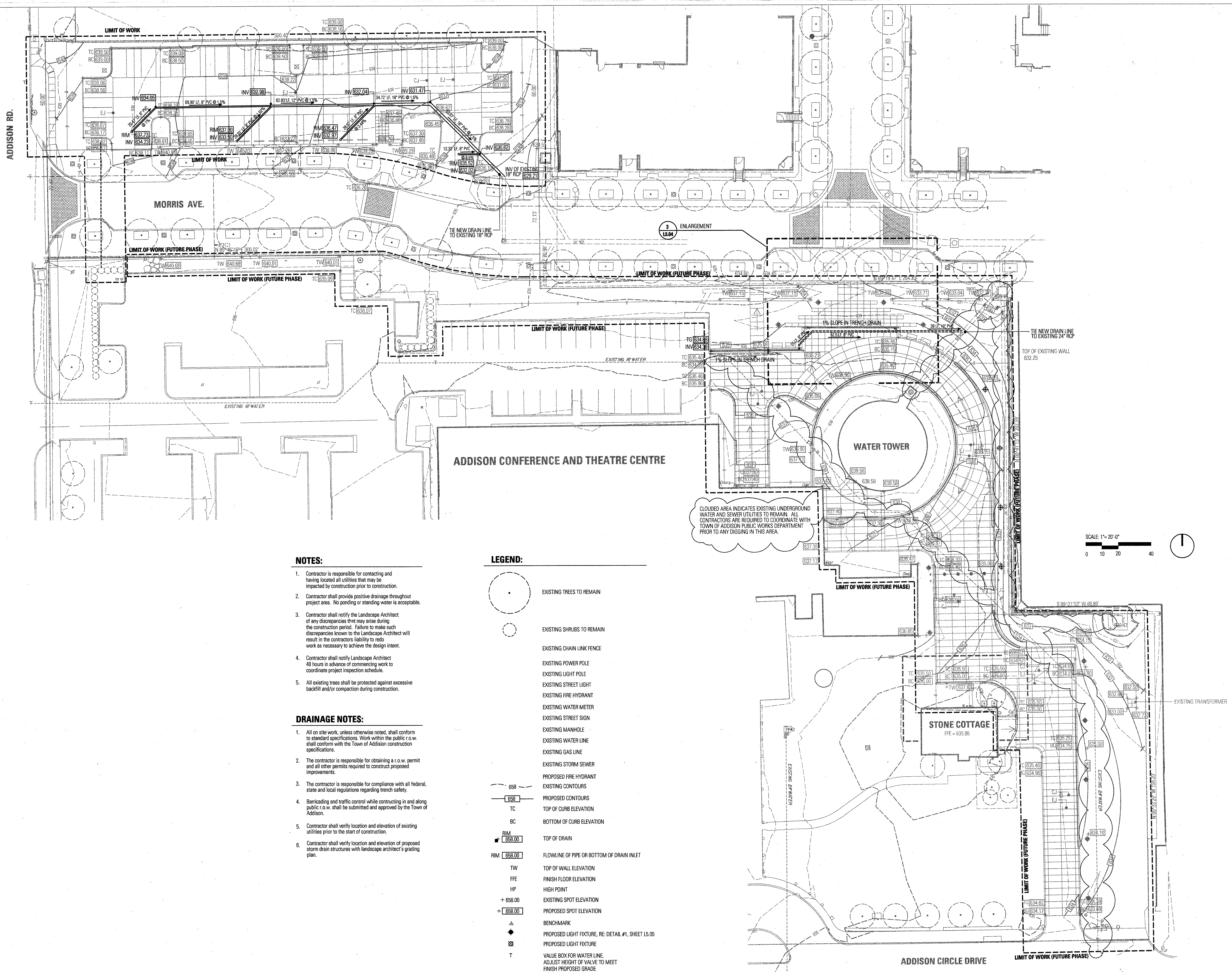

NOTES:

- Contractor is responsible for contacting and having located all utilities that may be impacted by construction prior to construction.
- Contractor shall provide positive drainage throughout project area. No ponding or standing water is acceptable.
- Contractor shall notify the Landscape Architect of any discrepancies that may arise during the construction period. Failure to make such discrepancies known to the Landscape Architect will result in the contractor's liability to redo work as necessary to achieve the design intent.
- Contractor shall notify Landscape Architect 48 hours in advance of commencing work to coordinate project inspection schedule.
- All existing trees shall be protected against excessive backfill and/or compaction during construction.

DRAINAGE NOTES:

- All on site work, unless otherwise noted, shall conform to standard specifications. Work within the public r.o.w. shall conform with the Town of Addison construction specifications.
- The contractor is responsible for obtaining a r.o.w. permit and all other permits required to construct proposed improvements.
- The contractor is responsible for compliance with all federal, state and local regulations regarding trench safety.
- Barricading and traffic control while constructing in and along public r.o.w. shall be submitted and approved by the Town of Addison.
- Contractor shall verify location and elevation of existing utilities prior to the start of construction.
- Contractor shall verify location and elevation of proposed storm drain structures with landscape architect's grading plan.

LEGEND:

- EXISTING TREES TO REMAIN
- EXISTING SHRUBS TO REMAIN
- EXISTING CHAIN LINK FENCE
- EXISTING POWER POLE
- EXISTING LIGHT POLE
- EXISTING STREET LIGHT
- EXISTING FIRE HYDRANT
- EXISTING WATER METER
- EXISTING STREET SIGN
- EXISTING MANHOLE
- EXISTING WATER LINE
- EXISTING GAS LINE
- EXISTING STORM SEWER
- PROPOSED FIRE HYDRANT
- EXISTING CONTOURS
- PROPOSED CONTOURS
- TC
- BC
- RIM
- RIM
- TW
- FFE
- HP
- + 658.00
- + 658.00
- BENCHMARK
- PROPOSED LIGHT FIXTURE, RE: DETAIL #1, SHEET L5.05
- PROPOSED LIGHT FIXTURE
- VALVE BOX FOR WATER LINE, ADJUST HEIGHT OF VALVE TO MEET FINISH PROPOSED GRADE

CLOUDED AREA INDICATES EXISTING UNDERGROUND WATER AND SEWER UTILITIES TO REMAIN. ALL CONTRACTORS ARE REQUIRED TO COORDINATE WITH TOWN OF ADDISON PUBLIC WORKS DEPARTMENT PRIOR TO ANY DIGGING IN THIS AREA.

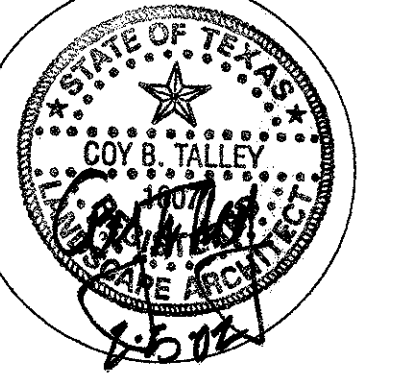
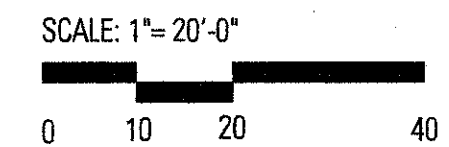

Project No. 1038

Drawn By: ES/CJ

Checked By: KB/CT

Date: FEBRUARY 5, 2002

Revisions:

- ▲
- ▲
- ▲

Sheet Title:
**STORM DRAINAGE
PLAN**

L2.02

Sheet No.: