

**2 LANES UNDIVIDED**  
**MORRIS AVENUE (ADDISON ROAD TO STA. 6+00.98)**  
 (SEE PLAN VIEW FOR NECK-DOWN AREAS)

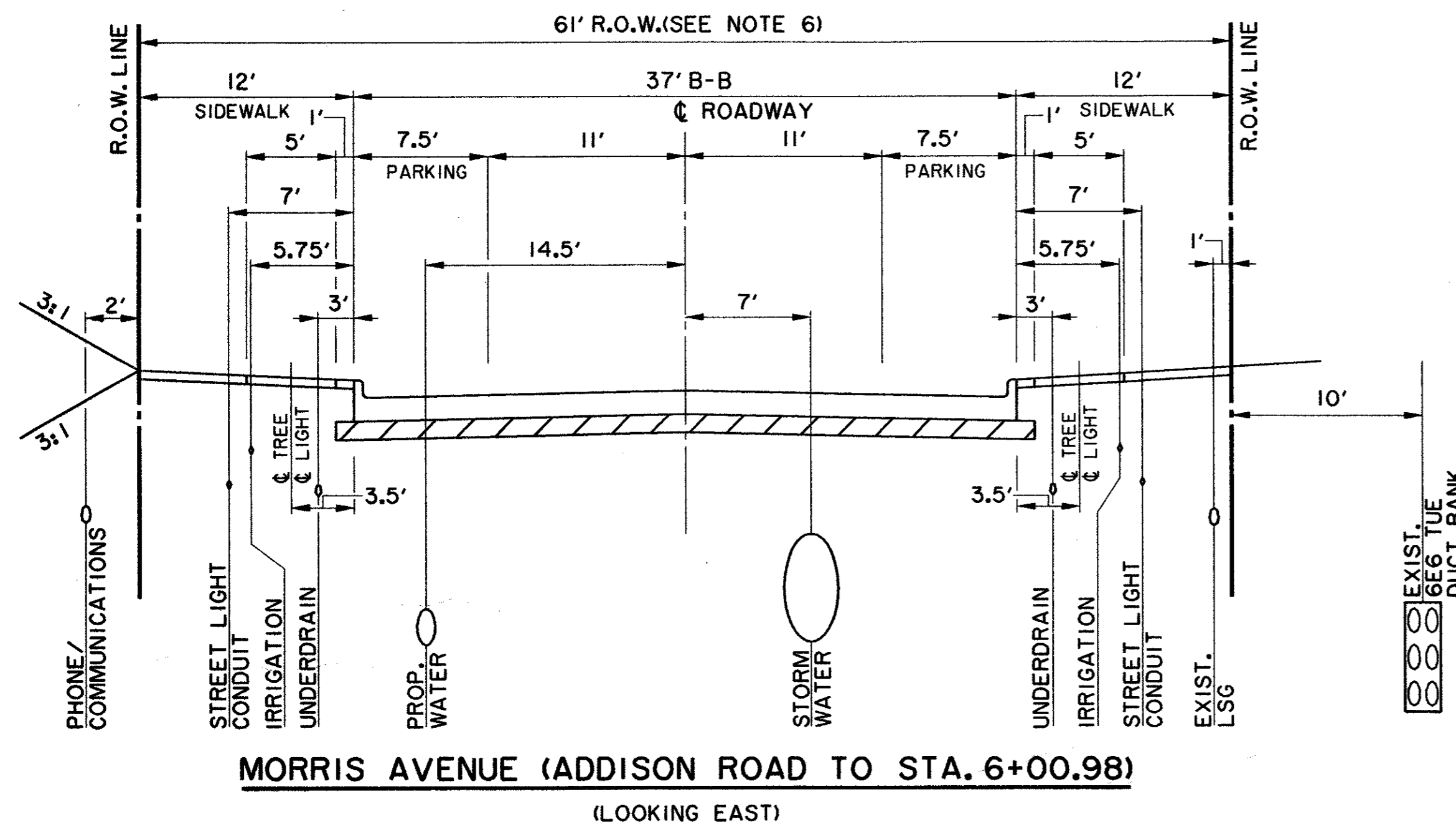

**MORRIS AVENUE (ADDISON ROAD TO STA. 6+00.98)**  
 (LOOKING EAST)

**NOTES:**

- BACKFILL MATERIAL IS NOT A SEPARATE PAY ITEM. MATERIAL ACQUIRED FROM EXCAVATION MAY BE USED IF APPROVED BY ENGINEER.
- PAY LINE FOR UNCLASSIFIED STREET EXCAVATION IS TO THE TOE OF SLOPE WHERE 3:1 MATCHES EXISTING.
- SAWED JOINTS SHALL BE SPACED AT 12' INTERVALS ON MORRIS AVENUE.
- PROFILE GRADES SHOWN ON THE PAVING PLAN AND PROFILE SHEETS ARE TOP OF CURB AT BACK OF CURB FOR A NORMAL ROADWAY CROSS-SECTION AS INDICATED ON THE TYPICAL SECTIONS BY "PROFILE T.C.".
- THE 1/4"/FT. CROSS-SLOPE IN SIDEWALK AREAS IS THE STANDARD CONDITION FOR THIS PROJECT.
- 61 FOOT RIGHT-OF WAY IS TYPICAL FOR A RESIDENTIAL STREET IN THE URBAN CENTER DISTRICT. THE SECTION OF STREET IN THIS PROJECT IS ON LAND OWNED BY THE TOWN OF ADDISON. THEREFORE, THERE IS NO DEDICATED STREET RIGHT OF WAY AND THE 12 FOOT DIMENSION IS TYPICAL ON THE NORTH SIDE OF MORRIS AVENUE AND IS VARIABLE ON THE SOUTH SIDE OF MORRIS AVENUE.

**JOINT LEGEND:**

- ① - SAWED LONGITUDINAL DUMMY JOINT
- ② - CONSTRUCTION JOINT (FULL WIDTH PVM'T. IS ALLOWED WHERE APPROVED BY THE TOWN OF ADDISON). FULL WIDTH PAVEMENT REQUIRES A SAWED LONGITUDINAL JOINT AT THE CENTERLINE OF THE PAVEMENT.

**LIST OF ABBREVIATIONS**

at	Area	PAR.	Parabolic
B-B	Back to Back	P.C.	Point of Curvature
BM	Bench Mark	P.F.	Partial Flow
BTM	Bottom	P.I.	Point of Intersection
B.W.	Bottom of wall	P.R.C.	Point of Reverse Curvature
C.	Capacity or Runoff Coefficient	PAV.	Paving
C.C.	Center to Center	PP	Power Pole
C.R.	Curb Return	PROP.	Proposed
CATV	Cable TV	P.T.	Point of Tangency
CD	Chord Distance	PB	Pull Box
CL	Centerline	P.V.I.	Point of Vertical Intersection
CLR.	Clear	P.V.C.	Point of Vertical Curvature
Conc.	Concrete	P.V.R.C.	Point of Vertical Reverse Curvature
CONST.	Construct	PVM'T.	Pavement
DIA.	Diameter	P.V.T.	Point of Vertical Tangency
DB	Direct Bury	Q100	100 year flow
E	East	R	Radius
E.P.	Edge of Pavement	REINF.	Reinforced
E.O.	Equal	REC.	Recessed
EX.	Existing	RCP	Reinforced Concrete Pipe
EX.F.	Existing Floor	RCCP	Reinforced Concrete Cylinder Pipe
F.L.	Flowline	R.O.W.	Right of Way
FH	Fire Hydrant	RR	Railroad
GM	Gas Meter	RT.	Right
HG	Hydraulic Gradient	S	Slope or South
HV	Velocity Head	SCH.	Schedule
I.R.	Iron Rod	SS	Sanitary Sewer
I.P.F.	Iron Rod Found	STD.	Standard
I.P.S.	Iron Rod Set	STA.	Station
I100	100 Year Intensity	STAB.	Stabilized
L	Length	SW	Storm Water
L.F.	Linear Feet	SWBT	Southwestern Bell Telephone
LAT.	Lateral	T	Tangent
LT.	Left	T.C.	Top of Curb
m	Mid-ordinate	tc	Time of Concentration
MAX.	Maximum	T.P.	Top of Pavement
M.J.	Mechanical Joint	T.W.	Top of Wall
MH	Manhole or Metal Halide	Typ.	Typical
MIN.	Minimum	V	Velocity
MOD.	Modified	VP	Partial Flow Velocity
N	North	V.C.	Vertical Curve
NA	Not Applicable	W	West
N.T.S.	Not to Scale	W/W	with Water Meter
O.C.	On Center	W	Water
O.C.E.W.	On Center Each Way	WW	Waste Water
O.D.	Outside Diameter	Δ	Angle of Deflection

**LEGEND**

<b>ELECTRIC — OHE —</b>	<b>MISC.</b>
★ LIGHT POLE	48" RCP
PP POWER POLE	EX. STORM SEWER
← GUY WIRE	CHAIN LINK FENCE
<b>TELEPHONE — T —</b>	WOOD FENCE
MH ● TELEPHONE MANHOLE	EXISTING ASPHALT
■ TELEPHONE PEDESTAL	EXISTING DIRT OR GRAVEL
TS. TELEPHONE SIGN	EX. CONCRETE
GAS — G —	TREE/TREE LINE
GM ● GAS METER	EXISTING CURB
GS. GAS SIGN	PROP. CURB
<b>LAND USE</b>	PROP. EDGE OF PAVEMENT NO CURB
ROR RAILROAD SIGN	EX. PROPERTY LINE
▽ SIGN	PROP. CENTERLINE
<b>SURVEY</b>	PROP. R.O.W.
I.R. FOUND IRON ROD	PROP. INLET
■ BENCHMARK	T.P. TOP OF PAVEMENT
<b>WASTEWATER — WW —</b>	T.C. TOP OF CURB
WW MH ● WASTEWATER MANHOLE	CR CURB RETURN
CO ● CLEANOUT	EX. G EXISTING GUTTER
<b>WATER — W —</b>	EX. T.C. EXISTING TOP OF CURB
FH ● FIRE HYDRANT	B-20 ● BORING LOCATION
WM ● METER	EXISTING BRICKS
T WATER VALVE	PAVEMENT REMOVAL

THE SEAL APPEARING ON THIS DOCUMENT WAS AUTHORIZED BY DAVID E. MEYERS, P.E. 81512

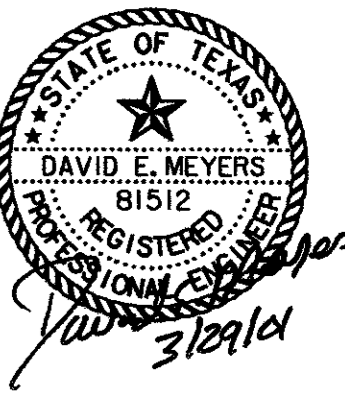

DATE	DESCRIPTION	REF NO.
4/20/01	ISSUED FOR BID	N/A
<b>PAVING TYPICAL SECTIONS, LEGEND &amp; ABBREVIATIONS</b>		
<b>MORRIS AVENUE EXTENSION</b>		
<b>PUBLIC INFRASTRUCTURE</b>		
<b>TOWN OF ADDISON, TEXAS</b>		
DESIGN	DRAWN	APPR.
HZI	HZI	DEM
SCALE	DATE	PROJECT NO.
N.T.S.	APR. 2001	01-3000-01
NO.		
2		