

NOTE: On All Streets w/ Islands Contractor to verify island Configuration with owner prior to Start of Construction.

TYPICAL PAVING SECTION  
No Scale

TYPICAL PAVING SECTION  
No Scale

ALTERNATE PAVING SECTION  
No Scale

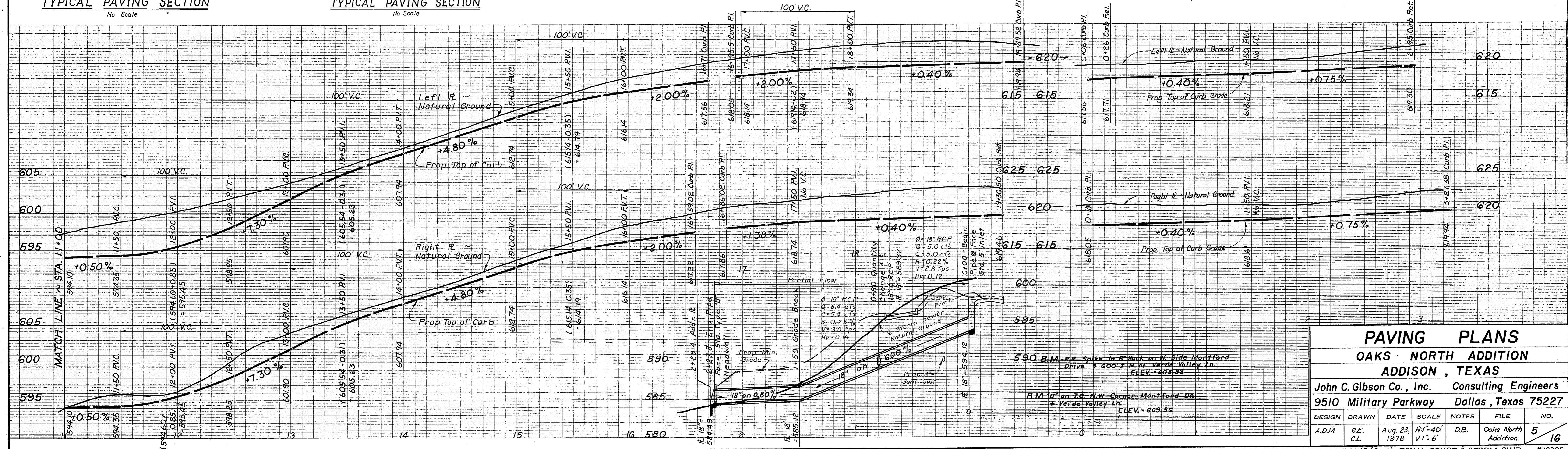

PAVING PLANS						
OAKS NORTH ADDITION						
ADDISON, TEXAS						
John C. Gibson Co., Inc. Consulting Engineers			9510 Military Parkway Dallas, Texas 75227			
DESIGN	DRAWN	DATE	SCALE	NOTES	FILE	NO.
A.D.M.	G.E.	Aug. 23, 1978	1/4" = 6'	D.B.	Oaks North Addition	5
ROYAL DRIVE (Cont.) ROYAL COURT & STORM SWR.						#10386