

- LEGEND**
- Existing Contour
 - Existing Spot Elevation
 - Proposed Contour
 - Proposed Spot Elevation
 - Flow Arrow
 - Existing Curb
 - Proposed Curb
 - Existing Storm Sewer Line
 - Proposed Storm Sewer Line
 - Existing Water Line
 - Proposed Water Line
 - Existing Sanitary Sewer Line
 - Proposed Sanitary Sewer Line
 - Valley Gutter
 - 8" CONC. PAVEMENT ON 6" LIME STABILIZED SUBGRADE

NOTE:
ALL ADA ACCESSIBLE ROUTES SHALL HAVE MAXIMUM 2% CROSS SLOPES AND MAXIMUM 5% LONGITUDINAL SLOPE.

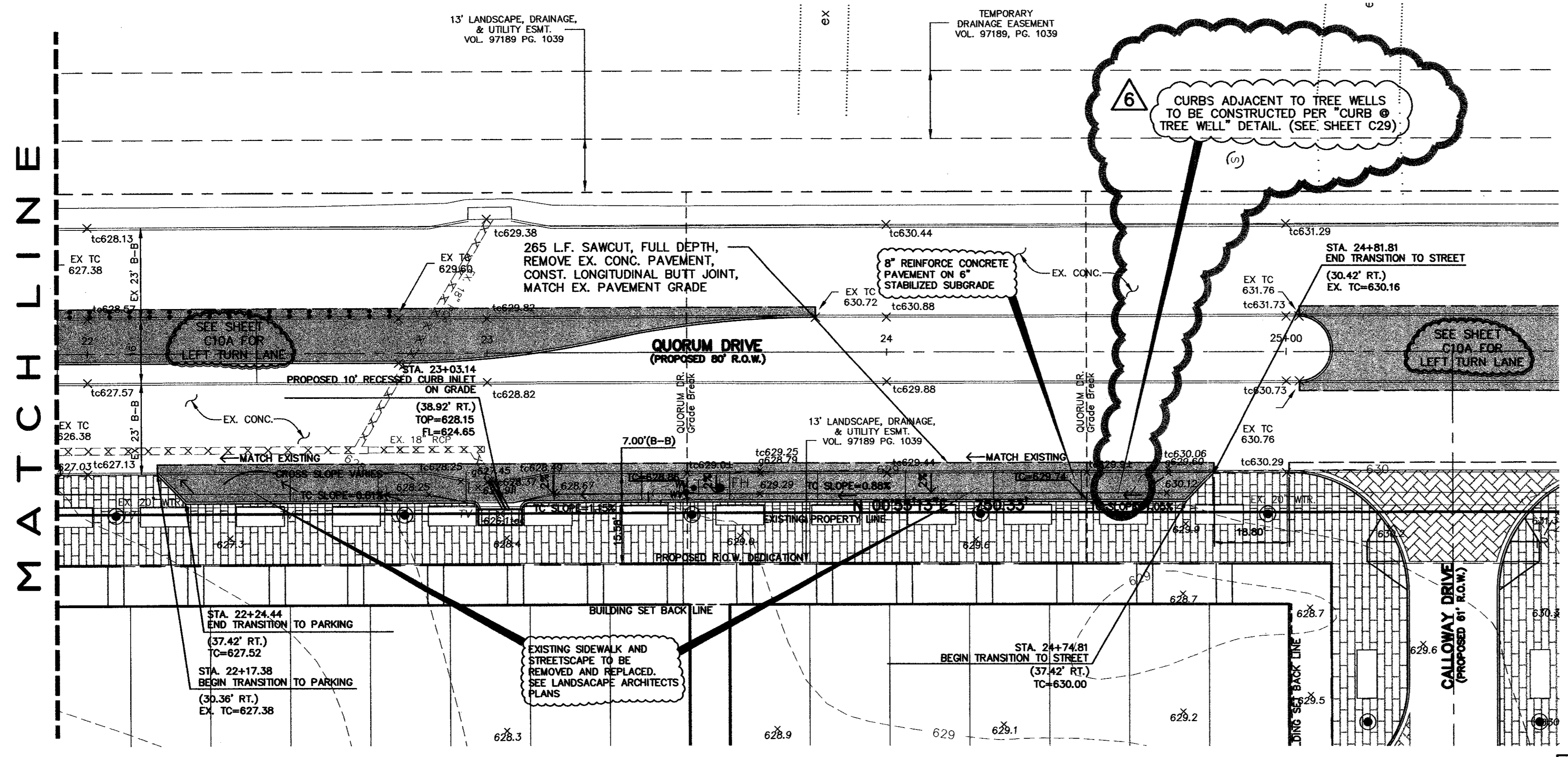

NOTE:
INSTALL BRICK PAVERS PER DETAIL ON SHEET C29

BENCHMARK:
"D" CUT ON EAST SIDE OF 6" INLET NORTH SIDE OF MORRIS AVENUE, 200' +/- EAST OF THE CENTERLINE OF QUORUM DRIVE.
ELEVATION: 616.41

QUORUM DRIVE PARKING IMPROVEMENTS
PARKVIEW AT ADDISON CIRCLE
TOWN OF ADDISON, TEXAS
DALLAS COUNTY

BROCKETTE · DAVIS · DRAKE, inc.
consulting engineers
Civil & Structural Engineering · Surveying
4144 North Central Expressway, Suite 1100 Dallas, Texas 75204
(214) 824-3647, fax (214) 824-7064

DESIGNED	DRAWN	DATE	SCALE	NOTES	FILE	NO.
RRJ	BDD	04/04	1"=20'	BDD	C03393	C10B

AS-BUILT
NOVEMBER 4, 2004

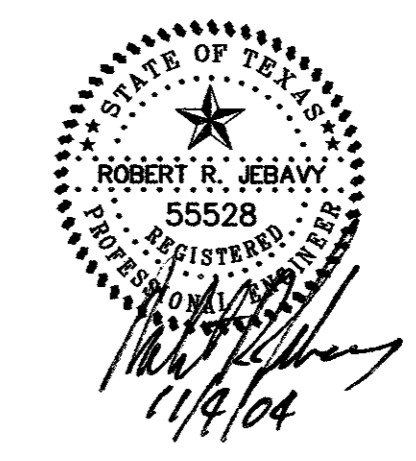

NOTE:
THESE PLANS HAVE BEEN REVISED TO CONFORM WITH CONSTRUCTION RECORDS PROVIDED BY CONTRACTOR.

6 ADD CURB @ TREE WELL NOTE. 6/04/04

Copyright 2003 Brockett/Davis/Drake, Inc. All Rights Reserved.
 This drawing is the property of Brockett/Davis/Drake, Inc.
 Any modification or reproduction without written
 permission of Brockett/Davis/Drake, Inc. is prohibited.