

NOTE:
INSTALL BRICK PAVERS PER
DETAIL ON SHEET C29

NOTE:
ALL DIMENSIONS ARE TO EDGE OF
PAVEMENT OR BACK OF CURB
UNLESS OTHERWISE NOTED.

BENCHMARK:
"D" CUT ON EAST SIDE OF 6' INLET NORTH SIDE
OF MORRIS AVENUE, 200' +/- EAST OF THE
CENTERLINE OF QUORUM DRIVE.
ELEVATION : 616.41

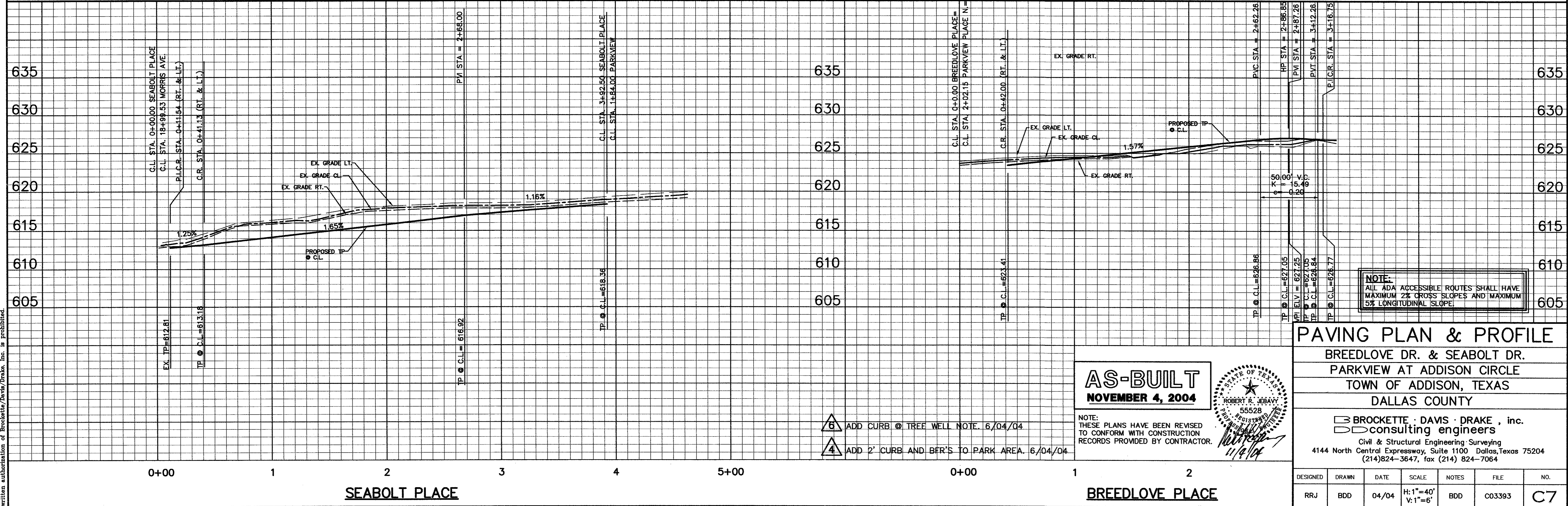

AS-BUILT
NOVEMBER 4, 2004

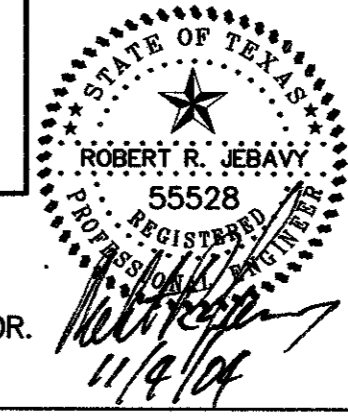

NOTE:
THESE PLANS HAVE BEEN REVISED
TO CONFORM WITH CONSTRUCTION
RECORDS PROVIDED BY CONTRACTOR.

- 6 ADD CURB @ TREE WELL NOTE. 6/04/04
- 4 ADD 2' CURB AND BFR'S TO PARK AREA. 6/04/04

PAVING PLAN & PROFILE						
BREEDLOVE DR. & SEABOLT DR.						
PARKVIEW AT ADDISON CIRCLE						
TOWN OF ADDISON, TEXAS						
DALLAS COUNTY						
BROCKETTE · DAVIS · DRAKE, inc.						
Civil & Structural Engineering · Surveying						
4144 North Central Expressway, Suite 1100 Dallas, Texas 75204						
(214)824-3647, fax (214) 824-7064						
DESIGNED	DRAWN	DATE	SCALE	NOTES	FILE	NO.
RRJ	BDD	04/04	H:1"=40' V:1"=6'	BDD	C03393	C7

Copyright 2003 Brockett/Davis/Drake, Inc. All Rights Reserved.
 This drawing is the property of Brockett/Davis/Drake, Inc.
 Any modification or use of this drawing without the
 written authorization of Brockett/Davis/Drake, Inc. is prohibited.

C03393 PLANS CO-07-PAV-1