

NOTE:
ALL DIMENSIONS ARE TO EDGE OF PAVEMENT OR BACK OF CURB UNLESS OTHERWISE NOTED.

NOTE:
INSTALL BRICK PAVERS PER DETAIL ON SHEET C29

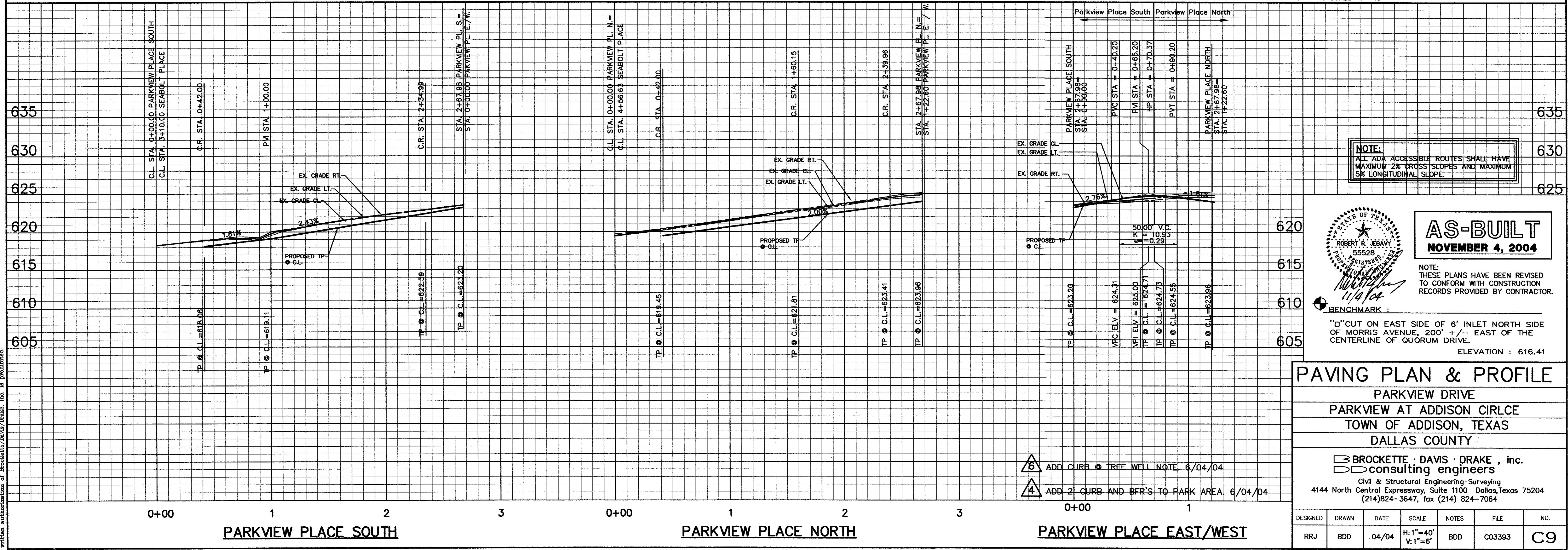

NOTE:
ALL ADA ACCESSIBLE ROUTES SHALL HAVE MAXIMUM 2% CROSS SLOPES AND MAXIMUM 5% LONGITUDINAL SLOPE.

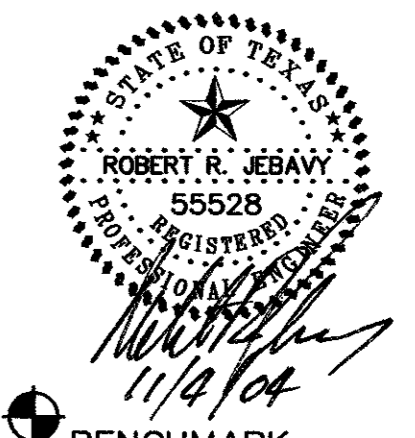

AS-BUILT
NOVEMBER 4, 2004

NOTE:
THESE PLANS HAVE BEEN REVISED TO CONFORM WITH CONSTRUCTION RECORDS PROVIDED BY CONTRACTOR.

BENCHMARK:
"D" CUT ON EAST SIDE OF 6' INLET NORTH SIDE OF MORRIS AVENUE, 200' +/- EAST OF THE CENTERLINE OF QUORUM DRIVE.
ELEVATION: 616.41

PAVING PLAN & PROFILE
PARKVIEW DRIVE
PARKVIEW AT ADDISON CIRLCE
TOWN OF ADDISON, TEXAS
DALLAS COUNTY

BROCKETTE · DAVIS · DRAKE, inc.
consulting engineers
Civil & Structural Engineering · Surveying
4144 North Central Expressway, Suite 1100 Dallas, Texas 75204
(214)824-3647, fax (214) 824-7064

DESIGNED	DRAWN	DATE	SCALE	NOTES	FILE	NO.
RRJ	BDD	04/04	H:1"=40' V:1"=6'	BDD	C03393	C9

Copyright 2003 Brockett/Davis/Drake, Inc. All Rights Reserved.
This drawing is the property of Brockett/Davis/Drake, Inc.
No part of this drawing may be reproduced or transmitted in any form or by any means electronic or mechanical, including photocopying, recording, or by any information storage and retrieval system, without the prior written permission of Brockett/Davis/Drake, Inc. is prohibited.

C03393\PLANS CD\08-PAV03-PV