

CAUTION!!!
Buried MFS Fiber Optic Cable
Call 214-665-2300
48 Hours Prior To Construction

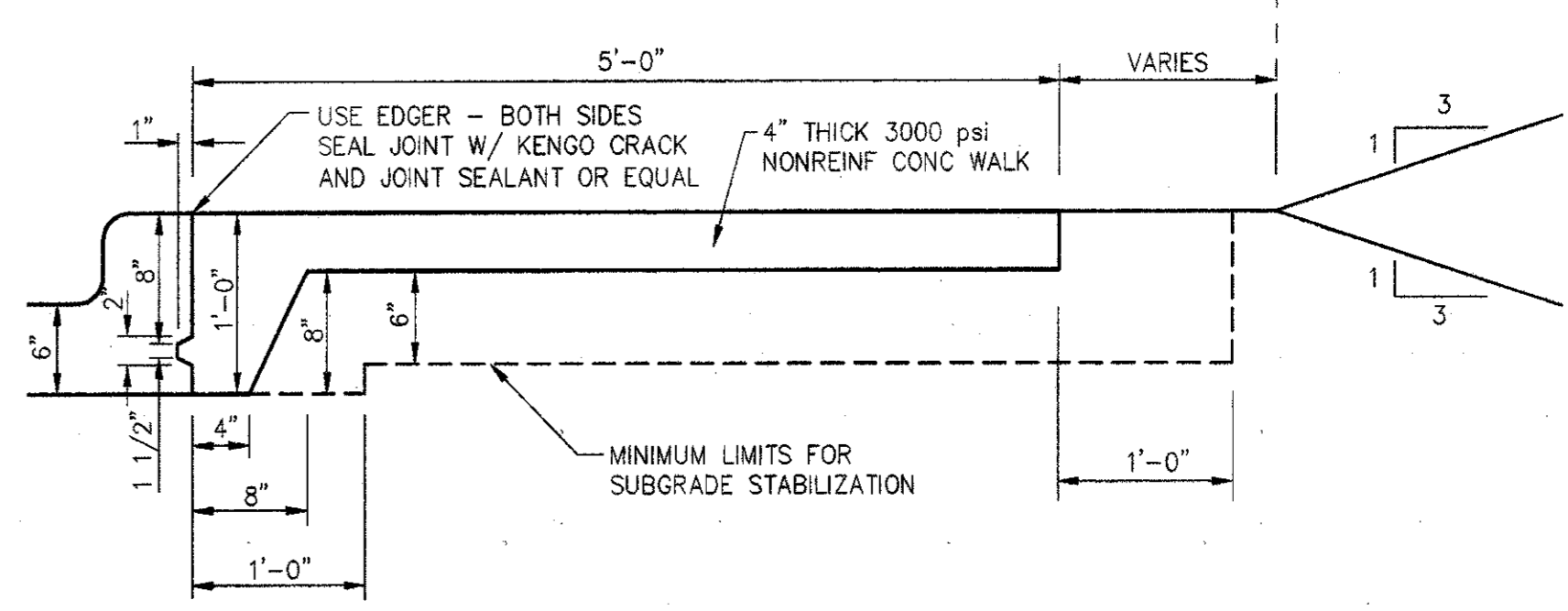

SIDEWALK AGAINST PROPOSED CONCRETE CURB
N.T.S.

$\Delta = 21'05''10''$
 $R = 777.43$
 $L = 286.11$
 $LC = 284.50$
 $CB = S 13'48''49'' E$

CAUTION!!!
Buried Fiber Optic Cable
Contact Mike Hendricks
972-918-1287
48 Hours Prior To Construction

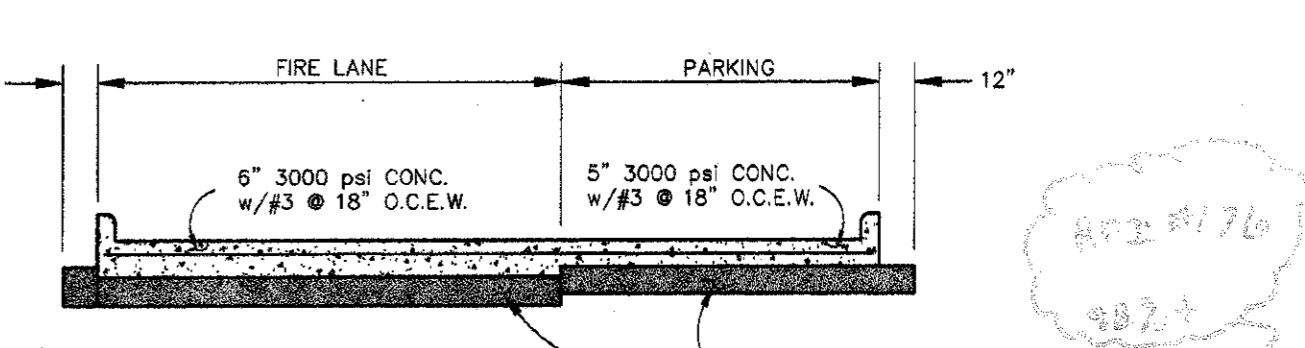

TYPICAL PAVING SECTION
N.T.S.

LEGEND

- BFR - Barrier Free Ramp
- Existing Curb
- Proposed Curb
- Sawcut
- EJ - Expansion Joint
- Existing Water Line
- Proposed Water Line
- Existing Sanitary Sewer Line
- Proposed Sanitary Sewer Line
- Proposed 5" Pavement
5" 3000 psi Concrete Reinforced w/ #3 Bars @ 18" O.C.E.W. (Parking Areas)
- Proposed 6" Pavement
6" 3000 psi Concrete Reinforced w/ #3 Bars @ 18" O.C.E.W. (Fire Lane & Drive Approaches)
- Proposed 7" Pavement
7" 3000 psi Concrete Reinforced w/ #3 Bars @ 18" O.C.E.W. (Dock Area)
- Special Paving Surface
Refer To Landscape Plans For Detail

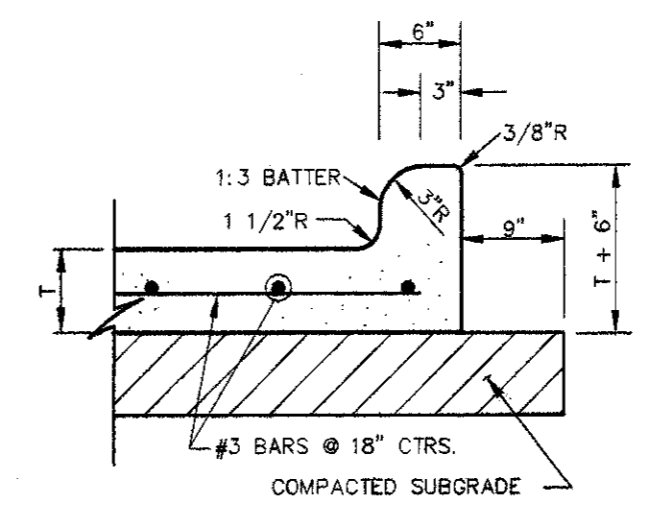

TYPICAL PAVEMENT SECTION
N.T.S.

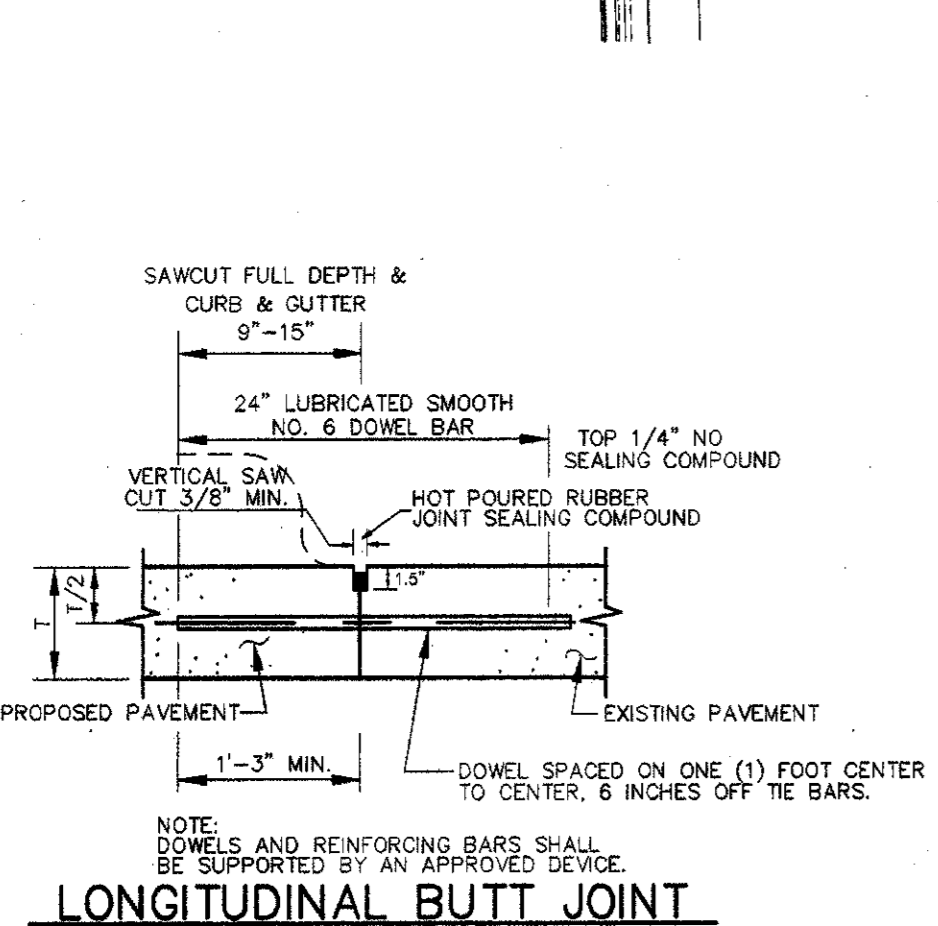

LONGITUDINAL BUTT JOINT
N.T.S.

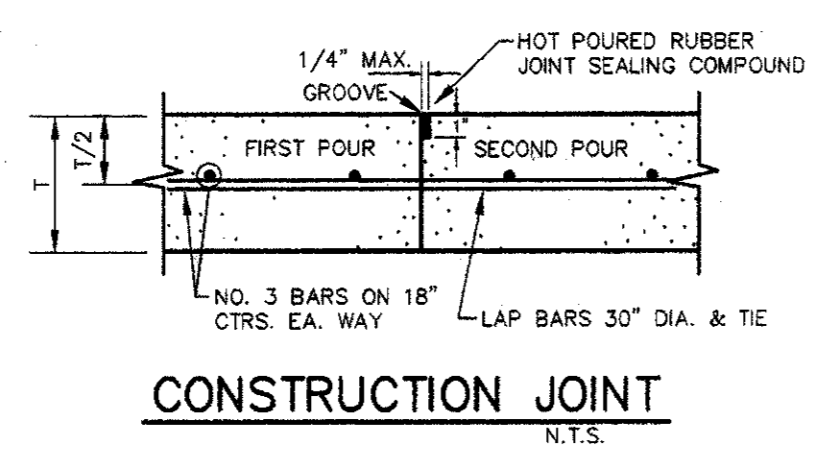

CONSTRUCTION JOINT
N.T.S.

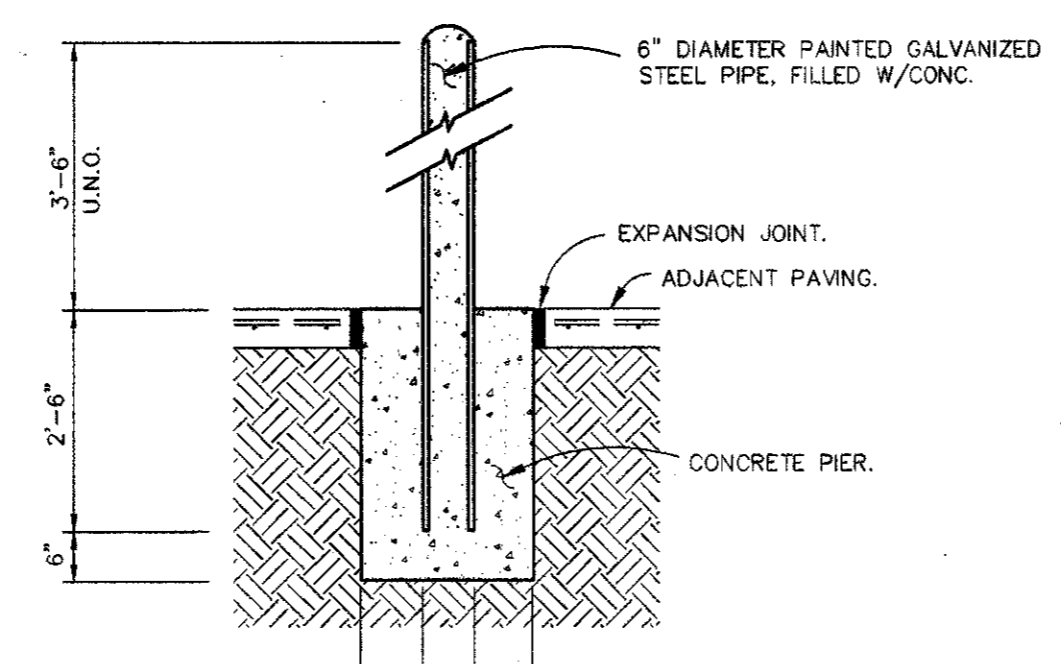

BOLLARD DETAIL
N.T.S.

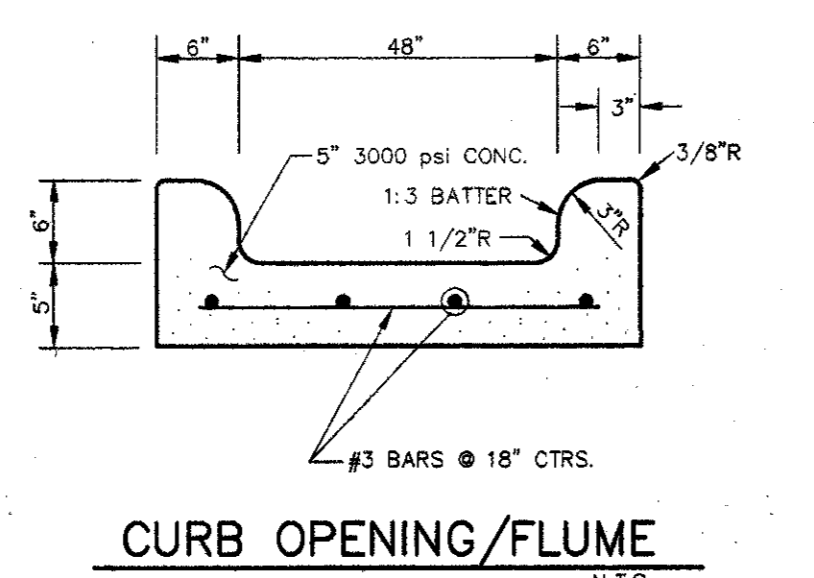

CURB OPENING/FLUME
N.T.S.

General Notes

1. All materials and construction shall conform to the Town of Addison's standards and specifications.
2. It will be the responsibility of the contractor to protect all public utilities in the construction of this project. All manholes, clean-outs, valve boxes, fire hydrants, etc. must be adjusted to proper line and grade by the Contractor prior to and after the placing of permanent paving. Utilities must be maintained to proper line and grade during construction of this project.
3. The Contractor will be responsible for coordinating with all the appropriate utility companies for the location of all utilities within the construction area.
4. The Paving Contractor shall coordinate with the Utility Contractor to insure all sleeving for irrigation has been installed prior to placement of permanent paving.
5. All paving and earthwork operations shall conform to the recommendations in the Geotechnical Investigation Report, Reed Engineering Group, Report No. 3520.
6. All dimensions are to face of curb unless otherwise noted.
7. All curb return radii are 1.5' unless otherwise noted.
8. All construction debris shall be legally disposed of offsite.

AS-BUILT

NOTE: THESE PLANS HAVE BEEN REVISED TO CONFORM WITH CONSTRUCTION RECORDS PROVIDED BY CONTRACTOR.

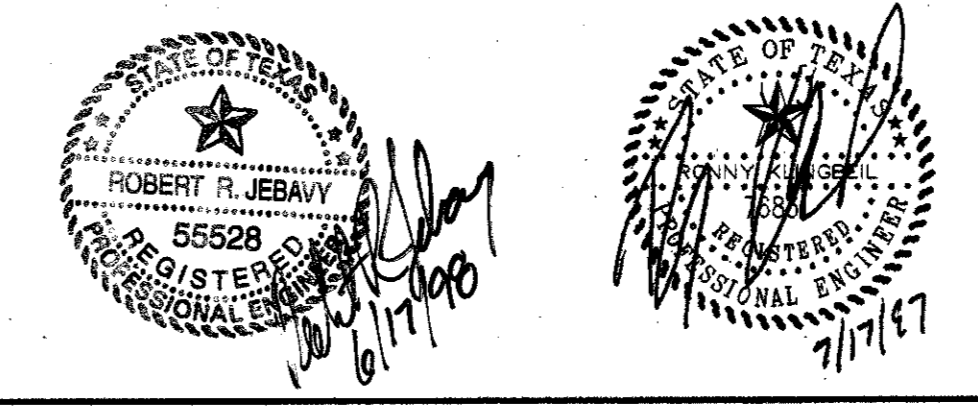

Benchmarks
Disk In Brick Wall Of Old Addison School Bldg.
4.0' Above Ground
Elevation : 650.61

Paving Plan						
Quorum Drive Office						
Addison, Texas						
BROCKETTE • DAVIS • DRAKE, INC. consulting engineers Civil & Structural Engineering • Surveying 4144 North Central Expressway, Suite 1100 • Dallas, Texas 75204 (214) 928-3647 • Fax: (214) 928-7064						
DESIGN	DRAWN	DATE	SCALE	NOTES	FILE	NO.
HW	STL	06/09/97	1"=40'	FG	C97138	C-4

- NOTES:
1. NO. 5 SMOOTH DOWEL BAR MAY BE USED IN 5 INCH AND 6 INCH PAVEMENT THICKNESS.
 2. LONGITUDINAL BUTT CONSTRUCTION MAY BE UTILIZED IN PLACE OF LONGITUDINAL HINGED JOINT AT CONTRACTOR'S OPTION.
 3. DOWEL BARS SHALL BE DRILLED INTO PAVEMENT HORIZONTALLY BY USE OF A MECHANICAL RIG.
 4. DRILLED BY HAND IS NOT ACCEPTABLE. PUSHING DOWEL BARS INTO GREEN CONCRETE NOT ACCEPTABLE.

PAV-GO.DWG