

# CIVIL CONSTRUCTION PLANS FOR OFF-SITE SANITARY SEWER

## AMLI ADDISON 15250 QUORUM DRIVE TOWN OF ADDISON DALLAS COUNTY, TEXAS

TOWN PROJECT # 17-05

### PLANS SUBMITTAL/REVIEW LOG

CIVIL ENGINEERING PACKAGE - NOT FOR CONSTRUCTION.	05/01/2017
CIVIL ENGINEERING PACKAGE SUBMITTAL 2 -NOT FOR CONSTRUCTION	06/02/2017
CIVIL ENGINEERING PACKAGE SUBMITTAL 3 -NOT FOR CONSTRUCTION	7/26/2017
CIVIL ENGINEERING PACKAGE SUBMITTAL 4 -FOR CONSTRUCTION (TOWN RELEASE)	8/14/2017
DART SUBMITTAL PACKAGE -NOT FOR CONSTRUCTION	8/23/2017

### TOWN OF ADDISON CITY COUNCIL

TOWN HALL  
5300 BELT LINE ROAD  
ADDISON, TX 75254  
(972) 450-7000

#### COUNCIL MEMBERS:

• JOE CHOW	MAYOR
• IVAN HUGHES	MAYOR PRO TEMPORE
• JIM DUFFY	DEPUTY MAYOR PRO TEMPORE
• AL ANGELL	COUNCIL MEMBER
• TOM BRAUN	COUNCIL MEMBER
• PAUL WALDEN	COUNCIL MEMBER
• LORI WARD	COUNCIL MEMBER

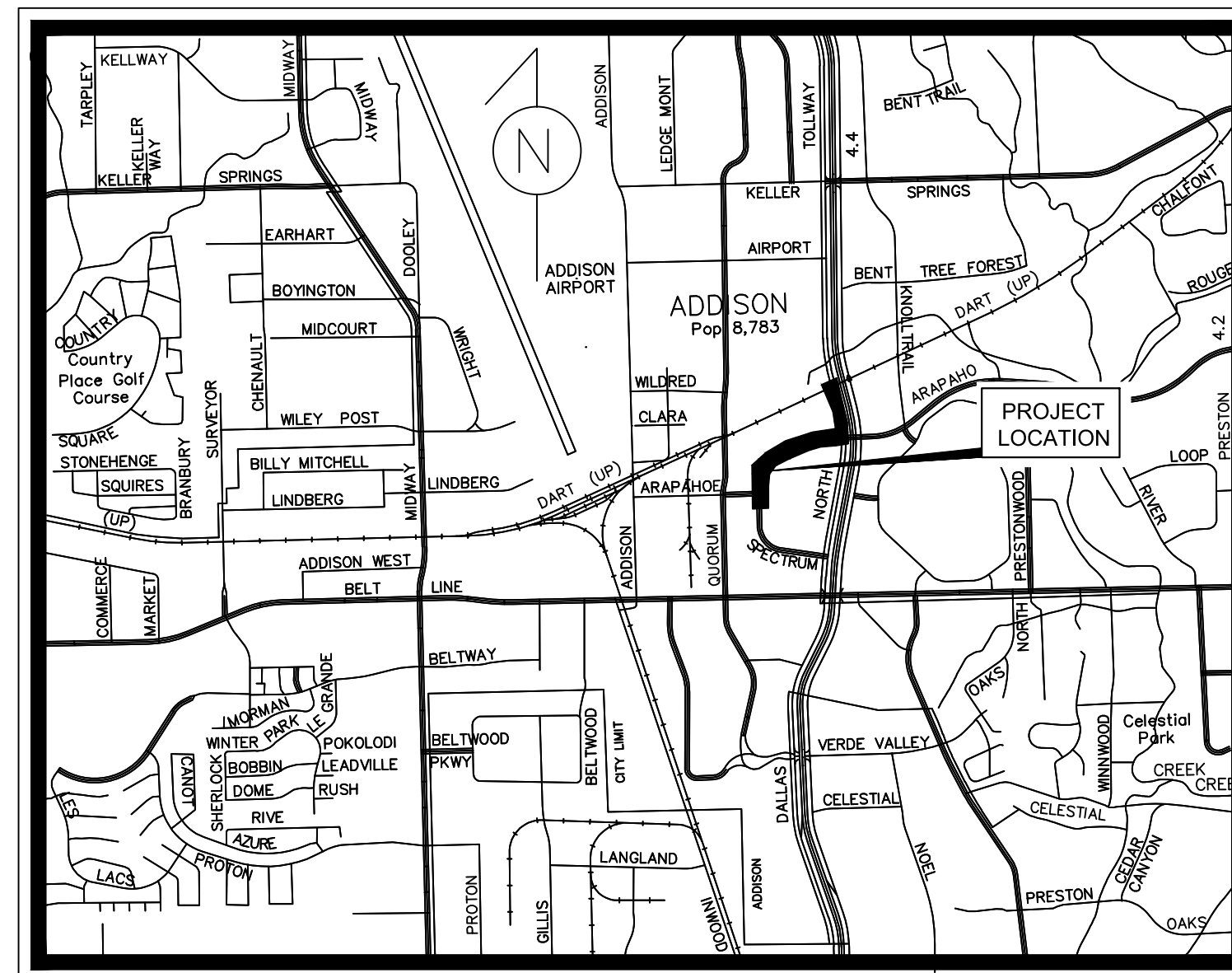

VICINITY MAP

SCALE: 1" = 2,000'

#### NOTES:

1. THE PROJECT SHALL MEET OR EXCEED THE STANDARD SPECIFICATIONS FOR PUBLIC WORKS CONSTRUCTION FOR THE NCTCOG - NORTH CENTRAL TEXAS COUNCIL OF GOVERNMENTS (LATEST EDITION), THE TOWN OF ADDISON STANDARDS, AND ANY SPECIAL PROVISIONS ADOPTED BY THE TOWN OF ADDISON. TOWN OF ADDISON STANDARDS GOVERN OVER NCTCOG IN THE EVENT OF A CONFLICT.
2. ALL NECESSARY INSPECTIONS AND/OR CERTIFICATIONS REQUIRED BY CODES AND/OR UTILITY SERVICE COMPANIES SHALL BE PERFORMED PRIOR TO CONTRACT COMPLETION AND THE FINAL CONNECTION OF SERVICES.
3. IF REPRODUCED, THE SCALES SHOWN ON THESE PLANS ARE BASED ON A 22" X 34" SHEET.

### INDEX OF SHEETS

SHEET NO.	DESCRIPTION	DATE	REVISION
C-0	COVER SHEET	05/06/2019	
C-1	GENERAL NOTES	03/02/2016	
C-2	SEWER LINE A PLAN AND PROFILE	06/19/2018	
C-3	SEWER LINE A PLAN AND PROFILE	05/06/2019	
C-4	CONSTRUCTION DETAILS	03/02/2016	
C-5	CONSTRUCTION DETAILS	03/02/2016	
TCP-1	TRAFFIC CONTROL PLAN	08/14/2017	
TCP-2	TRAFFIC CONTROL PLAN	08/14/2017	
TCP-3	TRAFFIC CONTROL PLAN	08/14/2017	
TCP-4	TRAFFIC CONTROL PLAN	08/14/2017	
TCP-5	TRAFFIC CONTROL PLAN	08/14/2017	
TCP-6	TRAFFIC CONTROL PLAN	08/14/2017	

This drawing has been revised to show those changes during the construction process reported by the contractor to Kimley-Horn and Associates, Inc. and considered to be significant. This drawing is not guaranteed to be "As Built" but is based on the information made available.

Date: 05/06/2019

By: RYAN SAFFORD, P.E.

### ENGINEER

**Kimley»Horn**

5750 GENESIS COURT SUITE 200  
FRISCO, TEXAS 75034  
PH. (972) 335-3580  
CONTACT: RYAN SAFFORD, P.E.  
RYAN.SAFFORD@KIMLEY-HORN.COM

### OWNER/DEVELOPER

AMLI RESIDENTIAL  
5057 KELLER SPRINGS ROAD  
SUITE 250  
ADDISON, TX 75001  
CONTACT: TAYLOR BOWEN

MAY 2019

