

B19-1
15255 Quorum
As-Built
Springhill Suites
B19-1

CONSTRUCTION PLANS
SPRINGHILL SUITES
QUORUM DRIVE AT EDWIN LEWIS DRIVE
TOWN OF ADDISON, TEXAS
FOR
PORTION OF
QUORUM CENTRE ADDITION
4.5 ACRES ZONED PD

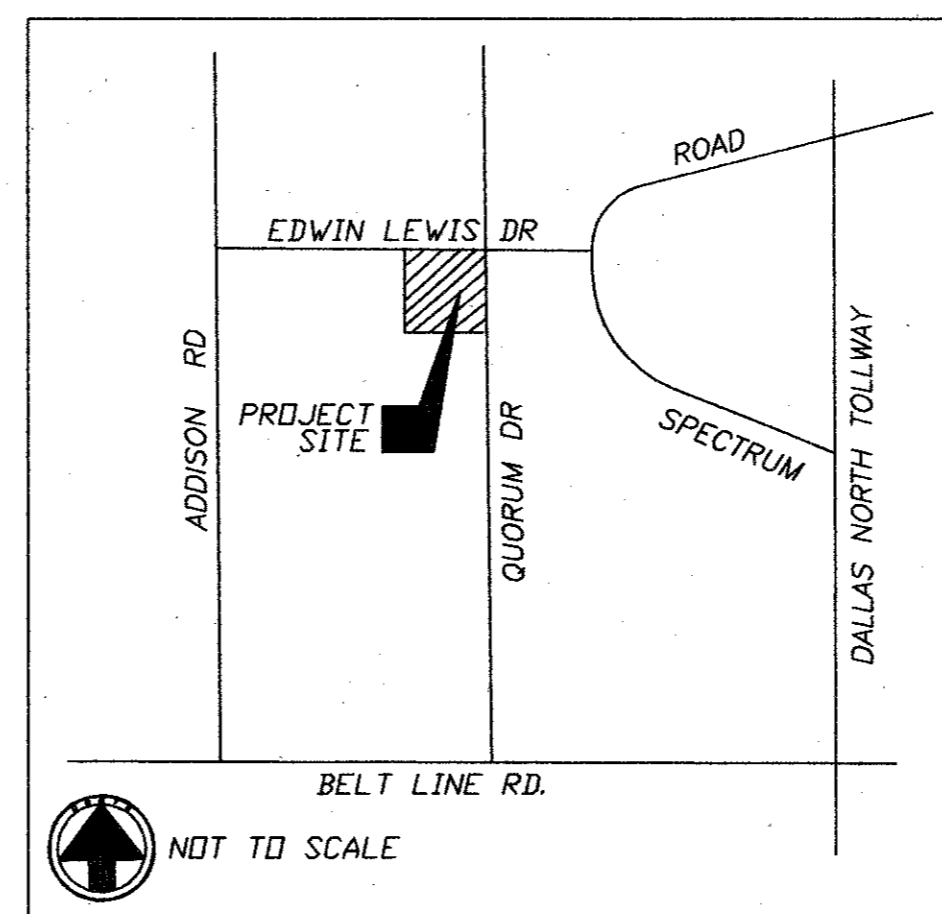

SHEET INDEX

NO.	TITLE
	COVER SHEET
C1	NOTES AND LEGEND
C2	DIMENSION CONTROL & PAVING
C3	GRADING PLAN
C4	DRAINAGE AREA MAP, CALCULATIONS & PROFILES
C5	DRAINAGE PLAN
C6	UTILITY PLAN
C7	EROSION CONTROL PLAN
C8	EROSION CONTROL NOTES
D1	MISCELLANEOUS PAVING DETAILS
D2	MISCELLANEOUS PAVING DETAILS
D3	EROSION CONTROL DETAILS

TOWN OF ADDISON, TEXAS
VICINITY MAP

PATE ENGINEERS
 8150 BROOKRIVER DRIVE
 SUITE S-700
 DALLAS, TEXAS, 75247
 TEL (214) 357-2981
 FAX (214) 357-2985
 JOB NO. 083100900

OWNER:
WESTERN INTERNATIONAL
12850 SPURLING DRIVE SUITE 114
DALLAS, TEXAS 75230
PH: (972) 934-8699
CONTACT: MIKE MAHONEY

CONTACT: JAY E. MARSH, P.E.

RECORD DRAWING
THIS DRAWING REFLECTS FIELD REVISIONS
AS PROVIDED BY THE CONTRACTOR

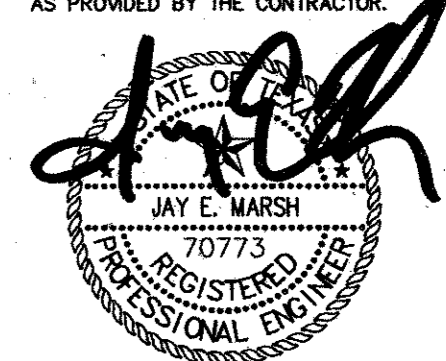

15OCT02

MAY 3, 2001
JOB NO. 083100900