

**EDWIN LEWIS DRIVE**  
( FORMERLY ARAPAHO ROAD ) ( VARIABLE WIDTH RIGHT OF WAY )

**DIMENSION CONTROL & PAVING GENERAL NOTES**

- PRIOR TO CONSTRUCTION THE CONTRACTOR SHALL MAKE CERTAIN THAT ALL REQUIRED PERMITS AND APPROVALS HAVE BEEN OBTAINED. NO CONSTRUCTION OR FABRICATION SHALL BEGIN UNTIL THE CONTRACTOR HAS RECEIVED AND THOROUGHLY REVIEWED ALL PLANS AND DOCUMENTS APPROVED BY ALL OF THE PERMITTING AGENCIES.
- ALL CONSTRUCTION SHALL CONFORM TO TOWN OF ADDISON AND N.C.T.C.O.G. STANDARDS AND SPECIFICATIONS. CONTRACTOR IS RESPONSIBLE FOR OBTAINING A CURRENT COPY OF THE TOWN OF ADDISON STANDARDS AND SPECIFICATIONS.
- ALL DIMENSIONS SHOWN ARE TO FACE OF CURB AND OUTSIDE FACE OF BUILDING UNLESS OTHERWISE NOTED.
- REFERENCE ARCHITECTURAL PLANS FOR POOL AREA LAYOUT INFORMATION.
- ALL CURB RADII ARE 30 FEET FOR LARGER CURVES AND 3 FEET FOR SMALLER CURVES UNLESS OTHERWISE NOTED.
- ALL PARKING SPACES ARE 18 FEET BY 9 FEET UNLESS OTHERWISE NOTED.
- ALL CURB SHALL BE INTEGRAL WITH CONCRETE PAVEMENT. ALL JOINTS SHALL CONTINUE THROUGH CURB.
- CONTRACTOR SHALL PROVIDE PAVEMENT JOINTING PLANS AS A SHOP DRAWING FOR ENGINEER REVIEW.
- REINFORCEMENT SHALL NOT BE CONTINUOUS THROUGH EXPANSION JOINTS.
- CONTRACTOR SHALL SAW-CUT EXISTING PAVEMENT AND CURBS TO PROVIDE A SMOOTH CONNECTION AND INSURE POSITIVE DRAINAGE. ALL SAWCUTS OF EXISTING PAVEMENT SHALL BE FULL DEPTH OF PAVEMENT.
- ACCESSIBLE RAMP TO BE LOCATED WHERE DRIVES INTERSECT PUBLIC STREETS.
- CONTRACTOR SHALL COORDINATE INSTALLATION OF ALL SIGNS, PAVEMENT MARKINGS AND OTHER TRAFFIC CONTROL DEVICES WITH OTHER CONTRACTORS ON SITE.
- ALL EXISTING STRUCTURES, CONCRETE PAVING AND WALKS WITHIN THE LIMITS OF THE PROPERTY SHALL BE REMOVED. FAILURES IN EXISTING SIDEWALK SHALL BE REMOVED AND REPLACED AS DIRECTED BY THE TOWN OF ADDISON.
- ALL PARKING STRIPES ARE FOUR-INCHES WIDE AND TRAFFIC WHITE EXCEPT WHERE NOTED.
- FIRE LANE STRIPES SHALL BE FOUR-INCHES WIDE, RED AND LABELED WITH WHITE LETTERS. MINIMUM RADIUS ON FIRE LANE STRIPE SHALL BE 30 FEET. WHERE ADJACENT TO A CURB, STRIPING SHALL BE PLACED ON THE CURB. FIRE LANE STRIPING SHALL BE PLACED CORRESPONDING TO THE FIRE LANE LOCATION REFLECTED ON THE PLANS.
- DRIVEWAY CONSTRUCTION MUST BE COMPLETED WITHIN 72 HOURS AFTER CURB CUT HAS BEGUN.
- CONTRACTOR TO PROVIDE TRENCH SAFETY PLANS SIGNED AND SEALED BY A REGISTERED ENGINEER PRIOR TO START OF CONSTRUCTION.
- ALL CONSTRUCTION SHALL ADHERE TO RECOMMENDATIONS IN THE GEOTECHNICAL REPORT ISSUED FOR THIS SITE.

- PARKING AREA PAVEMENT SHALL BE 5-INCH THICK CONCRETE PAVEMENT. FIRE LANE PAVEMENT SHALL BE 7-INCH THICK CONCRETE PAVEMENT. DUMPSTER AREA PAVEMENT SHALL BE 7-INCH THICK CONCRETE PAVEMENT. ALL PAVEMENT SECTIONS SHALL INCLUDE 6-INCH SCARIFIED AND RECOMPACTED SUBGRADE AT 95 PERCENT OF STANDARD PROCTOR.
- CONCRETE STRENGTH SHALL BE A MINIMUM OF 3,000 PSI AT 28 DAYS. FIRE LANE SHALL HAVE A MINIMUM STRENGTH OF 3,500 P.S.I. AT 28 DAYS. DRIVEWAYS WITHIN THE PUBLIC R.O.W. SHALL HAVE A MINIMUM STRENGTH OF 4,000 PSI AT 28 DAYS.
- PAVEMENT REINFORCEMENT SHALL BE NO. 3 BARS AT 18" O.C.E.W.
- CONTRACTION JOINTS SHALL BE SPACED AT 12 FEET O.C.E.W. WITH NO DIMENSION LESS THAN 75 PERCENT OF THE PERPENDICULAR DIMENSION.
- EXPANSION JOINTS SHALL PARALLEL ALL FIRE LANES. CONTRACTOR SHALL TAKE SPECIAL CARE TO ASSURE PROPER DOWEL PLACEMENT AT EXPANSION JOINTS. IMPROPER PLACEMENT WILL NECESSITATE REMOVAL OF PAVEMENT. EXPANSION JOINTS SHALL BE PLACED AT ALL FIRE LANE INTERSECTIONS AND TURNS. EXPANSION JOINTS SHALL BE SPACED AT 300-FOOT INTERVALS LONGITUDINALLY.
- REFERENCE ARCHITECTURAL PLANS FOR EXACT BUILDING AND RELATED SIDEWALK DIMENSIONS.
- IT SHALL BE THE RESPONSIBILITY OF THE CONTRACTOR TO PROTECT ALL PUBLIC UTILITIES IN THE CONSTRUCTION OF THIS PROJECT. ALL MANHOLES, CLEANOUTS, VALVE BOXES, FIRE HYDRANTS, etc. MUST BE ADJUSTED TO PROPER LINE AND GRADE BY THE CONTRACTOR PRIOR TO AND AFTER THE PLACING OF PERMANENT PAVING.
- PRIOR TO CONSTRUCTION, THE CONTRACTOR SHALL VERIFY THE LOCATION OF VALVES, MANHOLES, FIRE HYDRANTS, GAS/TELEPHONE/ELECTRICAL LINES THAT ARE AFFECTED BY THE CONSTRUCTION.
- SAW CUTTING SHALL BE DONE WITHIN 8 HOURS OF POUR OR AS SOON AS CONCRETE CAN SUPPORT WEIGHT AND CAN PROVIDE A NEAT CUT WHICH IS TRUE IN ALIGNMENT.
- RADIAL JOINTS SHALL BE NO SHORTER THAN 1.5 FEET.
- CONTRACTOR SHALL USE A THICKENED EDGE EXPANSION JOINT AROUND THE PERIMETER OF ANY BLOCKOUT IN THE CONCRETE PAVING.
- ALL CONSTRUCTION JOINTS SHALL BE SAWN, CLEANED OF DEBRIS, BLOWN DRY AND IMMEDIATELY SEALED PER N.C.T.C.O.G. SPECIFICATIONS.
- PROVIDE EXPANSION JOINTS WITHOUT DOWELS BETWEEN PAVEMENT AND BUILDING.
- THICKENED EDGES ARE REQUIRED AT ALL CONNECTIONS TO EXISTING PAVEMENT, REFER TO KEYWAY AND THICKENED EDGE DETAILS.
- CONTRACTOR SHALL COORDINATE EFFORT FOR RELOCATING LIGHT AND POWER POLES. THE COST ASSOCIATED WITH THE RELOCATION SHALL BE PAID BY CONTRACTOR.
- BUILDING FOOTPRINTS SHOWN ARE AS PROVIDED BY ARCHITECT. ALL BUILDING CORNER DIMENSIONS RELY ON THE ACCURACY OF THE ARCHITECT'S ELECTRONIC FILE. REFER TO ARCHITECTURAL PLANS FOR EXACT BUILDING DIMENSIONS. CONTRACTOR SHALL IMMEDIATELY NOTIFY ENGINEER OF ANY DISCREPANCY BETWEEN THIS PLAN AND THE ARCHITECT'S PLAN.
- REFERENCE ARCHITECTURAL PLANS FOR DUMPSTER SCREENING.
- SUBGRADES OF BUILDING AND PAVING AREAS SHALL BE MAINTAINED IN A MOIST CONDITION UNTIL THE PAVEMENT/CONCRETE IS PLACED.
- ALL ACCESSIBLE PARKING SPACES SHALL HAVE APPROPRIATE SIGNAGE ASSOCIATED WITH EACH SPACE.

QUORUM DRIVE  
( VARIABLE WIDTH RIGHT OF WAY )

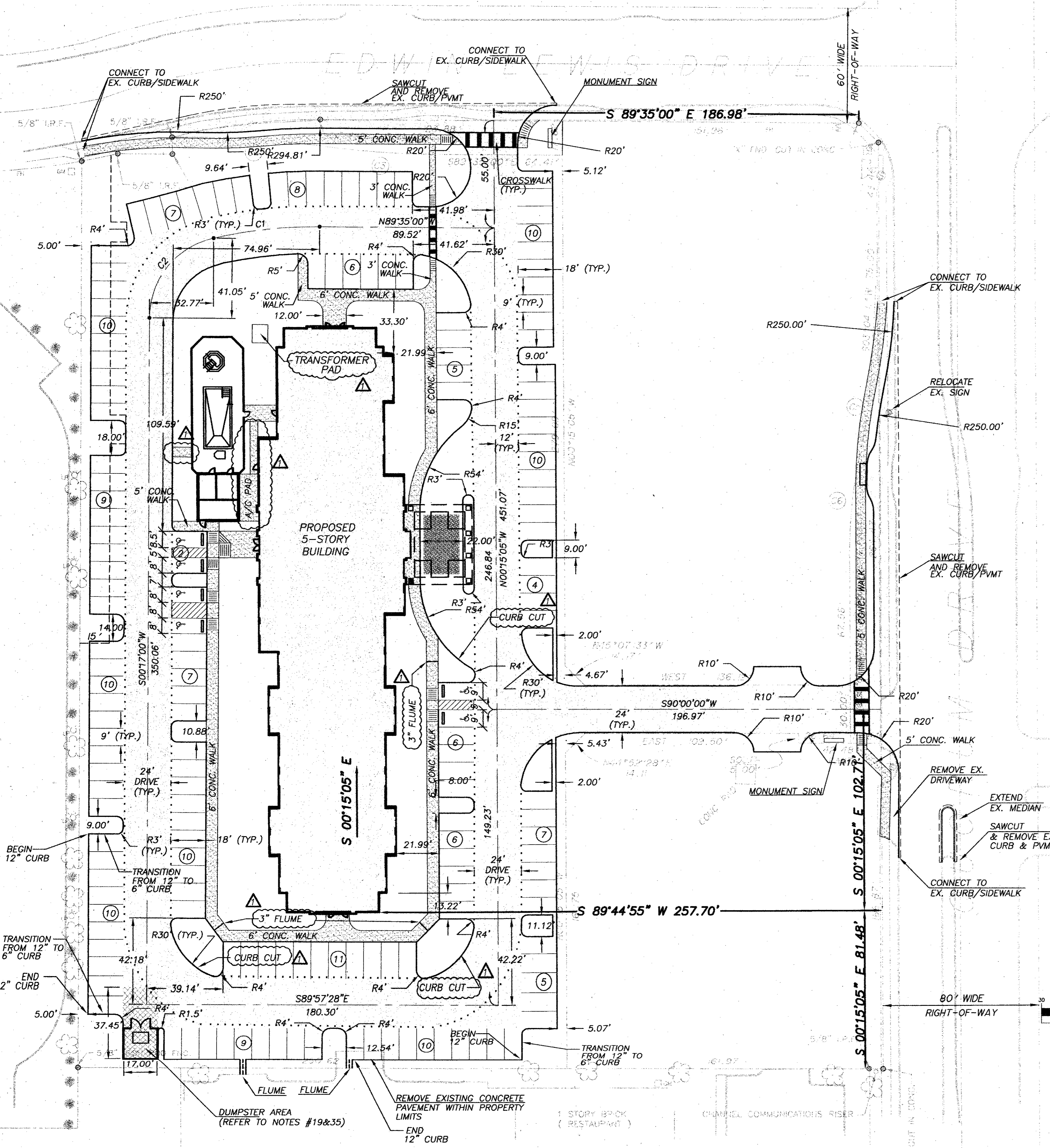

**LEGEND**

	HEAVY DUTY CONCRETE
	PROPOSED SIDEWALK
	BARRIER FREE RAMP
	FIRE LANE
	PYLON SIGN
	PARKING COUNT

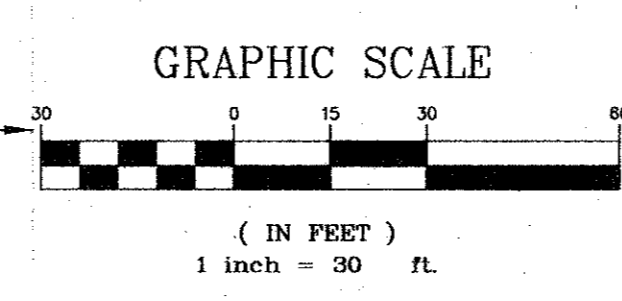

**RECORD DRAWING**  
THIS DRAWING REFLECTS FIELD REVISIONS AS PROVIDED BY THE CONTRACTOR.

**15 OCT 02**

**CURVE TABLE**

Curve	Length	Radius	Delta	Tangent	Chord	Chord Direction
C1	54.76'	244.50'	12°49'56"	27.49	54.64'	S84°00'02"W
C2	56.66'	42.00'	77°18'04"	33.59	52.46'	S38°56'02"W

**BENCHMARK:**  
TOWN OF ADDISON, TEXAS, BENCHMARK NO. 3  
60' NAIL IN POWER POLE AT SOUTHEAST CORNER  
OF JULIAN ST. AND BROADWAY ST.  
ELEV. 632.50'

**PATE ENGINEERS**  
8150 BROOKRIVER DRIVE  
SUITE S-700  
DALLAS, TEXAS, 75247  
TEL (214) 357-2981  
FAX (214) 357-2985  
JOB NO. 08310900

NO.	BY	DATE	REVISION
1	EAE	10/11/02	RECORD DRAWING

DIMENSION CONTROL & PAVING						
SPRINGHILL SUITES						
TOWN OF ADDISON, TEXAS						
DRAWN	DESIGN	DATE	NOTES	SCALE	FILE	NUMBER
JPS	JEM	05/03/01	AS	1" = 30'	MARADD11	<b>C2</b>