

EDWIN LEWIS DRIVE
(FORMERLY ARAPAHO ROAD) (VARIABLE WIDTH RIGHT OF WAY)

GRADING GENERAL NOTES

1. ALL CONSTRUCTION SHALL CONFORM TO TOWN OF ADDISON AND N.C.T.C.O.G. STANDARDS AND SPECIFICATIONS.
2. REFERENCE ARCHITECTURAL PLANS FOR EXACT BUILDING AND RELATED SIDEWALK DIMENSIONS.
3. PRIOR TO CONSTRUCTION THE CONTRACTOR SHALL VERIFY THE LOCATION OF ALL VALVES, MANHOLES, FIRE HYDRANTS, GAS/TELEPHONE/ELECTRIC LINES THAT ARE AFFECTED BY THE CONSTRUCTION.
4. MAXIMUM SLOPE WITHIN THE SITE SHALL BE THREE FEET HORIZONTAL TO ONE FOOT VERTICAL.
5. ALL CONSTRUCTION SHALL ADHERE TO RECOMMENDATIONS IN THE GEOTECHNICAL REPORT ISSUED FOR THIS SITE.
6. IT SHALL BE THE RESPONSIBILITY OF THE CONTRACTOR TO PROTECT ALL PUBLIC UTILITIES IN THE CONSTRUCTION OF THIS PROJECT. ALL MANHOLES, CLEANOUTS, VALVE BOXES, FIRE HYDRANTS, etc. MUST BE ADJUSTED TO PROPER LINE AND GRADE BY THE CONTRACTOR PRIOR TO AND AFTER THE PLACING OF PERMANENT PAVING.
7. REFERENCE EROSION CONTROL PLAN FOR EROSION CONTROL DEVICES TO BE INSTALLED PRIOR TO BEGINNING GRADING OPERATIONS. MAINTENANCE REQUIREMENTS ARE ALSO DEFINED.
8. AREAS TO RECEIVE FILL, OR WITHIN THE BUILDING AREA SHALL BE SCARIFIED TO A DEPTH OF 6 INCHES AND RECOMPACTED TO BETWEEN 92 PERCENT AND 98 PERCENT OF STANDARD PROCTOR DENSITY (ASTM D-698). MOISTURE CONTENT SHALL RANGE FROM +1 TO +5 PERCENTAGE POINTS ABOVE OPTIMUM. FILL SHALL BE PLACED IN 8-INCH LOOSE LIFTS.
9. PAVEMENT SUBGRADE SHALL BE SCARIFIED AND RECOMPACTED TO A MINIMUM OF 95 PERCENT STANDARD PROCTOR, AT OR ABOVE OPTIMUM MOISTURE CONTENT. SUBGRADE WITHIN THE R.O.W. SHALL BE RECOMPACTED AT 0 TO +3 PERCENTAGE POINTS OF OPTIMUM MOISTURE CONTENT.
10. ALL VEGETATION AND TOPSOIL CONTAINING ORGANIC MATERIAL SHALL BE CLEARED AND GRUBBED AT THE BEGINNING OF EARTHWORK CONSTRUCTION.

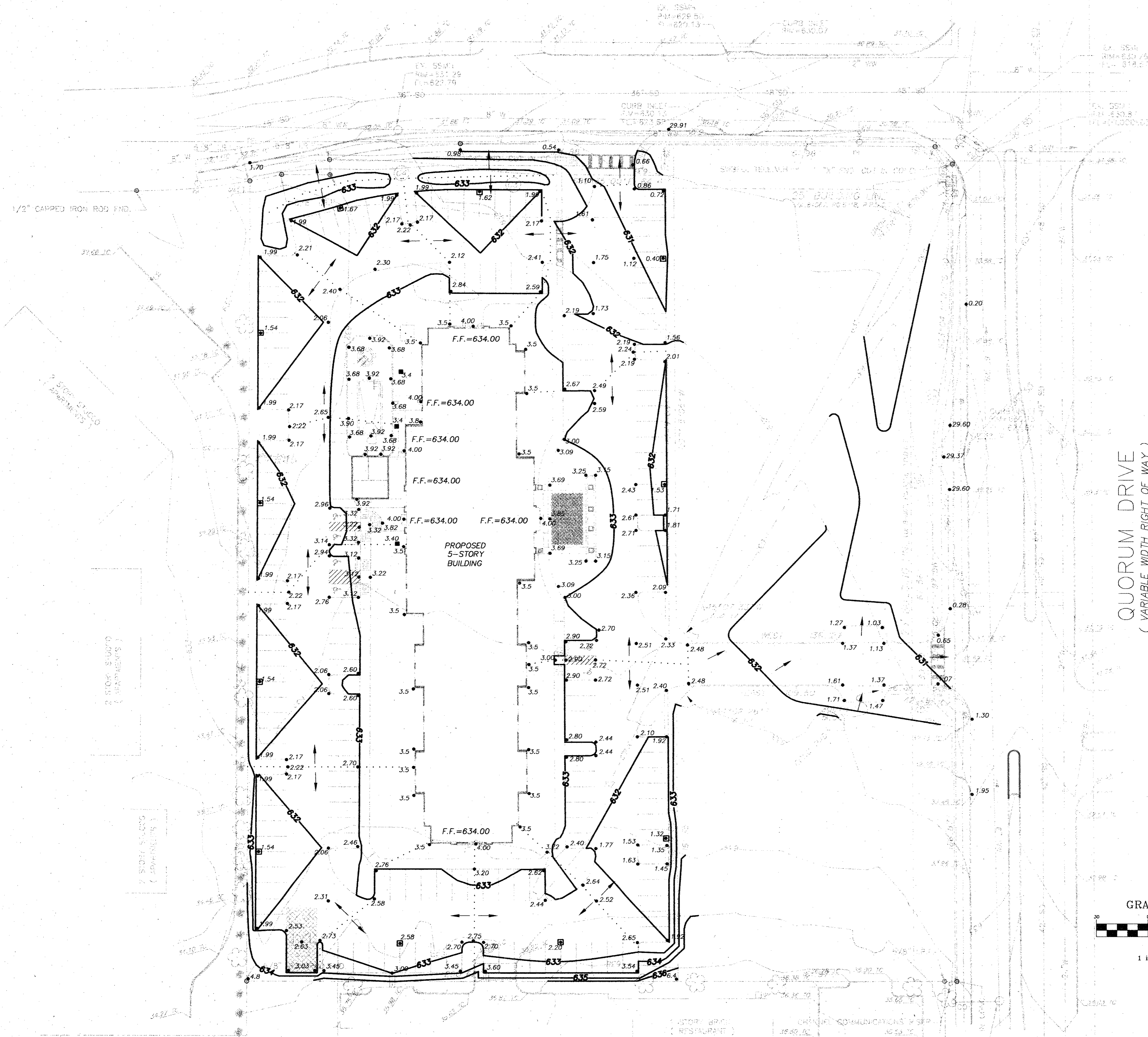

QUORUM DRIVE
(VARIABLE WIDTH RIGHT OF WAY)

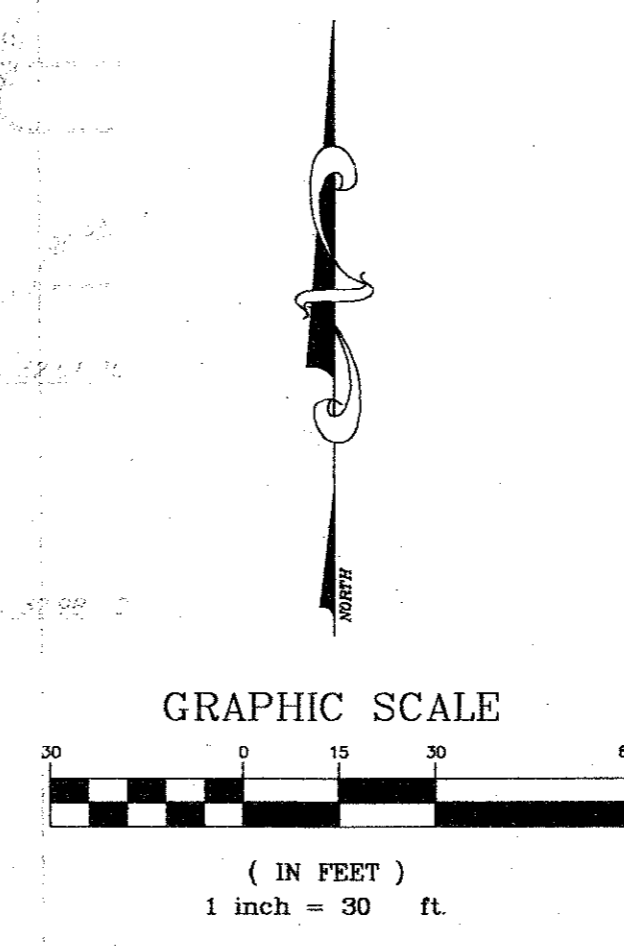

RECORD DRAWING
THIS DRAWING REFLECTS FIELD REVISIONS
AS PROVIDED BY THE CONTRACTOR.



15 OCT 02

GRADING PLAN

SPRINGHILL SUITES

TOWN OF ADDISON, TEXAS

NO.	BY	DATE	REVISION
1	EAE	10/11/02	RECORD DRAWING

PATE ENGINEERS

8150 BROOKRIVER DRIVE
SUITE S-700
DALLAS, TEXAS, 75247
TEL (214) 357-2981
FAX (214) 357-2985

BENCHMARK:
TOWN OF ADDISON, TEXAS, BENCHMARK NO. 3
60D NAIL IN POWER POLE AT SOUTHEAST CORNER
OF JULIAN ST. AND BROADWAY ST.
ELEV. 632.50'

DRAWN	DESIGN	DATE	NOTES	SCALE	FILE	NUMBER
JPS	JEM	05/03/01	AS	1" = 30'	MARADGR1	C3

X:\p0505\083100900\MARADGR1.dwg, 10/15/02 08:59:49 AM, EAE