

EDWIN LEWIS DRIVE
(FORMERLY ARAPAHO ROAD) (VARIABLE WIDTH RIGHT OF WAY)

UTILITY GENERAL NOTES

- ALL CONSTRUCTION SHALL CONFORM TO TOWN OF ADDISON STANDARDS AND SPECIFICATIONS.
- ALL DIMENSIONS SHOWN ARE TO FACE OF CURB, CENTERLINE OF PIPE AND OUTSIDE FACE OF BUILDING UNLESS OTHERWISE NOTED.
- THE UTILITY CONTRACTOR SHALL BE RESPONSIBLE FOR ADJUSTING ALL WATER MAINS IN AREAS OF CONFLICT WITH OTHER PROPOSED UTILITIES.
- CONTRACTOR TO PROVIDE TRENCH SAFETY PLANS SIGNED AND SEALED BY A LICENSED ENGINEER PRIOR TO START OF CONSTRUCTION.
- THE CONTRACTOR SHALL PROVIDE AS-BUILT PLANS TO THE ENGINEER SO THAT THE REPRODUCIBLES OF THE ENGINEERING PLANS MAY BE CORRECTED TO REFLECT AS-BUILT CONDITIONS.
- THE CONTRACTOR SHALL BE REQUIRED TO PROVIDE AND MAINTAIN ALL NECESSARY WARNING AND SAFETY DEVICES (FLASHING LIGHTS, BARRICADES, SIGNS, etc.) TO PROTECT PUBLIC SAFETY AND HEALTH UNTIL ALL WORK HAS BEEN COMPLETED AND ACCEPTED BY THE TOWN OF ADDISON.
- ALL WATER AND SEWER CROSSINGS SHALL BE CENTERED ON THE JOINT OF PIPE.
- ALL SANITARY SEWER PIPE SHALL BE SDR 35 PVC (ASTM 3034). EXCESSIVE DEPTH LINES MAY REQUIRE A DIFFERENT PIPE SPECIFICATION. REFERENCE PLANS FOR LOCATION AND LIMITS OF EXCESSIVE DEPTH PIPE.
- ALL SANITARY SEWER AND WATER LINES SHALL BE TESTED IN ACCORDANCE WITH TOWN OF ADDISON STANDARD SPECIFICATIONS.
- ALL SANITARY SEWER MAIN CONSTRUCTION SHALL CONFORM TO THE MINIMUM REQUIREMENTS OF THE TEXAS STATE DEPARTMENT OF HEALTH RULES AND REGULATIONS FOR PUBLIC WATER AND SEWERAGE SYSTEMS.
- THE LOCATION OF EXISTING UNDERGROUND FACILITIES INDICATED ON THE PLANS IS TAKEN FROM PUBLIC RECORDS. IT IS THE CONTRACTOR'S RESPONSIBILITY TO MAKE ARRANGEMENTS WITH THE OWNERS OF SUCH UNDERGROUND FACILITIES PRIOR TO WORKING IN THE AREA TO CONFIRM THEIR EXACT LOCATION AND TO DETERMINE WHETHER ANY ADDITIONAL FACILITIES, OTHER THAN THOSE SHOWN ON THE PLAN, MAY BE PRESENT. THE CONTRACTOR SHALL PRESERVE AND PROTECT ALL UNDERGROUND FACILITIES FOUND.
- WATER MAINS SHALL BE PVC C909, DR18, CLASS 200
- ALL WATER LINE FITTINGS SHALL BE GRAY OR DUCTILE CAST IRON AND SHALL BE CEMENT LINED INSIDE AND BITUMINOUS COATED OUTSIDE.
- THE UTILITY CONTRACTOR SHALL PROVIDE ADEQUATE CONCRETE THRUST BLOCKING AT ALL TEES, BENDS, FIRE HYDRANTS, etc.
- IT SHALL BE THE RESPONSIBILITY OF THE CONTRACTOR TO PROTECT ALL PUBLIC UTILITIES IN THE CONSTRUCTION OF THIS PROJECT. ALL MANHOLES, CLEANOUTS, VALVE BOXES, FIRE HYDRANTS, etc. MUST BE ADJUSTED TO PROPER LINE AND GRADE BY THE CONTRACTOR PRIOR TO AND AFTER THE PLACING OF TEMPORARY AND PERMANENT PAVING.
- HOSE/PUMPER NOZZLES ON FIRE HYDRANTS SHALL BE 18 INCHES ABOVE THE TOP OF CURB, OR FINISHED GRADE AND SHALL FACE THE STREET OR FIRE LANE. FIRE HYDRANTS SHALL BE PLACED NOT LESS THAN THREE FEET NOR MORE THAN SIX FEET BEHIND THE CURB.
- ALL WATER MAINS SHALL HAVE A MINIMUM COVER OF 42 INCHES FROM FINISHED GRADE.
- CONTRACTOR SHALL VERIFY ALL EXISTING INVERTS AND RIM ELEVATIONS PRIOR TO BEGINNING CONSTRUCTION. IF ANY DISCREPANCY IS FOUND, CONTRACTOR SHALL IMMEDIATELY NOTIFY ENGINEER FOR RESOLUTION.
- ALL UNDERGROUND PIPING FOR FIRE SPRINKLER SYSTEM IS REQUIRED TO BE INSTALLED BY A LICENSED CONTRACTOR AND PERMITTED THROUGH FIRE PREVENTION.
- FIRE SPRINKLER PIPING IS REQUIRED TO BE CLASS 200.
- CONTRACTOR SHALL REFERENCE MEP AND ARCHITECTURAL PLANS TO CONFIRM LOCATION OF BUILDING UTILITY SERVICES PRIOR TO BEGINNING CONSTRUCTION.
- CONSTRUCTION SHALL NOT PROCEED ABOVE FOUNDATION PRIOR TO COMPLETION OF ALL FIRE LANES.
- CONTRACTOR SHALL TERMINATE ALL UTILITY LINES FIVE FEET FROM THE FACE OF BUILDING.
- ALL PVC TO RCP CONNECTIONS SHALL BE CONSTRUCTED WITH CONCRETE COLLARS.
- CONTRACTOR SHALL VERIFY THE SUITABILITY OF ALL EXISTING AND PROPOSED SITE CONDITIONS INCLUDING GRADES AND DIMENSIONS BEFORE COMMENCEMENT OF CONSTRUCTION. ENGINEER SHALL BE NOTIFIED IMMEDIATELY OF ANY DISCREPANCIES.
- UTILITY BACKFILL SHALL BE TESTED ONCE PER 150 LINEAR FEET OF TRENCH.
- ABANDONED LINE TO BE FILLED WITH GROUT WHERE UNDER PROPOSED PAVEMENT. IF ANY PORTION OF THE LINE IS UNDER THE PROPOSED BUILDING, REMOVE THE LINE WITHIN THE BUILDING ENVELOPE.

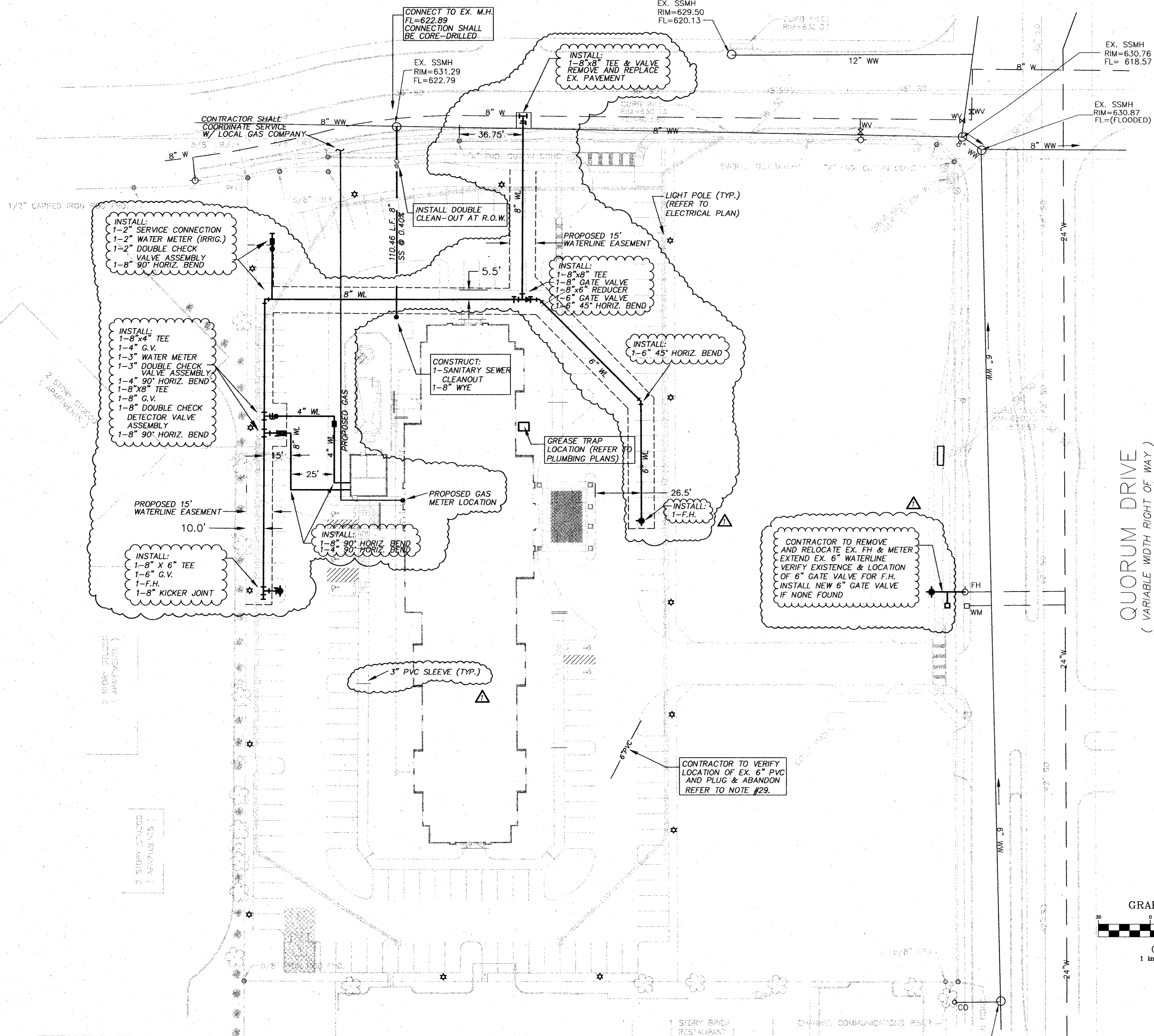

QUORUM DRIVE
(VARIABLE WIDTH RIGHT OF WAY)

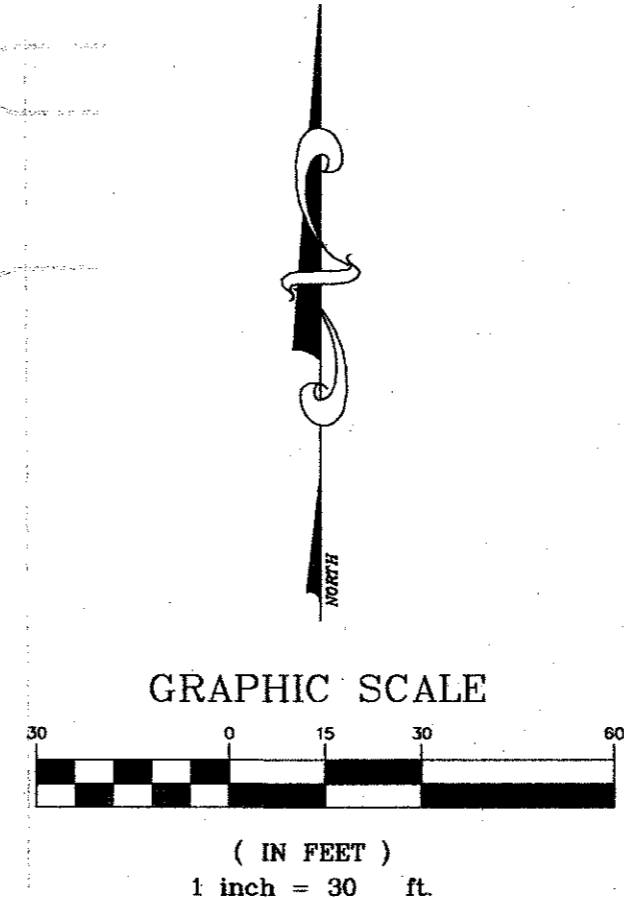

GRAPHIC SCALE

(IN FEET)
1 inch = 30 ft.

RECORD DRAWING
THIS DRAWING REFLECTS FIELD REVISIONS
AS PROVIDED BY THE CONTRACTOR.

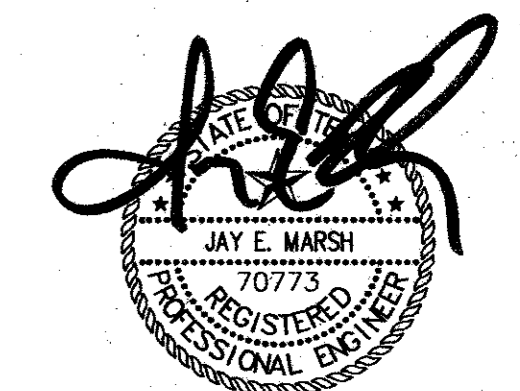

15 OCT 02

NO.	BY	DATE	REVISION
1	EAE	10/11/02	RECORD DRAWING

PATE ENGINEERS

8150 BROOKRIVER DRIVE
SUITE 5-700
DALLAS, TEXAS, 75247
TEL (214) 357-2981
FAX (214) 357-2985

JOB NO. 08310090

BENCHMARK:
TOWN OF ADDISON, TEXAS, BENCHMARK NO. 3
60D NAIL IN POWER POLE AT SOUTHEAST CORNER
OF JULIAN ST. AND BROADWAY ST. ELEV. 632.50'

UTILITY PLAN						
SPRINGHILL SUITES						
TOWN OF ADDISON, TEXAS						
DRAWN	DESIGN	DATE	NOTES	SCALE	FILE	NUMBER
JPS	JEM	05/03/01	AS	1"=30'	MARADUTI	C6

X:\projects\08310090\08310090\08310090.dwg, 10/15/02, 08:11:56 AM, EAE