

Addison Residential

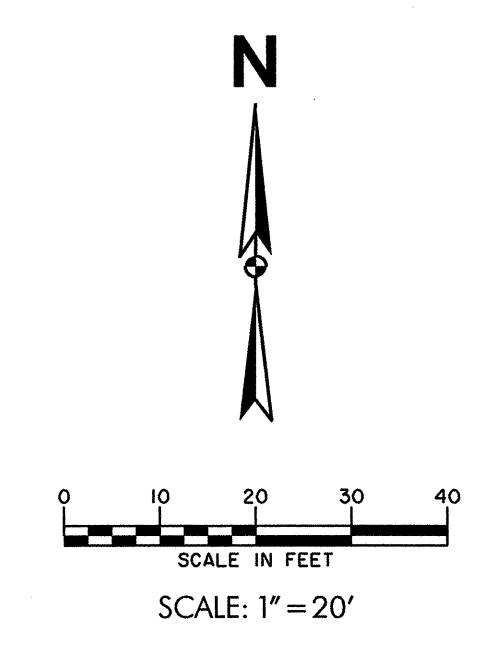
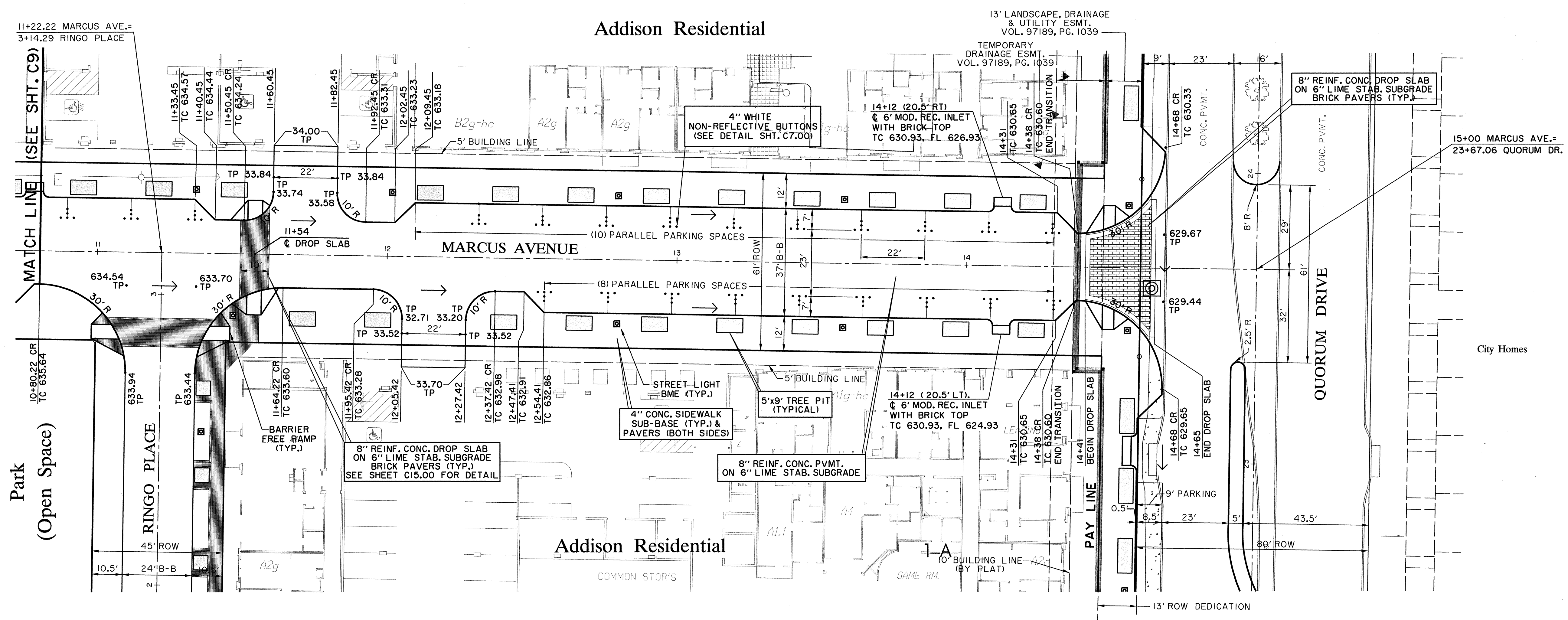

CAUTION!
 EXIST. GAS MAIN IN AREA
 CONTACT TEXAS ONE CALL
 1-800-245-4545
 48 HOURS PRIOR TO
 CONSTRUCTION

ADDISON RESIDENTIAL PLANS ← → QUORUM DR. PLANS

RECORD DRAWING

THIS DRAWING HAS BEEN MODIFIED FROM THE ORIGINAL TO SHOW ONLY THE FIELD CHANGES AND ADJUSTMENTS MADE DURING CONSTRUCTION BY THE CONTRACTOR WHICH WERE DOCUMENTED AND FURNISHED TO THE ENGINEER FOR THE PURPOSE OF PREPARING THESE RECORD DRAWINGS. FIELD INSPECTION OF CONSTRUCTION WAS PERFORMED BY OTHERS. TO THE BEST OF OUR KNOWLEDGE AND UNDERSTANDING THESE RECORD DRAWINGS REPRESENT THE "AS-BUILT" CONDITIONS.



SHEET 4 OF 4
 PROJECT: 01340801.dgn
 DATE: 11/20/08
 DRAWN BY: HZ1
 CHECKED BY: HZ1
 APPR. BY: DEM
 SCALE: H: 1"=20', V: 1"=6'
 DATE: 11/20/08
 PROJECT NO.:
 NO.: C8

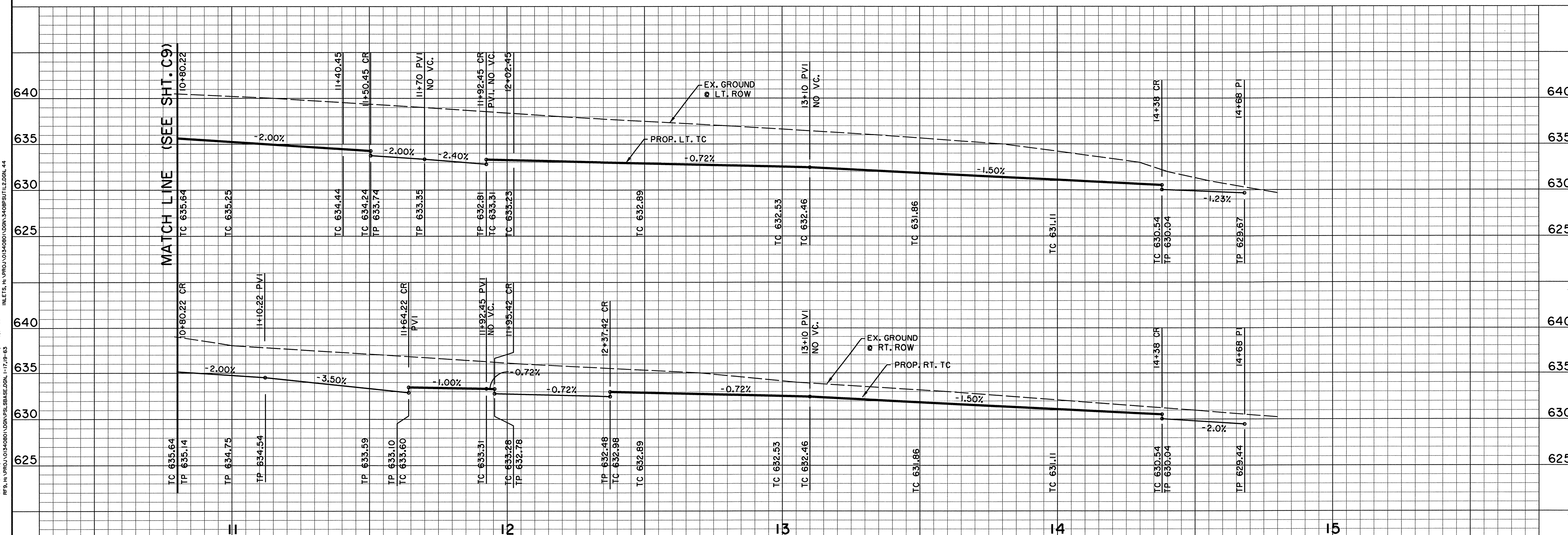

BENCHMARKS:						
640	BM#5 "C" CUT ON 8' INLET ON NORTH CURB LINE OF GOODMAN AVE. 175' EAST OF PASCHAL PLACE. ELEV. 629.98					
635	BM#6 "C" CUT AT C/O OF 8' INLET AT THE SOUTHWEST CORNER OF MORRIS AVE. AND WITT PLACE. ELEV. 627.29					
630	BM#7 "C" CUT AT WEST CORNER OF ADDISON THEATRE CENTRE PARKING LOT, SECOND ENTRANCE NORTH OF ADDISON RD. ELEV. 637.66					
PAVING PLAN & PROFILE MARCUS AVENUE ADDISON RESIDENTIAL						
TOWN OF ADDISON, TEXAS						
HUNT - ZOLLERS, INC. 3131 McKinney Ave., Suite 600 Dallas, TX 75204 Phone (214) 871-3311/Fax (214) 871-0757						
DESIGN	CHECKED	APPR.	SCALE	DATE	PROJECT NO.	NO.
HZ1	HZ1	DEM	H: 1"=20' V: 1"=6'	11/20/08		C8