

# CONSTRUCTION PLANS FOR PARKSIDE CORPORATE CENTER

## AN ADDITION TO THE TOWN OF ADDISON, TEXAS

### Index Of Drawings

- C-1 Cover Sheet
- C-2 Plat
- C-3 Paving Plan
- C-4 Grading Plan
- C-5 Drainage Area Map
- C-6 Storm Sewer Plan
- C-7 Storm Sewer Profile
- C-8 Water and Sanitary Sewer Plan
- C-9 Erosion Control
- C-10 Storm Water Pollution Prevention Plan - Narrative
- C-11 Storm Water Pollution Prevention Plan - Narrative
- C-12 Storm Water Pollution Prevention Plan - Practices
- C-13 Horizontal Control Plan
- D-1 Multiple Box Culverts

#### GENERAL NOTES

- A. Prior to final acceptance by the Town of Addison,
  1. A Texas Registered Professional Engineer shall certify that the project was constructed in accordance with the plans and specifications approved by the Town of Addison.
  2. The Owner shall provide one reproducible set of as-built (sealed and certified by a Texas Registered Engineer) and two blue line sets.
  3. A two foot (2') sidewalk shall be installed along the public streets. See attached detail.
  4. A one year 10% maintenance bond is required for the public infrastructure.
  5. Contractor shall demonstrate that the water and sanitary sewer systems meet the property pressure, bacteria, and mandrel tests. In addition, the Owner shall provide a VHS format video tape of the sanitary sewer.
- B. Prior to starting construction, the Contractor shall contact the utility companies to locate existing facilities. These include but may not be limited to the following:
  1. Town of Addison
  2. Lone Star Gas
  3. Southwestern Bell
  4. Sloner Cable
  5. Planned Cable Systems
  6. T.U. Electric
- C. Prior to beginning construction, the Owner or his authorized representative shall convene a preconstruction conference among the Town of Addison, Consulting Engineers, Contractor(s), Utility companies and any other affected parties. Notify Bruce Ellis (972) 450-2847 at least 48 hours prior to beginning of construction.
- D. Any existing pavement, curbs, and/or sidewalks damaged or removed will be repaired by the Contractor at their expense.
- E. Lot pins shall be installed after construction and prior to final acceptance. Concrete monuments shall be placed as shown on the final plat and iron pins shall be placed at block corners, curve points and angle points in public right-of-way. Concrete monuments shall be six inches (6") in diameter and twenty-four inches (24") long, on iron rod one-half inch (1-1/2") in diameter embedded at least three inches (3") in the monument at the exact intersection point of the monument. The monuments shall be set at such an elevation that after construction, the top of the monument will be not less than twelve inches (12") below the ground surface.
- F. The Contractor shall stamp a two inch (2") "S" and a two inch (2") "W" in the curb at the location of the sewer service and water service lines, respectively.
- G. At intersections that have valley drainage, the crown of the intersecting streets will culminate in a distance of 40 feet (40') from the intersecting curb line unless otherwise noted.
- H. Temporary or permanent street barricades shall remain at all points of ingress and egress to prevent public use until such street received final acceptance.
- I. Contractor shall obtain a right-of-way permit by the Town of Addison for working within the public right-of-way.
- J. During construction, the Owner shall provide a qualified geotechnical lab to perform materials testing during the construction at the request of the Town of Addison.
- K. The Contractor shall submit material sheets to the Town of Addison for approval prior to incorporating materials into the job.
- L. The utility contractor shall submit to the Town of Addison for approval a trench safety plan sealed by a Registered Professional Engineer for the installation of utilities greater than five feet (5') in depth.
- M. All existing and proposed improvements (curbs, manholes, fire hydrants, water meters, etc.) shall be adjusted to finished grade by the Contractor.

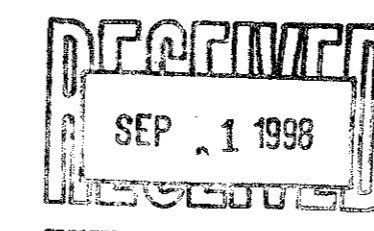

### Owner

**Centre Development Company, Inc**  
**14001 North Dallas Parkway, Suite 900**  
**Dallas, Texas 75240**  
**(972) 980-8060**  
**Contact Jack McJunkin, Jr.**

### Engineer

**Brockette • Davis • Drake**  
**4144 N. Central Expressway, Suite 1100**  
**Dallas, Texas 75204**  
**(214) 824-3647**

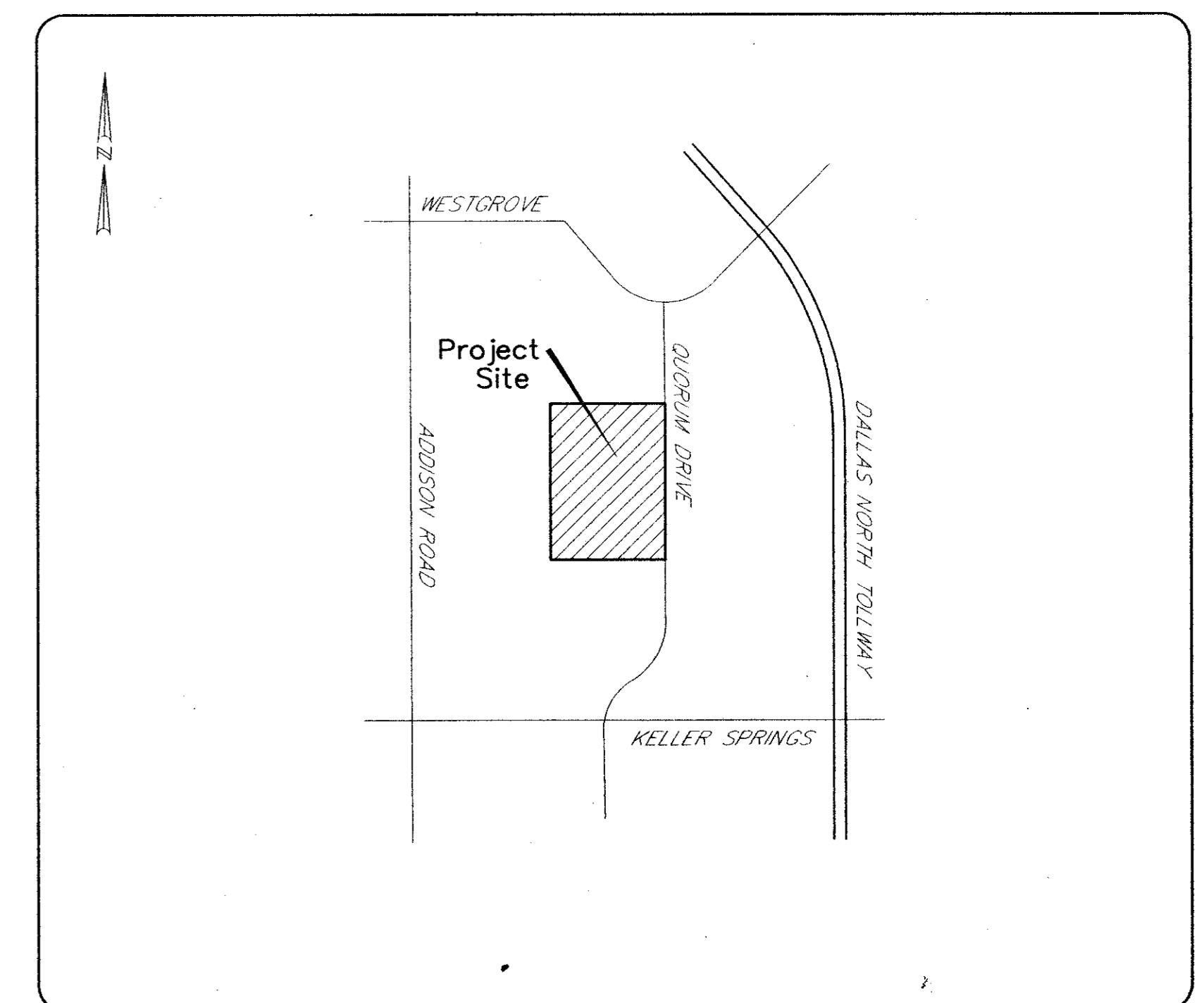
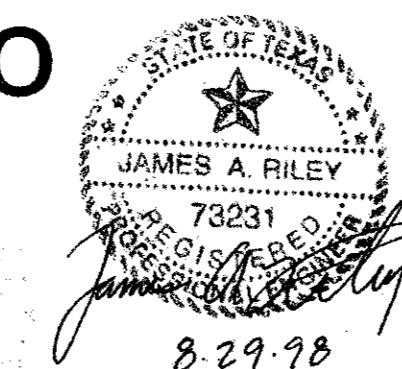
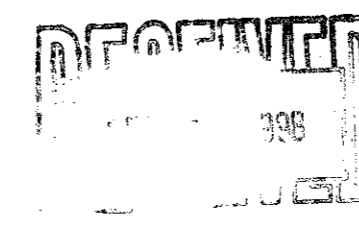

Location Map  
nts

PARKSIDE CORPORATE CENTER

COVERING