

BILLS OF REINFORCING STEEL - FOR 44' CLEAR WIDTH - BARRELS ONLY

Table with 4 columns representing different barrel spans: 2 SPANS 9'x5', 2 SPANS 9'x6', 2 SPANS 9'x7', and 2 SPANS 9'x8'. Each column contains 4 rows: NUMBER, SIZE, SPACING, LENGTH, and WEIGHT. Each row lists 26 different span lengths and their corresponding steel quantities.

Table with 4 columns for 2 SPANS 9'x5', 2 SPANS 9'x6', 2 SPANS 9'x7', and 2 SPANS 9'x8'. Each column contains 4 rows: NUMBER, SIZE, SPACING, LENGTH, and WEIGHT, listing steel quantities for various span lengths.

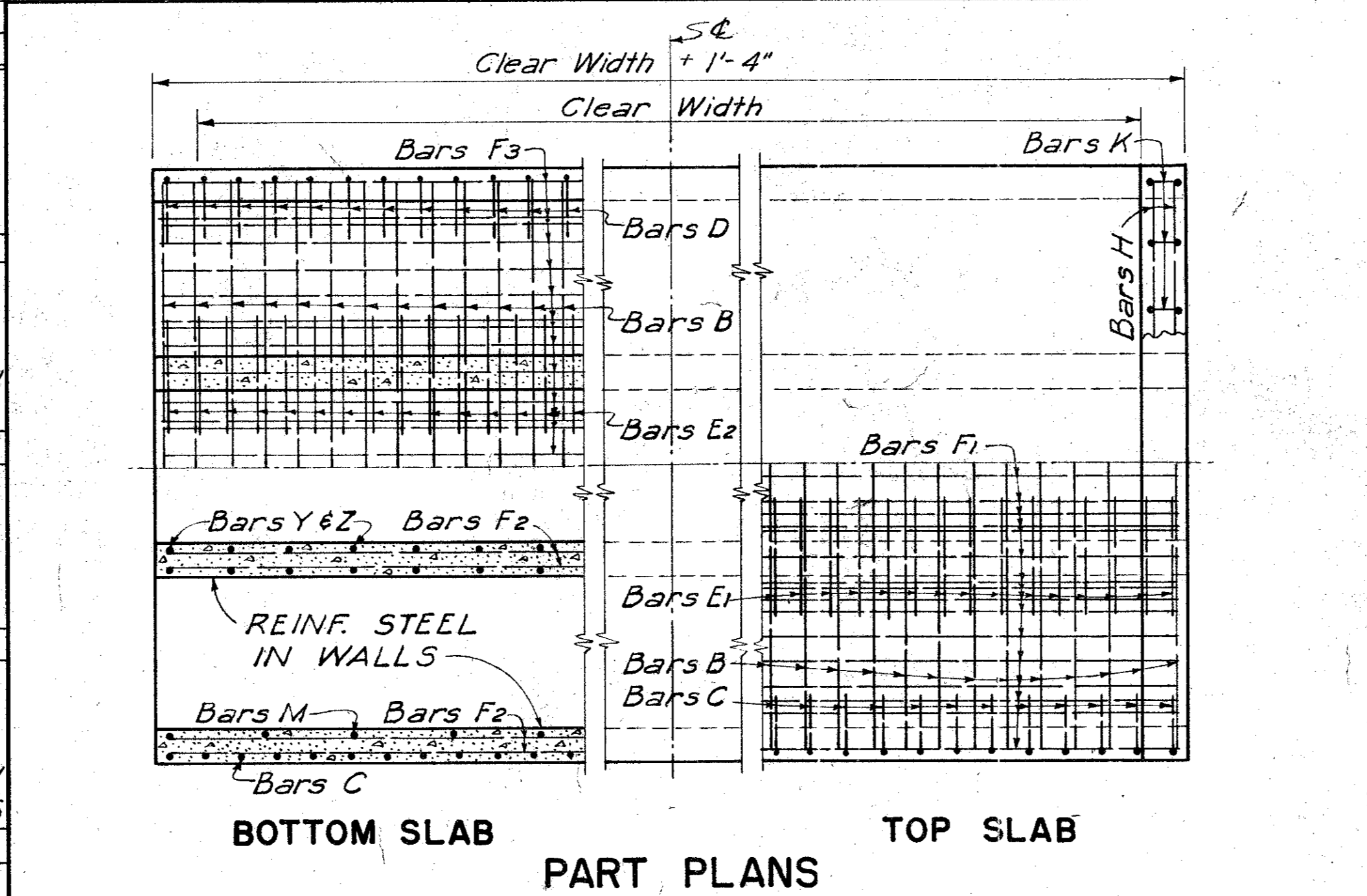

BARREL QUANTITIES FOR 44' CLEAR WIDTH. Table with columns: CULVERT SIZE, NO. OF SPANS, LENGTH OF STRUCT., *BARREL QUANTITIES (CONC., STEEL), and QUANTITIES (CONC., STEEL). Rows list barrel sizes from 9'x5' to 9'x9'.

GENERAL NOTES:- Design Loading: H20- or H20 S16- in accordance with A.A.S.H.O. 1957 Standard Specifications. Chamfer exposed corners 3/4". All dimensions relating to reinforcing steel are to centers of bars. Quantities of reinforcing steel shown hereon are for 44'-0" clear width between headwalls.

CONSTRUCTION JOINT SHOWN AT THE FLOW LINE MAY BE RAISED A MAXIMUM OF 6" AT THE CONTRACTOR'S OPTION. BARS A MAY BE CUT OFF OR RAISED, BARS C & D MAY BE REVERSED (D ON TOP) AND BARS Y & Z MAY BE REVERSED (Y ON TOP).

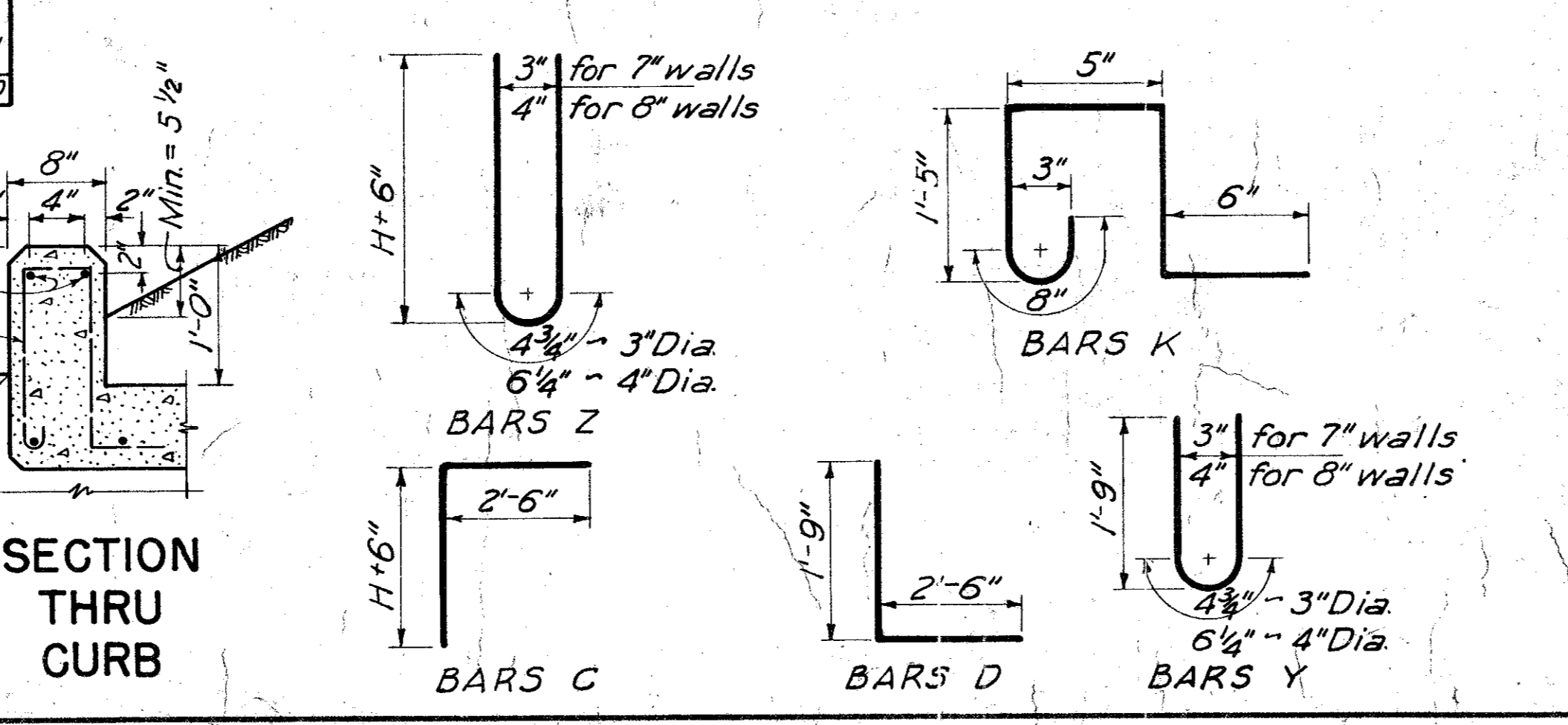
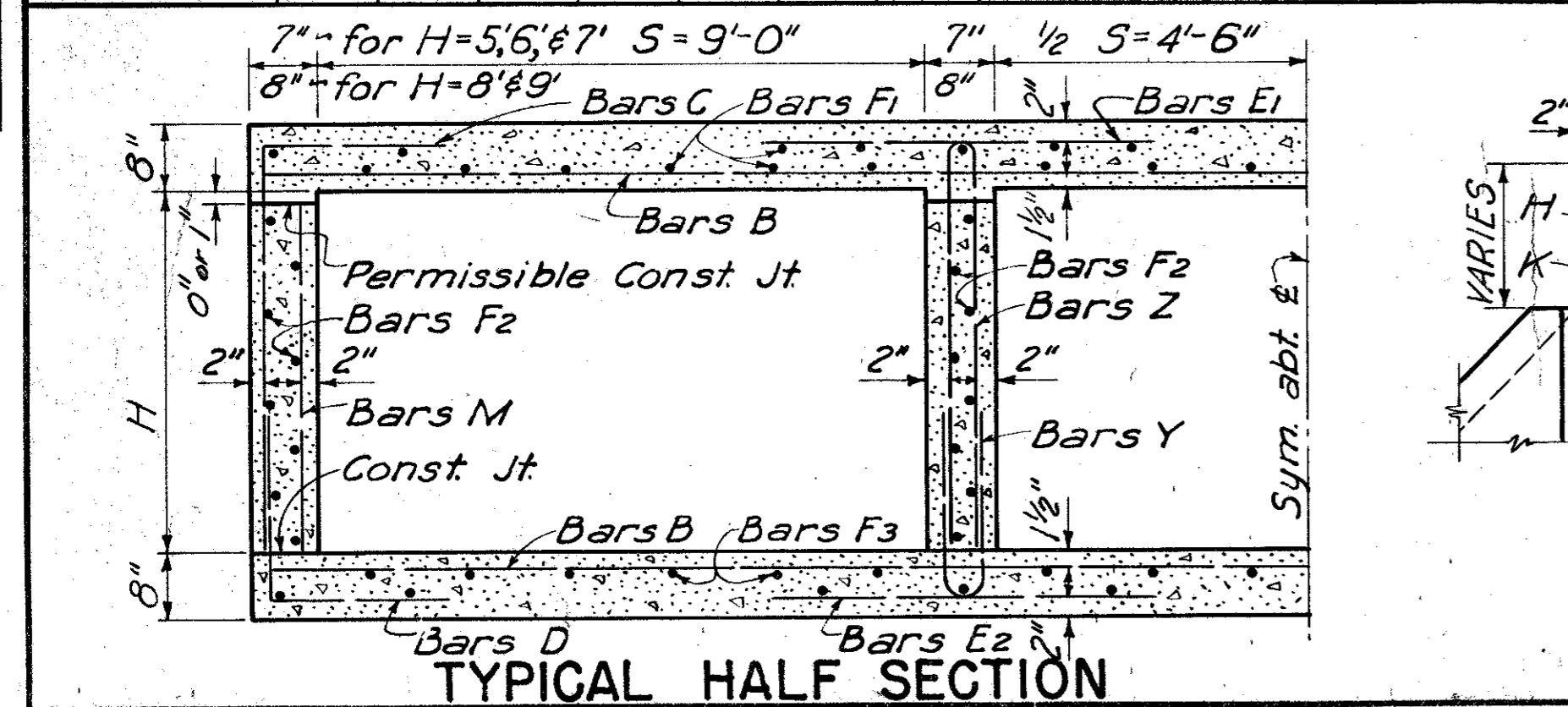

* These quantities do not include toe walls or wings.

TEXAS HIGHWAY DEPARTMENT MULTIPLE BOX CULVERTS SIZES 9'x5', 9'x6', 9'x7', 9'x8', & 9'x9' 2'-1\"/>

Table with columns: Dwg. No., M.D.A., Drawing, Date, Per. Road, State, Federal Aid Project No., Sheet No. Includes details for drawing M.D.A., Date JAN 1958, State TEXAS, and Sheet No. MC9-2.