

3 WATER METER PIT DETAIL  
NO SCALE

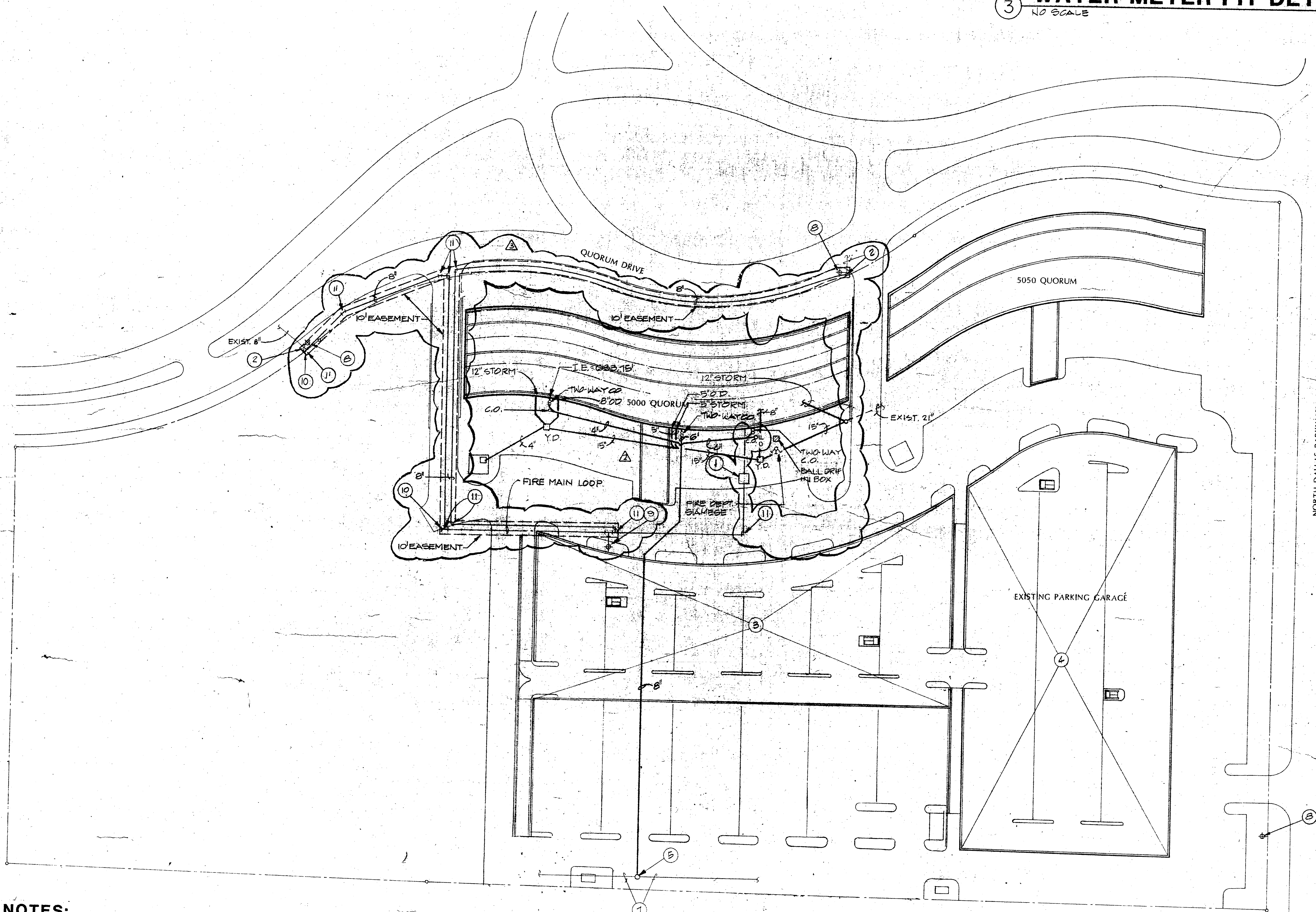

**NOTES:**

- 1 6" F.M. COMPOUND (FIRE & DOMESTIC COLD WATER) METER WITH 6" BY PASS IN CONC. PIT - PER CITY OF ADDISON STANDARDS.
- 2 EXIST. 8" C.W. W/8" C.W. TAP. VERIFY EXACT LOCATION. CONN NEW 8" C.W. AS SHOWN.
- 3 FOR NEW PARKING GARAGE FIRE PROTECTION REF: SHEETS B/S.2-1 & B/S.2-2.
- 4 FOR EXISTING PARKING GARAGE, CONTRACTOR SHALL PROVIDE A DRY STANDPIPE SYSTEM. THE SYSTEM SHALL CONSIST OF (2) SIAMOSE CONNECTIONS AND (3) 2 1/2" FIRE DEPT. VALVES ON EACH LEVEL. LOCATE (1) SIAMOSE CONNECTION AT QUORUM DRIVE ENTRANCE AND (1) AT DALLAS PARKWAY ENTRANCE WITHIN THE CONFINES OF THE EXISTING PARKING GARAGE. LOCATE (1) 2 1/2" FIRE DEPT. VALVE IN BOTH SYSTEMS AT EACH LEVEL. THE THIRD VALVE SHALL BE LOCATED WHERE THE REMAINING AREA SHALL BE COVERED WITH 100' OF HOSE AND 30' OF SPRAY.
- 5 EXIST. SANITARY SEWER MANHOLE I.E. = 623.89'. CONNECT NEW 8" SANITARY INTO EXIST. 9" TAP AT I.E. = 628.42'.
- 6 FOR STORM SEWER REF: A/S.2-1
- 7 EXIST. 12" SANITARY SEWER.
- 8 EXIST. FIRE HYDRANT
- 9 NEW 6" FIRE HYDRANT W/VALVE.
- 10 NEW 8" TAP GAPPED FOR FUTURE USE.
- 11 PROVIDE THRUST BLOCK AS SHOWN.

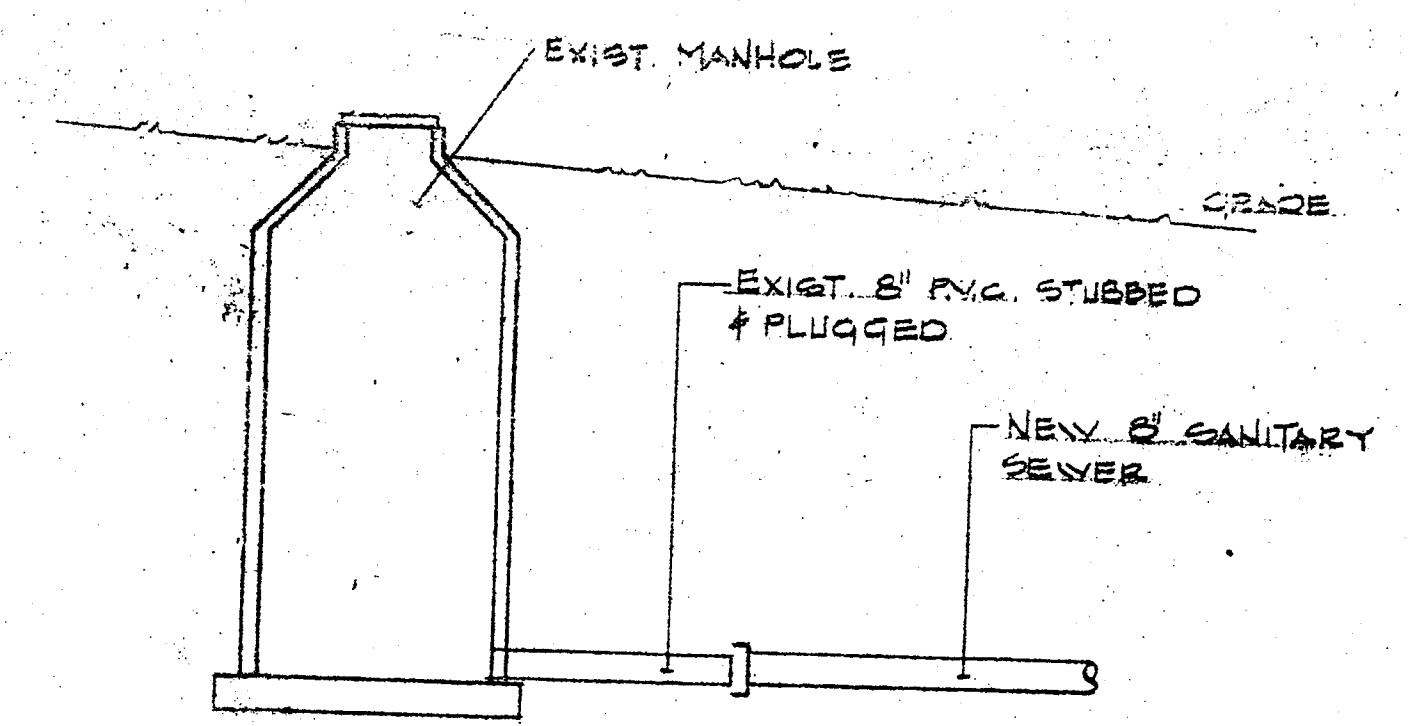

2 SANITARY SEWER CONNECTION  
NO SCALE

**SITE UTILITIES - MECHANICAL**

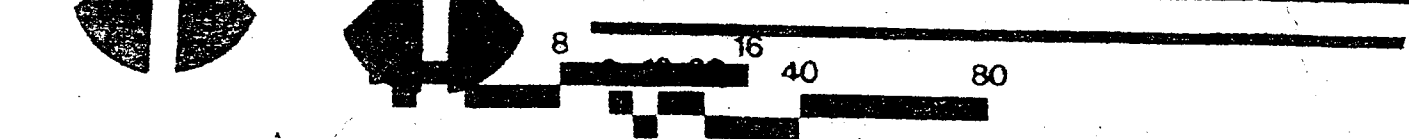

Quorum Partners  
Owner

Hellmuth, Obata & Kassabaum, Inc. Architect  
Ellisor & Tanner, Inc. Structural Engineers  
Purdy-McGuire, Inc. Mech./Elec. Engineers

**QUORUM OFFICE BUILDING #2**

Revisions	SB	T	Job Number	Detail
12-28-88			3113-001	
	M-2			Category
				<b>5.1-2</b>