

ALLEY WIDTH (A)	HALF SECTION WIDTH (L)	INVERT DEPTH (d)
10'	5'	5"
12'	6'	6"
16'	8'	6"
20'	10'	6"

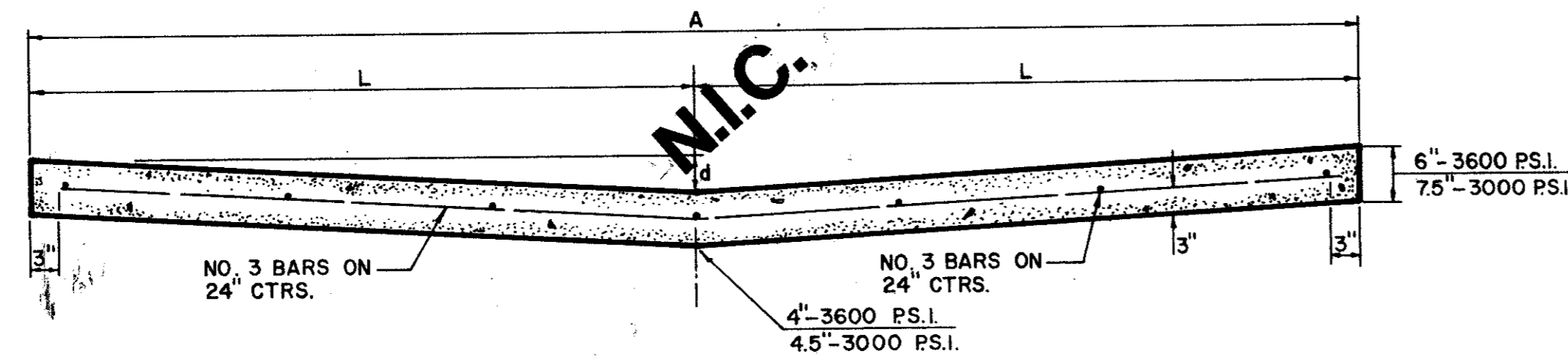

STANDARD 10', 12', 16', & 20' ALLEY SECTION

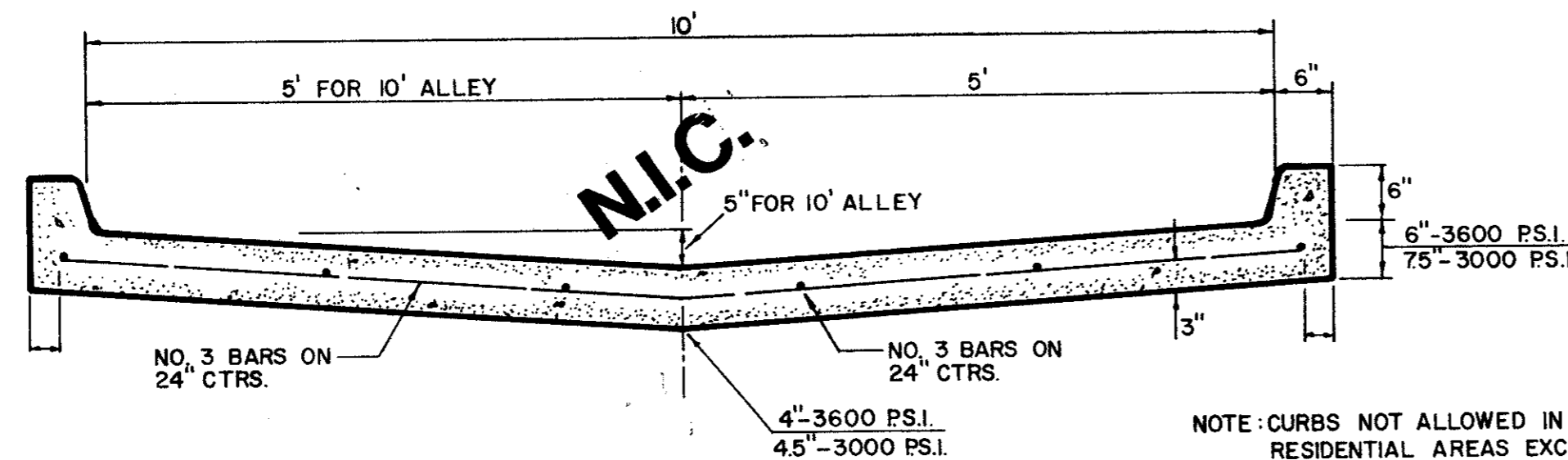

STANDARD ALLEY SECTION WITH CURBS

NOTE: CURBS NOT ALLOWED IN RESIDENTIAL AREAS EXCEPT AS APPROVED BY THE ENGINEER.

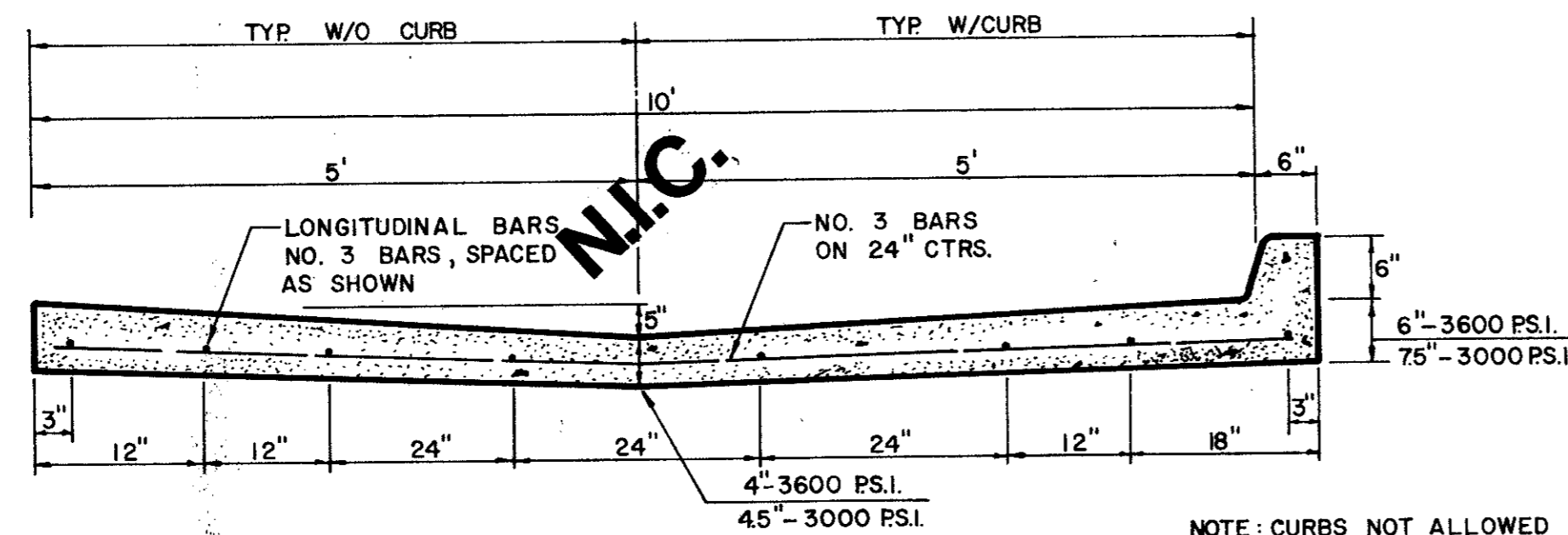

ALTERNATE 10' ALLEY SECTION / CURB

NOTE: CURBS NOT ALLOWED IN RESIDENTIAL AREAS EXCEPT AS APPROVED BY THE ENGINEER

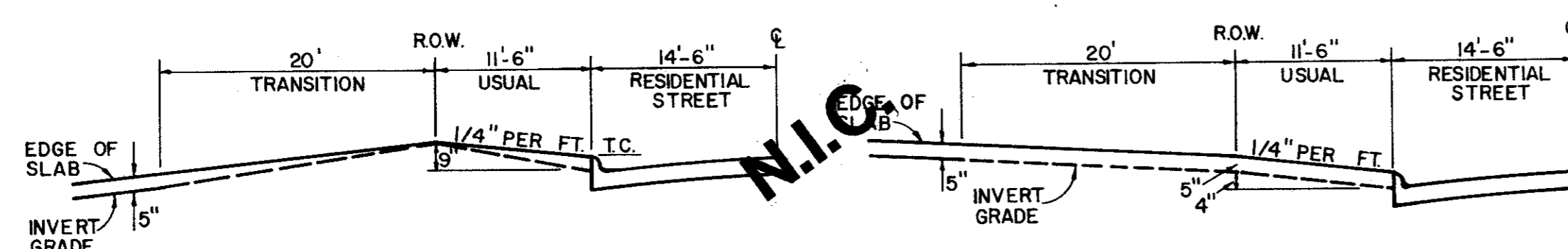

TYPE I ALLEY ENTRANCE

TYPE II ALLEY ENTRANCE

ALLEY WIDTH	A	B	C	D	E	F
10'	10'	2'-6"	15'	1'-6"	12'	8.6'
12'	12'	1'-6"	15'	1'-6"	12'	8.5'
16'	16'	2'-0"	20'	2'-0"	16'	8.0'
20'	20'	0	20'	0	20'	10.0'

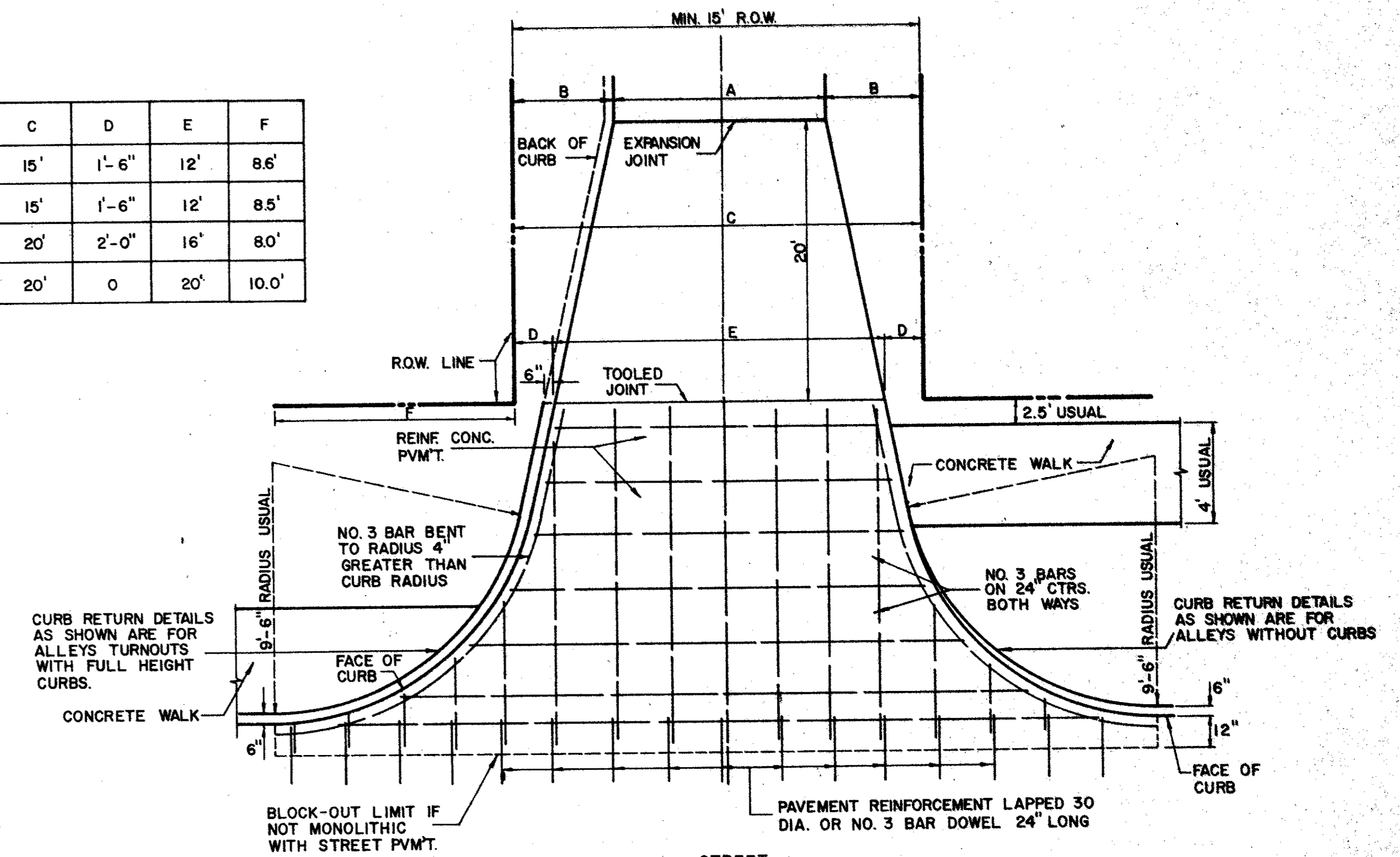

ALLEY RETURN DETAILS

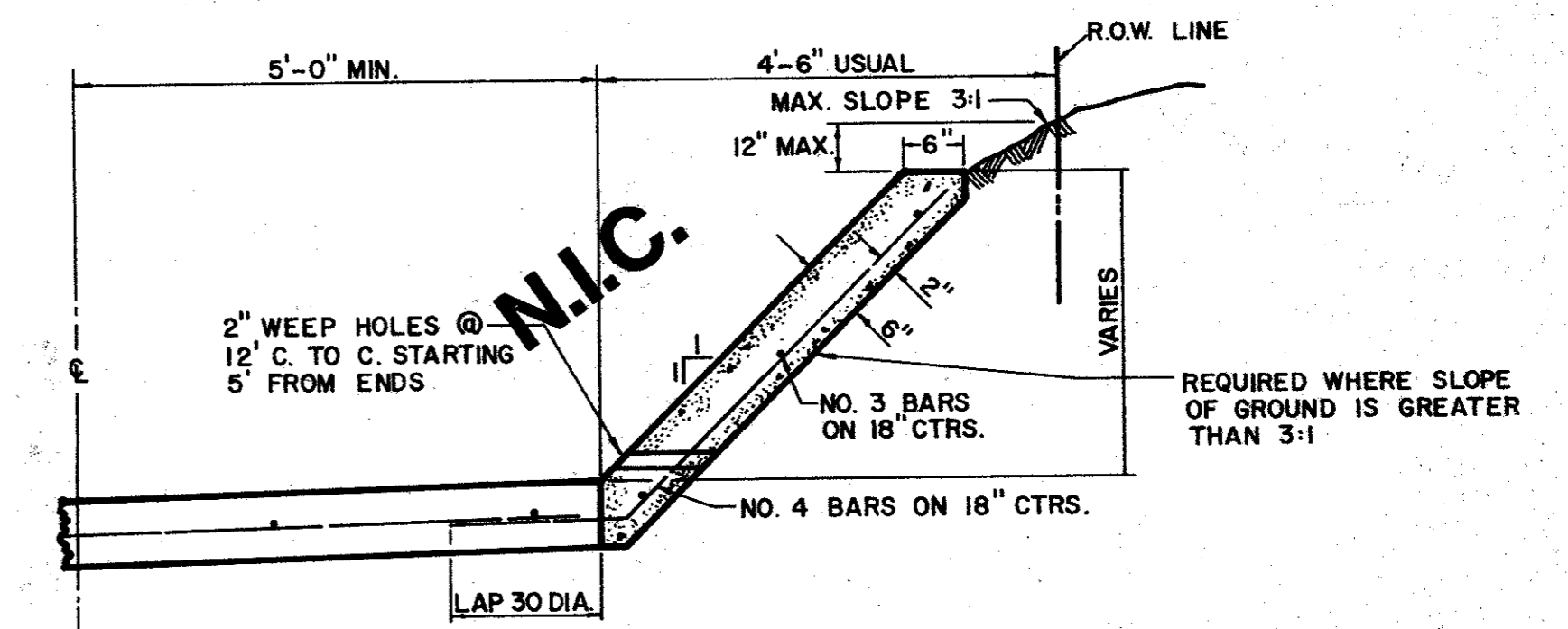

ALLEY SLOPE PROTECTION

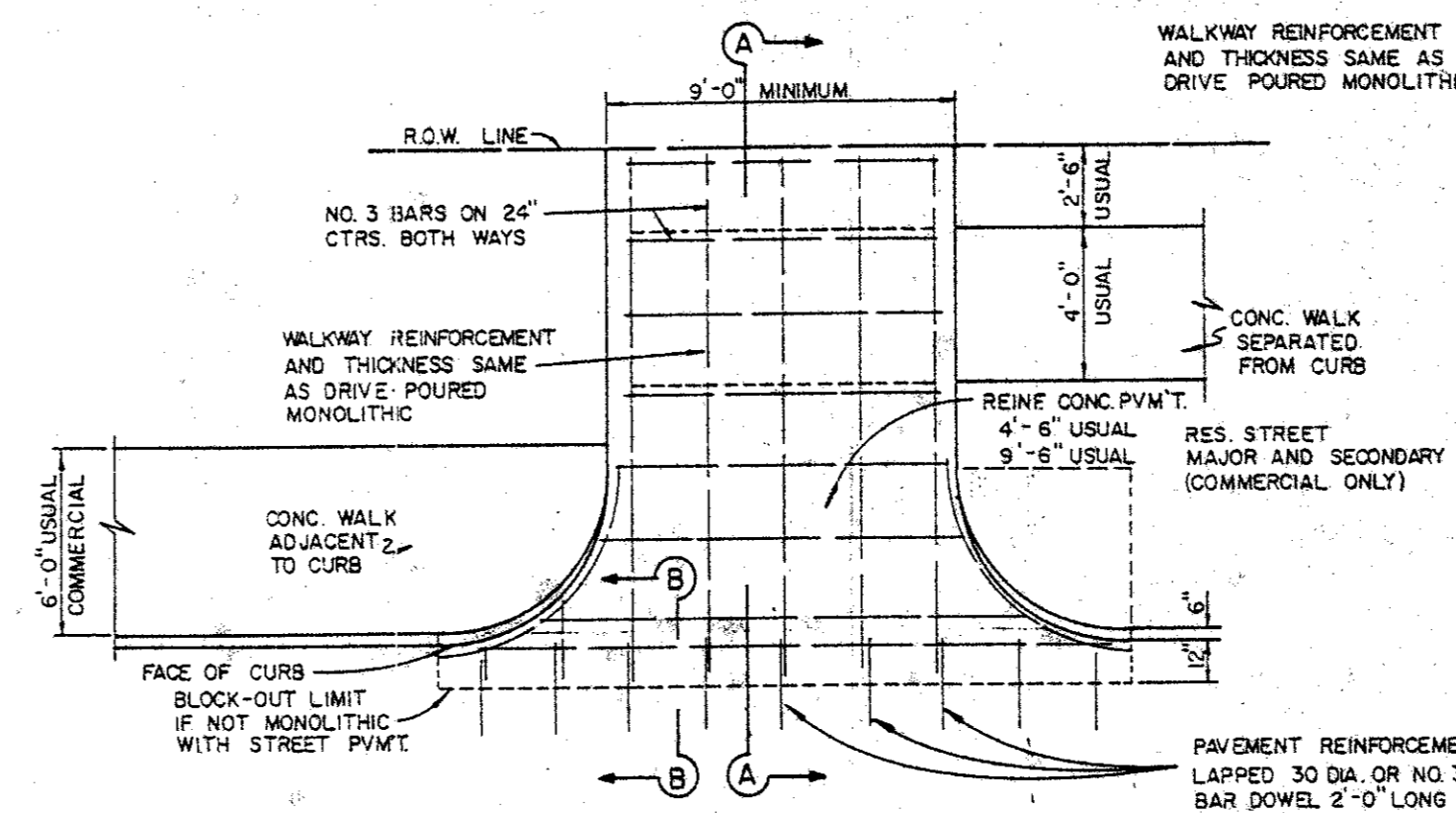

DRIVEWAY RETURN TO STREET

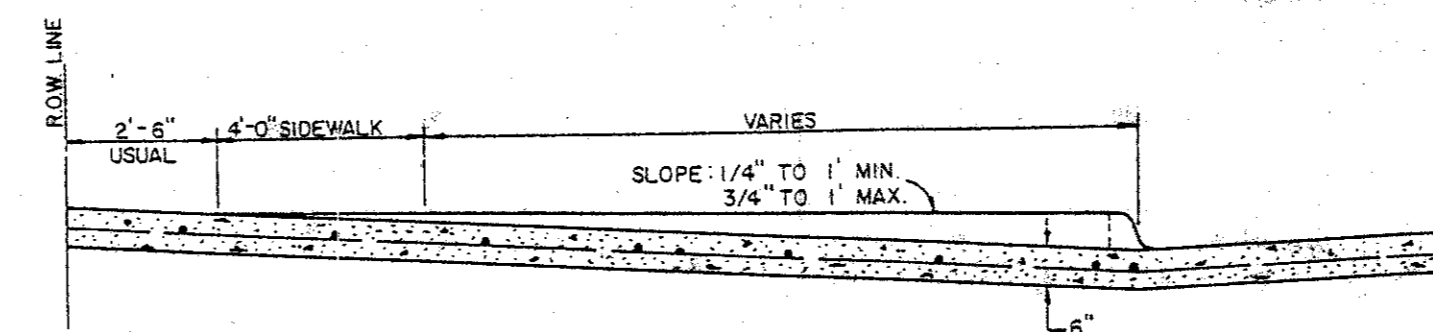

SECTION A-A

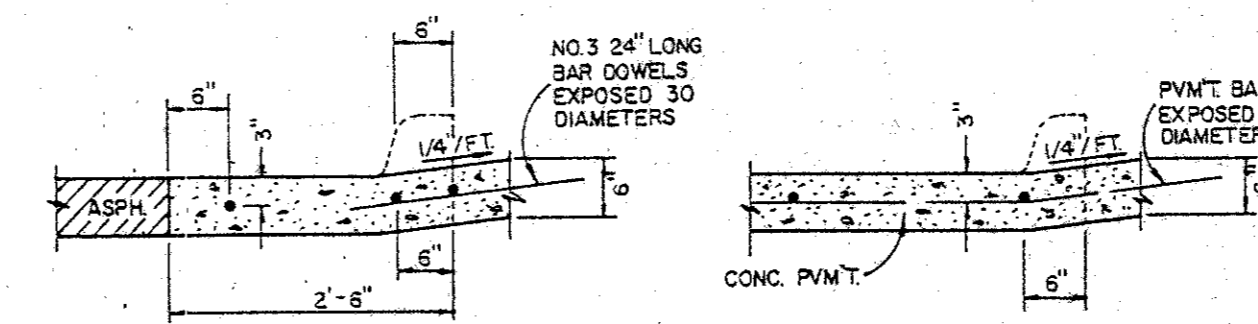

SECTION B-B

DRIVEWAY RETURN DETAILS

GENERAL NOTES FOR ALLEYS AND DRIVEWAYS

1. CONCRETE FOR ALLEY RETURNS AND DRIVEWAYS SHALL HAVE A MINIMUM COMPRESSIVE STRENGTH AT 28 DAYS IDENTICAL TO THAT SPECIFIED FOR THE STREET PAVEMENT OR BASE WHEN BUILT AS COMPONENTS OF A CONCRETE PAVING PROJECT WHEN BUILT SEPARATELY, THE STRENGTH SHALL BE AS SPECIFIED ON THE CONSTRUCTION PLANS.
2. CONCRETE FOR ALLEY PAVEMENT SHALL BE OF THE STRENGTH SPECIFIED ON THE CONSTRUCTION PLANS. (3000 PSI. OR 3600 PSI. MINIMUM COMPRESSIVE)
3. SPACING AND CONSTRUCTION OF JOINTS SHALL CONFORM TO STREET PAVEMENT DETAILS.

No.	Revision	By	Date
STANDARD CONSTRUCTION DETAILS PAVING			
ALLEY & DRIVEWAY RETURNS			
GINN, INC.			
Consulting Engineers Dallas, Texas			
Designed -	Drawn -	Date - June, 1990	Job No. - 90439
Approved -	Checked -	Scale -	Sheet M6 of

SD4