

STA. 35+00
MATCH LINE

STATIONING
35+00
35+20
36+00
37+00
38+00
39+00
40+00

Parkway
Business Center I

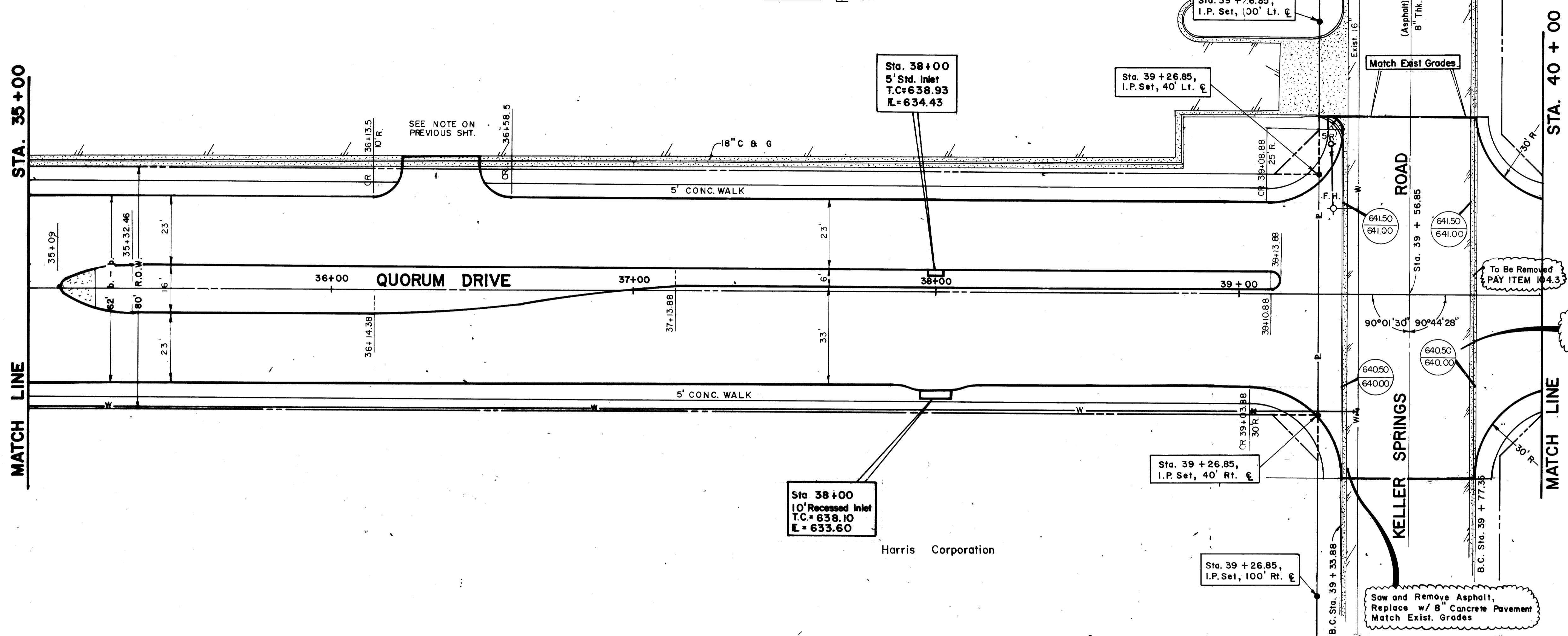
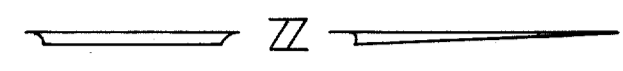

Sta 38+00
10' Recessed Inlet
T.C. = 638.10
E. = 633.60

Harris Corporation

Sta. 39 + 26.85,
I.P. Set, 40' Lt. ϕ

Sta. 39 + 26.85,
I.P. Set, 100' Rt. ϕ

Sta. 39 + 26.85,
I.P. Set, 40' Rt. ϕ

Sta. 39 + 26.85,
I.P. Set, 100' Rt. ϕ

Saw and Remove Asphalt,
Replace w/ 8" Concrete Pavement
Match Exist. Grades

To Be Removed
PAY ITEM 104.3

Saw and Remove Asphalt,
Replace w/ 8" Concrete Pvm't.
Match Exist. Grades

B.M. #2 - 2 Keller Springs Road Survey
On Top Curb Center Radius Island
at Sta. 14 + 60 + and Right 40'
Elevation 638.94'

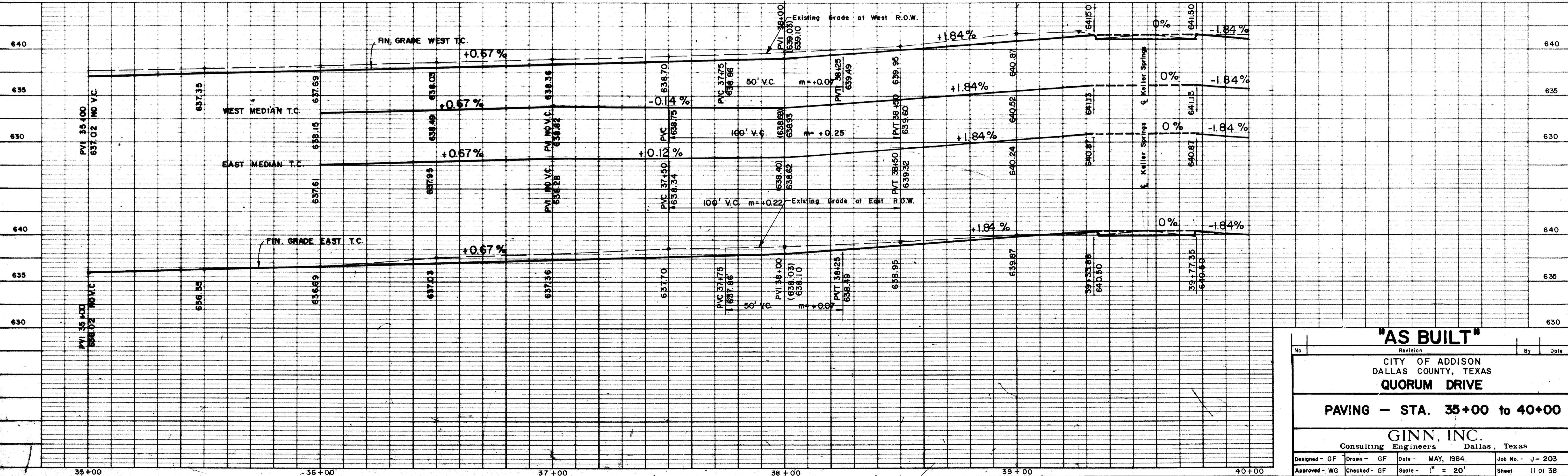

"AS BUILT"

No.	Revision	By	Date
CITY OF ADDISON DALLAS COUNTY, TEXAS QUORUM DRIVE			
PAVING - STA. 35+00 to 40+00			
GINN, INC. Consulting Engineers Dallas, Texas			
Designed - GF	Drawn - GF	Date - MAY, 1984	Job No. - J-203
Approved - WG	Checked - GF	Scale - 1" = 20'	Sheet 11 of 38