

Curve Data:
 $\Delta = 18^\circ 40' 18''$
 $R = 420.00'$
 $T = 69.05'$
 $L = 136.87'$
 $D = 13^\circ 38' 31''$

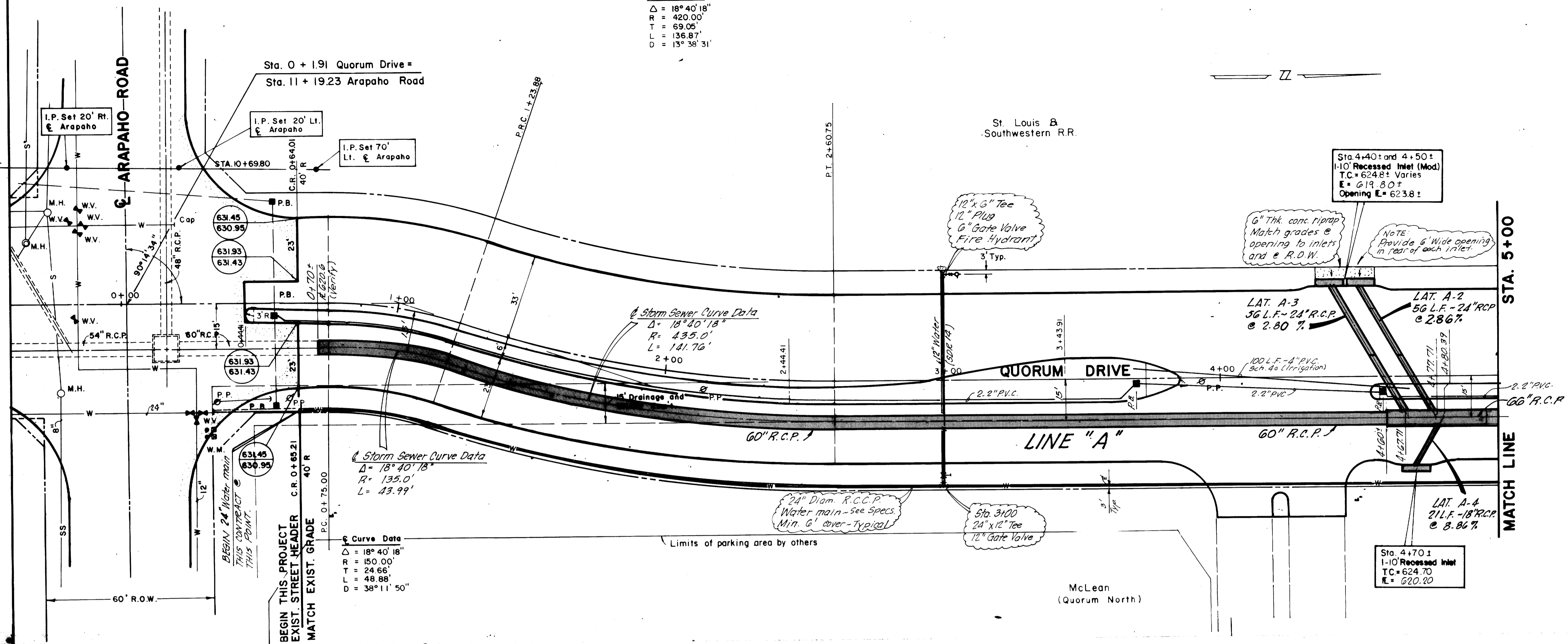

B.M. - "□" On Southeast Corner Sidewalk at Front Entrance to 4805 Quorum Drive Elevation 630.66'
 B.M. - "□" On Southeast Corner Sidewalk at South Entrance to 4805 Quorum Drive Elevation 630.54'

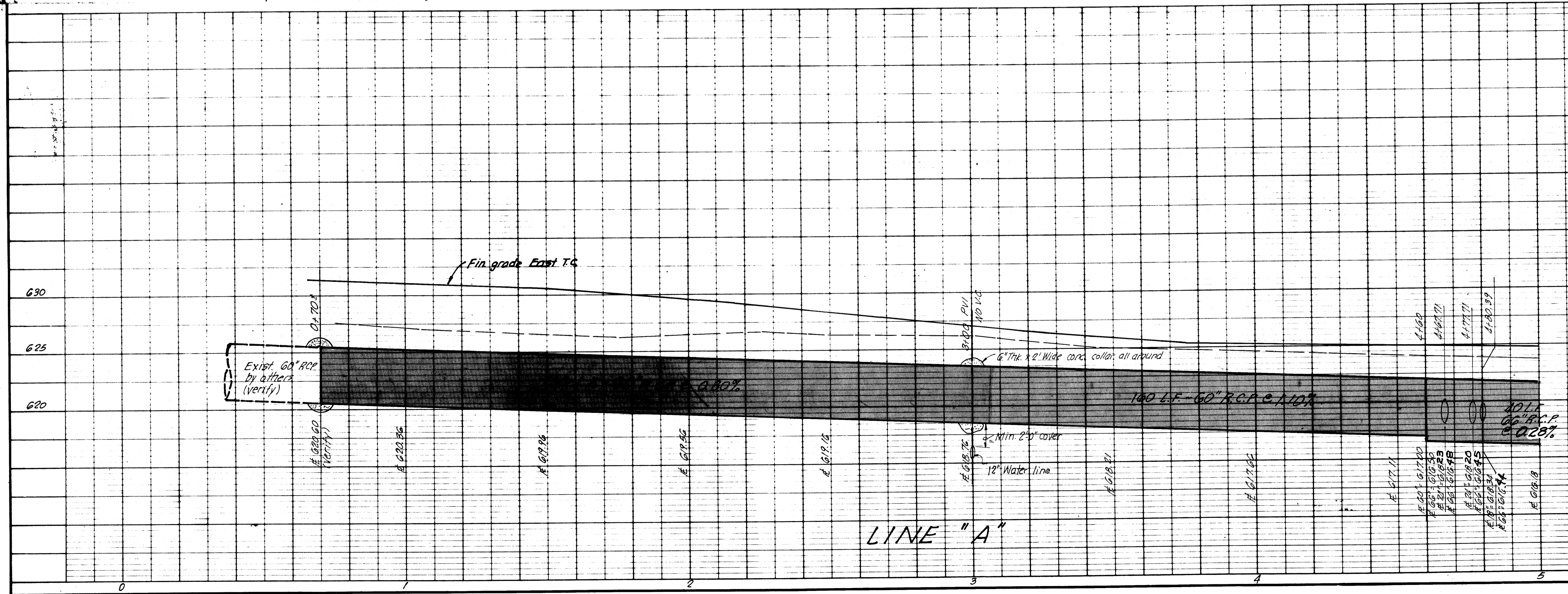

"AS BUILT"			
No.	Revision	By	Date
CITY OF ADDISON DALLAS COUNTY, TEXAS QUORUM DRIVE			
DRAINAGE - STA. 0+00 to 5+00			
GINN, INC. Consulting Engineers Dallas, Texas			
Designed - G.E.	Drawn - G.F.-RB	Date - MAY, 1984	Job No. - J - 203
Approved - HWG	Checked - HBJ	Scale - 1" = 20'	Sheet 17 of 38