

NOTE: Contours shown taken from base maps compiled from aerial photographs and are provided to indicate general direction of existing drainage.

Spot elevations shown as 626.84 are taken from actual field cross sections. The location of the spot elevation is approximate and may be field adjusted as conditions dictate at time of const.

NOTE: Pay Item 100 - Prepare R.O.W., not a separate pay item for work indicated on this sheet, but shall be incidental to the various items to be constructed this sheet, only if the item is incurred.

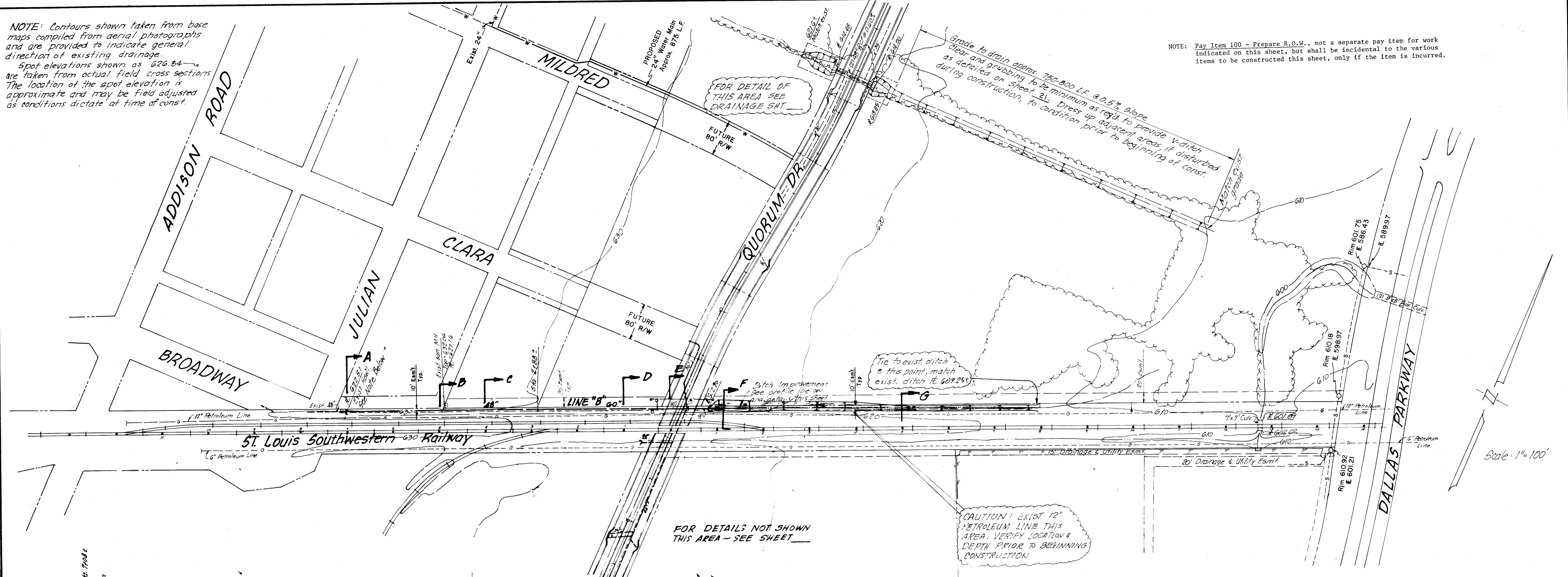

Scale: 1"=100'

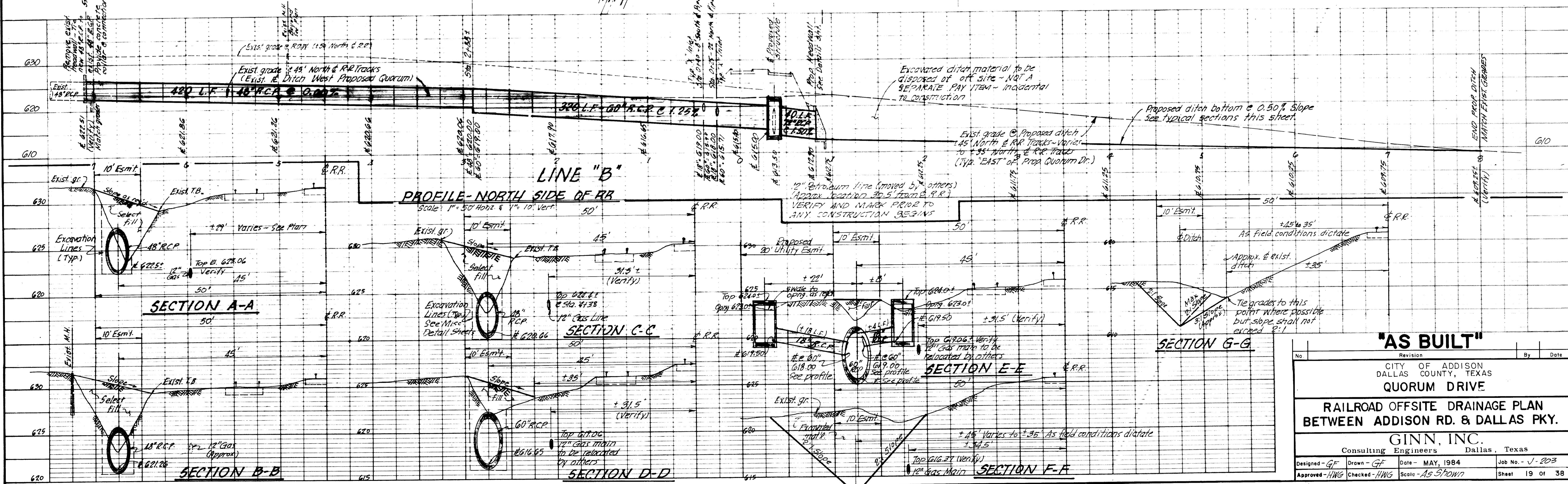

"AS BUILT"		Revision	By	Date
		CITY OF ADDISON DALLAS COUNTY, TEXAS QUORUM DRIVE		
RAILROAD OFFSITE DRAINAGE PLAN BETWEEN ADDISON RD. & DALLAS PKY.				
GINN, INC. Consulting Engineers Dallas, Texas				
Designed - GF	Drawn - GF	Date - MAY, 1984	Job No. - J-203	
Approved - HWG	Checked - HWG	Scale - AS SHOWN	Sheet 19 of 38	