

Curve Data:  
 $\Delta = 18^\circ 40' 18''$   
 $R = 420.00'$   
 $L = 69.05'$   
 $T = 136.37'$   
 $D = 13^\circ 36' 31''$

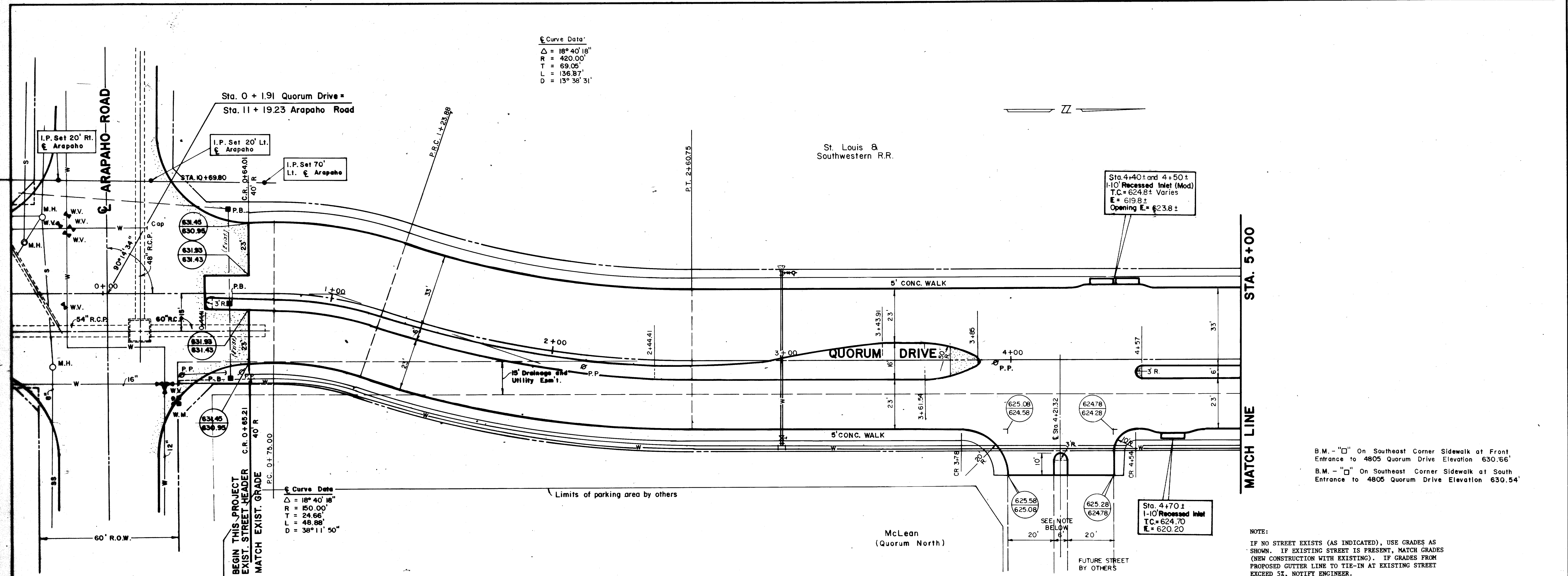

BEGIN THIS PROJECT  
 EXIST. STREET HEADER  
 MATCH EXIST. GRADE

Curve Data:  
 $\Delta = 18^\circ 40' 18''$   
 $R = 150.00'$   
 $L = 24.66'$   
 $T = 48.88'$   
 $D = 38^\circ 11' 50''$

B.M. - "□" On Southeast Corner Sidewalk at Front Entrance to 4805 Quorum Drive Elevation 630.66'  
 B.M. - "□" On Southeast Corner Sidewalk at South Entrance to 4805 Quorum Drive Elevation 630.54'

NOTE:  
 IF NO STREET EXISTS (AS INDICATED), USE GRADES AS SHOWN. IF EXISTING STREET IS PRESENT, MATCH GRADES (NEW CONSTRUCTION WITH EXISTING). IF GRADES FROM PROPOSED GUTTER LINE TO TIE-IN AT EXISTING STREET EXCEED 5%, NOTIFY ENGINEER.

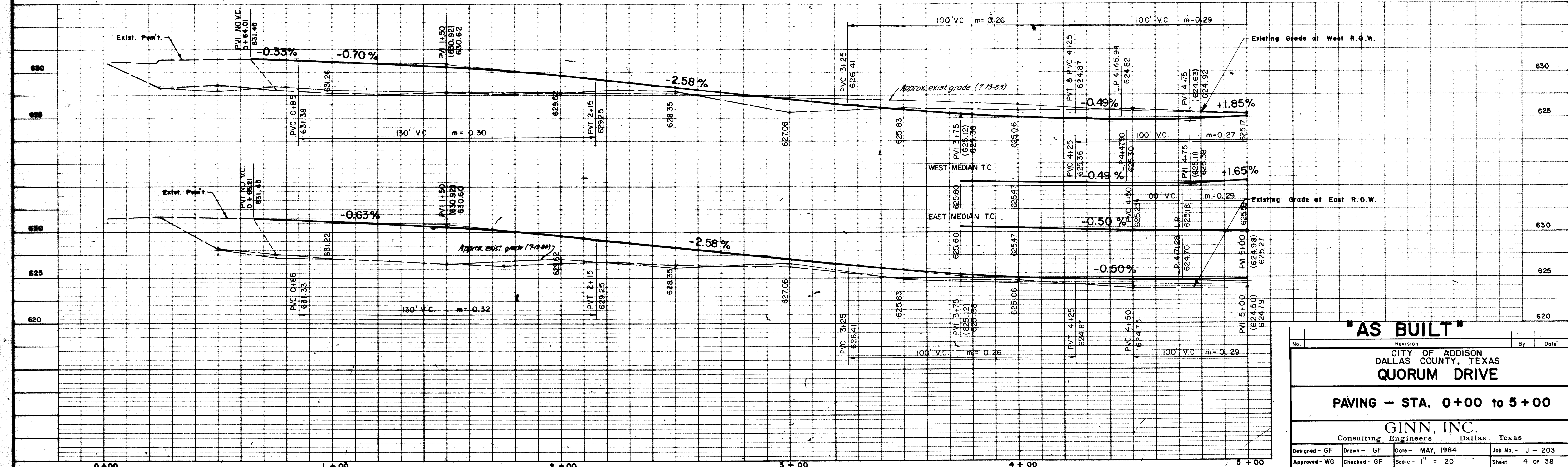

**"AS BUILT"**

No.	Revision	By	Date
CITY OF ADDISON DALLAS COUNTY, TEXAS <b>QUORUM DRIVE</b>			
<b>PAVING - STA. 0+00 to 5+00</b>			
GINN, INC. Consulting Engineers Dallas, Texas			
Designed - GF	Drawn - GF	Date - MAY, 1984	Job No. - J - 203
Approved - WG	Checked - GF	Scale - 1" = 20'	Sheet 4 of 38