

NOTE: Proposed 24" water main along Mildred St.
The Town of Addison has not secured right-of-way at the time of bidding to construct the 24" water main. It is the intention of the Town to construct the approximate 875 LF within the time frame of this project. At such time, the right-of-way is secured, a final layout will be made to determine the exact location of main. For bidding purposes, a pay item has been established for construction of this item in accordance with these plans and specifications.

Approx. 875 L.F. - 24" R.C.C.P. Water Main - To Connect to Existing 24" Main at Julian St. (See Note at Right) (See Sht. 19 for Continuation)

Curve Data
 $\Delta = 6^{\circ}05'10''$
 $R = 1432.39'$
 $L = 152.15'$
 $D = 4^{\circ}00'00''$

Sta. 13+79.17,
I.P. Set, 100' Lt. ξ

Stim Swr Curve Data
 $d = 6^{\circ}05'10''$
 $R = 1414.55'$
 $L = 150.56'$

DATA (Stm. Swr.)
 $d = 6^{\circ}05'10''$
 $R = 1417.99'$
 $L = 150.56'$

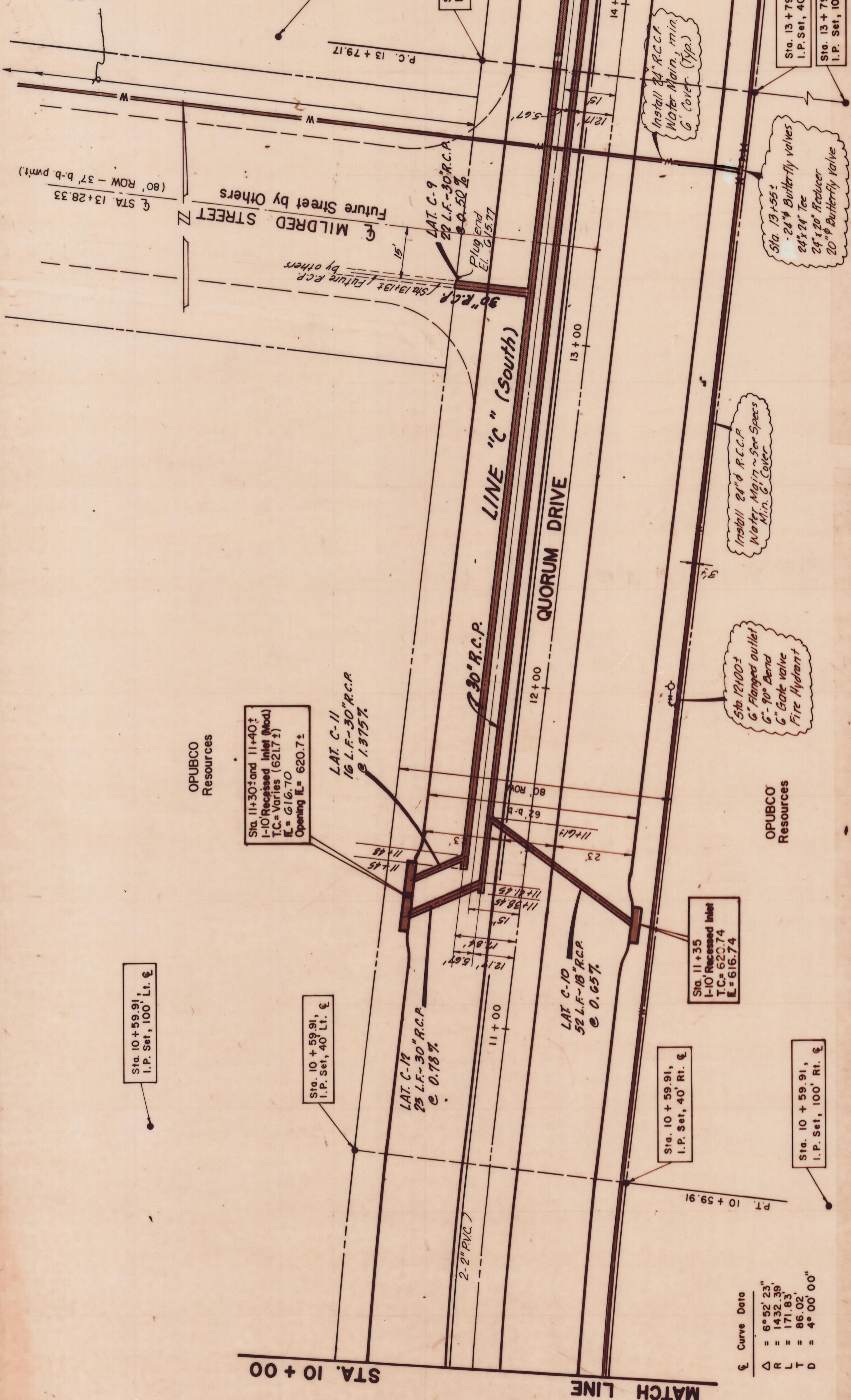

Curve Data
 $\Delta = 6^{\circ}52'23''$
 $R = 1432.39'$
 $L = 171.85'$
 $D = 4^{\circ}00'00''$

Fin grade next I.C.
Elevations: 616.54, 616.53, 616.52, 616.50 (Beyond), 616.48, 616.43, 616.40, 616.30, 616.23



625					
620					
615					
"AS BUILT"					
No.	Revision	By	Date		
CITY OF ADDISON DALLAS COUNTY, TEXAS QUORUM DRIVE.					
DRAINAGE - STA. 10+00 to 15+00					
GINN, INC. Consulting Engineers, Dallas, Texas					
Designed - G.F. Brown - G.F. RB	Drawn - G.F. RB	Checked - HBJ	Scale - 1" = 20'	Job No. - J - 205	Sheet 20 of 38
Approved - HWG					