

Curve Data
 $\Delta = 60^\circ 40' 48''$
 $T = 248.75'$
 $R = 425.00'$
 $L = 450.10'$

Straight Curve Data
 $\Delta = 55^\circ 02' 45''$
 $R = 400.0'$
 $L = 384.29'$
 $T = 208.43'$
 $D = 14^\circ 19' 26''$

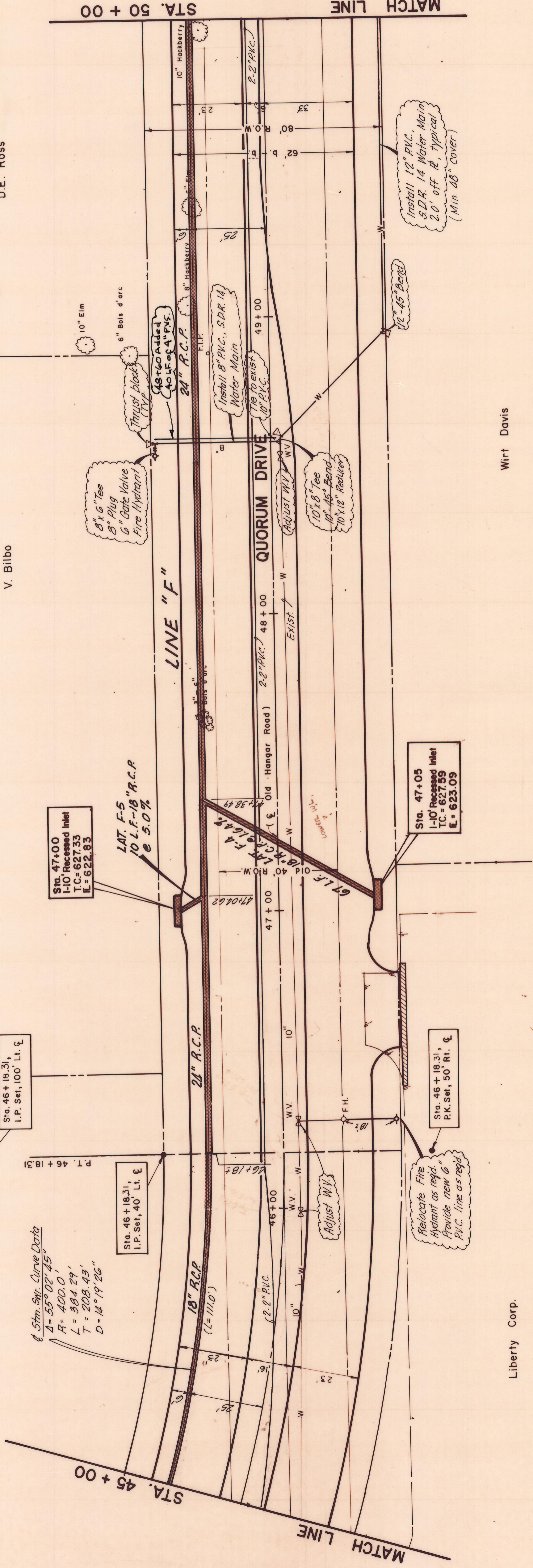

Liberty Corp.

Wirt Davis

B.M. "D" On Northmost N.W. Corner United Fidelity Life Ins. Parking Lot - Sta. 46 + 91.50, 39.5 Ft. ϵ Elevation 627.98

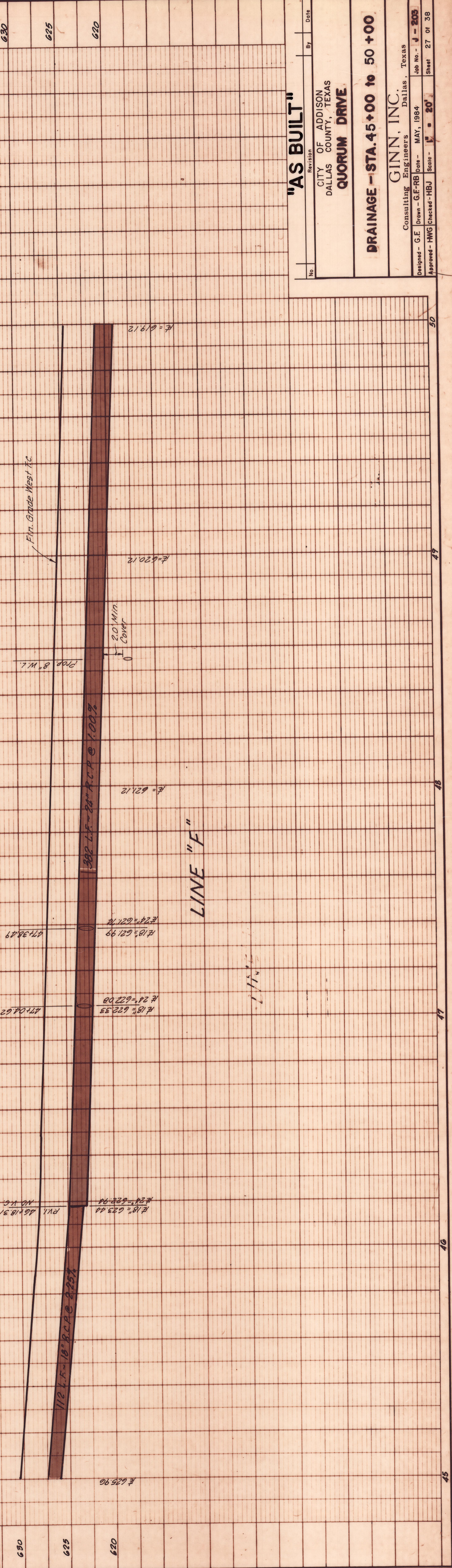

"AS BUILT"

No.	Revision	By	Date

CITY OF ADDISON
DALLAS COUNTY, TEXAS
QUORUM DRIVE

DRAINAGE - STA. 45+00 to 50+00

GINN, INC.
Consulting Engineers Dallas, Texas
Designed - G.E. Dren - G.F.-RB Date - MAY, 1984 Job No. - J - 205
Approved - HWG Checked - HBJ Scale - 1" = 20' Sheet 27 of 38