

GOODMAN AVENUE

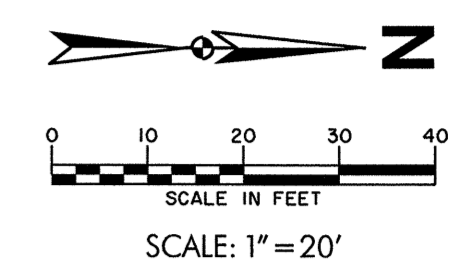
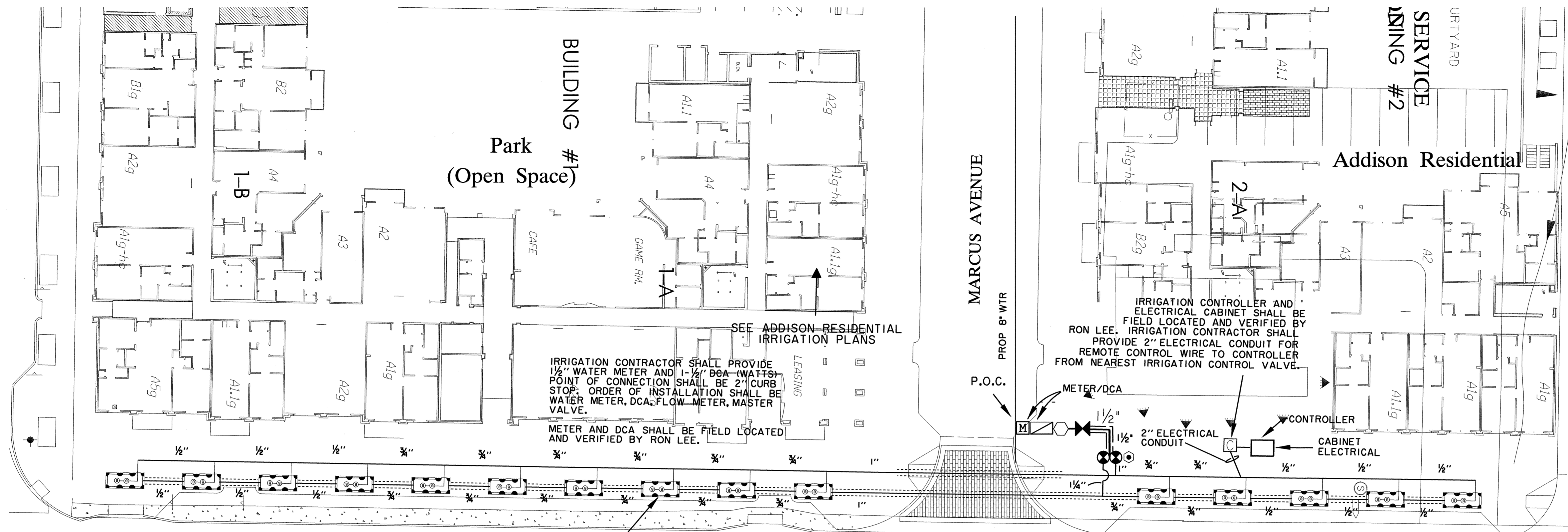

CAUTION:
EXIST. GAS LINES
IN THE AREA.
LOCATE BEFORE DIGGING.

PHONE SERVICE TO CONTROLLER WILL BE FROM EXISTING SERVICE ON QUORUM DRIVE. CONTACT TOBY PARKER WITH SBC 972-234-7037

NOTE:
ALL IRRIGATION LINES SHALL BE LOCATED IN SLEEVES OR PLANTERS IRRIGATION LINES NOT SHOWN IN SLEEVES OR PLANTERS ARE DIAGRAMMATIC AND DO NOT REPRESENT THE ABSOLUTE LOCATIONS.

IRRIGATION CONTRACTOR SHALL PROVIDE 1/2" WATER METER AND 1-1/2" DCA (WATTS) STOP. ORDER OF INSTALLATION SHALL BE WATER METER, DCA, FLOW METER, MASTER VALVE.
METER AND DCA SHALL BE FIELD LOCATED AND VERIFIED BY RON LEE.

IRRIGATION CONTROLLER AND ELECTRICAL CABINET SHALL BE FIELD LOCATED AND VERIFIED BY RON LEE. IRRIGATION CONTRACTOR SHALL PROVIDE 2" ELECTRICAL CONDUIT FOR REMOTE CONTROL WIRE TO CONTROLLER FROM NEAREST IRRIGATION CONTROL VALVE.

SEE 5'x12' TREE PIT IRRIGATION DIAGRAM (THIS SHEET) TYP.



QUORUM DRIVE

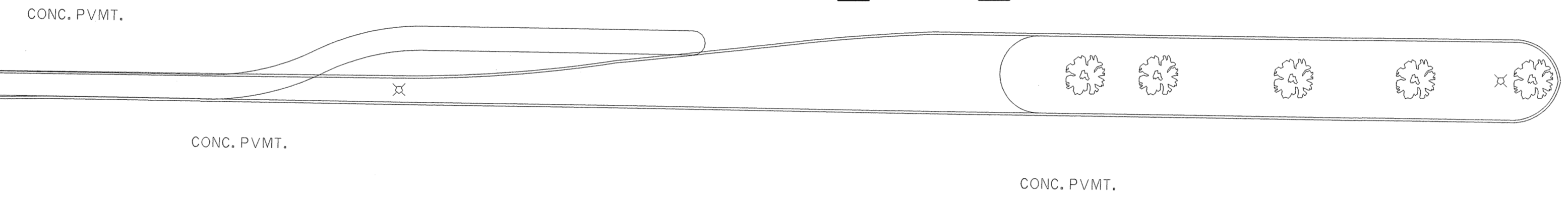

NOTE:
ALL IRRIGATION LINES SHALL BE LOCATED IN SLEEVES OR PLANTERS IRRIGATION LINES NOT SHOWN IN SLEEVES OR PLANTERS ARE DIAGRAMMATIC AND DO NOT REPRESENT THE ABSOLUTE LOCATIONS.

BENCHMARKS:

BM#5
"□" CUT ON 8' INLET ON NORTH CURB LINE OF GOODMAN AVE. +75' EAST OF PASCHAL PLACE. ELEV. 629.98

BM#6
"□" CUT AT C & OF 8' INLET AT THE SOUTHWEST CORNER OF MORRIS AVE. AND WITT PLACE. ELEV. 627.29

BM#7
"□" CUT AT WEST CORNER OF ADDISON THEATRE CENTRE PARKING LOT, SECOND ENTRANCE NORTH OF ADDISON RD. ELEV. 637.66

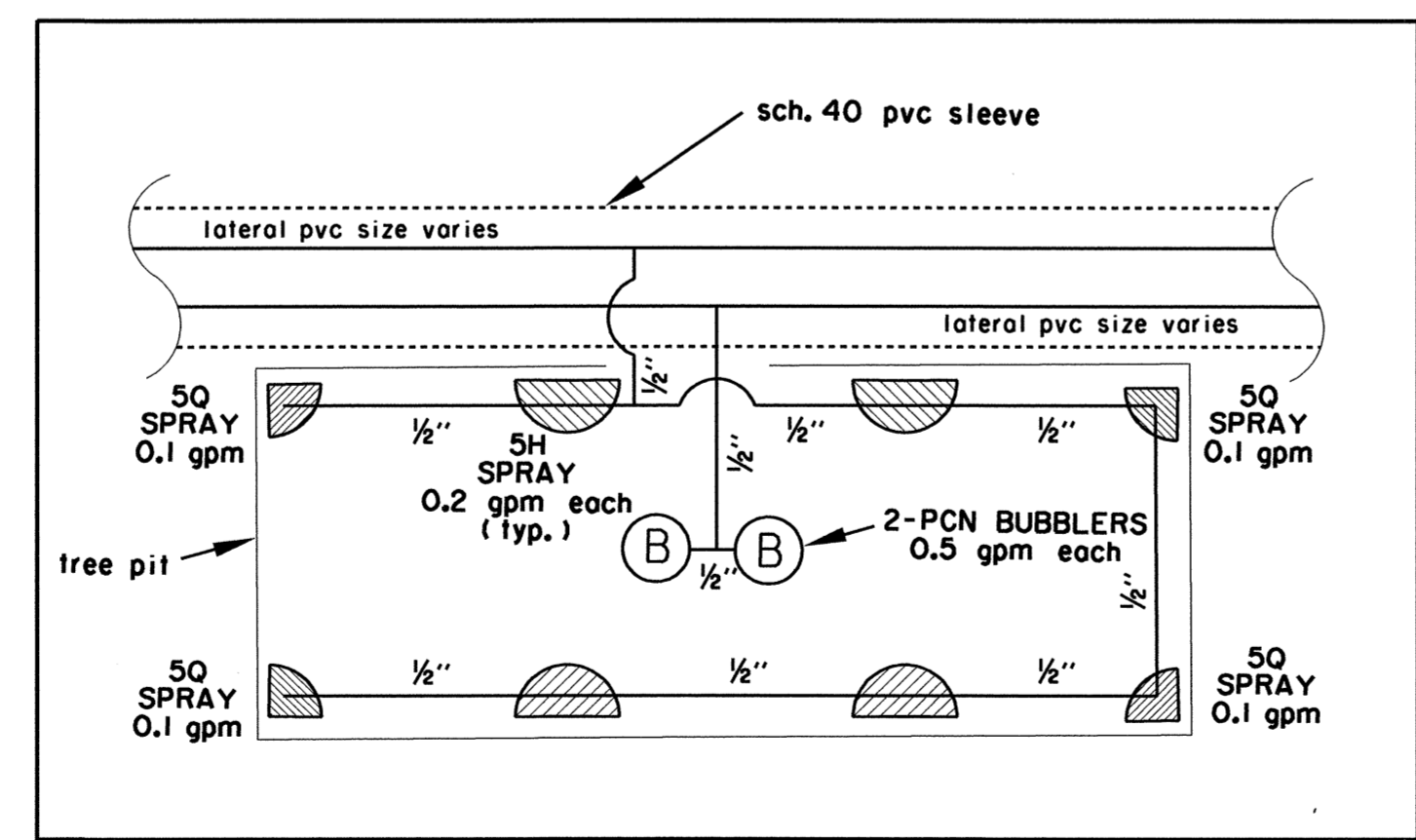

5'x12' TREE PIT DIAGRAM
nts



RECORD DRAWING

THIS DRAWING HAS BEEN MODIFIED FROM THE ORIGINAL TO SHOW ONLY THE FIELD CHANGES AND ADJUSTMENTS MADE DURING CONSTRUCTION BY THE CONTRACTOR WHICH WERE DOCUMENTED AND FURNISHED TO THE ENGINEER FOR THE PURPOSE OF PREPARING THESE RECORD DRAWINGS. FIELD INSPECTION OF CONSTRUCTION WAS PERFORMED BY OTHERS. TO THE BEST OF OUR KNOWLEDGE AND UNDERSTANDING THESE RECORD DRAWINGS REPRESENT THE "AS-BUILT" CONDITIONS.

**IRRIGATION PLAN
QUORUM DRIVE**

TOWN OF ADDISON, TEXAS

Huff - Zolgers, Inc.
3131 McKinney Ave., Suite 600, Dallas, TX 75204
Phone (214) 871-3311/Fax (214) 871-0757

DESIGN	CHECKED	APPR.	SCALE	DATE	PROJECT NO.	NO.
HZI	HZI		1"=20'	01/15/09		C22

N:\proj\01340801\dgn\3408RR04.DGN
 The Jan 15 10:21:18 2009
 P:\Users\KARLSON\Documents\3408RR04.dgn
 P:\Users\KARLSON\Documents\3408RR04.dgn
 1-15-09
 89232
 K.N. CARLSON
 PROFESSIONAL ENGINEER
 STATE OF TEXAS
 1-15-09