

QUORUM NORTH

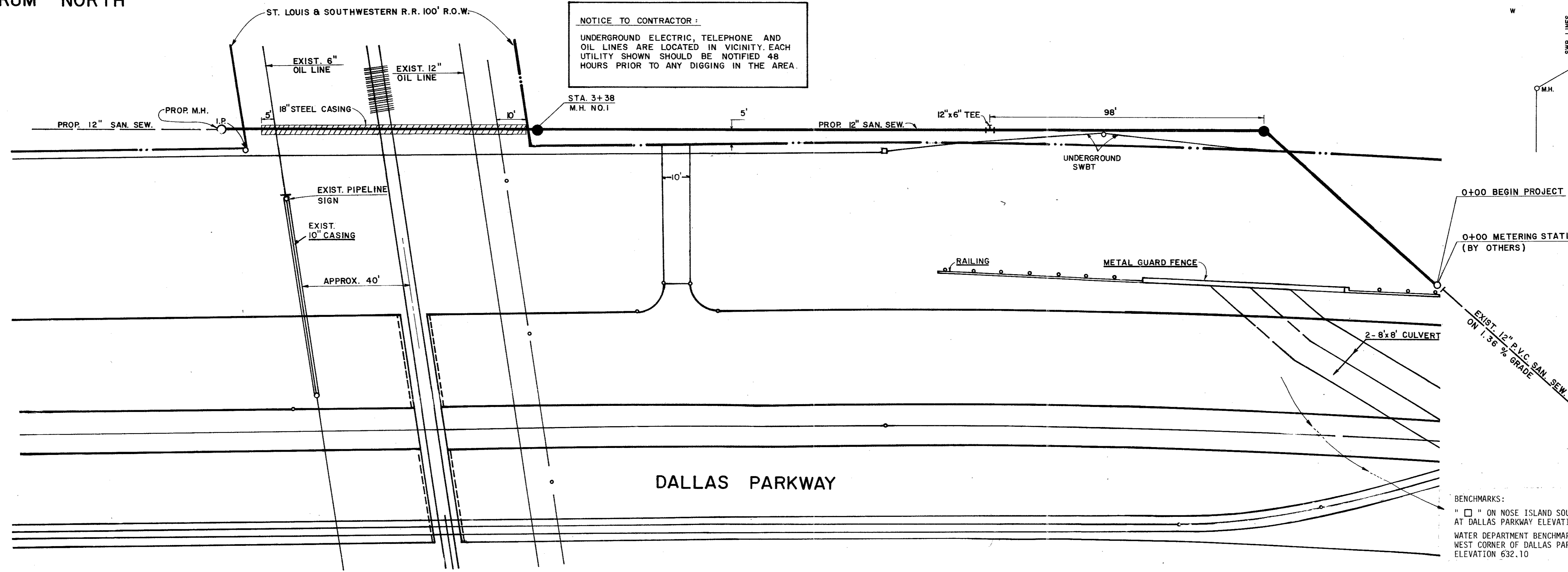

NOTICE TO CONTRACTOR:
 UNDERGROUND ELECTRIC, TELEPHONE AND OIL LINES ARE LOCATED IN VICINITY. EACH UTILITY SHOWN SHOULD BE NOTIFIED 48 HOURS PRIOR TO ANY DIGGING IN THE AREA.

0+00 BEGIN PROJECT
 0+00 METERING STATION (BY OTHERS)
 EXIST. 12" P.V.C. SAN. SEW. ON 1.36% GRADE



SCALE: 1" = 20' HORIZ.
 1" = 4' VERT.

BENCHMARKS:
 " □ " ON NOSE ISLAND SOUTH SIDE BELT LINE AT DALLAS PARKWAY ELEVATION 630.77
 WATER DEPARTMENT BENCHMARK ON INLET ON NORTHWEST CORNER OF DALLAS PARKWAY & BELT LINE ROAD ELEVATION 632.10

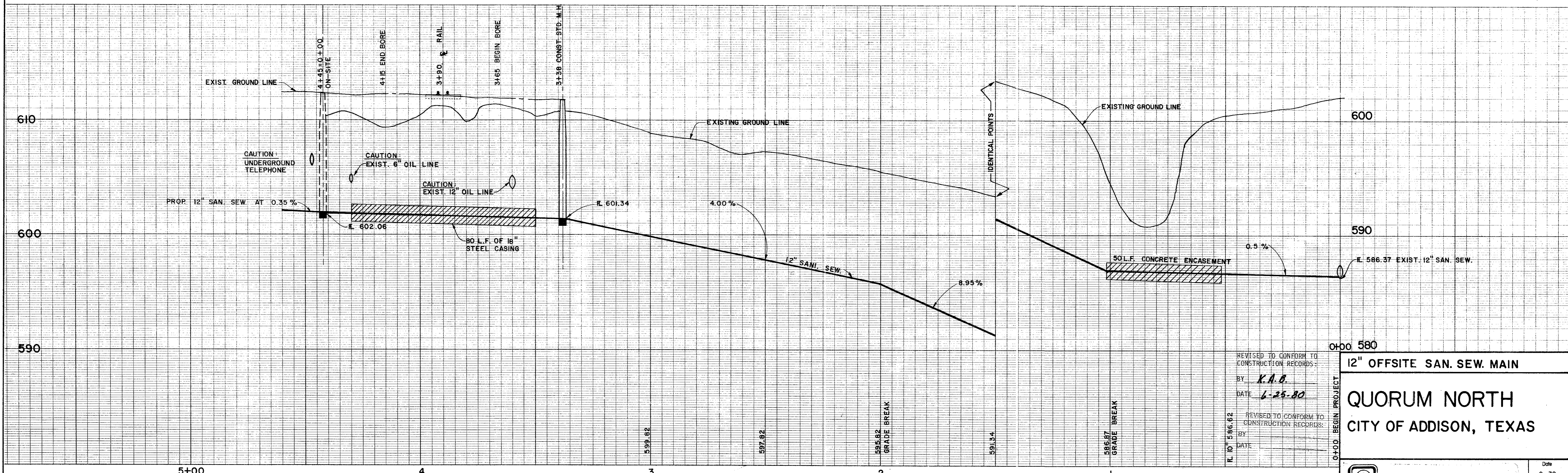

REVISED TO CONFORM TO CONSTRUCTION RECORDS:
 BY *K.A.B.*
 DATE *6-25-80*
 REVISED TO CONFORM TO CONSTRUCTION RECORDS:
 BY _____
 DATE _____

12" OFFSITE SAN. SEW. MAIN
 QUORUM NORTH
 CITY OF ADDISON, TEXAS

Graham Associates, Inc.
 CONSULTING ENGINEERS & PLANNERS

Date 9-79
 File 314-1441