

PRELIMINARY
ISSUE DATE 29 JAN 1990
REVISIONS

PROJECT NO. 88019
DRAWN BY
CHECKED BY
SCALE 1"=20'0"
SHEET NO.

NOTE:

1. Main electrical service line from the existing transformer to the property line boundary of Folsom Apartment Complex to be buried a minimum of 36" deep encased with 2" of red concrete. In addition to the concrete at a depth of 12" below grade, a 6" wide red underground warning tape printed with the words "buried electric line" shall also be required.
2. Source for underground warning tape:
 - A. Seton Nameplate Company (800) 243-6224
 - B. W.H. Brady Company (214) 350-6871
3. TU Electric would provide single phase 120/240 volt service utilizing an existing transformer located at 16300 Ledgemont. Customer would provide all civil work, cable and metering from the transformer located at the Folsom Apartment complex to the City Park. There will be no charge from TU Electric for this type of service.
4. Electrician to field verify means of access into existing transformer interior.

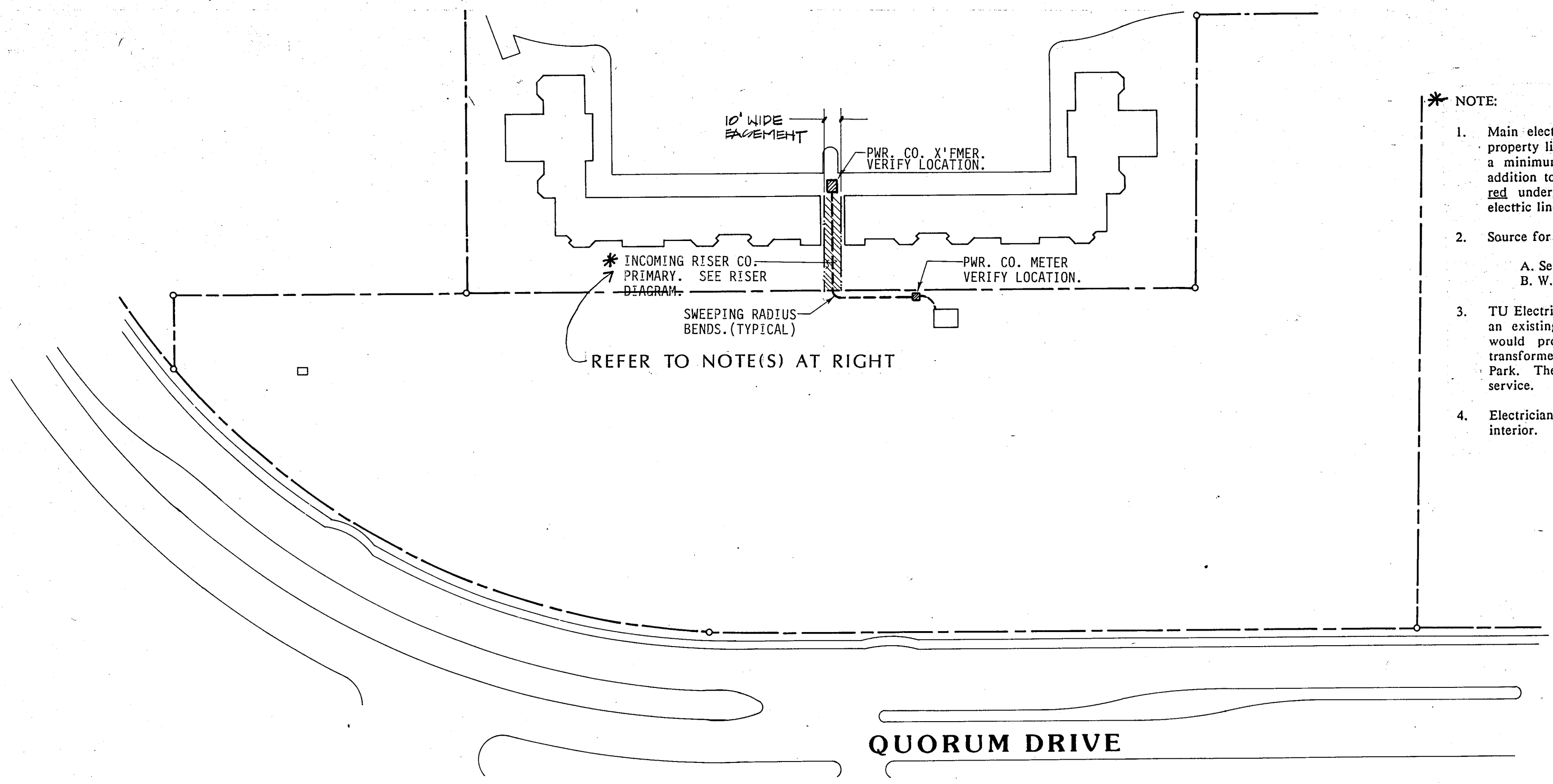

OVERALL SITE PLAN - ELECTRICAL

SCALE: 1"=50'-0"

PROPERTY LINE

POWER CO. METER.
VERIFY ALL REQ'TS.
W/PMR. CO.
MAIN ELECTRIC SERVICES.
REFERENCE RISER DIAGRAM
REFERENCE VAULT DETAIL.
LARGE FOUNTAIN VAULT
VERIFY EXACT LOCATION

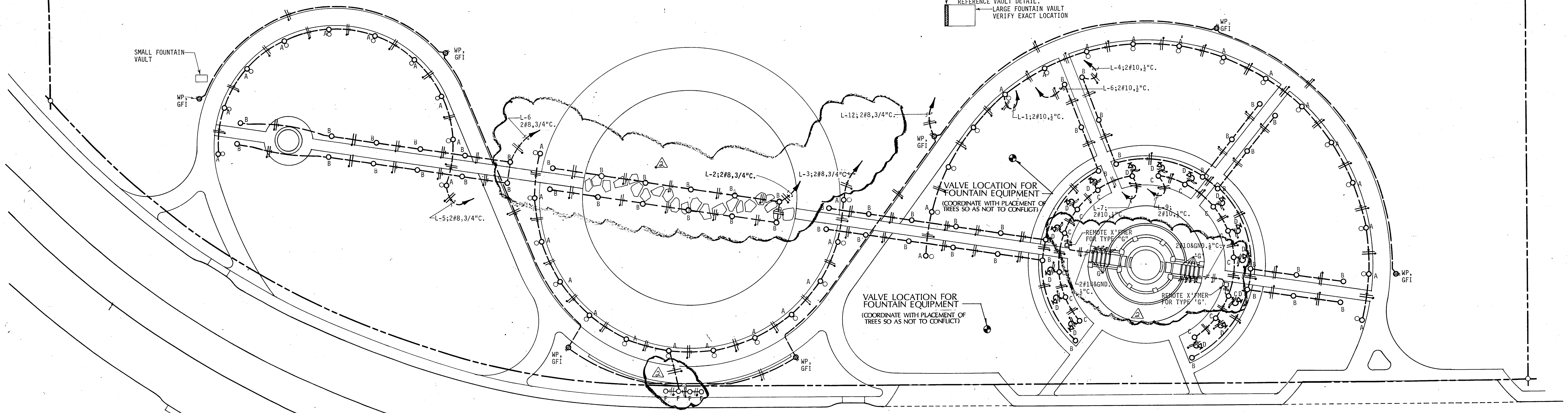

Q U O R U M D R I V E

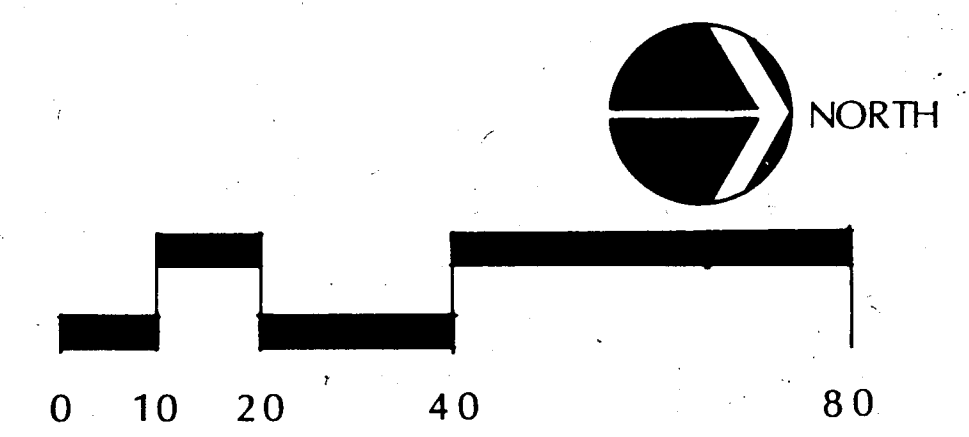

S I T E P L A N