

CEDAR ELM

**A** TYPICAL TREE PLANTING / STAKING DETAIL  
NOT TO SCALE

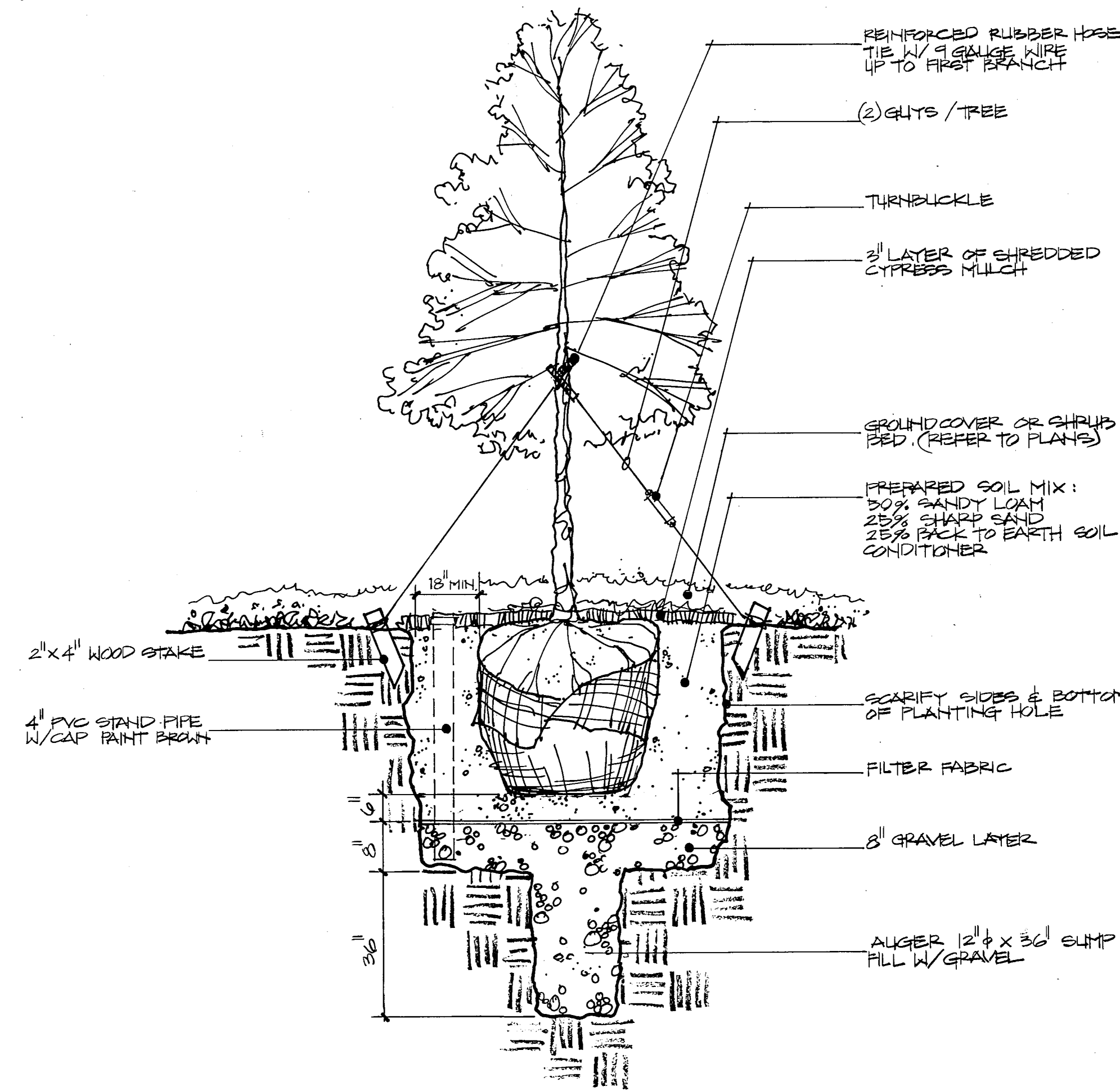

RED OAK /LELAND CYPRESS

**D** TREE PLANTING / STAKING @ FOUNTAIN AREA  
NOT TO SCALE

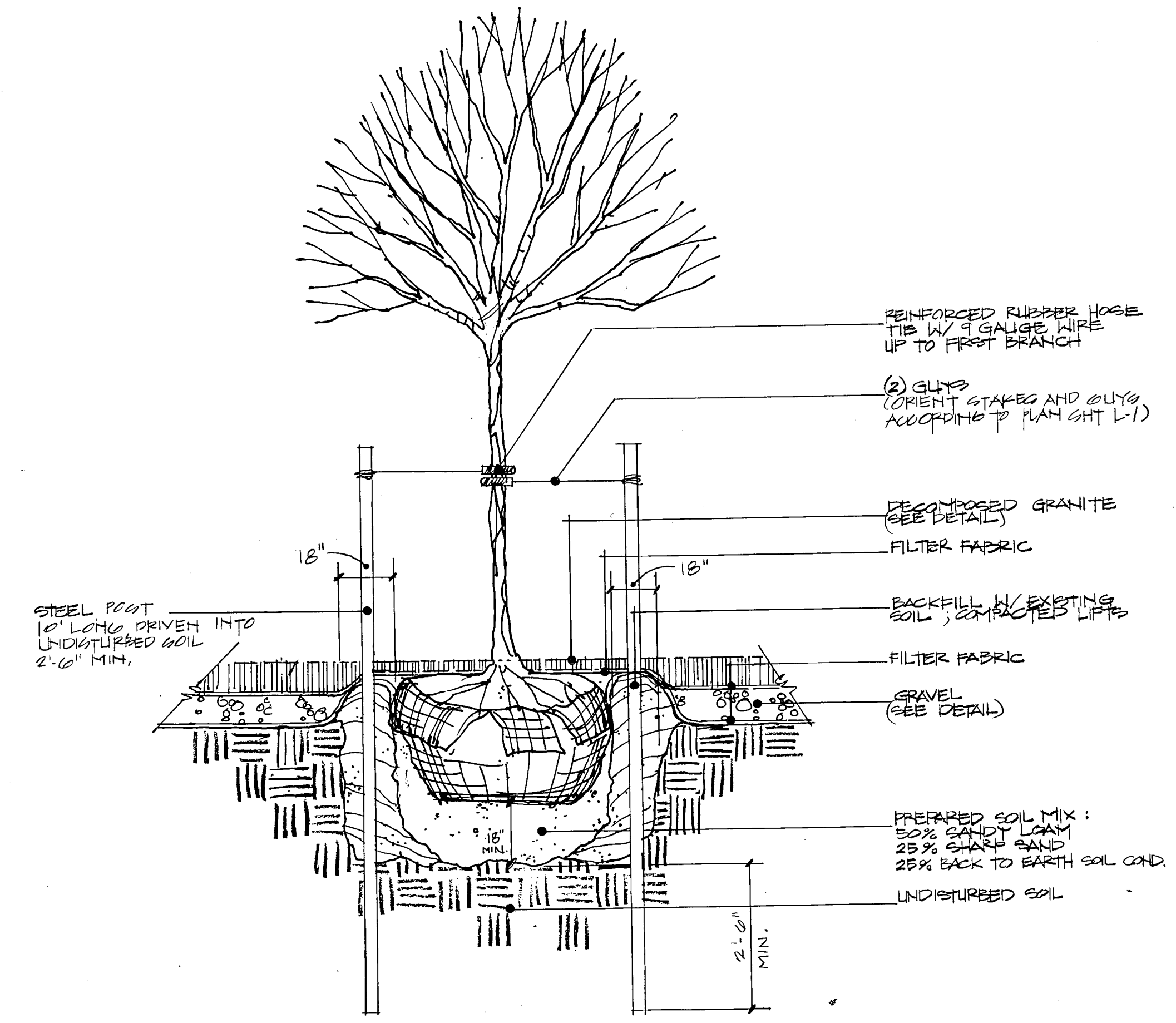

GRAPE MYRTLE TREE PLANTING

**F** ORNAMENTAL TREE BOSQUE PLANTING / STAKING DETAIL  
NOT TO SCALE

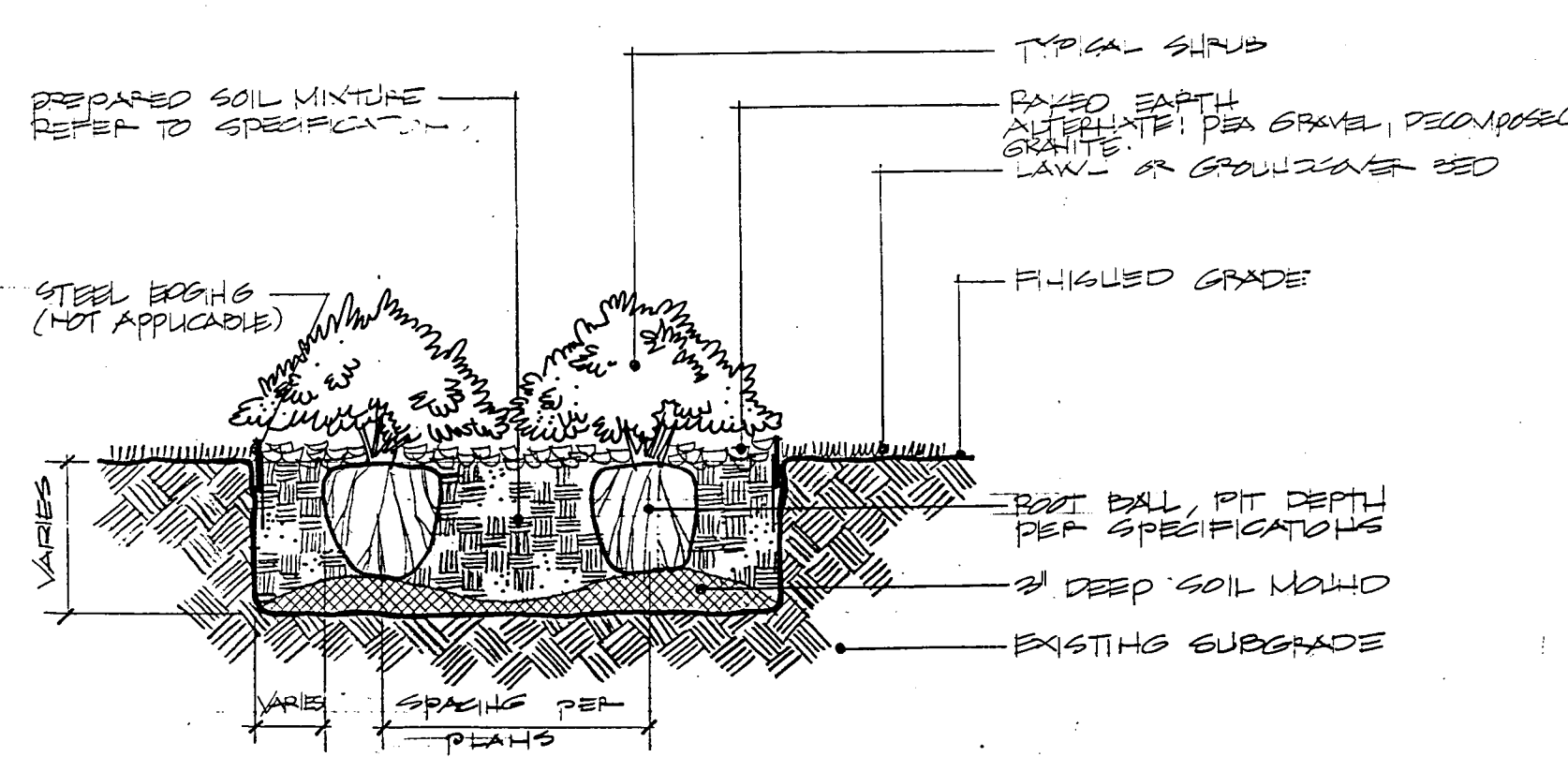

**B** TYPICAL SHRUB PLANTING DETAIL  
NOT TO SCALE

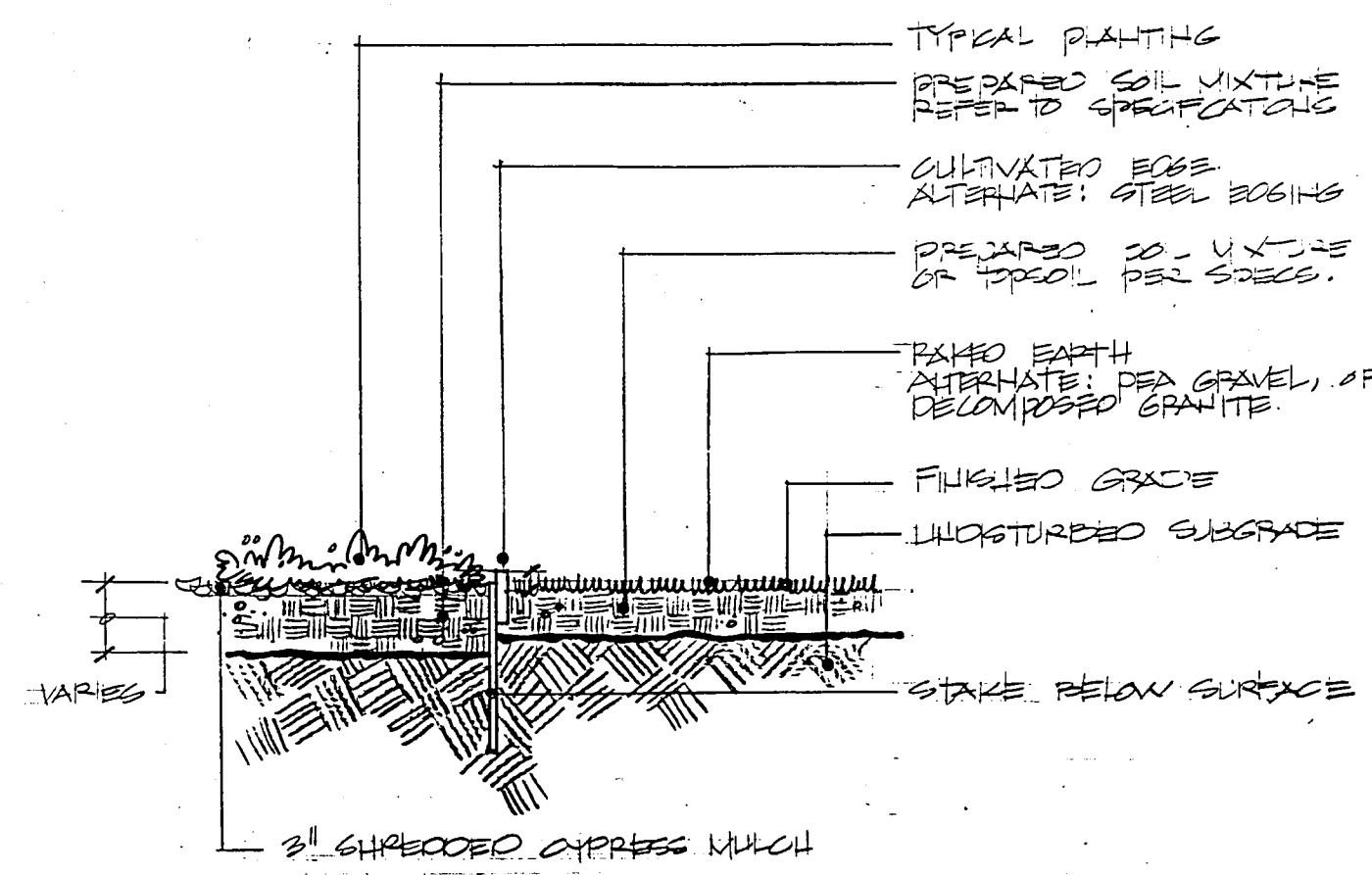

**E** STEEL EDGING DETAIL  
NOT TO SCALE

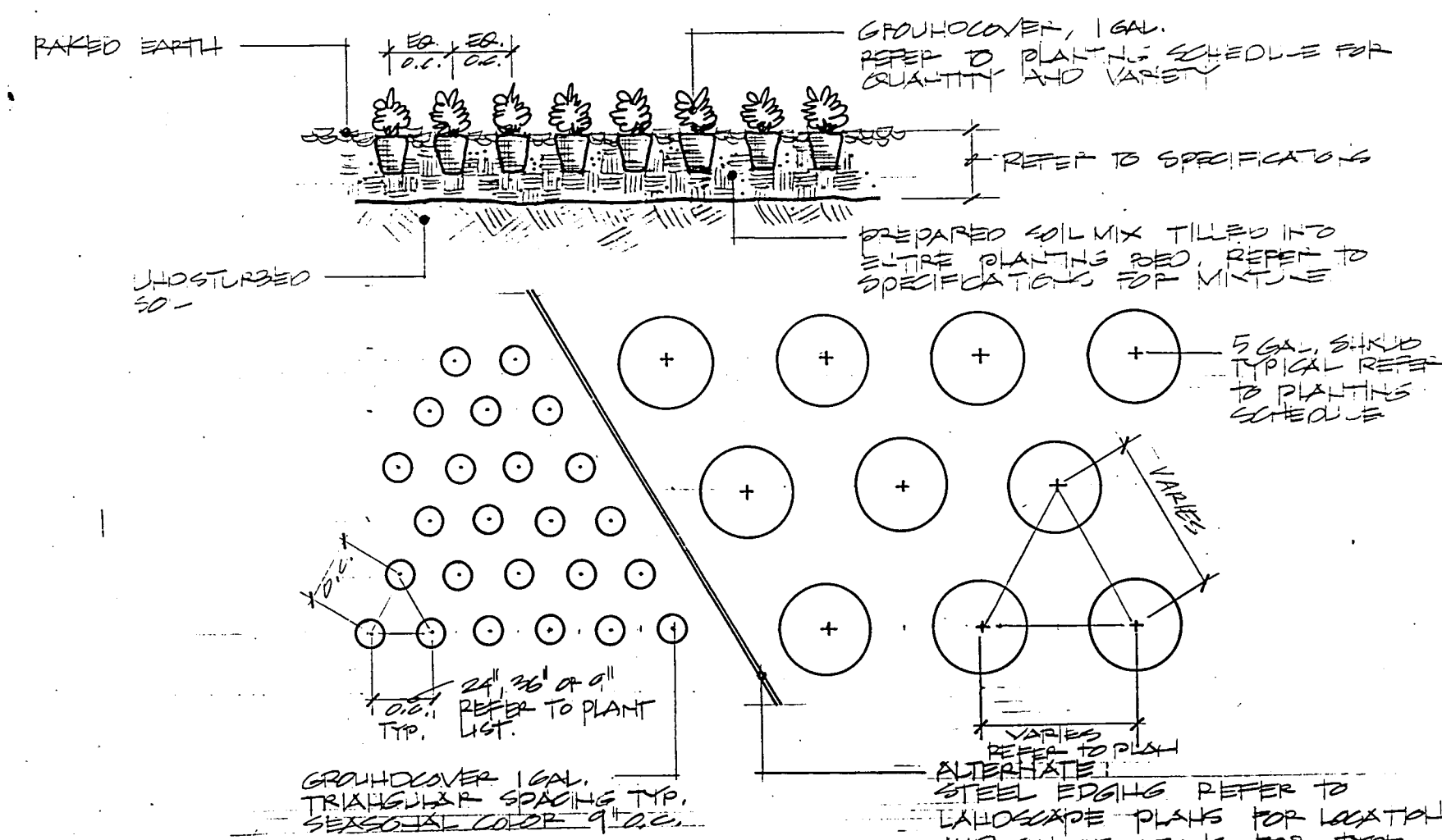

**C** TYPICAL GROUNDCOVER PLANTING DETAIL  
NOT TO SCALE

**LANDSCAPE NOTES**

- A. Preparation  
Landscape Contractor shall be responsible for making himself familiar in all underground utilities, pipes, structures, and line runs.
- B. Plant Locations  
Refer to planting plan for planting locations and plant material legend for specifications.
- \* C. Grading and Drainage  
MESA Design Group assumes no responsibility for failure of any hardscape amenity such as walks, entrances to structures, and planter beds formed or enclosed by edging and flatwork, which do not drain due to improper set up of elevations during construction.
- D. Mulch  
All bed areas shall receive a 3" layer of shredded Cypress mulch.
- E. Coordination  
Landscape Contractor shall be responsible for any coordination with sub-contractors as required to accomplish all planting operations.
- F. Maintenance  
Landscape Contractor shall be responsible for maintaining all shrub and ground cover areas in a weed and debris free condition until final acceptance.
- G. Verification  
Contractor is responsible for verification of all quantities per drawings and specifications by Landscape Architect. Plant quantities have been provided as a convenience only to the contractor and shall not be considered absolute. Landscape Architect to be notified if minor discrepancies occur. Otherwise, the Contractor is to bid their own verified quantities.

**H. Planting Soil Mixture**

- Planting soil mixture to be as follows:  
Red Oak & Leland Cypress Crepe Myrtles trees and shrubs  
50% Sandy Loam  
25% Sharp Sand  
25% Back to Earth Soil Conditioner
- All other trees, and groundcover:  
50% Existing Soil  
25% Sharp Sand  
25% Back to Earth Soil Conditioner

- I. Fertilizer  
Application rate to be approved by Landscape Architect for ground cover, shrubs and trees.
- J. Warranty  
All plant material, with the exception of seasonal color, to be guaranteed for a period of one year.
- K. Irrigation  
All landscape areas to be watered by automatic irrigation system with 100% coverage.
- L. Bed Areas  
All bed areas are to be left 2" above finish grade. All bed areas shall be rototilled to a depth of 6", add prepared soil mixture, rototill, rake level and plant.
- M. Ryerson Steel Edging  
Locate edging as shown on plans and along all curbs which are adjacent to areas. Edging shall be manufactured by V. T. Ryerson, painted green-blue approved equal.

\* refer to grading plan for soil in main fountain area.

- NYMPHAEA 'HERMINE' HERMINE WATER LILY (WHITE) 19 TOTAL
- NYMPHAEA 'MARIAGEA CHROMATELLA' CHROMATELLA WATER LILY (YELLOW) 10 TOTAL
- NYMPHAEA 'JAMES BRYDON' JAMES BRYDON WATERLILY (RED) 24 TOTAL
- NYMPHAEA 'FABOLA' FABOLA WATERLILY (PINK) 16 TOTAL

**NOTE:**  
1. PLANTS TO BE SPACED 8' O.C. (MIN.)  
2. REFER TO TYP. LILY PLANTING DETAIL FOR FURTHER INFO.  
3. SOURCE: LILY POND WATER GARDENS BRENSCHKE I, TX. (714) 341-0070

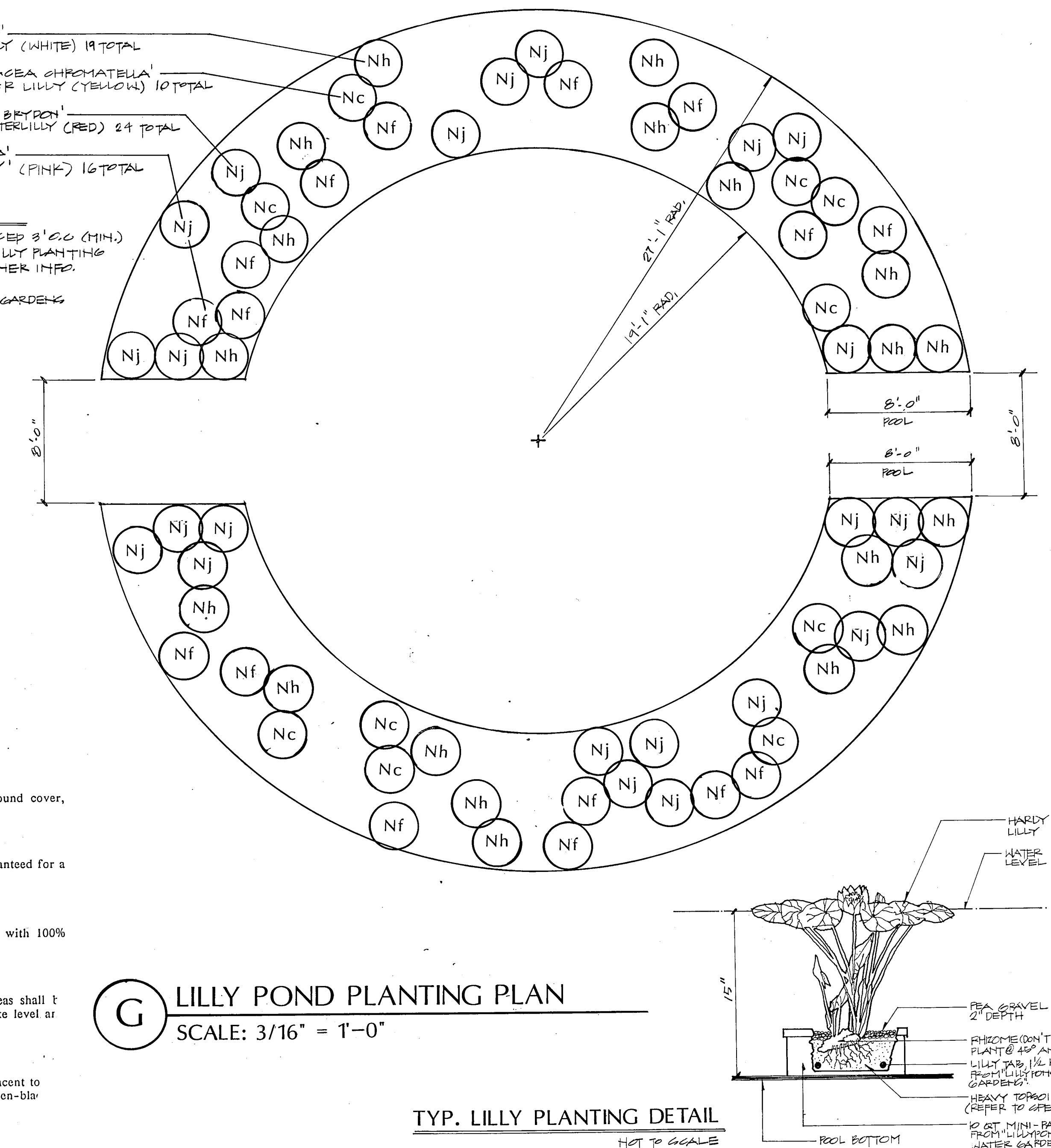

**G** LILY POND PLANTING PLAN  
SCALE: 3/16" = 1'-0"

TYP. LILY PLANTING DETAIL  
NOT TO SCALE

PRELIMINARY
ISSUE DATE 29 JAN 1990
REVISIONS

PROJECT NO. 88019
DRAWN BY SG
CHECKED BY
SCALE
SHEET NO.