

TYPICAL PAVEMENT & GRADING SECTION - SECTION X-X

NOTE: CONCRETE SHALL BE 3,000 P.S.I. AT 28 DAYS. LIME SHALL BE SLURRY MIXED PRIOR TO APPLICATION. REINFORCING SHALL BE NO. 3 AT 24" O.C.E.W.

NOTE: 10' CURB INLET SHALL BE CONSTRUCTED IN ACCORDANCE WITH THE CITY OF DALLAS, TEXAS STANDARD SPECIFICATIONS FOR PAVING DETAILS AND SPECIFICATIONS FILE # 231D-1

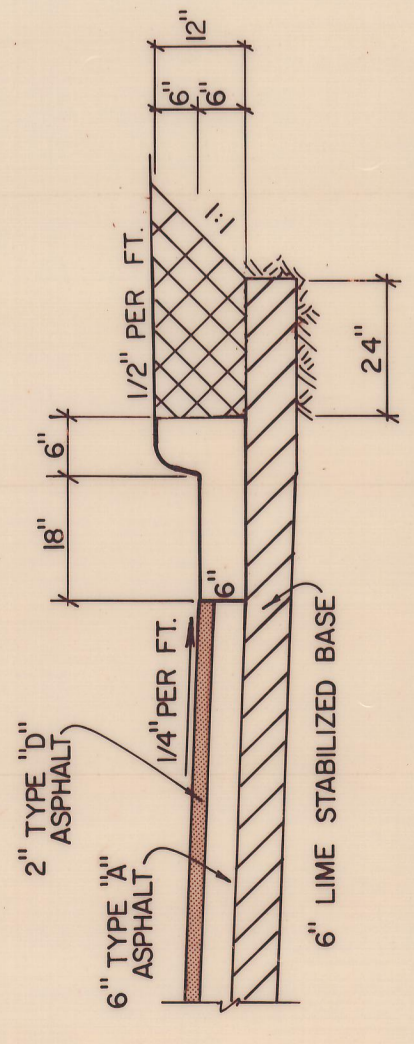

ALTERNATE ASPHALT PAVEMENT SECTION

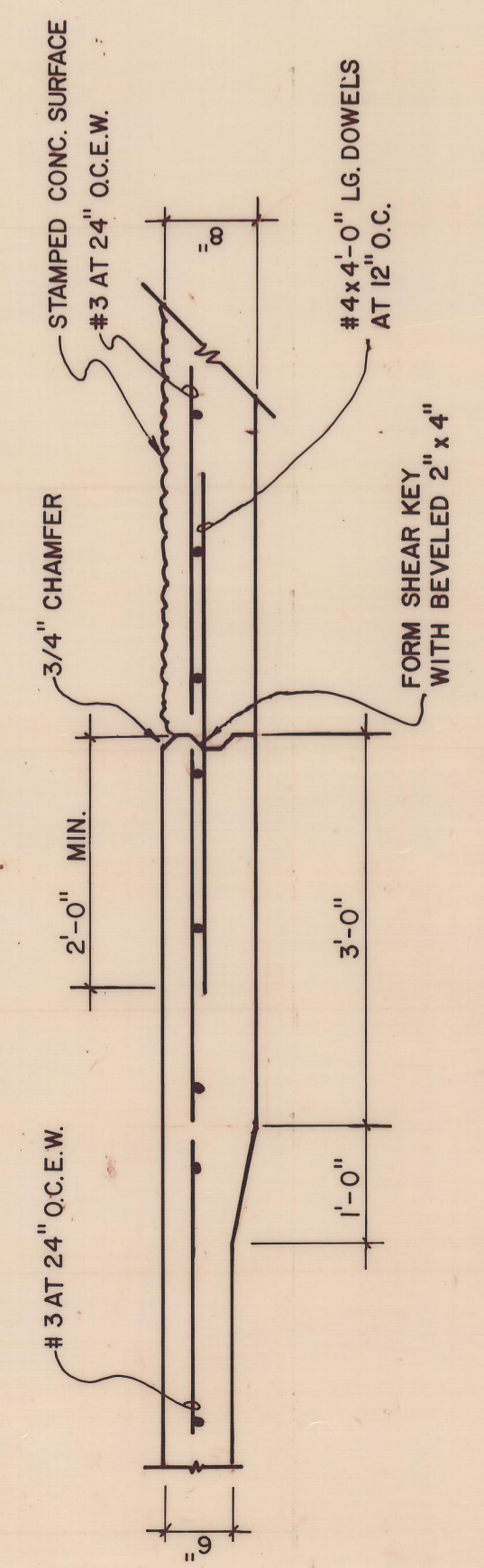

SECTION Y-Y

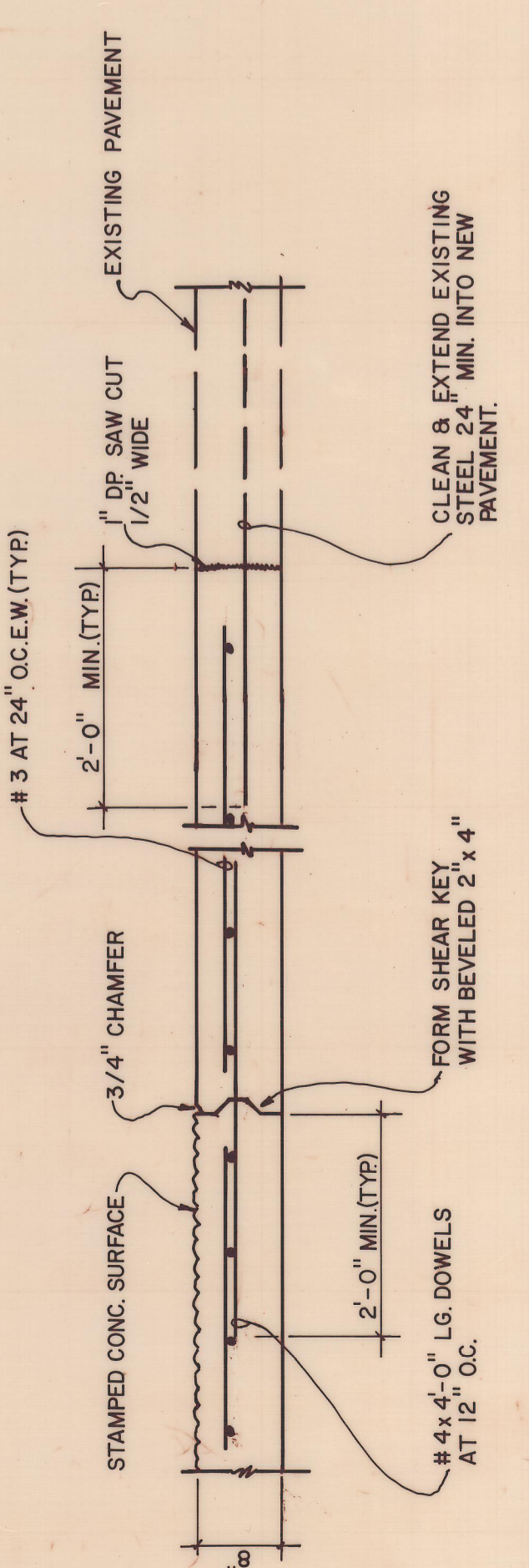

SECTION Z-Z

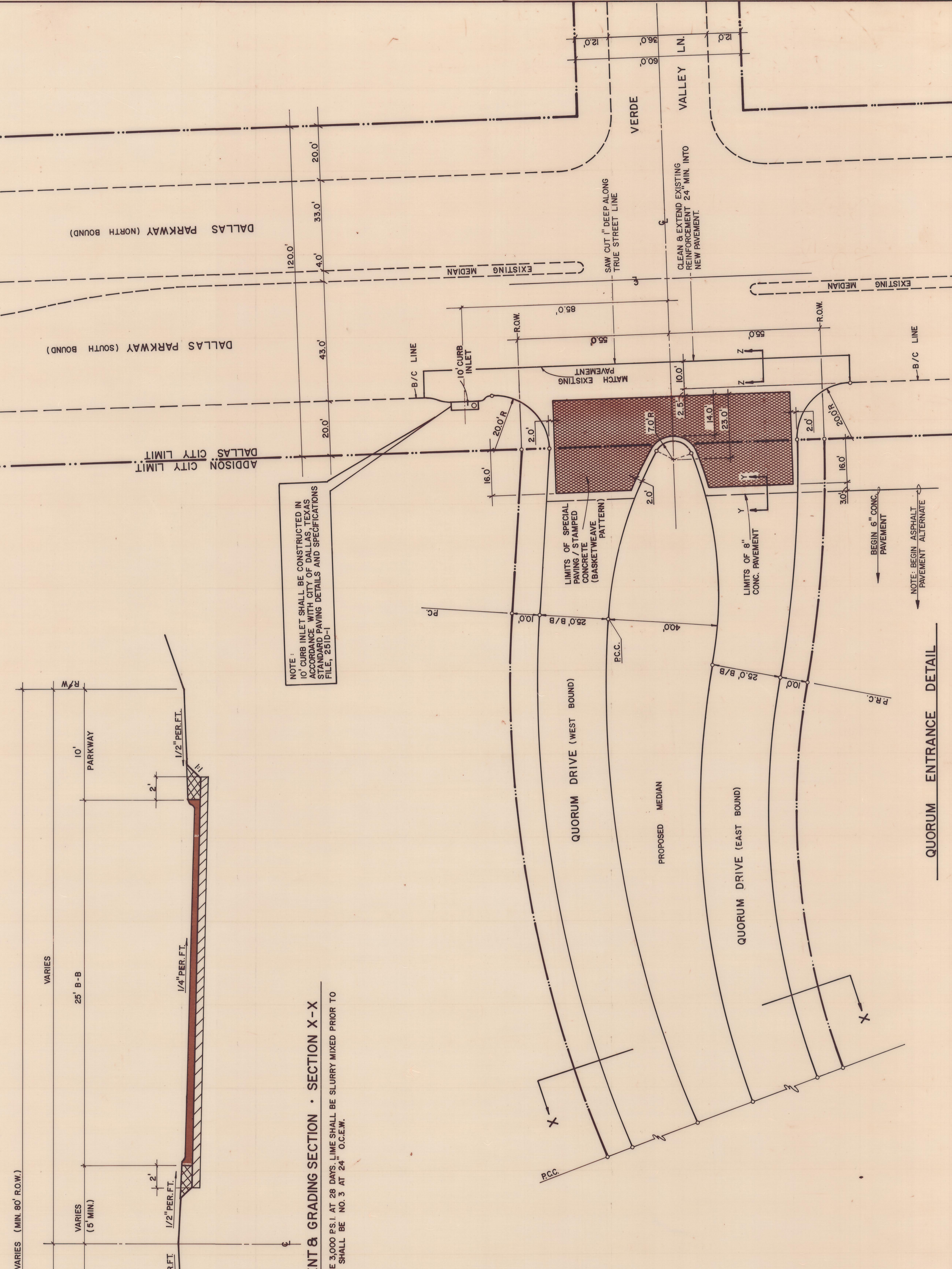

QUORUM ENTRANCE DETAIL



REVISION TO CONFORM TO CONSTRUCTION RECORDS BY DATE 8/6/89

PAVING DETAILS
QUORUM
ADDISON, TEXAS