

SECT. A-A

NOTE: Any damage done to sprinkler systems due to construction operations shall be repaired or replaced immediately, to same or better condition, prior to damage, unless otherwise approved by engineer. This is not a separate pay item, but is considered incidental to construction.

B.M. "□" On S.E. Corner of Retaining Wall at S.E. Corner of Building For Whitaker Metals - 15251 Marcy Road (Elev. 637.61)
 B.M. "□" On Curb at N.W. Corner of Walk at the N.W. Corner of Shakeys. Pizza Belt Line at Marcy Drive (Elev. 646.07)

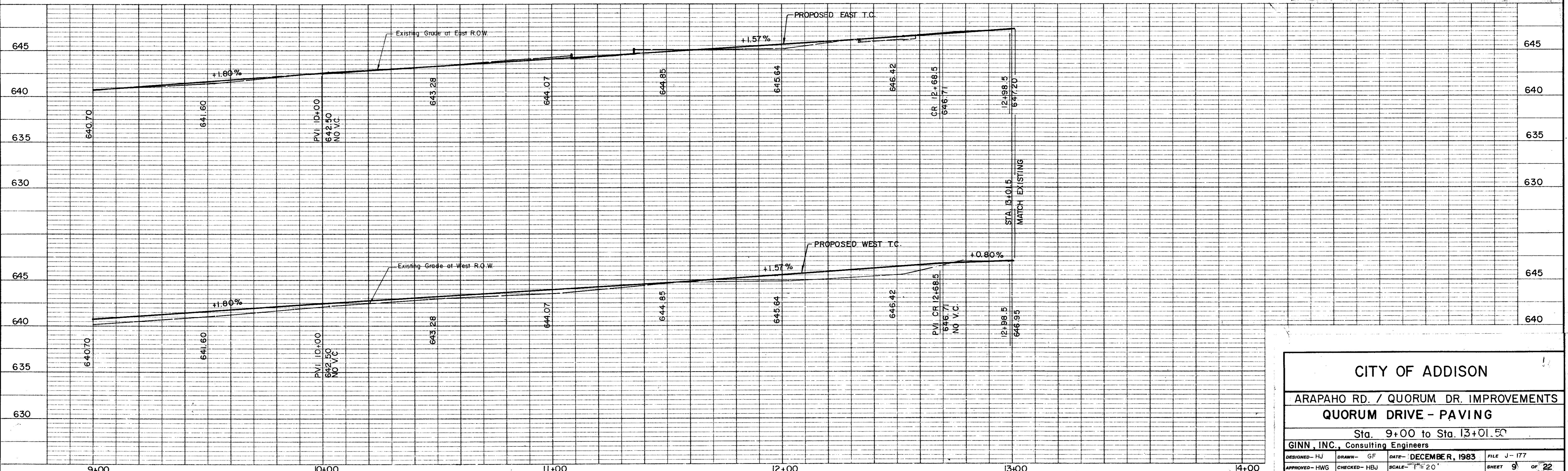

CITY OF ADDISON

ARAPAHO RD. / QUORUM DR. IMPROVEMENTS

QUORUM DRIVE - PAVING

Sta. 9+00 to Sta. 13+01.50

GINN, INC., Consulting Engineers

DESIGNED - HJ	DRAWN - GF	DATE - DECEMBER, 1983	FILE J-177
APPROVED - HWG	CHECKED - HBJ	SCALE - 1" = 20'	SHEET 9 OF 22